

8/17/99

INTERSECTION DETAIL SHEET

DETAIL SHOWING INTERSECTIONS (-Y1A-, -SR2-, -DR7-, -DR8-)
SEE SHEET NO. 17 FOR INTERCHANGE DESIGN

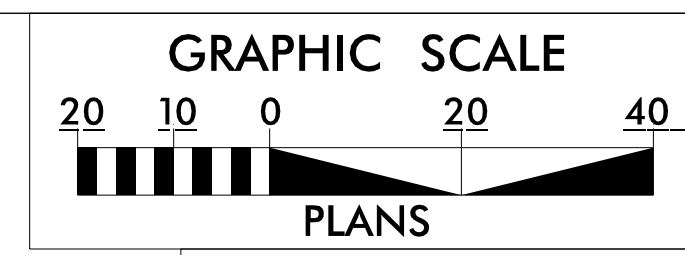

SEE SHEET 17 & 37 FOR ADDITIONAL INFORMATION

PROJECT REFERENCE NO. 1-5987A	SHEET NO. 2B-3
RW SHEET NO.	HYDRAULICS ENGINEER
ROADWAY DESIGN ENGINEER 5/18/2022	HYDRAULICS ENGINEER

DocuSigned by:
Steve Anthony Dean

**DOCUMENT NOT CONSIDERED FINAL
UNLESS ALL SIGNATURES COMPLETED**

NV5 NV5 ENGINEERS & CONSULTANTS, INC.
7500 E. INDEPENDENCE BLVD, STE 100
CHARLOTTE, NC 28227
P: 704.537.7300 www.NV5.com
NC License # F-1333

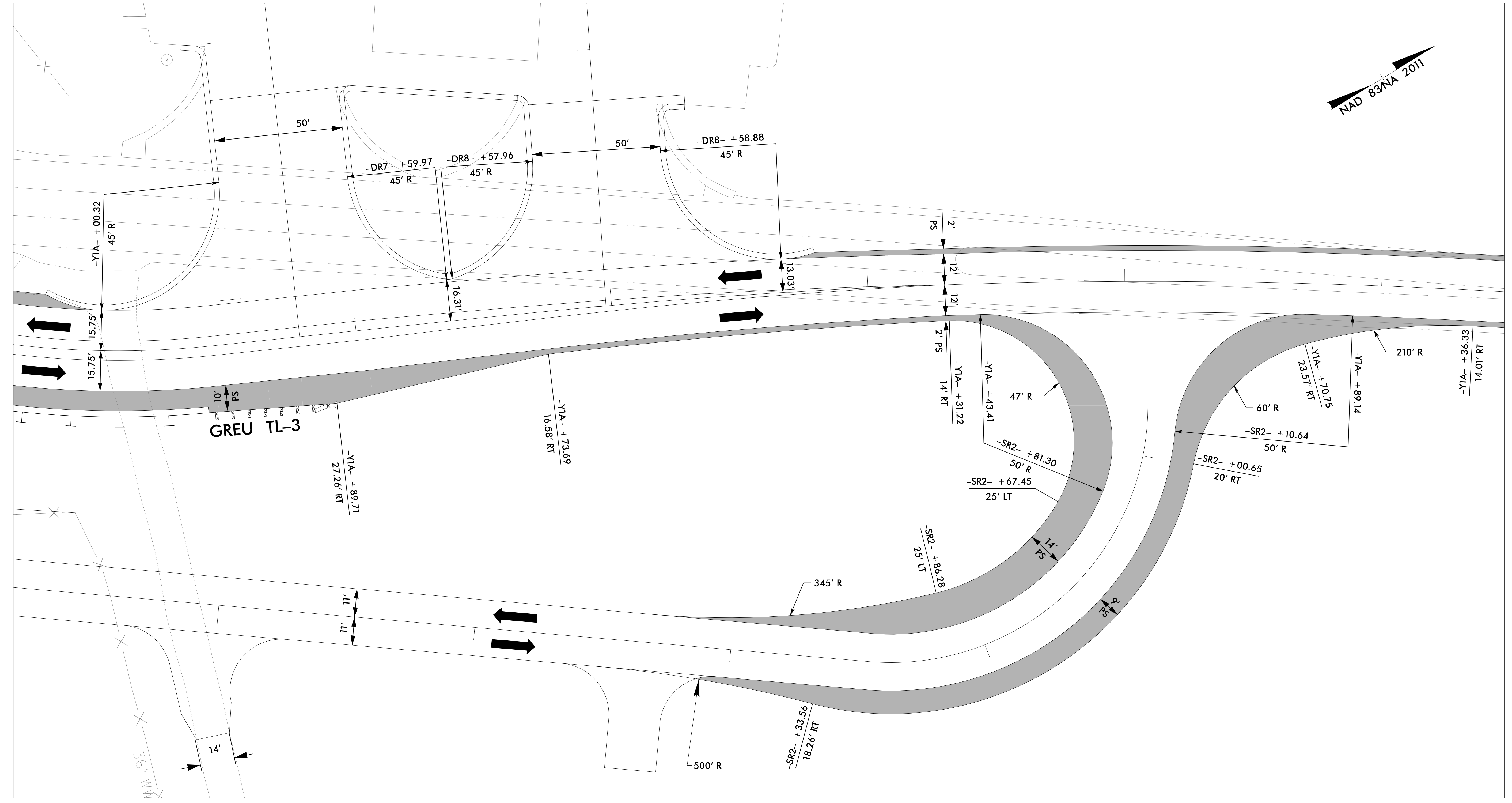
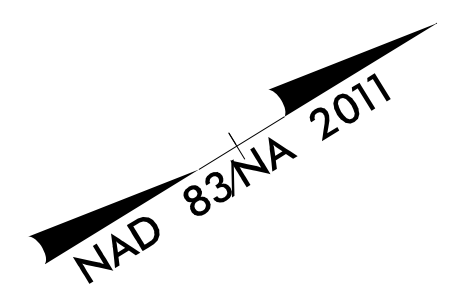

5/17/2022
R:\Projects\15987A_Proj\15987A_RDY_PSH_2B-3.dgn
Eric Moran