

REVISIONS

K:\CHL\_P\01036453 - 1-5973 (1-485 Brookshire)Erosion Control\DesignPlan Sheets\1-5973.ec.psh\_09.dgn

2/23/2022

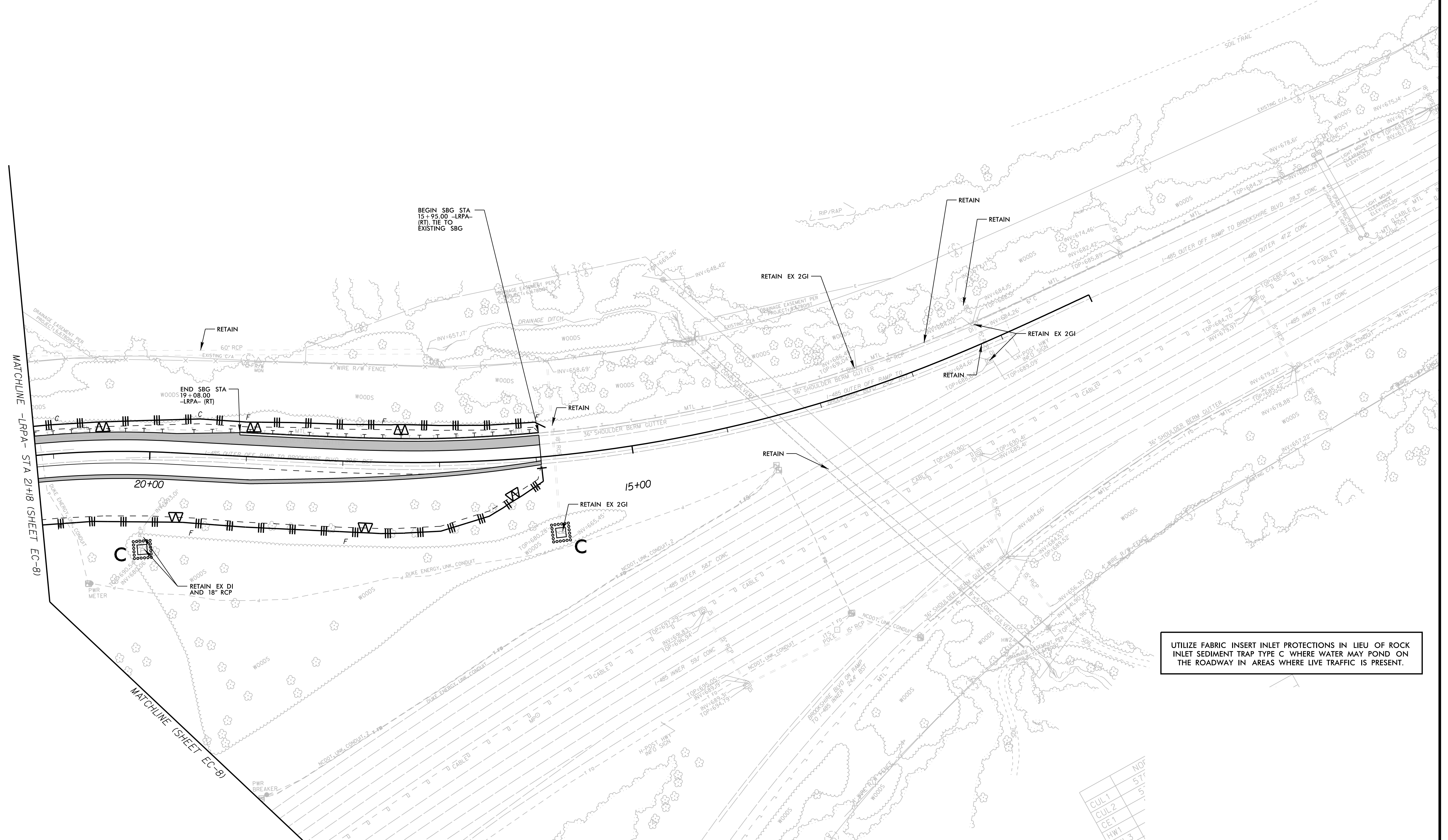

UTILIZE FABRIC INSERT INLET PROTECTIONS IN LIEU OF ROCK INLET SEDIMENT TRAP TYPE C WHERE WATER MAY POND ON THE ROADWAY IN AREAS WHERE LIVE TRAFFIC IS PRESENT.

CUL 1	NOF
CUL 2	574
CE 1	5
HW 1	
HW 2	
HW 3	