

PROJECT REFERENCE NO.	SHEET NO.
1-5973	EC-6/CONST 6
R/W SHEET NO.	HYDRAULICS ENGINEER
ROADWAY ENGINEER	
DOCUMENT NOT CONSIDERED FINAL UNLESS ALL SIGNATURES COMPLETED	

Kimley»Horn
 200 S. TRYON ST. • CHARLOTTE, NC 28202
 RIGHT-OF-WAY REV.
 CONST. REV.

CLEARING AND GRUBBING
 EROSION CONTROL FOR
 CONSTRUCTION SHEET 6

NOTE:
 PLACE TEMPORARY ROCK SEDIMENT DAMS TYPE - B
 AND TEMPORARY ROCK SILT CHECKS TYPE - A AT
 DRAINAGE OUTLETS.

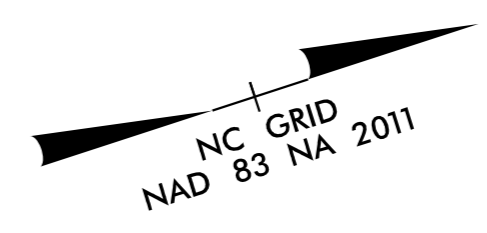

REVISIONS

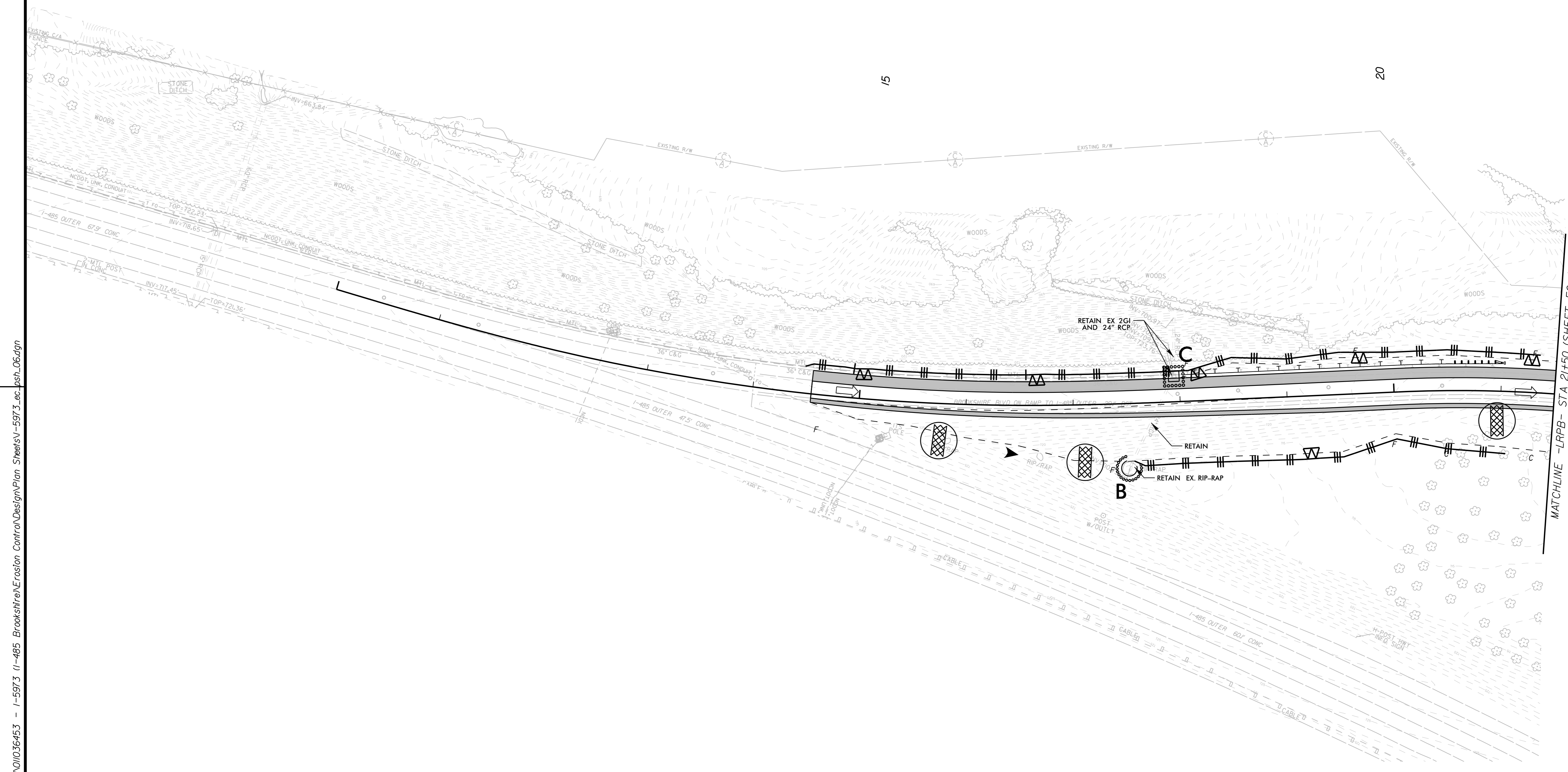

K:\CHL_PRA\01036453 - 1-5973 1-485 Brookshire Erosion Control\DesignPlan Sheets\1-5973.ec.psh_06.dgn

2/23/2022

MATCHLINE -LRPB- STA 21+50 (SHEET EC-4)

UTILIZE FABRIC INSERT INLET PROTECTIONS IN LIEU OF ROCK INLET SEDIMENT TRAP TYPE C WHERE WATER MAY POND ON THE ROADWAY IN AREAS WHERE LIVE TRAFFIC IS PRESENT.