

PROJECT: 32572.1.FS10 REFERENCE: A-0009CB

**STATE OF NORTH CAROLINA**  
**DEPARTMENT OF TRANSPORTATION**  
**DIVISION OF HIGHWAYS**  
**GEOTECHNICAL ENGINEERING UNIT**

STATE	STATE PROJECT REFERENCE NO.	SHEET NO.	TOTAL SHEETS
N.C.	A-0009CB	1	7

**CONTENTS**

SHEET NO.	DESCRIPTION
1	TITLE SHEET
2	LEGEND (SOIL & ROCK)
3	SITE PLAN
4	WALL ENVELOPE
5-6	CROSS SECTIONS
7	BORE LOGS

# STRUCTURE

## SUBSURFACE INVESTIGATION

COUNTY GRAHAM

PROJECT DESCRIPTION UPGRADE NC 143 FROM SR 1223 (BEECH CREEK ROAD) TO 0.5 MILES NORTH OF APPALACHIAN TRAIL

SITE DESCRIPTION RETAINING WALL #38: CAST-IN-PLACE CONCRETE WALL ON -L- FROM 319+29 RT TO 321+08 RT

**CAUTION NOTICE**

THE SUBSURFACE INFORMATION AND THE SUBSURFACE INVESTIGATION ON WHICH IT IS BASED WERE MADE FOR THE PURPOSE OF STUDY, PLANNING AND DESIGN, AND NOT FOR CONSTRUCTION OR PAY PURPOSES. THE VARIOUS FIELD BORING LOGS, ROCK CORES AND SOIL TEST DATA AVAILABLE MAY BE REVIEWED OR INSPECTED IN RALEIGH BY CONTACTING THE N. C. DEPARTMENT OF TRANSPORTATION, GEOTECHNICAL ENGINEERING UNIT AT (919) 707-6850. THE SUBSURFACE PLANS AND REPORTS, FIELD BORING LOGS, ROCK CORES AND SOIL TEST DATA ARE NOT PART OF THE CONTRACT.

GENERAL SOIL AND ROCK STRATA DESCRIPTIONS AND INDICATED BOUNDARIES ARE BASED ON A GEOTECHNICAL INTERPRETATION OF ALL AVAILABLE SUBSURFACE DATA AND MAY NOT NECESSARILY REFLECT THE ACTUAL SUBSURFACE CONDITIONS BETWEEN BORINGS OR BETWEEN SAMPLED STRATA WITHIN THE BOREHOLE. THE LABORATORY SAMPLE DATA AND THE IN SITU (IN-PLACE) TEST DATA CAN BE RELIED ON ONLY TO THE DEGREE OF RELIABILITY INHERENT IN THE STANDARD TEST METHOD. THE OBSERVED WATER LEVELS OR SOIL MOISTURE CONDITIONS INDICATED IN THE SUBSURFACE INVESTIGATIONS ARE AS RECORDED AT THE TIME OF THE INVESTIGATION. THESE WATER LEVELS OR SOIL MOISTURE CONDITIONS MAY VARY CONSIDERABLY WITH TIME ACCORDING TO CLIMATIC CONDITIONS INCLUDING TEMPERATURES, PRECIPITATION AND WIND, AS WELL AS OTHER NON-CLIMATIC FACTORS.

THE BIDDER OR CONTRACTOR IS CAUTIONED THAT DETAILS SHOWN ON THE SUBSURFACE PLANS ARE PRELIMINARY ONLY AND IN MANY CASES THE FINAL DESIGN DETAILS ARE DIFFERENT. FOR BIDDING AND CONSTRUCTION PURPOSES, REFER TO THE CONSTRUCTION PLANS AND DOCUMENTS FOR FINAL DESIGN INFORMATION ON THIS PROJECT. THE DEPARTMENT DOES NOT WARRANT OR GUARANTEE THE SUFFICIENCY OR ACCURACY OF THE INVESTIGATION MADE, NOR THE INTERPRETATIONS MADE, OR OPINION OF THE DEPARTMENT AS TO THE TYPE OF MATERIALS AND CONDITIONS TO BE ENCOUNTERED. THE BIDDER OR CONTRACTOR IS CAUTIONED TO MAKE SUCH INDEPENDENT SUBSURFACE INVESTIGATIONS AS HE DEEMS NECESSARY TO SATISFY HIMSELF AS TO CONDITIONS TO BE ENCOUNTERED ON THE PROJECT. THE CONTRACTOR SHALL HAVE NO CLAIM FOR ADDITIONAL COMPENSATION OR FOR AN EXTENSION OF TIME FOR ANY REASON RESULTING FROM THE ACTUAL CONDITIONS ENCOUNTERED AT THE SITE DIFFERING FROM THOSE INDICATED IN THE SUBSURFACE INFORMATION.

- NOTES:
- THE INFORMATION CONTAINED HEREIN IS NOT IMPLIED OR GUARANTEED BY THE N. C. DEPARTMENT OF TRANSPORTATION AS ACCURATE NOR IS IT CONSIDERED PART OF THE PLANS, SPECIFICATIONS OR CONTRACT FOR THE PROJECT.
  - BY HAVING REQUESTED THIS INFORMATION, THE CONTRACTOR SPECIFICALLY WAIVES ANY CLAIMS FOR INCREASED COMPENSATION OR EXTENSION OF TIME BASED ON DIFFERENCES BETWEEN THE CONDITIONS INDICATED HEREIN AND THE ACTUAL CONDITIONS AT THE PROJECT SITE.

PERSONNEL

CG2 EXPLORATION

S. BRAUN

INVESTIGATED BY CG2

DRAWN BY M. BREWER, P.E.

CHECKED BY R. KRAL, P.E.

SUBMITTED BY M. BREWER, P.E.

DATE MAY 2022

Prepared in the Office of:

**CAROLINAS  
GEOTECHNICAL  
GROUP**

2400 CROWNPOINT EXECUTIVE DRIVE  
SUITE 800  
CHARLOTTE, NC 28227  
(980) 339-8684



DocuSigned by:

Donald Brewer 05/06/2022

386129C0A4C1462 SIGNATURE DATE

**DOCUMENT NOT CONSIDERED FINAL  
UNLESS ALL SIGNATURES COMPLETED**

**NORTH CAROLINA DEPARTMENT OF TRANSPORTATION**  
**DIVISION OF HIGHWAYS**  
**GEOTECHNICAL ENGINEERING UNIT**  
**SUBSURFACE INVESTIGATION**  
**SOIL AND ROCK LEGEND, TERMS, SYMBOLS, AND ABBREVIATIONS**

SOIL DESCRIPTION										GRADATION										ROCK DESCRIPTION										TERMS AND DEFINITIONS																																																																																																																																																																																															
<p>SOIL IS CONSIDERED UNCONSOLIDATED, SEMI-CONSOLIDATED, OR WEATHERED EARTH MATERIALS THAT CAN BE PENETRATED WITH A CONTINUOUS FLIGHT POWER AUGER AND YIELD LESS THAN 100 BLOWS PER FOOT ACCORDING TO THE STANDARD PENETRATION TEST (AASHTO T 208, ASTM D1586). SOIL CLASSIFICATION IS BASED ON THE AASHTO SYSTEM. BASIC DESCRIPTIONS GENERALLY INCLUDE THE FOLLOWING: CONSISTENCY, COLOR, TEXTURE, MOISTURE, AASHTO CLASSIFICATION, AND OTHER PERTINENT FACTORS SUCH AS MINERALOGICAL COMPOSITION, ANGULARITY, STRUCTURE, PLASTICITY, ETC. FOR EXAMPLE, <i>VERY STIFF, GRAY, SILTY CLAY, MOIST WITH INTERBEDDED FINE SAND LAYERS, HIGHLY PLASTIC, A-7-6</i></p>										<p><b>WELL GRADED</b> - INDICATES A GOOD REPRESENTATION OF PARTICLE SIZES FROM FINE TO COARSE.  <b>UNIFORMLY GRADED</b> - INDICATES THAT SOIL PARTICLES ARE ALL APPROXIMATELY THE SAME SIZE.  <b>GAP-GRADED</b> - INDICATES A MIXTURE OF UNIFORM PARTICLE SIZES OF TWO OR MORE SIZES.</p>										<p>HARD ROCK IS NON-COASTAL PLAIN MATERIAL THAT WOULD YIELD SPT REFUSAL IF TESTED, AN INFERRED ROCK LINE INDICATES THE LEVEL AT WHICH NON-COASTAL PLAIN MATERIAL WOULD YIELD SPT REFUSAL. SPT REFUSAL IS PENETRATION BY A SPLIT SPOON SAMPLER EQUAL TO OR LESS THAN 0.1 FOOT PER 60 BLOWS IN NON-COASTAL PLAIN MATERIAL. THE TRANSITION BETWEEN SOIL AND ROCK IS OFTEN REPRESENTED BY A ZONE OF WEATHERED ROCK. ROCK MATERIALS ARE TYPICALLY DIVIDED AS FOLLOWS:</p>										<p><b>ALLUVIUM (ALLUV.)</b> - SOILS THAT HAVE BEEN TRANSPORTED BY WATER.  <b>AQUIFER</b> - A WATER BEARING FORMATION OR STRATA.  <b>ARENACEOUS</b> - APPLIED TO ROCKS THAT HAVE BEEN DERIVED FROM SAND OR THAT CONTAIN SAND.  <b>ARGILLACEOUS</b> - APPLIED TO ALL ROCKS OR SUBSTANCES COMPOSED OF CLAY MINERALS, OR HAVING A NOTABLE PROPORTION OF CLAY IN THEIR COMPOSITION, SUCH AS SHALE, SLATE, ETC.  <b>ARTESIAN</b> - GROUND WATER THAT IS UNDER SUFFICIENT PRESSURE TO RISE ABOVE THE LEVEL AT WHICH IT IS ENCOUNTERED, BUT WHICH DOES NOT NECESSARILY RISE TO OR ABOVE THE GROUND SURFACE.  <b>CALCAREOUS (CALC.)</b> - SOILS THAT CONTAIN APPRECIABLE AMOUNTS OF CALCIUM CARBONATE.  <b>COLLUVIUM</b> - ROCK FRAGMENTS MIXED WITH SOIL DEPOSITED BY GRAVITY ON SLOPE OR AT BOTTOM OF SLOPE.  <b>CORE RECOVERY (REC.)</b> - TOTAL LENGTH OF ALL MATERIAL RECOVERED IN THE CORE BARREL DIVIDED BY TOTAL LENGTH OF CORE RUN AND EXPRESSED AS A PERCENTAGE.  <b>DIKE</b> - A TABULAR BODY OF IGNEOUS ROCK THAT CUTS ACROSS THE STRUCTURE OF ADJACENT ROCKS OR CUTS MASSIVE ROCK.  <b>DIP</b> - THE ANGLE AT WHICH A STRATUM OR ANY PLANAR FEATURE IS INCLINED FROM THE HORIZONTAL.  <b>DIP DIRECTION (DIP AZIMUTH)</b> - THE DIRECTION OR BEARING OF THE HORIZONTAL TRACE OF THE LINE OF DIP, MEASURED CLOCKWISE FROM NORTH.  <b>FAULT</b> - A FRACTURE OR FRACTURE ZONE ALONG WHICH THERE HAS BEEN DISPLACEMENT OF THE SIDES RELATIVE TO ONE ANOTHER PARALLEL TO THE FRACTURE.  <b>FISSILE</b> - A PROPERTY OF SPLITTING ALONG CLOSELY SPACED PARALLEL PLANES.  <b>FLOAT</b> - ROCK FRAGMENTS ON SURFACE NEAR THEIR ORIGINAL POSITION AND DISLOADED FROM PARENT MATERIAL.  <b>FLOOD PLAIN (FP)</b> - LAND BORDERING A STREAM, BUILT OF SEDIMENTS DEPOSITED BY THE STREAM.  <b>FORMATION (FM)</b> - A MAPPABLE GEOLOGIC UNIT THAT CAN BE RECOGNIZED AND TRACED IN THE FIELD.  <b>JOINT</b> - FRACTURE IN ROCK ALONG WHICH NO APPRECIABLE MOVEMENT HAS OCCURRED.  <b>LEDGE</b> - A SHELF-LIKE RIDGE OR PROJECTION OF ROCK WHOSE THICKNESS IS SMALL COMPARED TO ITS LATERAL EXTENT.  <b>LENS</b> - A BODY OF SOIL OR ROCK THAT THINS OUT IN ONE OR MORE DIRECTIONS.  <b>MOTTLED (MOT.)</b> - IRREGULARLY MARKED WITH SPOTS OF DIFFERENT COLORS. MOTTLING IN SOILS USUALLY INDICATES POOR AERATION AND LACK OF GOOD DRAINAGE.  <b>PERCHED WATER</b> - WATER MAINTAINED ABOVE THE NORMAL GROUND WATER LEVEL BY THE PRESENCE OF AN INTERVENING IMPERVIOUS STRATUM.  <b>RESIDUAL (RES.) SOIL</b> - SOIL FORMED IN PLACE BY THE WEATHERING OF ROCK.  <b>ROCK QUALITY DESIGNATION (ROD)</b> - A MEASURE OF ROCK QUALITY DESCRIBED BY TOTAL LENGTH OF ROCK SEGMENTS EQUAL TO OR GREATER THAN 4 INCHES DIVIDED BY THE TOTAL LENGTH OF CORE RUN AND EXPRESSED AS A PERCENTAGE.  <b>SAPROLITE (SAP.)</b> - RESIDUAL SOIL THAT RETAINS THE RELIC STRUCTURE OR FABRIC OF THE PARENT ROCK.  <b>SILL</b> - AN INTRUSIVE BODY OF IGNEOUS ROCK OF APPROXIMATELY UNIFORM THICKNESS AND RELATIVELY THIN COMPARED WITH ITS LATERAL EXTENT, THAT HAS BEEN EMPLACED PARALLEL TO THE BEDDING OR SCHISTOSITY OF THE INTRUDED ROCKS.  <b>SLICKENSIDE</b> - POLISHED AND STRIATED SURFACE THAT RESULTS FROM FRICTION ALONG A FAULT OR SLIP PLANE.  <b>STANDARD PENETRATION TEST (PENETRATION RESISTANCE) (SPT)</b> - NUMBER OF BLOWS (IN OR BPF) OF A 140 LB. HAMMER FALLING 30 INCHES REQUIRED TO PRODUCE A PENETRATION OF 1 FOOT INTO SOIL WITH A 2 INCH OUTSIDE DIAMETER SPLIT SPOON SAMPLER. SPT REFUSAL IS PENETRATION EQUAL TO OR LESS THAN 0.1 FOOT PER 60 BLOWS.  <b>STRATA CORE RECOVERY (SREC.)</b> - TOTAL LENGTH OF STRATA MATERIAL RECOVERED DIVIDED BY TOTAL LENGTH OF STRATUM AND EXPRESSED AS A PERCENTAGE.  <b>STRATA ROCK QUALITY DESIGNATION (SROD)</b> - A MEASURE OF ROCK QUALITY DESCRIBED BY TOTAL LENGTH OF ROCK SEGMENTS WITHIN A STRATUM EQUAL TO OR GREATER THAN 4 INCHES DIVIDED BY THE TOTAL LENGTH OF STRATA AND EXPRESSED AS A PERCENTAGE.  <b>TOPSOIL (TS.)</b> - SURFACE SOILS USUALLY CONTAINING ORGANIC MATTER.</p>																																																																																																																																																																																															
<p style="text-align: center;"><b>SOIL LEGEND AND AASHTO CLASSIFICATION</b></p> <table border="1" style="width: 100%; border-collapse: collapse;"> <tr> <th rowspan="2">GENERAL CLASS.</th> <th colspan="5">GRANULAR MATERIALS (≤ 35% PASSING #200)</th> <th colspan="5">SILT-CLAY MATERIALS (&gt; 35% PASSING #200)</th> <th colspan="5">ORGANIC MATERIALS</th> </tr> <tr> <th>A-1</th> <th>A-3</th> <th>A-2</th> <th>A-4</th> <th>A-5</th> <th>A-6</th> <th>A-7</th> <th>A-1, A-2</th> <th>A-3</th> <th>A-4, A-5</th> <th>A-6, A-7</th> <th></th> <th></th> <th></th> <th></th> </tr> <tr> <td>GROUP CLASS.</td> <td>A-1-a</td> <td>A-1-b</td> <td>A-2-4</td> <td>A-2-5</td> <td>A-2-6</td> <td>A-2-7</td> <td>A-4</td> <td>A-5</td> <td>A-6</td> <td>A-7</td> <td>A-1, A-2</td> <td>A-3</td> <td>A-4, A-5</td> <td>A-6, A-7</td> <td></td> </tr> <tr> <td>SYMBOL</td> <td colspan="5">[Pattern]</td> <td colspan="5">[Pattern]</td> <td colspan="5">[Pattern]</td> </tr> <tr> <td>% PASSING #10 #40 #200</td> <td>50 MX 30 MX 15 MX</td> <td>50 MX 25 MX</td> <td>51 MN 35 MX 35 MX</td> <td>40 MX 41 MN 10 MX 11 MN</td> <td>40 MX 41 MN 11 MN 11 MN</td> <td>40 MX 41 MN 11 MN 11 MN</td> <td>36 MN 36 MN 36 MN</td> <td>40 MX 41 MN 40 MX 41 MN</td> <td>40 MX 41 MN 40 MX 41 MN</td> <td>40 MX 41 MN 40 MX 41 MN</td> <td>40 MX 41 MN 40 MX 41 MN</td> <td>GRANULAR SOILS</td> <td>SILT-CLAY SOILS</td> <td>MUCK, PEAT</td> <td></td> </tr> <tr> <td>MATERIAL PASSING #40 LL PI</td> <td colspan="5"></td> <td colspan="5"></td> <td colspan="5">SOILS WITH LITTLE OR MODERATE AMOUNTS OF ORGANIC MATTER</td> </tr> <tr> <td>GROUP INDEX</td> <td colspan="5">0</td> <td colspan="5">0</td> <td colspan="5">4 MX 8 MX 12 MX 16 MX NO MX</td> </tr> <tr> <td>USUAL TYPES OF MAJOR MATERIALS</td> <td colspan="2">STONE FRAGS. GRAVEL, AND SAND</td> <td colspan="2">FINE SAND</td> <td colspan="2">SILTY OR CLAYEY GRAVEL AND SAND</td> <td colspan="2">SILTY SOILS</td> <td colspan="2">CLAYEY SOILS</td> <td colspan="5">HIGHLY ORGANIC SOILS</td> </tr> <tr> <td>GEN. RATING AS SUBGRADE</td> <td colspan="5">EXCELLENT TO GOOD</td> <td colspan="5">FAIR TO POOR</td> <td>FAIR TO POOR</td> <td>POOR</td> <td>UNSATURABLE</td> <td></td> </tr> <tr> <td colspan="10">PI OF A-7-5 SUBGROUP IS ≤ LL - 30 ; PI OF A-7-6 SUBGROUP IS &gt; LL - 30</td> <td colspan="5"></td> <td colspan="5"></td> </tr> </table>										GENERAL CLASS.	GRANULAR MATERIALS (≤ 35% PASSING #200)					SILT-CLAY MATERIALS (> 35% PASSING #200)					ORGANIC MATERIALS					A-1	A-3	A-2	A-4	A-5	A-6	A-7	A-1, A-2	A-3	A-4, A-5	A-6, A-7					GROUP CLASS.	A-1-a	A-1-b	A-2-4	A-2-5	A-2-6	A-2-7	A-4	A-5	A-6	A-7	A-1, A-2	A-3	A-4, A-5	A-6, A-7		SYMBOL	[Pattern]					[Pattern]					[Pattern]					% PASSING #10 #40 #200	50 MX 30 MX 15 MX	50 MX 25 MX	51 MN 35 MX 35 MX	40 MX 41 MN 10 MX 11 MN	40 MX 41 MN 11 MN 11 MN	40 MX 41 MN 11 MN 11 MN	36 MN 36 MN 36 MN	40 MX 41 MN 40 MX 41 MN	40 MX 41 MN 40 MX 41 MN	40 MX 41 MN 40 MX 41 MN	40 MX 41 MN 40 MX 41 MN	GRANULAR SOILS	SILT-CLAY SOILS	MUCK, PEAT		MATERIAL PASSING #40 LL PI											SOILS WITH LITTLE OR MODERATE AMOUNTS OF ORGANIC MATTER					GROUP INDEX	0					0					4 MX 8 MX 12 MX 16 MX NO MX					USUAL TYPES OF MAJOR MATERIALS	STONE FRAGS. GRAVEL, AND SAND		FINE SAND		SILTY OR CLAYEY GRAVEL AND SAND		SILTY SOILS		CLAYEY SOILS		HIGHLY ORGANIC SOILS					GEN. RATING AS SUBGRADE	EXCELLENT TO GOOD					FAIR TO POOR					FAIR TO POOR	POOR	UNSATURABLE		PI OF A-7-5 SUBGROUP IS ≤ LL - 30 ; PI OF A-7-6 SUBGROUP IS > LL - 30																				<p style="text-align: center;"><b>MINERALOGICAL COMPOSITION</b></p> <p>MINERAL NAMES SUCH AS QUARTZ, FELDSPAR, MICA, TALC, KAOLIN, ETC. ARE USED IN DESCRIPTIONS WHEN THEY ARE CONSIDERED OF SIGNIFICANCE.</p>										<p style="text-align: center;"><b>WEATHERING</b></p> <p>FRESH: ROCK FRESH, CRYSTALS BRIGHT, FEW JOINTS MAY SHOW SLIGHT STAINING. ROCK RINGS UNDER HAMMER IF CRYSTALLINE.</p> <p>VERY SLIGHT (IV SLI.): ROCK GENERALLY FRESH, JOINTS STAINED, SOME JOINTS MAY SHOW THIN CLAY COATINGS IF OPEN. CRYSTALS ON A BROKEN SPECIMEN FACE SHINE BRIGHTLY. ROCK RINGS UNDER HAMMER BLOWS IF OF A CRYSTALLINE NATURE.</p> <p>SLIGHT (SLI.): ROCK GENERALLY FRESH, JOINTS STAINED AND DISCOLORATION EXTENDS INTO ROCK UP TO 1 INCH. OPEN JOINTS MAY CONTAIN CLAY. IN GRANITOID ROCKS SOME OCCASIONAL FELDSPAR CRYSTALS ARE DULL AND DISCOLORED. CRYSTALLINE ROCKS RING UNDER HAMMER BLOWS.</p> <p>MODERATE (MOD.): SIGNIFICANT PORTIONS OF ROCK SHOW DISCOLORATION AND WEATHERING EFFECTS. IN GRANITOID ROCKS, MOST FELDSPARS ARE DULL AND DISCOLORED, SOME SHOW CLAY. ROCK HAS DULL SOUND UNDER HAMMER BLOWS AND SHOWS SIGNIFICANT LOSS OF STRENGTH AS COMPARED WITH FRESH ROCK.</p> <p>MODERATELY SEVERE (MOD. SEV.): ALL ROCK EXCEPT QUARTZ DISCOLORED OR STAINED. IN GRANITOID ROCKS, ALL FELDSPARS DULL AND DISCOLORED AND A MAJORITY SHOW KAOLINIZATION. ROCK SHOWS SEVERE LOSS OF STRENGTH AND CAN BE EXCAVATED WITH A GEOLOGIST'S PICK. ROCK GIVES "CLUNK" SOUND WHEN STRUCK. <i>IF TESTED, WOULD YIELD SPT REFUSAL</i></p> <p>SEVERE (SEV.): ALL ROCK EXCEPT QUARTZ DISCOLORED OR STAINED. ROCK FABRIC CLEAR AND EVIDENT BUT REDUCED IN STRENGTH TO STRONG SOIL. IN GRANITOID ROCKS ALL FELDSPARS ARE KAOLINIZED TO SOME EXTENT. SOME FRAGMENTS OF STRONG ROCK USUALLY REMAIN. <i>IF TESTED, WOULD YIELD SPT N VALUES &gt; 100 BPF</i></p> <p>VERY SEVERE (IV SEV.): ALL ROCK EXCEPT QUARTZ DISCOLORED OR STAINED. ROCK FABRIC ELEMENTS ARE DISCERNIBLE BUT MASS IS EFFECTIVELY REDUCED TO SOIL STATUS, WITH ONLY FRAGMENTS OF STRONG ROCK REMAINING. SAPROLITE IS AN EXAMPLE OF ROCK WEATHERED TO A DEGREE THAT ONLY MINOR VESTIGES OF ORIGINAL ROCK FABRIC REMAIN. <i>IF TESTED, WOULD YIELD SPT N VALUES &lt; 100 BPF</i></p> <p>COMPLETE: ROCK REDUCED TO SOIL. ROCK FABRIC NOT DISCERNIBLE, OR DISCERNIBLE ONLY IN SMALL AND SCATTERED CONCENTRATIONS. QUARTZ MAY BE PRESENT AS DIKES OR STRINGERS. SAPROLITE IS ALSO AN EXAMPLE.</p>										<p style="text-align: center;"><b>PERCENTAGE OF MATERIAL</b></p> <table border="1" style="width: 100%; border-collapse: collapse;"> <tr> <th>ORGANIC MATERIAL</th> <th>GRANULAR SOILS</th> <th>SILT - CLAY SOILS</th> <th>OTHER MATERIAL</th> </tr> <tr> <td>TRACE OF ORGANIC MATTER</td> <td>2 - 3%</td> <td>3 - 5%</td> <td>TRACE 1 - 10%</td> </tr> <tr> <td>LITTLE ORGANIC MATTER</td> <td>3 - 5%</td> <td>5 - 12%</td> <td>LITTLE 10 - 20%</td> </tr> <tr> <td>MODERATELY ORGANIC</td> <td>5 - 10%</td> <td>12 - 20%</td> <td>SOME 20 - 35%</td> </tr> <tr> <td>HIGHLY ORGANIC</td> <td>&gt; 10%</td> <td>&gt; 20%</td> <td>HIGHLY 35% AND ABOVE</td> </tr> </table>										ORGANIC MATERIAL	GRANULAR SOILS	SILT - CLAY SOILS	OTHER MATERIAL	TRACE OF ORGANIC MATTER	2 - 3%	3 - 5%	TRACE 1 - 10%	LITTLE ORGANIC MATTER	3 - 5%	5 - 12%	LITTLE 10 - 20%	MODERATELY ORGANIC	5 - 10%	12 - 20%	SOME 20 - 35%	HIGHLY ORGANIC	> 10%	> 20%	HIGHLY 35% AND ABOVE
GENERAL CLASS.	GRANULAR MATERIALS (≤ 35% PASSING #200)					SILT-CLAY MATERIALS (> 35% PASSING #200)					ORGANIC MATERIALS																																																																																																																																																																																																																		
	A-1	A-3	A-2	A-4	A-5	A-6	A-7	A-1, A-2	A-3	A-4, A-5	A-6, A-7																																																																																																																																																																																																																		
GROUP CLASS.	A-1-a	A-1-b	A-2-4	A-2-5	A-2-6	A-2-7	A-4	A-5	A-6	A-7	A-1, A-2	A-3	A-4, A-5	A-6, A-7																																																																																																																																																																																																															
SYMBOL	[Pattern]					[Pattern]					[Pattern]																																																																																																																																																																																																																		
% PASSING #10 #40 #200	50 MX 30 MX 15 MX	50 MX 25 MX	51 MN 35 MX 35 MX	40 MX 41 MN 10 MX 11 MN	40 MX 41 MN 11 MN 11 MN	40 MX 41 MN 11 MN 11 MN	36 MN 36 MN 36 MN	40 MX 41 MN 40 MX 41 MN	40 MX 41 MN 40 MX 41 MN	40 MX 41 MN 40 MX 41 MN	40 MX 41 MN 40 MX 41 MN	GRANULAR SOILS	SILT-CLAY SOILS	MUCK, PEAT																																																																																																																																																																																																															
MATERIAL PASSING #40 LL PI											SOILS WITH LITTLE OR MODERATE AMOUNTS OF ORGANIC MATTER																																																																																																																																																																																																																		
GROUP INDEX	0					0					4 MX 8 MX 12 MX 16 MX NO MX																																																																																																																																																																																																																		
USUAL TYPES OF MAJOR MATERIALS	STONE FRAGS. GRAVEL, AND SAND		FINE SAND		SILTY OR CLAYEY GRAVEL AND SAND		SILTY SOILS		CLAYEY SOILS		HIGHLY ORGANIC SOILS																																																																																																																																																																																																																		
GEN. RATING AS SUBGRADE	EXCELLENT TO GOOD					FAIR TO POOR					FAIR TO POOR	POOR	UNSATURABLE																																																																																																																																																																																																																
PI OF A-7-5 SUBGROUP IS ≤ LL - 30 ; PI OF A-7-6 SUBGROUP IS > LL - 30																																																																																																																																																																																																																													
ORGANIC MATERIAL	GRANULAR SOILS	SILT - CLAY SOILS	OTHER MATERIAL																																																																																																																																																																																																																										
TRACE OF ORGANIC MATTER	2 - 3%	3 - 5%	TRACE 1 - 10%																																																																																																																																																																																																																										
LITTLE ORGANIC MATTER	3 - 5%	5 - 12%	LITTLE 10 - 20%																																																																																																																																																																																																																										
MODERATELY ORGANIC	5 - 10%	12 - 20%	SOME 20 - 35%																																																																																																																																																																																																																										
HIGHLY ORGANIC	> 10%	> 20%	HIGHLY 35% AND ABOVE																																																																																																																																																																																																																										
<p style="text-align: center;"><b>CONSISTENCY OR DENSENESS</b></p> <table border="1" style="width: 100%; border-collapse: collapse;"> <tr> <th>PRIMARY SOIL TYPE</th> <th>COMPACTNESS OR CONSISTENCY</th> <th>RANGE OF STANDARD PENETRATION RESISTANCE (N-VALUE)</th> <th>RANGE OF UNCONFINED COMPRESSIVE STRENGTH (TONS/FT<sup>2</sup>)</th> </tr> <tr> <td>GENERALLY GRANULAR MATERIAL (NON-COHESIVE)</td> <td>VERY LOOSE LOOSE MEDIUM DENSE DENSE VERY DENSE</td> <td>&lt; 4 4 TO 10 10 TO 30 30 TO 50 &gt; 50</td> <td>N/A</td> </tr> <tr> <td>GENERALLY SILT-CLAY MATERIAL (COHESIVE)</td> <td>VERY SOFT SOFT MEDIUM STIFF STIFF VERY STIFF HARD</td> <td>&lt; 2 2 TO 4 4 TO 8 8 TO 15 15 TO 30 &gt; 30</td> <td>&lt; 0.25 0.25 TO 0.5 0.5 TO 1.0 1 TO 2 2 TO 4 &gt; 4</td> </tr> </table>										PRIMARY SOIL TYPE	COMPACTNESS OR CONSISTENCY	RANGE OF STANDARD PENETRATION RESISTANCE (N-VALUE)	RANGE OF UNCONFINED COMPRESSIVE STRENGTH (TONS/FT <sup>2</sup> )	GENERALLY GRANULAR MATERIAL (NON-COHESIVE)	VERY LOOSE LOOSE MEDIUM DENSE DENSE VERY DENSE	< 4 4 TO 10 10 TO 30 30 TO 50 > 50	N/A	GENERALLY SILT-CLAY MATERIAL (COHESIVE)	VERY SOFT SOFT MEDIUM STIFF STIFF VERY STIFF HARD	< 2 2 TO 4 4 TO 8 8 TO 15 15 TO 30 > 30	< 0.25 0.25 TO 0.5 0.5 TO 1.0 1 TO 2 2 TO 4 > 4	<p style="text-align: center;"><b>GROUND WATER</b></p> <p>▽ WATER LEVEL IN BORE HOLE IMMEDIATELY AFTER DRILLING</p> <p>▽/24 STATIC WATER LEVEL AFTER 24 HOURS</p> <p>▽/PW PERCHED WATER, SATURATED ZONE, OR WATER BEARING STRATA</p> <p>○ SPRING OR SEEP</p>										<p style="text-align: center;"><b>MISCELLANEOUS SYMBOLS</b></p> <p>ROADWAY EMBANKMENT (RE) WITH SOIL DESCRIPTION</p> <p>SOIL SYMBOL</p> <p>ARTIFICIAL FILL (AF) OTHER THAN ROADWAY EMBANKMENT</p> <p>INFERRED SOIL BOUNDARY</p> <p>INFERRED ROCK LINE</p> <p>ALLUVIAL SOIL BOUNDARY</p> <p>DIP &amp; DIP DIRECTION OF ROCK STRUCTURES</p> <p>SPT TEST BORING</p> <p>AUGER BORING</p> <p>CORE BORING</p> <p>MONITORING WELL</p> <p>PIEZOMETER INSTALLATION</p> <p>SLOPE INDICATOR INSTALLATION</p> <p>CONE PENETROMETER TEST</p> <p>SOUNDING ROD</p> <p>TEST BORING WITH CORE</p> <p>SPT N-VALUE</p>																																																																																																																																																																																													
PRIMARY SOIL TYPE	COMPACTNESS OR CONSISTENCY	RANGE OF STANDARD PENETRATION RESISTANCE (N-VALUE)	RANGE OF UNCONFINED COMPRESSIVE STRENGTH (TONS/FT <sup>2</sup> )																																																																																																																																																																																																																										
GENERALLY GRANULAR MATERIAL (NON-COHESIVE)	VERY LOOSE LOOSE MEDIUM DENSE DENSE VERY DENSE	< 4 4 TO 10 10 TO 30 30 TO 50 > 50	N/A																																																																																																																																																																																																																										
GENERALLY SILT-CLAY MATERIAL (COHESIVE)	VERY SOFT SOFT MEDIUM STIFF STIFF VERY STIFF HARD	< 2 2 TO 4 4 TO 8 8 TO 15 15 TO 30 > 30	< 0.25 0.25 TO 0.5 0.5 TO 1.0 1 TO 2 2 TO 4 > 4																																																																																																																																																																																																																										
<p style="text-align: center;"><b>TEXTURE OR GRAIN SIZE</b></p> <table border="1" style="width: 100%; border-collapse: collapse;"> <tr> <th>U.S. STD. SIEVE SIZE OPENING (MM)</th> <td>4</td> <td>10</td> <td>40</td> <td>60</td> <td>200</td> <td>270</td> </tr> <tr> <td></td> <td>4.75</td> <td>2.00</td> <td>0.42</td> <td>0.25</td> <td>0.075</td> <td>0.053</td> </tr> <tr> <th>BOULDER (BLDR.)</th> <th>COBBLE (COB.)</th> <th>GRAVEL (GR.)</th> <th>COARSE SAND (CSE. SD.)</th> <th>FINE SAND (F SD.)</th> <th>SILT (SL.)</th> <th>CLAY (CL.)</th> </tr> <tr> <td>GRAIN SIZE</td> <td>MM 305</td> <td>75</td> <td>2.0</td> <td>0.25</td> <td>0.05</td> <td>0.005</td> </tr> <tr> <td></td> <td>IN. 12</td> <td>3</td> <td></td> <td></td> <td></td> <td></td> </tr> </table>										U.S. STD. SIEVE SIZE OPENING (MM)	4	10	40	60	200	270		4.75	2.00	0.42	0.25	0.075	0.053	BOULDER (BLDR.)	COBBLE (COB.)	GRAVEL (GR.)	COARSE SAND (CSE. SD.)	FINE SAND (F SD.)	SILT (SL.)	CLAY (CL.)	GRAIN SIZE	MM 305	75	2.0	0.25	0.05	0.005		IN. 12	3					<p style="text-align: center;"><b>RECOMMENDATION SYMBOLS</b></p> <p>UNDERCUT</p> <p>SHALLOW UNDERCUT</p> <p>UNCLASSIFIED EXCAVATION - UNSUITABLE WASTE</p> <p>UNCLASSIFIED EXCAVATION - ACCEPTABLE DEGRADABLE ROCK</p> <p>UNCLASSIFIED EXCAVATION - ACCEPTABLE, BUT NOT TO BE USED IN THE TOP 3 FEET OF EMBANKMENT OR BACKFILL</p>										<p style="text-align: center;"><b>ROCK HARDNESS</b></p> <p>VERY HARD: CANNOT BE SCRATCHED BY KNIFE OR SHARP PICK. BREAKING OF HAND SPECIMENS REQUIRES SEVERAL HARD BLOWS OF THE GEOLOGIST'S PICK.</p> <p>HARD: CAN BE SCRATCHED BY KNIFE OR PICK ONLY WITH DIFFICULTY. HARD HAMMER BLOWS REQUIRED TO DETACH HAND SPECIMEN.</p> <p>MODERATELY HARD: CAN BE SCRATCHED BY KNIFE OR PICK. GOUGES OR GROOVES TO 0.25 INCHES DEEP CAN BE EXCAVATED BY HARD BLOW OF A GEOLOGIST'S PICK. HAND SPECIMENS CAN BE DETACHED BY MODERATE BLOWS.</p> <p>MEDIUM HARD: CAN BE GROUDED OR GOUGED 0.05 INCHES DEEP BY FIRM PRESSURE OF KNIFE OR PICK POINT. CAN BE EXCAVATED IN SMALL CHIPS TO PIECES 1 INCH MAXIMUM SIZE BY HARD BLOWS OF THE POINT OF A GEOLOGIST'S PICK.</p> <p>SOFT: CAN BE GROUDED OR GOUGED READILY BY KNIFE OR PICK. CAN BE EXCAVATED IN FRAGMENTS FROM CHIPS TO SEVERAL INCHES IN SIZE BY MODERATE BLOWS OF A PICK POINT. SMALL, THIN PIECES CAN BE BROKEN BY FINGER PRESSURE.</p> <p>VERY SOFT: CAN BE CARVED WITH KNIFE. CAN BE EXCAVATED READILY WITH POINT OF PICK. PIECES 1 INCH OR MORE IN THICKNESS CAN BE BROKEN BY FINGER PRESSURE. CAN BE SCRATCHED READILY BY FINGER NAIL.</p>																																																																																																																																																																						
U.S. STD. SIEVE SIZE OPENING (MM)	4	10	40	60	200	270																																																																																																																																																																																																																							
	4.75	2.00	0.42	0.25	0.075	0.053																																																																																																																																																																																																																							
BOULDER (BLDR.)	COBBLE (COB.)	GRAVEL (GR.)	COARSE SAND (CSE. SD.)	FINE SAND (F SD.)	SILT (SL.)	CLAY (CL.)																																																																																																																																																																																																																							
GRAIN SIZE	MM 305	75	2.0	0.25	0.05	0.005																																																																																																																																																																																																																							
	IN. 12	3																																																																																																																																																																																																																											
<p style="text-align: center;"><b>SOIL MOISTURE - CORRELATION OF TERMS</b></p> <table border="1" style="width: 100%; border-collapse: collapse;"> <tr> <th>SOIL MOISTURE SCALE (ATTERBERG LIMITS)</th> <th>FIELD MOISTURE DESCRIPTION</th> <th>GUIDE FOR FIELD MOISTURE DESCRIPTION</th> </tr> <tr> <td>LL - LIQUID LIMIT</td> <td>- SATURATED - (SAT.)</td> <td>USUALLY LIQUID; VERY WET, USUALLY FROM BELOW THE GROUND WATER TABLE</td> </tr> <tr> <td>PL - PLASTIC LIMIT</td> <td>- WET - (W)</td> <td>SEMISOLID; REQUIRES DRYING TO ATTAIN OPTIMUM MOISTURE</td> </tr> <tr> <td>OM - OPTIMUM MOISTURE SHRINKAGE LIMIT</td> <td>- MOIST - (M)</td> <td>SOLID; AT OR NEAR OPTIMUM MOISTURE</td> </tr> <tr> <td>SL - SHRINKAGE LIMIT</td> <td>- DRY - (D)</td> <td>REQUIRES ADDITIONAL WATER TO ATTAIN OPTIMUM MOISTURE</td> </tr> </table>										SOIL MOISTURE SCALE (ATTERBERG LIMITS)	FIELD MOISTURE DESCRIPTION	GUIDE FOR FIELD MOISTURE DESCRIPTION	LL - LIQUID LIMIT	- SATURATED - (SAT.)	USUALLY LIQUID; VERY WET, USUALLY FROM BELOW THE GROUND WATER TABLE	PL - PLASTIC LIMIT	- WET - (W)	SEMISOLID; REQUIRES DRYING TO ATTAIN OPTIMUM MOISTURE	OM - OPTIMUM MOISTURE SHRINKAGE LIMIT	- MOIST - (M)	SOLID; AT OR NEAR OPTIMUM MOISTURE	SL - SHRINKAGE LIMIT	- DRY - (D)	REQUIRES ADDITIONAL WATER TO ATTAIN OPTIMUM MOISTURE	<p style="text-align: center;"><b>ABBREVIATIONS</b></p> <p>AR - AUGER REFUSAL  BT - BORING TERMINATED  CL - CLAY  CPT - CONE PENETRATION TEST  CSE - COARSE  DMT - DILATOMETER TEST  DPT - DYNAMIC PENETRATION TEST  e - VOID RATIO  F - FINE  FOSS. - FOSSILIFEROUS  FRAC. - FRACTURED, FRACTURES  FRAGS. - FRAGMENTS  HI. - HIGHLY</p> <p>MED. - MEDIUM  MICA - MICACEOUS  MOD. - MODERATELY  NP - NON PLASTIC  ORG. - ORGANIC  PMT - PRESSUREMETER TEST  SAP. - SAPROLITIC  SD. - SAND, SANDY  SL. - SILT, SILTY  SLI. - SLIGHTLY  TCR - TRICONE REFUSAL  w - MOISTURE CONTENT  V - VERY</p> <p>VST - VANE SHEAR TEST  WEA. - WEATHERED  U - UNIT WEIGHT  U<sub>G</sub> - DRY UNIT WEIGHT</p> <p>SAMPLE ABBREVIATIONS  S - BULK  SS - SPLIT SPOON  ST - SHELBY TUBE  RS - ROCK  RT - RECOMPACTED TRIAXIAL  CBR - CALIFORNIA BEARING RATIO</p>																																																																																																																																																																																																				
SOIL MOISTURE SCALE (ATTERBERG LIMITS)	FIELD MOISTURE DESCRIPTION	GUIDE FOR FIELD MOISTURE DESCRIPTION																																																																																																																																																																																																																											
LL - LIQUID LIMIT	- SATURATED - (SAT.)	USUALLY LIQUID; VERY WET, USUALLY FROM BELOW THE GROUND WATER TABLE																																																																																																																																																																																																																											
PL - PLASTIC LIMIT	- WET - (W)	SEMISOLID; REQUIRES DRYING TO ATTAIN OPTIMUM MOISTURE																																																																																																																																																																																																																											
OM - OPTIMUM MOISTURE SHRINKAGE LIMIT	- MOIST - (M)	SOLID; AT OR NEAR OPTIMUM MOISTURE																																																																																																																																																																																																																											
SL - SHRINKAGE LIMIT	- DRY - (D)	REQUIRES ADDITIONAL WATER TO ATTAIN OPTIMUM MOISTURE																																																																																																																																																																																																																											
<p style="text-align: center;"><b>PLASTICITY</b></p> <table border="1" style="width: 100%; border-collapse: collapse;"> <tr> <th>NON PLASTIC</th> <th colspan="2">PLASTICITY INDEX (PI)</th> <th>DRY STRENGTH</th> </tr> <tr> <td>SLIGHTLY PLASTIC</td> <td>0-5</td> <td></td> <td>VERY LOW</td> </tr> <tr> <td>MODERATELY PLASTIC</td> <td>6-15</td> <td></td> <td>SLIGHT</td> </tr> <tr> <td>HIGHLY PLASTIC</td> <td>16-25</td> <td></td> <td>MEDIUM</td> </tr> <tr> <td></td> <td>26 OR MORE</td> <td></td> <td>HIGH</td> </tr> </table>										NON PLASTIC	PLASTICITY INDEX (PI)		DRY STRENGTH	SLIGHTLY PLASTIC	0-5		VERY LOW	MODERATELY PLASTIC	6-15		SLIGHT	HIGHLY PLASTIC	16-25		MEDIUM		26 OR MORE		HIGH	<p style="text-align: center;"><b>EQUIPMENT USED ON SUBJECT PROJECT</b></p> <p>DRILL UNITS:  <input type="checkbox"/> CME-45C  <input type="checkbox"/> CME-55  <input type="checkbox"/> CME-550X  <input type="checkbox"/> VANE SHEAR TEST  <input type="checkbox"/> PORTABLE HOIST  <input checked="" type="checkbox"/> DIEDRICH D50</p> <p>ADVANCING TOOLS:  <input type="checkbox"/> CLAY BITS  <input type="checkbox"/> 6" CONTINUOUS FLIGHT AUGER  <input checked="" type="checkbox"/> 8" HOLLOW AUGERS  <input type="checkbox"/> HARD FACED FINGER BITS  <input type="checkbox"/> TUNG-CARBIDE INSERTS  <input type="checkbox"/> CASING <input type="checkbox"/> W/ ADVANCER  <input type="checkbox"/> TRICONE * STEEL TEETH  <input type="checkbox"/> TRICONE * TUNG-CARB.  <input type="checkbox"/> CORE BIT</p> <p>HAMMER TYPE:  <input checked="" type="checkbox"/> AUTOMATIC <input type="checkbox"/> MANUAL</p> <p>CORE SIZE:  <input type="checkbox"/> -B <input type="checkbox"/> -H <input type="checkbox"/> -N</p> <p>HAND TOOLS:  <input type="checkbox"/> POST HOLE DIGGER  <input type="checkbox"/> HAND AUGER  <input type="checkbox"/> SOUNDING ROD  <input type="checkbox"/> VANE SHEAR TEST</p>																																																																																																																																																																																															
NON PLASTIC	PLASTICITY INDEX (PI)		DRY STRENGTH																																																																																																																																																																																																																										
SLIGHTLY PLASTIC	0-5		VERY LOW																																																																																																																																																																																																																										
MODERATELY PLASTIC	6-15		SLIGHT																																																																																																																																																																																																																										
HIGHLY PLASTIC	16-25		MEDIUM																																																																																																																																																																																																																										
	26 OR MORE		HIGH																																																																																																																																																																																																																										
<p style="text-align: center;"><b>FRACATURE SPACING</b></p> <table border="1" style="width: 100%; border-collapse: collapse;"> <tr> <th>TERM</th> <th>SPACING</th> </tr> <tr> <td>VERY WIDE</td> <td>MORE THAN 10 FEET</td> </tr> <tr> <td>WIDE</td> <td>3 TO 10 FEET</td> </tr> <tr> <td>MODERATELY CLOSE</td> <td>1 TO 3 FEET</td> </tr> <tr> <td>CLOSE</td> <td>0.16 TO 1 FOOT</td> </tr> <tr> <td>VERY CLOSE</td> <td>LESS THAN 0.16 FEET</td> </tr> </table>										TERM	SPACING	VERY WIDE	MORE THAN 10 FEET	WIDE	3 TO 10 FEET	MODERATELY CLOSE	1 TO 3 FEET	CLOSE	0.16 TO 1 FOOT	VERY CLOSE	LESS THAN 0.16 FEET	<p style="text-align: center;"><b>BEDDING</b></p> <table border="1" style="width: 100%; border-collapse: collapse;"> <tr> <th>TERM</th> <th>THICKNESS</th> </tr> <tr> <td>VERY THICKLY BEDDED</td> <td>4 FEET</td> </tr> <tr> <td>THICKLY BEDDED</td> <td>1.5 - 4 FEET</td> </tr> <tr> <td>THINLY BEDDED</td> <td>0.16 - 1.5 FEET</td> </tr> <tr> <td>VERY THINLY BEDDED</td> <td>0.03 - 0.16 FEET</td> </tr> <tr> <td>THICKLY LAMINATED</td> <td>0.008 - 0.03 FEET</td> </tr> <tr> <td>THINLY LAMINATED</td> <td>&lt; 0.008 FEET</td> </tr> </table>										TERM	THICKNESS	VERY THICKLY BEDDED	4 FEET	THICKLY BEDDED	1.5 - 4 FEET	THINLY BEDDED	0.16 - 1.5 FEET	VERY THINLY BEDDED	0.03 - 0.16 FEET	THICKLY LAMINATED	0.008 - 0.03 FEET	THINLY LAMINATED	< 0.008 FEET																																																																																																																																																																																
TERM	SPACING																																																																																																																																																																																																																												
VERY WIDE	MORE THAN 10 FEET																																																																																																																																																																																																																												
WIDE	3 TO 10 FEET																																																																																																																																																																																																																												
MODERATELY CLOSE	1 TO 3 FEET																																																																																																																																																																																																																												
CLOSE	0.16 TO 1 FOOT																																																																																																																																																																																																																												
VERY CLOSE	LESS THAN 0.16 FEET																																																																																																																																																																																																																												
TERM	THICKNESS																																																																																																																																																																																																																												
VERY THICKLY BEDDED	4 FEET																																																																																																																																																																																																																												
THICKLY BEDDED	1.5 - 4 FEET																																																																																																																																																																																																																												
THINLY BEDDED	0.16 - 1.5 FEET																																																																																																																																																																																																																												
VERY THINLY BEDDED	0.03 - 0.16 FEET																																																																																																																																																																																																																												
THICKLY LAMINATED	0.008 - 0.03 FEET																																																																																																																																																																																																																												
THINLY LAMINATED	< 0.008 FEET																																																																																																																																																																																																																												
<p style="text-align: center;"><b>INDURATION</b></p> <p>FOR SEDIMENTARY ROCKS, INDURATION IS THE HARDENING OF MATERIAL BY CEMENTING, HEAT, PRESSURE, ETC.</p> <p>FRIABLE: RUBBING WITH FINGER FREES NUMEROUS GRAINS; GENTLE BLOW BY HAMMER DISINTEGRATES SAMPLE.</p> <p>MODERATELY INDURATED: GRAINS CAN BE SEPARATED FROM SAMPLE WITH STEEL PROBE; BREAKS EASILY WHEN HIT WITH HAMMER.</p> <p>INDURATED: GRAINS ARE DIFFICULT TO SEPARATE WITH STEEL PROBE; DIFFICULT TO BREAK WITH HAMMER.</p> <p>EXTREMELY INDURATED: SHARP HAMMER BLOWS REQUIRED TO BREAK SAMPLE; SAMPLE BREAKS ACROSS GRAINS.</p>										<p style="text-align: center;"><b>NOTES:</b></p> <p>SURVEY AND ROADWAY DESIGN FILES PROVIDED BY TGS ENGINEERS ON 11/15/2021</p>																																																																																																																																																																																																																			
<p style="text-align: center;"><b>COLOR</b></p> <p>DESCRIPTIONS MAY INCLUDE COLOR OR COLOR COMBINATIONS (TAN, RED, YELLOW-BROWN, BLUE-BROWN). MODIFIERS SUCH AS LIGHT, DARK, STREAKED, ETC. ARE USED TO DESCRIBE APPEARANCE.</p>										<p style="text-align: center;"><b>ELEVATION: FEET</b></p>																																																																																																																																																																																																																			

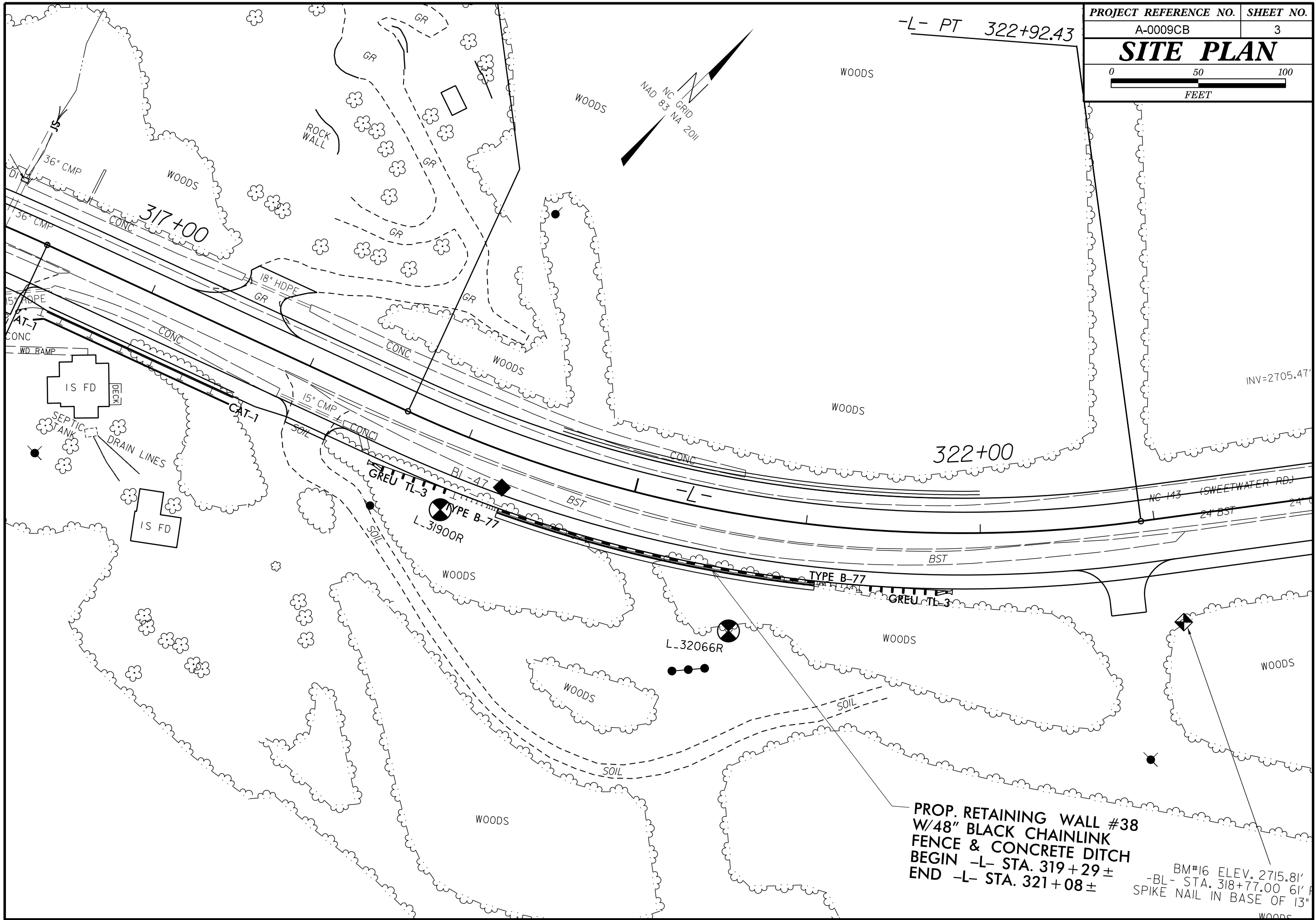

**PROP. RETAINING WALL #38**  
**W/48" BLACK CHAINLINK**  
**FENCE & CONCRETE DITCH**  
**BEGIN -L- STA. 319+29±**  
**END -L- STA. 321+08±**

BM#16 ELEV. 2715.81'  
 -BL- STA. 318+77.00 61'  
 SPIKE NAIL IN BASE OF 13"

INV=2705.47'

NC 143 (SWEETWATER RD)  
 24" BST



Prepared in the Office of:



CAROLINAS  
GEOTECHNICAL  
GROUP

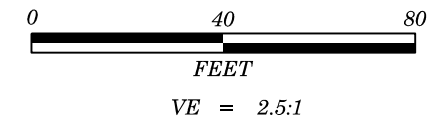

PROJECT REFERENCE NO.	SHEET NO.
A-0009CB	4
RETAINING WALL #38 PROFILE BORINGS PROJECTED ALONG WALL ENVELOPE	

## SOIL TEST RESULTS

SAMPLE NO.	OFFSET	STATION	DEPTH INTERVAL	AASHTO CLASS.	L.L.	P.I.	% BY WEIGHT				% PASSING (SIEVES)			% MOISTURE	% ORGANIC
							C. SAND	F. SAND	SILT	CLAY	10	40	200		
SS-779	45' RT	319+00 -L-	3.5' - 5.0'	A-4(4)	30	9	17	25	27	31	100	89	65	18	-
SS-774	67' RT	320+66 -L-	23.5' - 25.0'	A-4(0)	10	NP	19	43	30	8	100	89	50	15	-

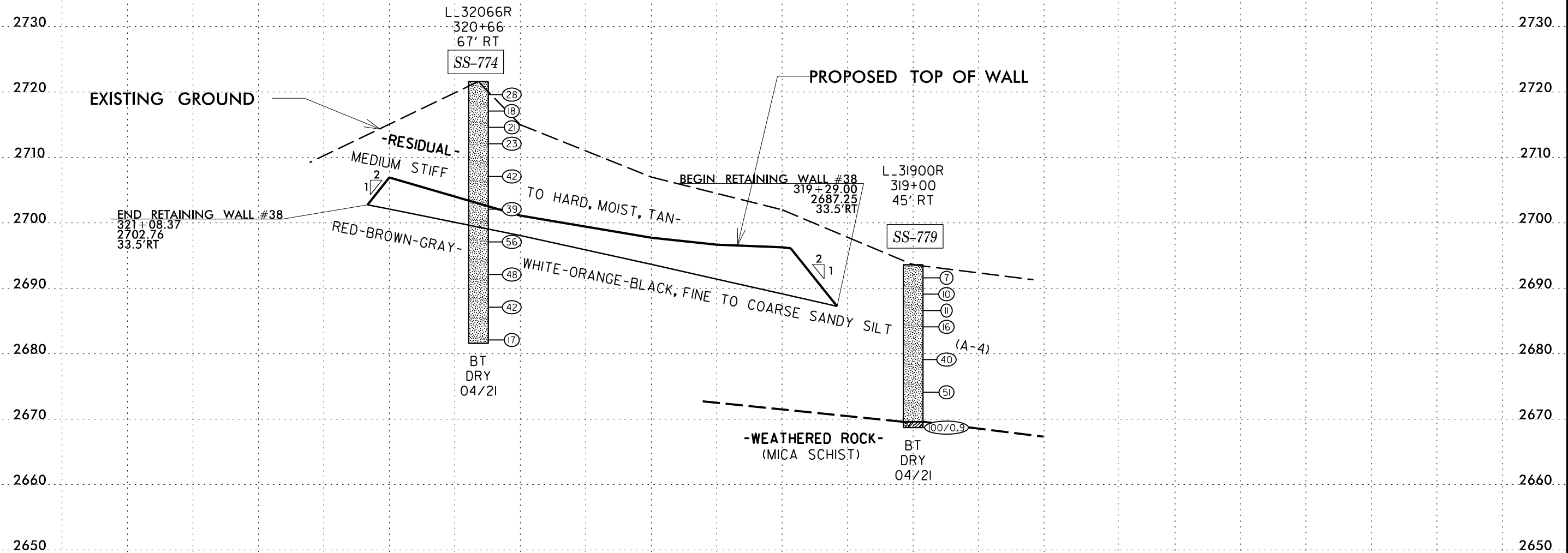

WALL ENVELOPE TAKEN FROM ROADWAY DESIGN PLANS PROVIDED BY TGS ENGINEERS ON 11/15/21.  
INFERRED STRATIGRAPHY IS DRAWN THROUGH THE BORING WITH BOTH PROJECTED ONTO THE  
PROFILE. EXISTING GROUND LINE IS DRAWN BORING TO BORING.

6/23/16  
 C:\Users\jbruner\OneDrive - Carolines Geotechnical Group, PLLC\Projects\0068 - A-0009CB - Future US 74\_TGS\A-0009CB\CADD\_GEO\TECH\Site\Sub\A-0009CB\_GEO\_RWAL\_38.XSI.dgn

75 70 65 60 55 50 45 40 35 30 25 20 15 10 5 0 5 10 15 20 25 30 35 40 45 50 55 60 65 70 75

## SOIL TEST RESULTS

SAMPLE NO.	OFFSET	STATION	DEPTH INTERVAL	AASHTO CLASS.	L.L.	P.I.	% BY WEIGHT				% PASSING (SIEVES)			% MOISTURE	% ORGANIC
							C. SAND	F. SAND	SILT	CLAY	10	40	200		
SS-779	45' RT	319+00 -L-	3.5' - 5.0'	A-4(4)	30	9	17	25	27	31	100	89	65	18	-

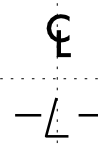
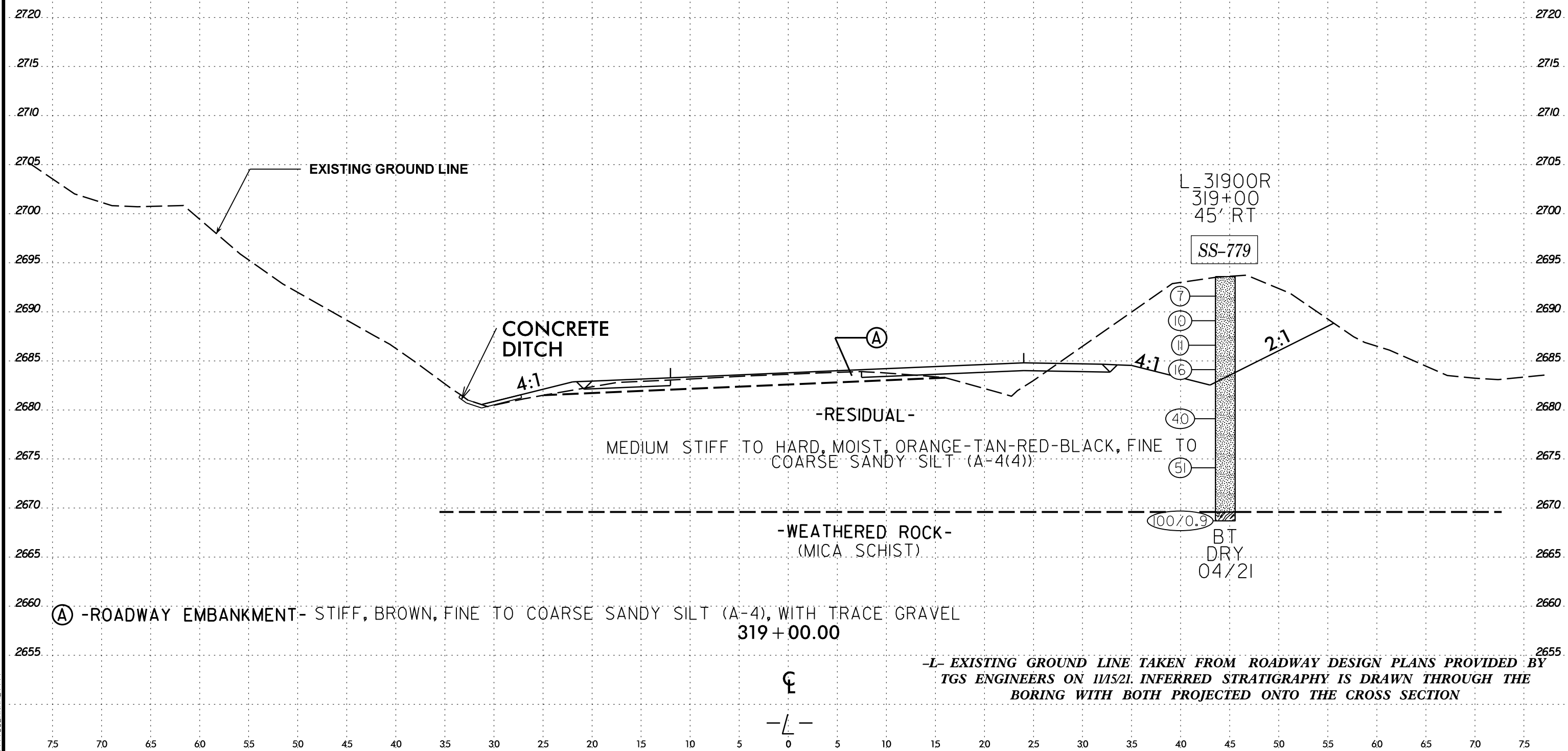

75 70 65 60 55 50 45 40 35 30 25 20 15 10 5 0 5 10 15 20 25 30 35 40 45 50 55 60 65 70 75

# SOIL TEST RESULTS

SAMPLE NO.	OFFSET	STATION	DEPTH INTERVAL	AASHTO CLASS.	L.L.	P.I.	% BY WEIGHT				% PASSING (SIEVES)			% MOISTURE	% ORGANIC
							C. SAND	F. SAND	SILT	CLAY	10	40	200		
SS-774	67' RT	320+66 -L-	23.5' - 25.0'	A-4(0)	10	NP	19	43	30	8	100	89	50	15	-

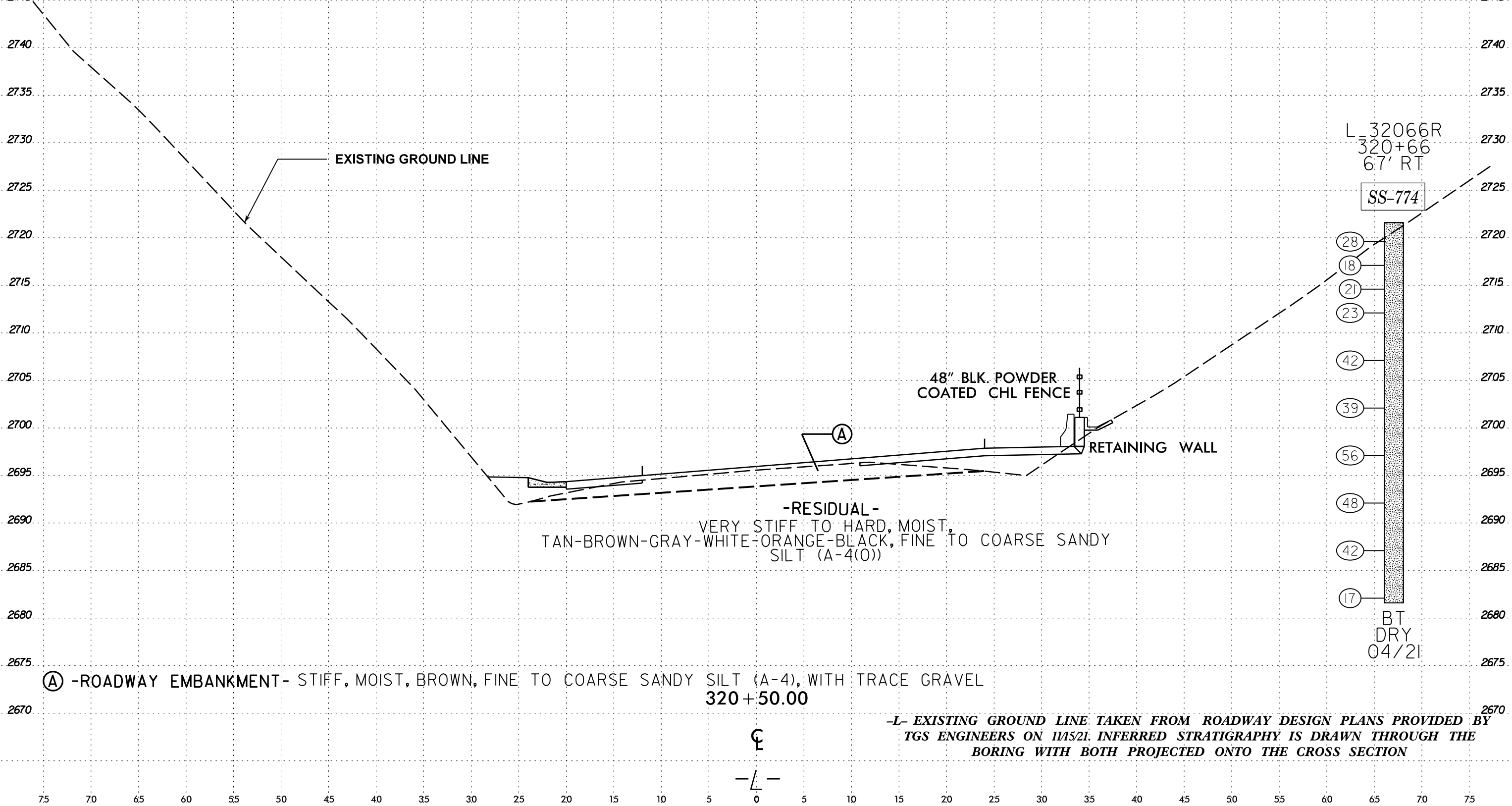

L 32066R  
 320+66  
 67' RT  
 SS-774

48" BLK. POWDER  
 COATED CHL FENCE

RETAINING WALL

-RESIDUAL-  
 VERY STIFF TO HARD, MOIST,  
 TAN-BROWN-GRAY-WHITE-ORANGE-BLACK, FINE TO COARSE SANDY  
 SILT (A-4(0))

(A) -ROADWAY EMBANKMENT- STIFF, MOIST, BROWN, FINE TO COARSE SANDY SILT (A-4), WITH TRACE GRAVEL  
 320+50.00

-L- EXISTING GROUND LINE TAKEN FROM ROADWAY DESIGN PLANS PROVIDED BY  
 TGS ENGINEERS ON 11/5/21. INFERRED STRATIGRAPHY IS DRAWN THROUGH THE  
 BORING WITH BOTH PROJECTED ONTO THE CROSS SECTION

02-MAY-2022 12:41  
 C:\Users\mreiner\OneDrive - Carolines Geotechnical Group, PLLC\Projects\0068 - A-0009CB - Future US 74\_TGS\A-0009CB\CADD\GEO\TECH\Site\Sub\A-0009CB.GEO\_RWAL\_38.XSI.dgn  
 \$\$\$USERNAME\$\$\$

