

# RETAINING WALL #17: 370

375

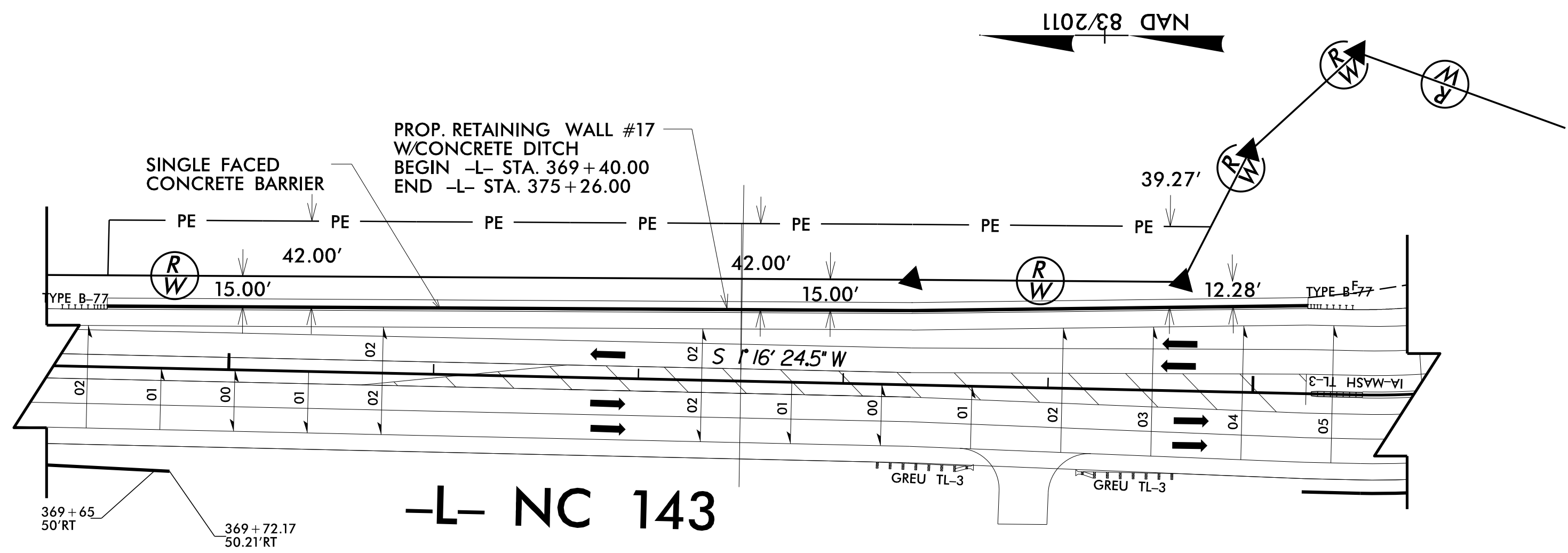

-L- NC 143

**RETAINING WALL #17 - PLAN**  
NOT TO SCALE

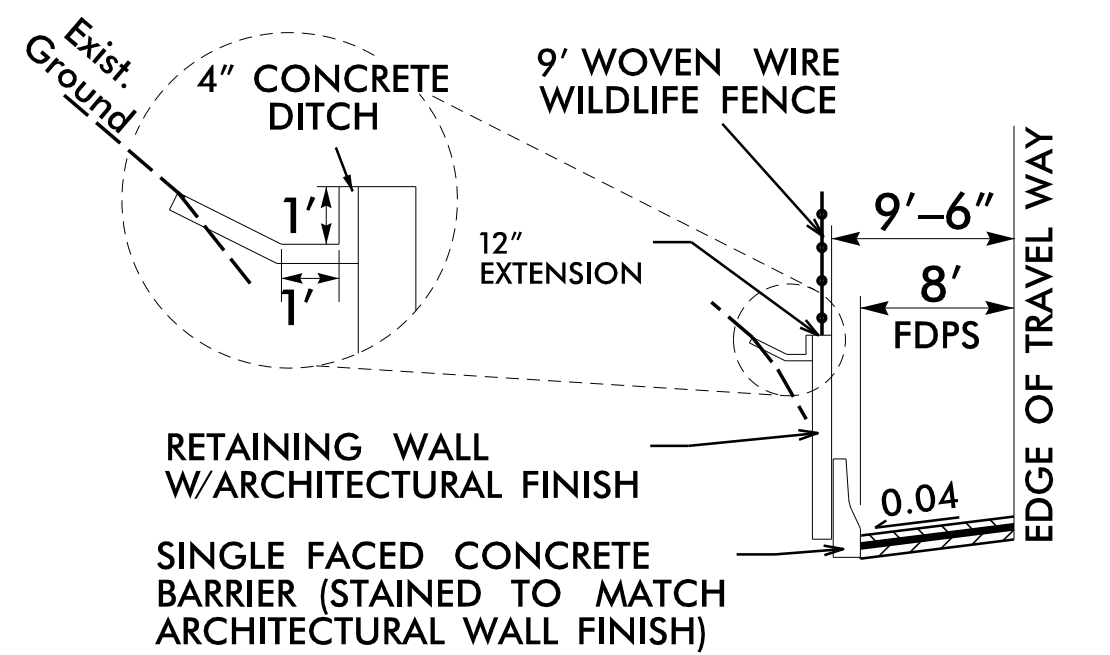

**DETAIL FOR WALL #17**  
NOT TO SCALE  
-L- STA. 369+40.00 TO -L- STA. 375+26.00, LT

THE WALL ENVELOPE DOES NOT ACCURATELY DEPICT THE ACTUAL WALL FACE OF WALL #17 AT THE FOLLOWING LOCATION:  
-L- STA. 369+40.00 TO 375+26.00, LT

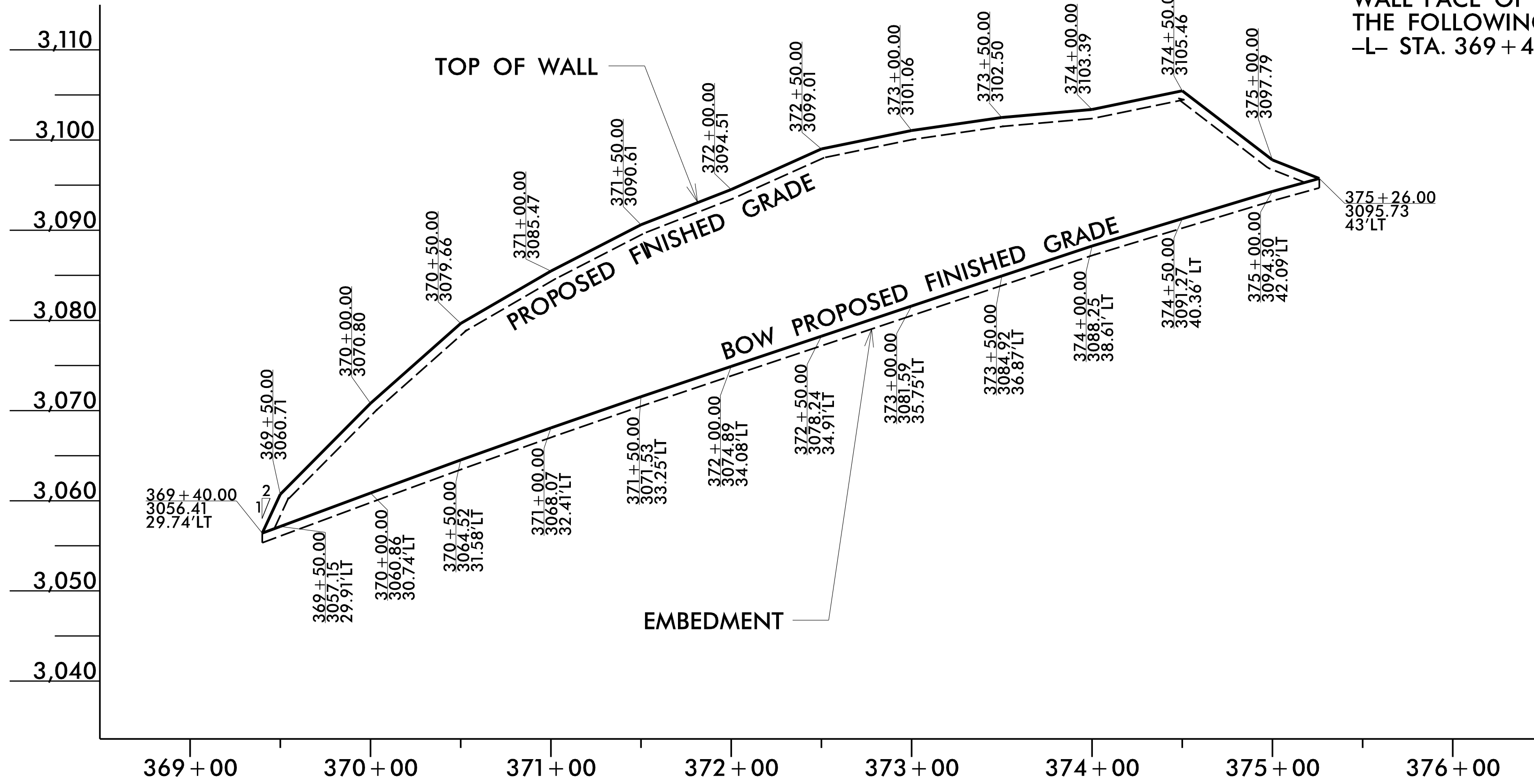

**RETAINING WALL #17 - ENVELOPE**

NOT TO SCALE  
BOW = BOTTOM OF WALL (LOOKING AT FACE OF WALL)

ESTIMATED SOIL NAIL WALL QUANTITIES			
RETAINING WALL NO.	SOIL NAIL RETAINING WALLS (SQ. FEET)	SOIL NAIL VERIFICATION TESTS	SOIL NAIL PROOF TESTS
17	9,280*	5	45
FORM LINER ARCHITECTURAL FINISH			9,280* SF
HORIZONTAL DRAINS (CONTINGENCY)			295 LF

\* INCLUDES RETAINING WALL EMBEDMENT

SOIL NAIL RETAINING WALL #17						
STA. -L-	OFFSET FROM -L- (LT) FT.	ELEV. @ TOP OF WALL	BOW PROPOSED FINISHED GRADE	TOP OF LEVELING PAD	ESTIMATED WALL EMBEDMENT FT.	WALL DESIGN HEIGHT "H"
369+40.00	29.74	3056.41	3056.41	3055.41	1.00	1.00
369+50.00	29.91	3060.71	3057.15	3056.15	1.00	3.56
370+00.00	30.74	3070.80	3060.86	3059.86	1.00	9.94
370+50.00	31.58	3079.66	3064.52	3063.52	1.00	15.14
371+00.00	32.41	3085.47	3068.07	3067.07	1.00	17.40
371+50.00	33.25	3090.61	3071.53	3070.53	1.00	19.08
372+00.00	34.08	3094.51	3074.89	3073.89	1.00	19.62
372+50.00	34.91	3099.01	3078.24	3077.24	1.00	20.77
373+00.00	35.75	3101.06	3081.59	3080.59	1.00	19.47
373+50.00	36.87	3102.50	3084.92	3083.92	1.00	17.58
374+00.00	38.61	3103.39	3088.25	3087.25	1.00	15.14
374+50.00	40.36	3105.46	3091.27	3090.27	1.00	14.19
375+00.00	42.09	3097.79	3094.30	3093.30	1.00	3.49
375+26.00	43.00	3095.73	3095.73	3094.73	1.00	1.00

PROJECT NO.: A-0009CB  
GRAHAM COUNTY  
RETAINING WALL #17: -L- 369+40, 30' LT TO 375+26, 43' LT  
SHEET 1 OF 3

PREPARED BY: R. KRAL  
REVIEWED BY: M. BREWER

DATE: 6/2/2022  
DATE: 6/2/2022  
RETAINING WALL #17 ENVELOPE AND WALL LAYOUT PROVIDED BY TGS ENGINEERS, INC.

Prepared in the Office of:  
**CGE CAROLINAS GEOTECHNICAL GROUP**  
2400 CROWNPOINT EXECUTIVE DRIVE SUITE 800  
CHARLOTTE, NC 28227  
(980) 339-8684

**NORTH CAROLINA DEPARTMENT OF TRANSPORTATION DIVISION OF HIGHWAYS**  
**GEOTECHNICAL ENGINEERING UNIT**

REVISIONS						SHEET NO.
NO.	BY	DATE	NO.	BY	DATE	
1			3			W17-1
2			4			