

# RETAINING WALL #12:

PROP. RETAINING WALL #12  
W/CONCRETE DITCH  
BEGIN -L- STA. 341+76.20  
END -L- STA. 344+10.55

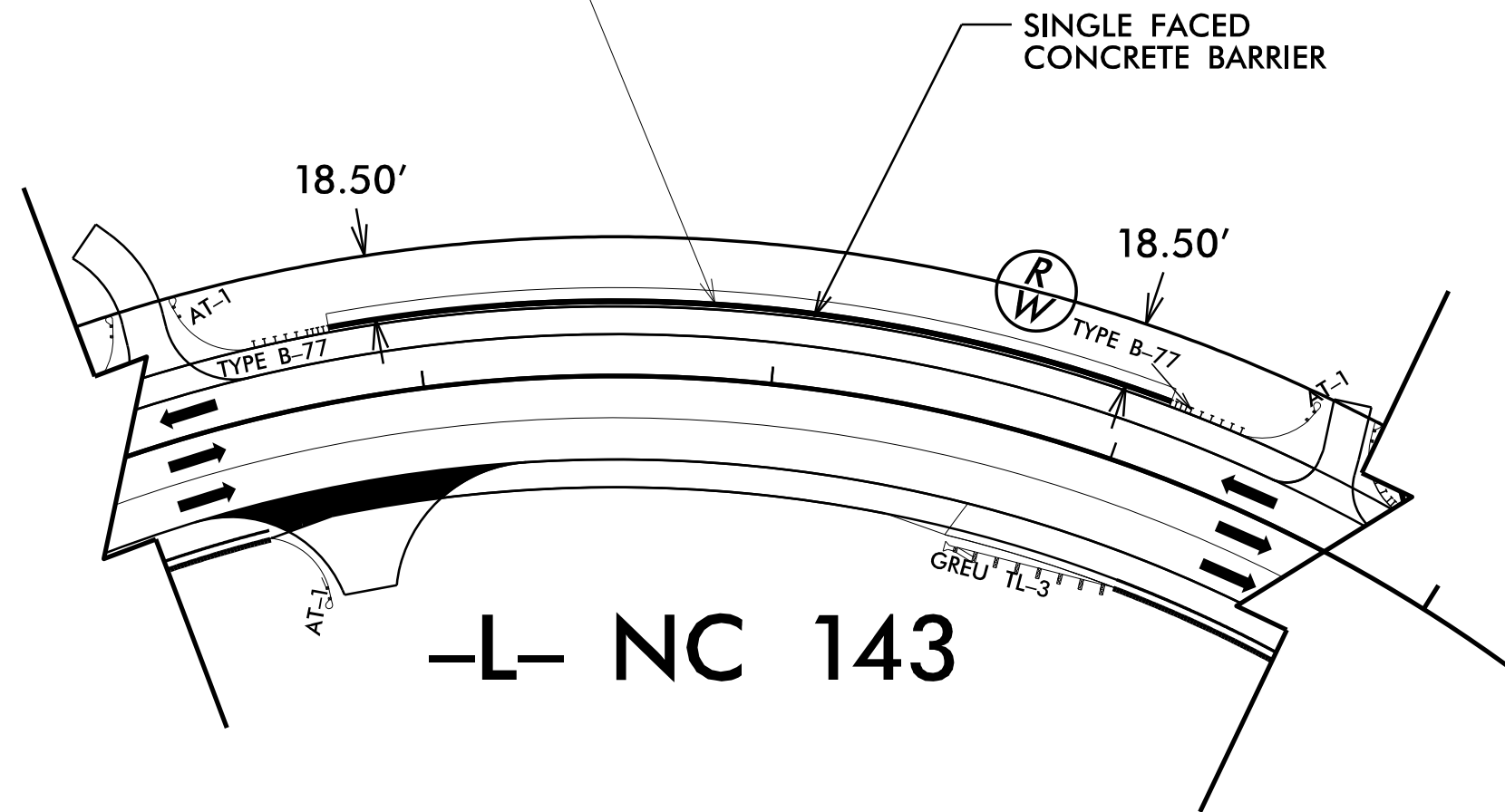

**RETAINING WALL #12 - PLAN**

NOT TO SCALE

345

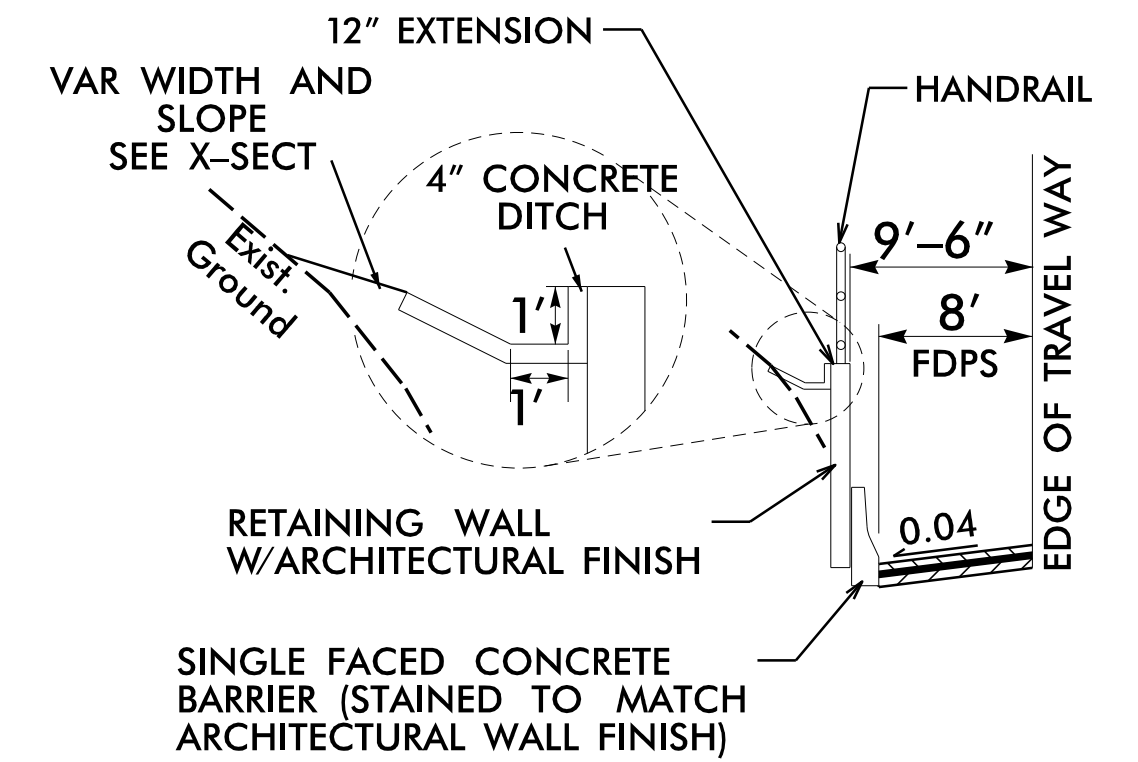

**DETAIL FOR WALL #12**

NOT TO SCALE

-L- STA. 341+76.20 TO -L- STA. 344+10.55, LT

| ESTIMATED SOIL NAIL WALL QUANTITIES |                                      |                              |                       |
|-------------------------------------|--------------------------------------|------------------------------|-----------------------|
| RETAINING WALL NO.                  | SOIL NAIL RETAINING WALLS (SQ. FEET) | SOIL NAIL VERIFICATION TESTS | SOIL NAIL PROOF TESTS |
| 12                                  | 2,030*                               | 3                            | 15                    |
| FORM LINER ARCHITECTURAL FINISH     |                                      |                              | 2,030* SF             |
| HORIZONTAL DRAINS (CONTINGENCY)     |                                      |                              | 120 LF                |

\*INCLUDES RETAINING WALL EMBEDMENT

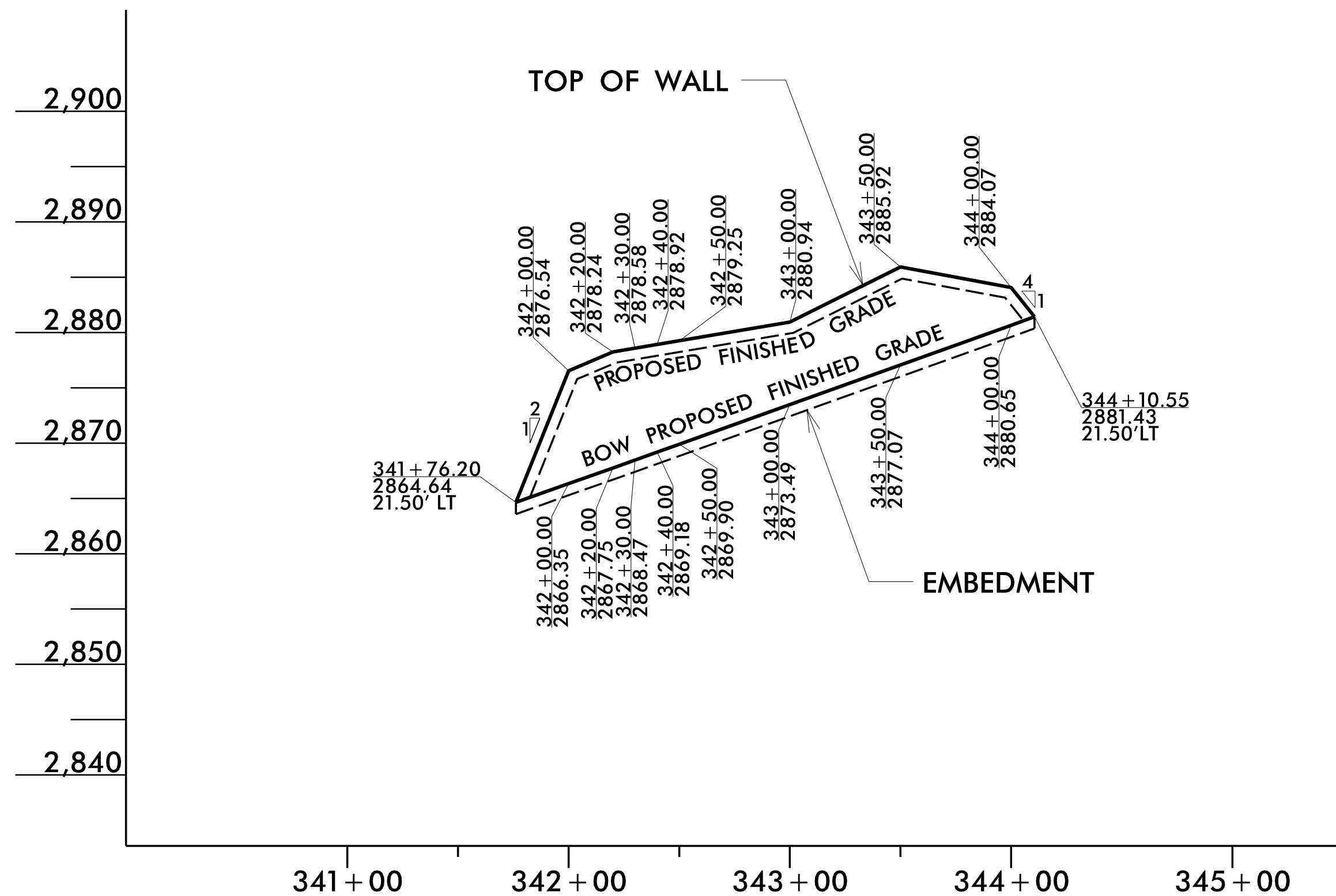

**RETAINING WALL #12 - ENVELOPE**

NOT TO SCALE  
BOW = BOTTOM OF WALL  
(LOOKING AT FACE OF WALL)

| SOIL NAIL RETAINING WALL #12 |                          |                     |                             |                     |                              |                        |
|------------------------------|--------------------------|---------------------|-----------------------------|---------------------|------------------------------|------------------------|
| STA. -L-                     | OFFSET FROM -L- (LT) FT. | ELEV. @ TOP OF WALL | BOW PROPOSED FINISHED GRADE | TOP OF LEVELING PAD | ESTIMATED WALL EMBEDMENT FT. | WALL DESIGN HEIGHT "H" |
| 341+76.20                    | 21.50                    | 2864.64             | 2864.64                     | 2863.64             | 1.00                         | 1.00                   |
| 342+00.00                    | 21.50                    | 2876.54             | 2866.35                     | 2865.35             | 1.00                         | 10.19                  |
| 342+20.00                    | 21.50                    | 2878.24             | 2867.75                     | 2866.75             | 1.00                         | 10.49                  |
| 342+30.00                    | 21.50                    | 2878.58             | 2868.47                     | 2867.47             | 1.00                         | 10.11                  |
| 342+40.00                    | 21.50                    | 2878.92             | 2869.18                     | 2868.18             | 1.00                         | 9.74                   |
| 342+50.00                    | 21.50                    | 2879.25             | 2869.90                     | 2868.90             | 1.00                         | 9.35                   |
| 343+00.00                    | 21.50                    | 2880.94             | 2873.49                     | 2872.49             | 1.00                         | 7.45                   |
| 343+50.00                    | 21.50                    | 2885.92             | 2877.07                     | 2876.07             | 1.00                         | 8.85                   |
| 344+00.00                    | 21.50                    | 2884.07             | 2880.65                     | 2879.65             | 1.00                         | 3.42                   |
| 344+10.55                    | 21.50                    | 2881.43             | 2881.43                     | 2880.43             | 1.00                         | 1.00                   |

PROJECT NO.: A-0009CB

GRAHAM COUNTY

RETAINING WALL #12: -L- 341+76, 22' LT TO 344+11, 22' LT

SHEET 1 OF 3

PREPARED BY: R. KRAL  
REVIEWED BY: M. BREWER

DATE: 6/2/2022  
DATE: 6/2/2022  
RETAINING WALL #12 ENVELOPE AND WALL LAYOUT PROVIDED BY TGS ENGINEERS, INC.

Prepared in the Office of:

**CAROLINAS GEOTECHNICAL GROUP**  
2400 CROWNPOINT EXECUTIVE DRIVE  
SUITE 800  
CHARLOTTE, NC 28227  
(980) 339-8684

**NORTH CAROLINA DEPARTMENT OF TRANSPORTATION DIVISION OF HIGHWAYS**

**GEOTECHNICAL ENGINEERING UNIT**

**RETAINING WALL #12 SOIL NAIL RETAINING WALL**

| REVISIONS |    |      |     |    |      | SHEET NO. |
|-----------|----|------|-----|----|------|-----------|
| NO.       | BY | DATE | NO. | BY | DATE |           |
| 1         |    |      | 3   |    |      | W12-1     |
| 2         |    |      | 4   |    |      |           |