

-L- CURVE DATA

PI Sta 320+83.09	PI Sta 328+01.63
$\Delta = 32^{\circ}27'42.9"$ (LT)	$\Delta = 21^{\circ}44'00.0"$ (RT)
$D = 732^{\circ}20.1'$	$D = 4^{\circ}05'33.2'$
$L = 430.59'$	$L = 531.05'$
$T = 221.25'$	$T = 268.75'$
$R = 760.00'$	$R = 1,400.00'$
$SE = 0.08$	$SE = 0.08$
$DS = 50$ MPH	$DS = 60$ MPH

CLEAN WATER DIVERSIONS ARE INDEPENDENT OF OTHER EC DITCH LINES AND TERMINATE INTO A SC-A.

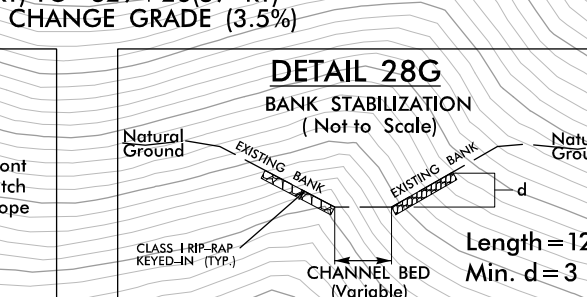
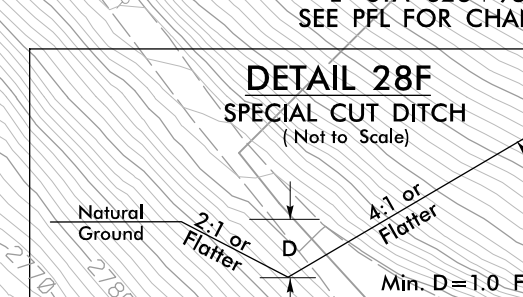
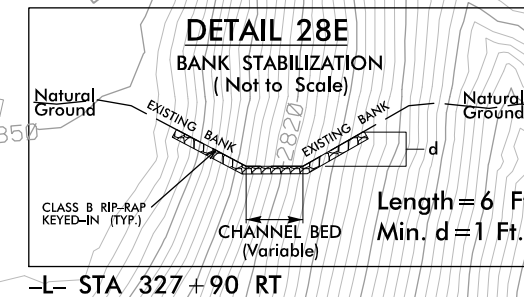
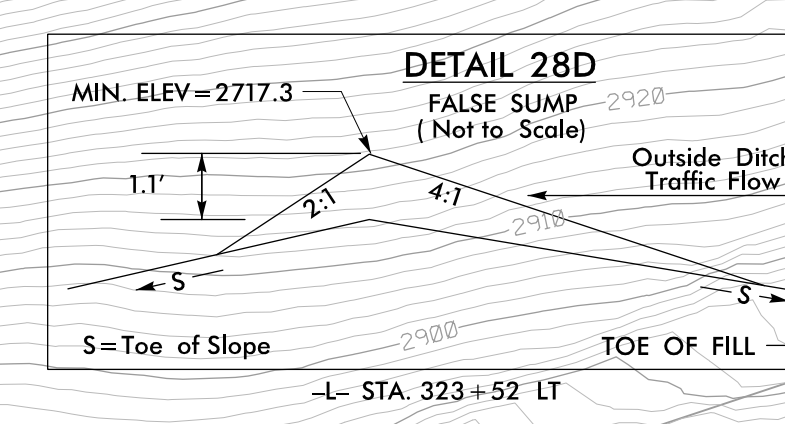
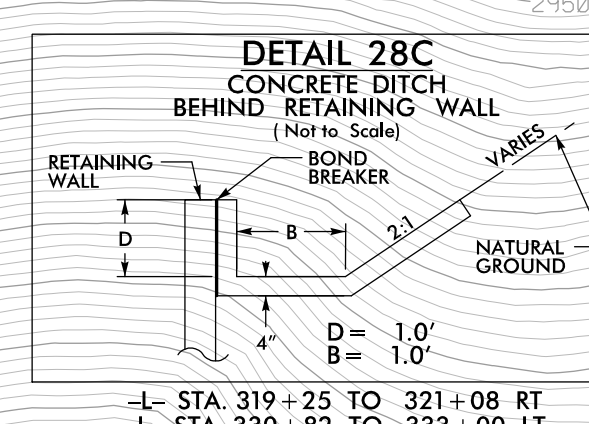
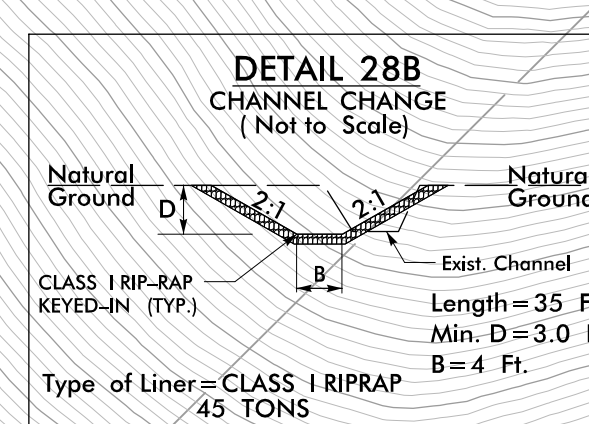
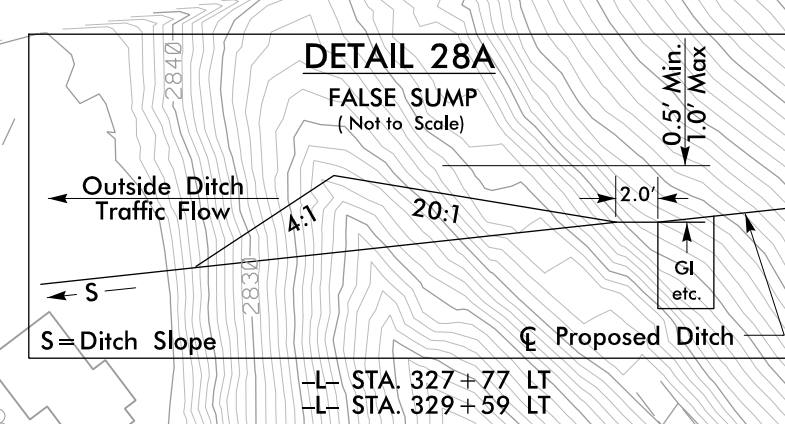

MATCH LINE STA -L- 319+00.00
MATCH TO SHEET NO. 27

MATCH LINE STA -L- 333+00.00
MATCH TO SHEET NO. 29

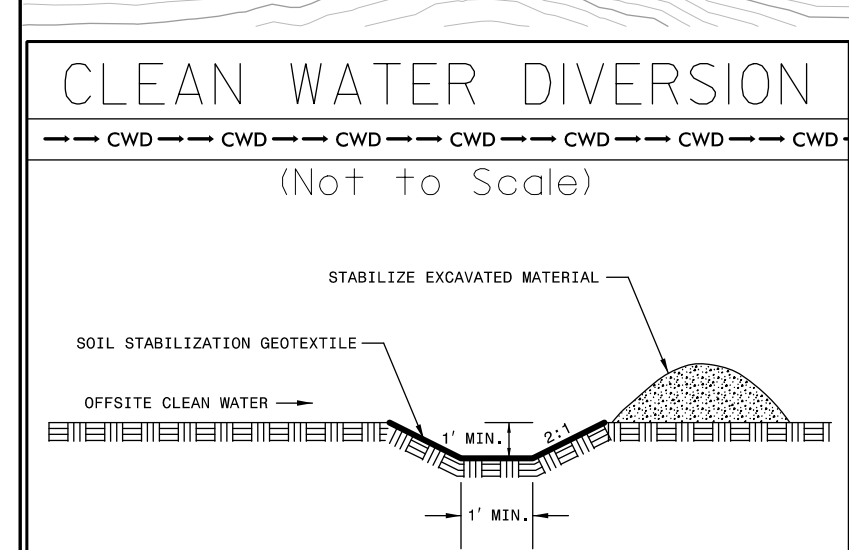

32 x 16 x 3
1.5 inch Skimmer
with 0.5 inch
Orifice Diameter
4 ft. weir
ID 28.1

PROJECT REFERENCE NO. A-0009CB	SHEET NO. EC-12/CONST.28
ROADWAY DESIGN ENGINEER	HYDRAULICS ENGINEER
TGS ENGINEERS 201 W. MARION ST. STE 200 SHELBY, NC 28150 PH (704) 476-0003 CORP. LICENSE NO.: C-0275	

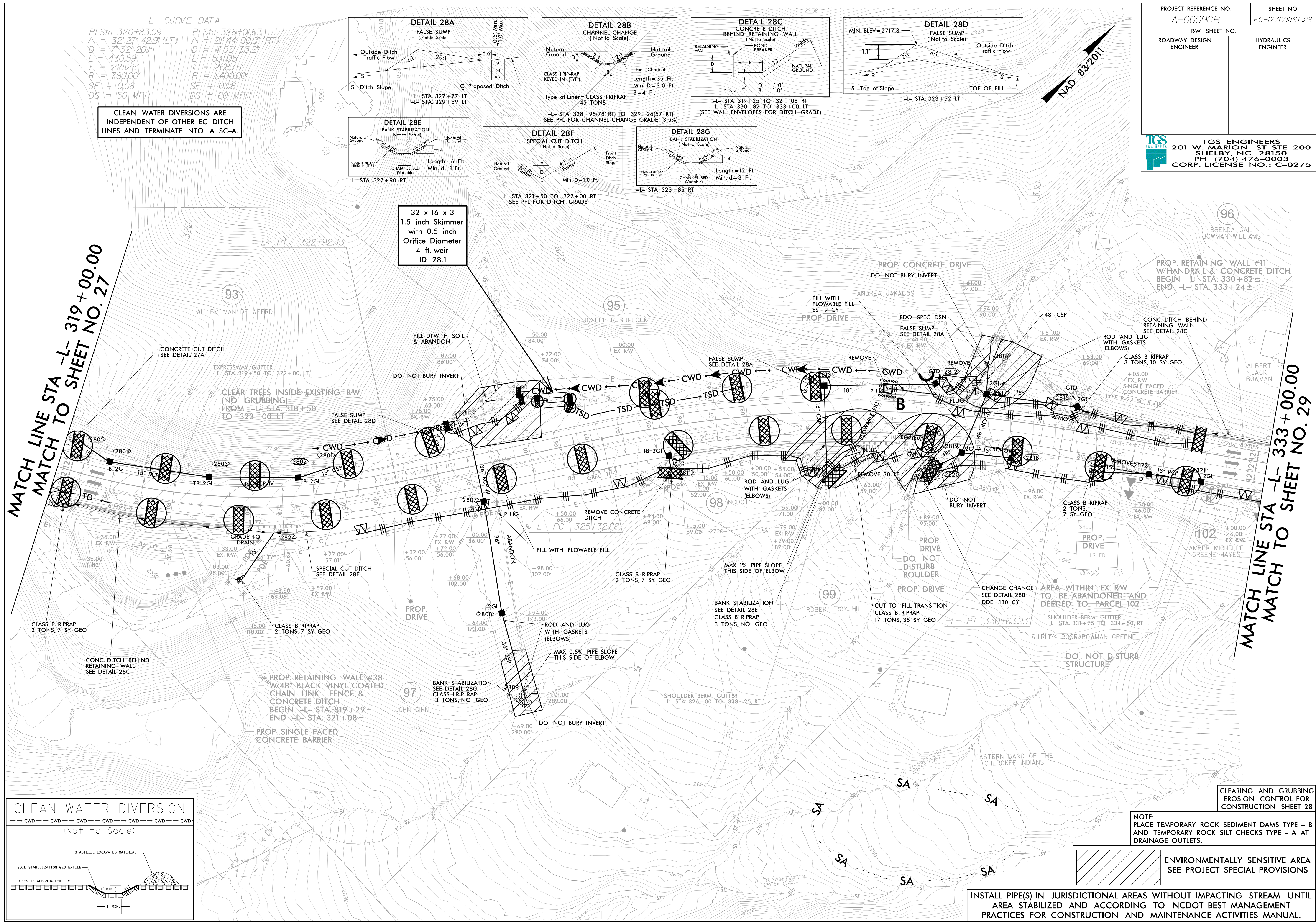

NOTE:
PLACE TEMPORARY ROCK SEDIMENT DAMS TYPE - B
AND TEMPORARY ROCK SILT CHECKS TYPE - A AT
DRAINAGE OUTLETS.

ENVIRONMENTALLY SENSITIVE AREA
SEE PROJECT SPECIAL PROVISIONS

INSTALL PIPE(S) IN JURISDICTIONAL AREAS WITHOUT IMPACTING STREAM UNTIL AREA STABILIZED AND ACCORDING TO NCDOT BEST MANAGEMENT PRACTICES FOR CONSTRUCTION AND MAINTENANCE ACTIVITIES MANUAL.