

PROJECT REFERENCE NO.	SHEET NO.
A-0009CB	EC-07A/CONST.23
RW SHEET NO.	
ROADWAY DESIGN ENGINEER	HYDRAULICS ENGINEER

CULVERT CONSTRUCTION SEQUENCE STA. 250+00 -L-

1. INSTALL PROPOSED DRAINAGE DITCH FROM -L- STA. 250+15 LT TO -L- STA. 251+00 LT. SEE DETAIL 23A.
2. INSTALL PROPOSED 2GI-A #2313 AND PROPOSED 36" RCP-IV FROM #2313 TO #2314.
3. INSTALL 36" TEMPORARY PIPE AS SHOWN.
4. INSTALL IMPERVIOUS DIKES #1 & #2, SHIFTING FLOW INTO TEMPORARY PIPE.
5. DEWATER WORK SITE AS NEEDED INTO SPECIAL STILLING BASIN(S).

6. REMOVE EXISTING 48" CMP.
7. CONSTRUCT 95"X67" CAA PIPE-ARCH WITH SILLS AT 10' O.C.
8. REMOVE 36" TEMPORARY PIPE AND IMPERVIOUS DIKES #1 & #2.
9. SHIFT FLOW INTO NEWLY CONSTRUCTED 95"X67" CAA PIPE-ARCH AND REESTABLISH STREAM.

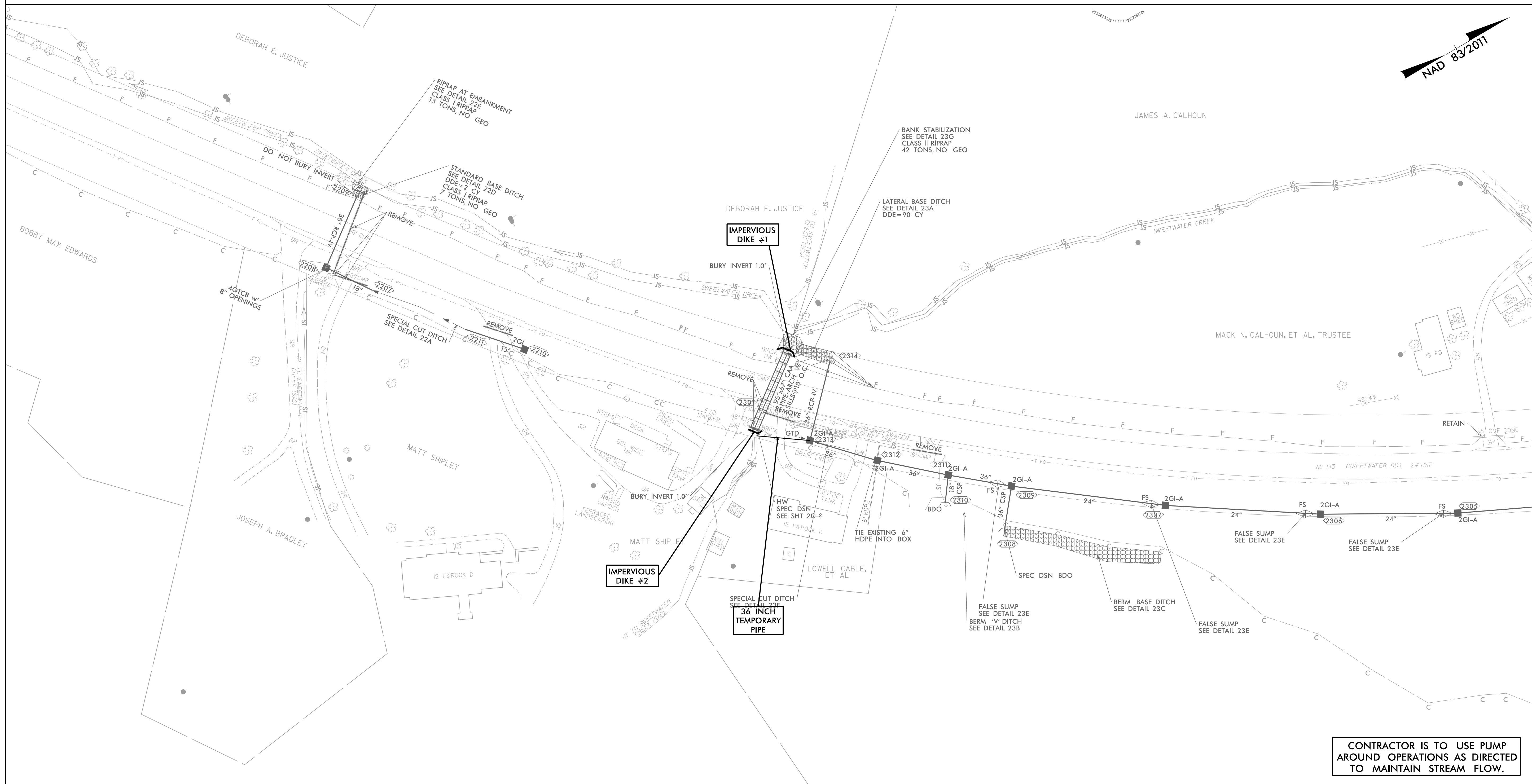

CONTRACTOR IS TO USE PUMP AROUND OPERATIONS AS DIRECTED TO MAINTAIN STREAM FLOW.