

5/28/22

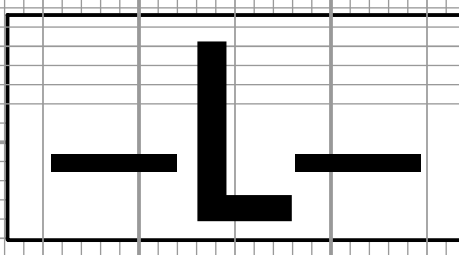

TGS ENGINEERS
 201 W. MARION ST
 SHELBY, NC 28150
 PH (704) 476-0003
 CORP. LICENSE NO.: C-0275

PROJECT REFERENCE NO. A-0009CB	SHEET NO. 50
ROADWAY DESIGN ENGINEER 	HYDRAULICS ENGINEER

DOCUMENT NOT CONSIDERED FINAL UNLESS ALL SIGNATURES COMPLETED

PIPE HYDRAULIC DATA
 *3201-L- Sta. 375+37

DRAINAGE AREA	= 4.0	AC
DESIGN FREQUENCY	= 50	YRS
DESIGN DISCHARGE	= 9.0	CFS
DESIGN HW ELEVATION	= 3083.2	FT
100 YEAR DISCHARGE	= 9.9	CFS
100 YEAR HW ELEVATION	= 3083.4	FT
OVERTOPPING FREQUENCY	= 500+	YRS
OVERTOPPING DISCHARGE	= N/A	CFS
OVERTOPPING ELEVATION	= 3095.8	FT

(+16.7245% (-)17.1756%)
 PI = 384+15.00
 EL = 3,157.47'
 VC = 1,470'
 K = 106
 DS = 50 MPH

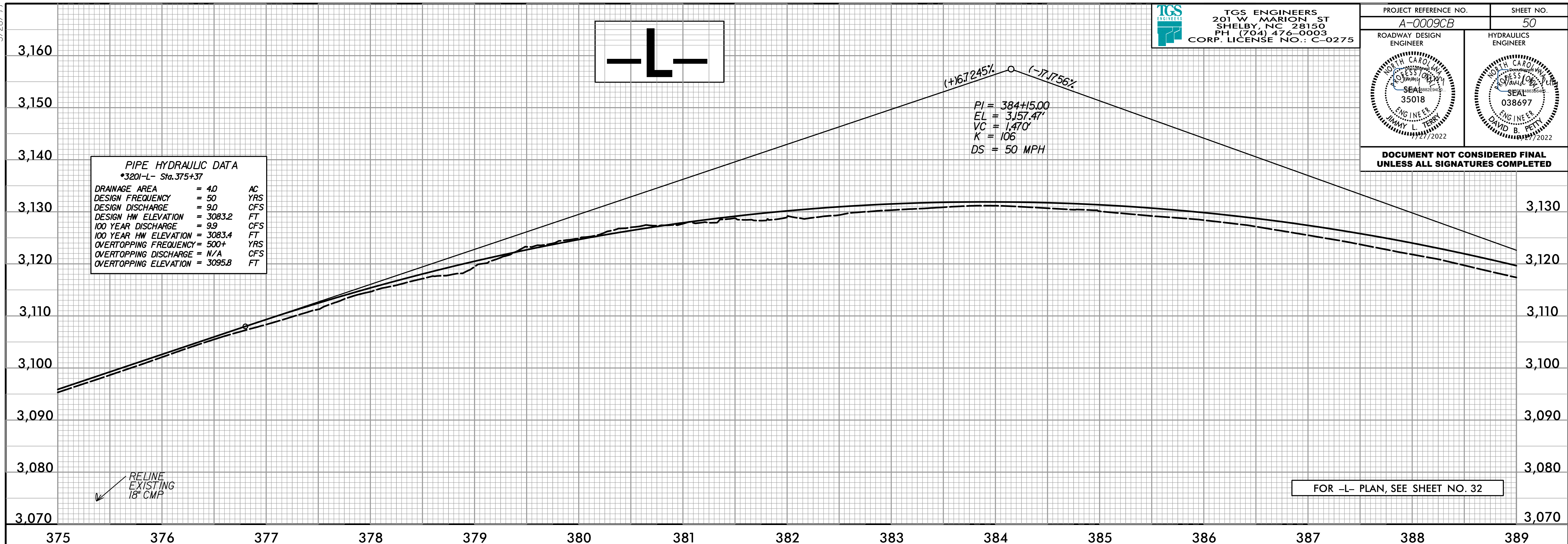

RELINE
 EXISTING
 18" CMP

FOR -L- PLAN, SEE SHEET NO. 32

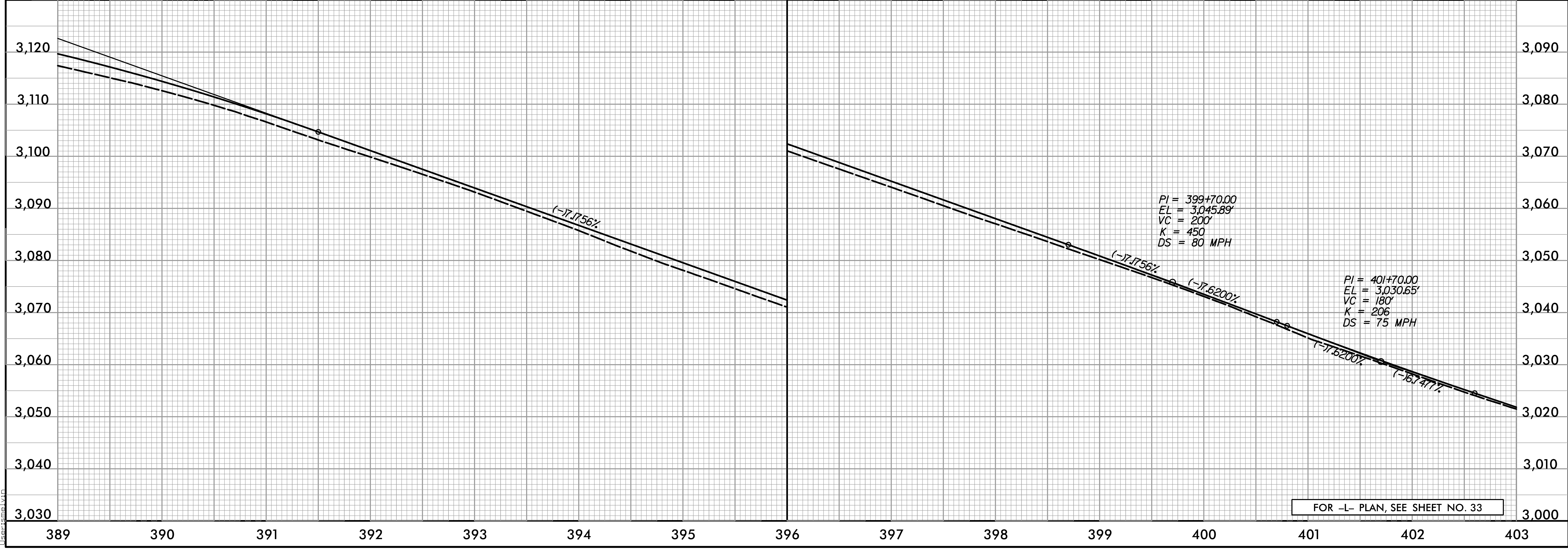

PI = 399+70.00
 EL = 3,045.89'
 VC = 200'
 K = 450
 DS = 80 MPH

PI = 401+70.00
 EL = 3,030.65'
 VC = 180'
 K = 206
 DS = 75 MPH

FOR -L- PLAN, SEE SHEET NO. 33

S:\2022\A-0009\Roadway\Proj\A-0009CB_Plan_Sheets\A-0009CB_Rdy_pfl_Sheets.dgn