

5/14/19
5/19/2022
C:\Users\jld\OneDrive\Documents\Roadway\Proj\A-0009CB\Plan_Sheets\A-0009CB_Rdy_pfl_Sheets.dgn

PROJECT REFERENCE NO. A-0009CB	SHEET NO. 45A
ROADWAY DESIGN ENGINEER 	HYDRAULICS ENGINEER
DOCUMENT NOT CONSIDERED FINAL UNLESS ALL SIGNATURES COMPLETED	
 TGS ENGINEERS 201 W. MARION ST SHELBY, NC 28150 PH (704) 476-0003 CORP. LICENSE NO.: C-0275	

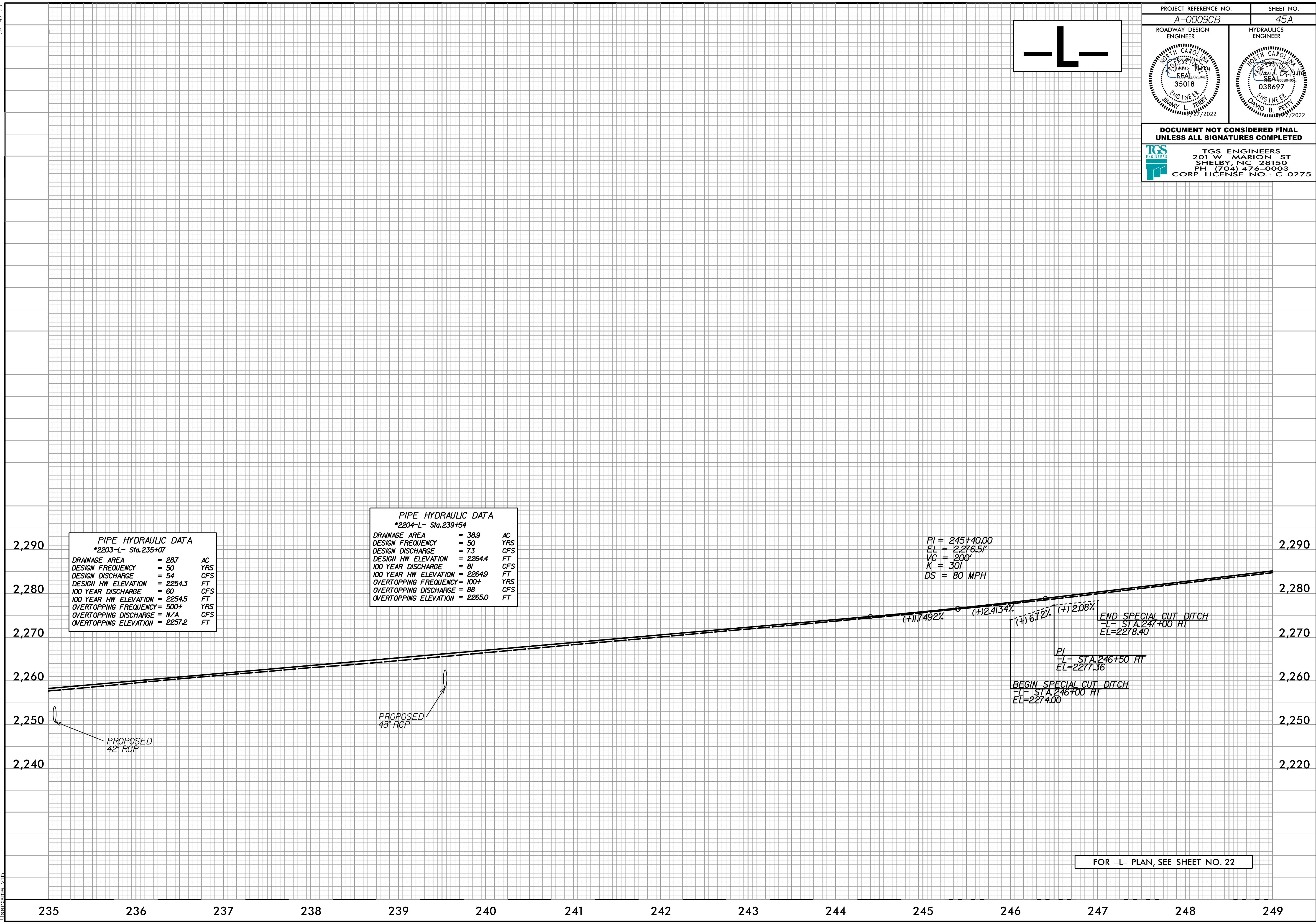
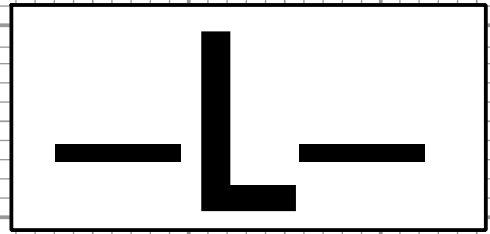

PIPE HYDRAULIC DATA
*2203-L- Sta.235+07

DRAINAGE AREA	= 287	AC
DESIGN FREQUENCY	= 50	YRS
DESIGN DISCHARGE	= 54	CFS
DESIGN HW ELEVATION	= 2254.3	FT
100 YEAR DISCHARGE	= 60	CFS
100 YEAR HW ELEVATION	= 2254.5	FT
OVERTOPPING FREQUENCY	= 500+	YRS
OVERTOPPING DISCHARGE	= N/A	CFS
OVERTOPPING ELEVATION	= 2257.2	FT

PIPE HYDRAULIC DATA
*2204-L- Sta.239+54

DRAINAGE AREA	= 38.9	AC
DESIGN FREQUENCY	= 50	YRS
DESIGN DISCHARGE	= 73	CFS
DESIGN HW ELEVATION	= 2264.4	FT
100 YEAR DISCHARGE	= 81	CFS
100 YEAR HW ELEVATION	= 2264.9	FT
OVERTOPPING FREQUENCY	= 100+	YRS
OVERTOPPING DISCHARGE	= 88	CFS
OVERTOPPING ELEVATION	= 2265.0	FT

PI = 245+40.00
 EL = 2,276.51'
 VC = 200'
 K = 301
 DS = 80 MPH

END SPECIAL CUT DITCH
 -L- STA 247+00 RT
 EL=2278.40

PI
 -L- STA 246+50 RT
 EL=2277.36

BEGIN SPECIAL CUT DITCH
 -L- STA 246+00 RT
 EL=2274.00

PROPOSED 42" RCP

PROPOSED 48" RCP

FOR -L- PLAN, SEE SHEET NO. 22