

8/17/19

-L- CURVE DATA

PI Sta 320+83.09	PI Sta 328+01.63
$\Delta = 32^\circ 27' 42.9" (LT)$	$\Delta = 21^\circ 44' 00.0" (RT)$
$D = 7^\circ 32' 20.1"$	$D = 4^\circ 05' 33.2"$
$L = 430.59'$	$L = 531.05'$
$R = 760.00'$	$R = 1,400.00'$
$SE = 0.08$	$SE = 0.08$
$DS = 50 MPH$	$DS = 60 MPH$

NOTE:
ALL DRIVEWAYS ARE TO BE ASPHALT UNLESS OTHERWISE NOTED.
END LOCATION OF DRIVEWAY SHOWN ON PLANS REPRESENTS TIE-IN
PER CROSS-SECTIONS, THE CONTRACTOR SHALL EXTEND THE DRIVES AND
PAVE UP TO THE RIGHT OF WAY LINE, FROM ROW POINT ON MATCH
DRIVEWAY IN KIND, UNLESS OTHERWISE NOTED.

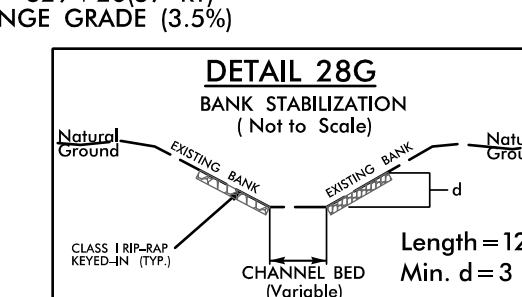
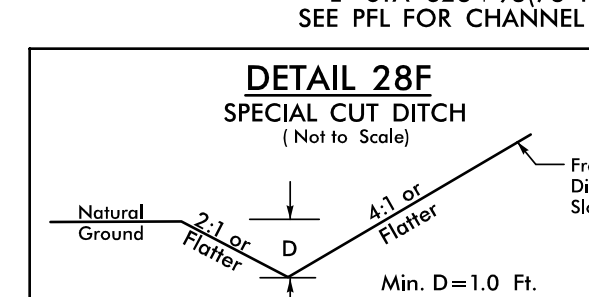
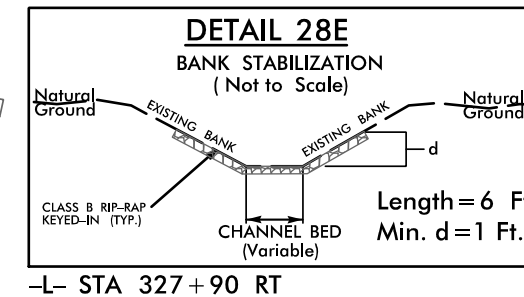
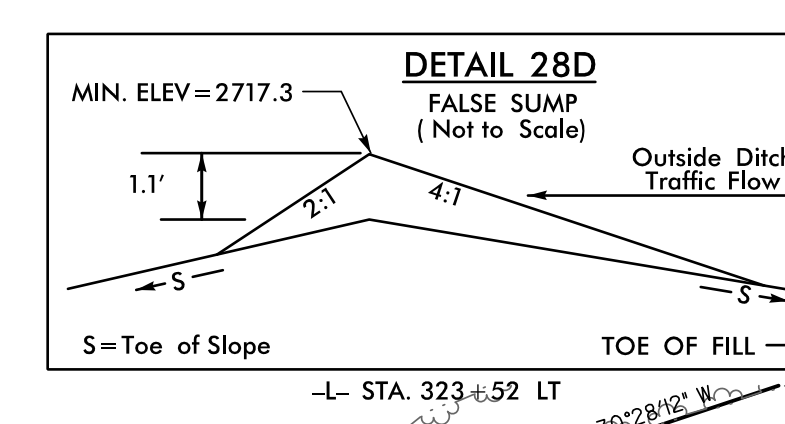
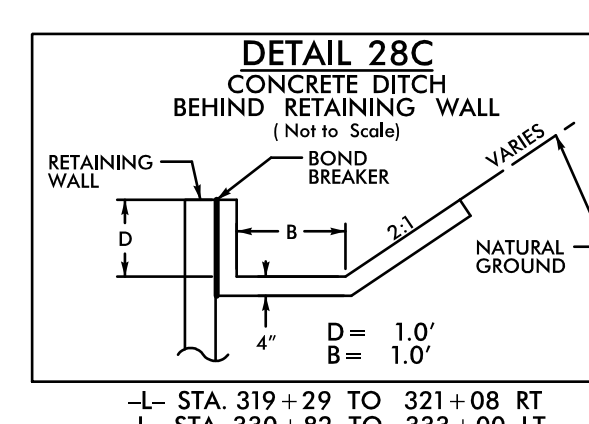
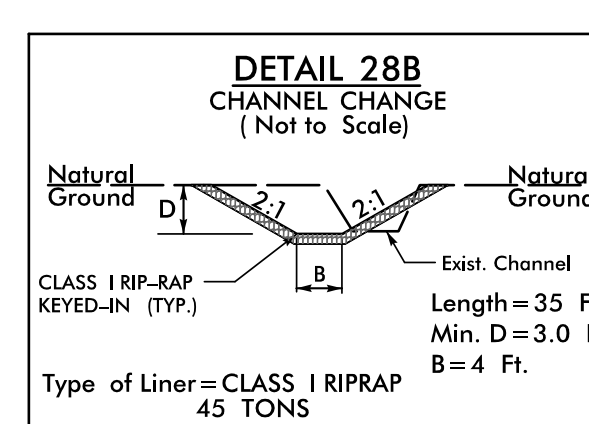
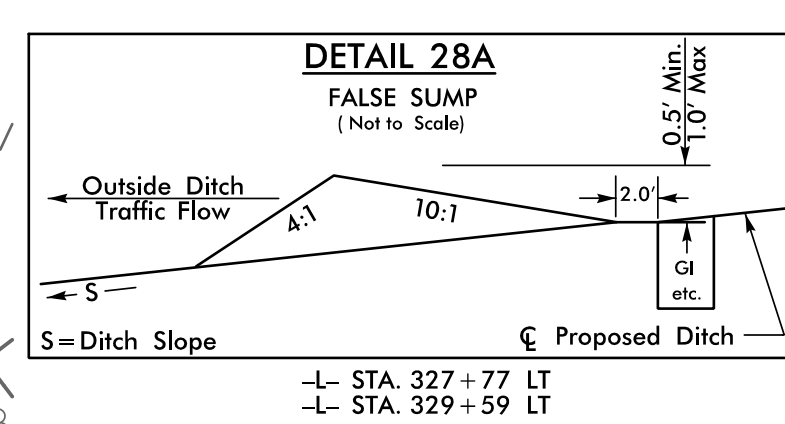

PROJECT REFERENCE NO. A-0009CB	SHEET NO. 28
ROADWAY DESIGN	HYDRAULICS ENGINEER
DOCUMENT NOT CONSIDERED FINAL UNLESS ALL SIGNATURES COMPLETED	
 TGS ENGINEERS 201 W. MARION ST SHELBY, NC 28150 PH: (704) 476-0003 CORP. LICENSE NO.: C-0275	

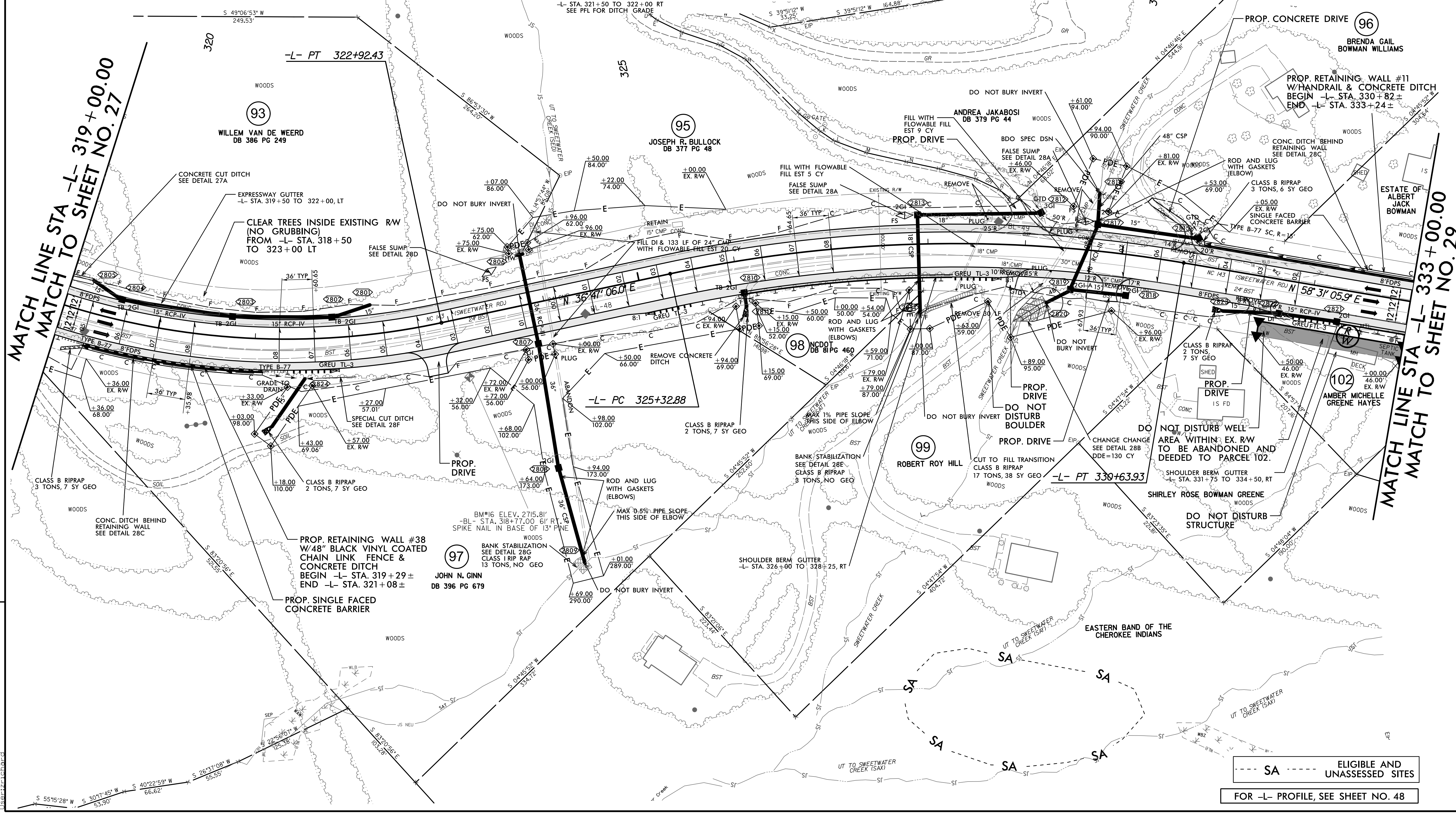

MATCH LINE STA -L- 319+00.00
MATCH TO SHEET NO. 27

MATCH LINE STA -L- 333+00.00
MATCH TO SHEET NO. 29

--- SA --- ELIGIBLE AND UNASSESSED SITES
FOR -L- PROFILE, SEE SHEET NO. 48

8/19/2022 A:\0009\Roadway\Proj\A-0009CB_Plan Sheets\A-0009CB_Rdy_psh_28.dgn