

8/17/99

-L- CURVE DATA

PI Sta 311+70.00 Δ = 54° 45' 45.1" (RT) D = 5' 24' 18.9" L = 1013.13' T = 549.01' R = 1060.00' SE = 0.08 DS = 55 MPH	PI Sta 320+83.09 Δ = 32° 27' 42.9" (LT) D = 7' 32' 20.1" L = 430.59' T = 221.25' R = 760.00' SE = 0.08 DS = 50 MPH	PI Sta 40+76.38 Δ = 78° 16' 33.1" (LT) D = 7' 37' 11.0" L = 109.29' T = 65.00' R = 80.00' ① -Y4- PCC 41+20.57 ② -Y4- PT 41+86.75	PI Sta 41+53.87 Δ = 15° 47' 56.9" (LT) D = 23' 52' 23.7" L = 66.18' T = 33.30' R = 240.00'	PI Sta 43+61.39 Δ = 41° 05' 30.0" (LT) D = 28' 38' 52.4" L = 143.44' T = 74.96' R = 200.00' ③ -Y4- PC 42+86.43 ④ -Y4- PT 44+29.86
---	---	---	---	--

NOTE:
ALL DRIVEWAYS ARE TO BE ASPHALT UNLESS OTHERWISE NOTED.
END LOCATION OF DRIVEWAY SHOWN ON PLANS REPRESENTS TIE-IN PER CROSS-SECTIONS, THE CONTRACTOR SHALL EXTEND THE DRIVES AND PAVE UP TO THE RIGHT OF WAY LINE FROM ROW POINT ON MATCH DRIVEWAY IN KIND, UNLESS OTHERWISE NOTED.

PROJECT REFERENCE NO. A-0009CB	SHEET NO. 27
ROADWAY DESIGN	HYDRAULICS ENGINEER
DOCUMENT NOT CONSIDERED FINAL UNLESS ALL SIGNATURES COMPLETED	
 TGS ENGINEERS 201 W MARION ST SHELBY, NC 28150 PH (704) 476-0003 CORP. LICENSE NO.: C-0275	

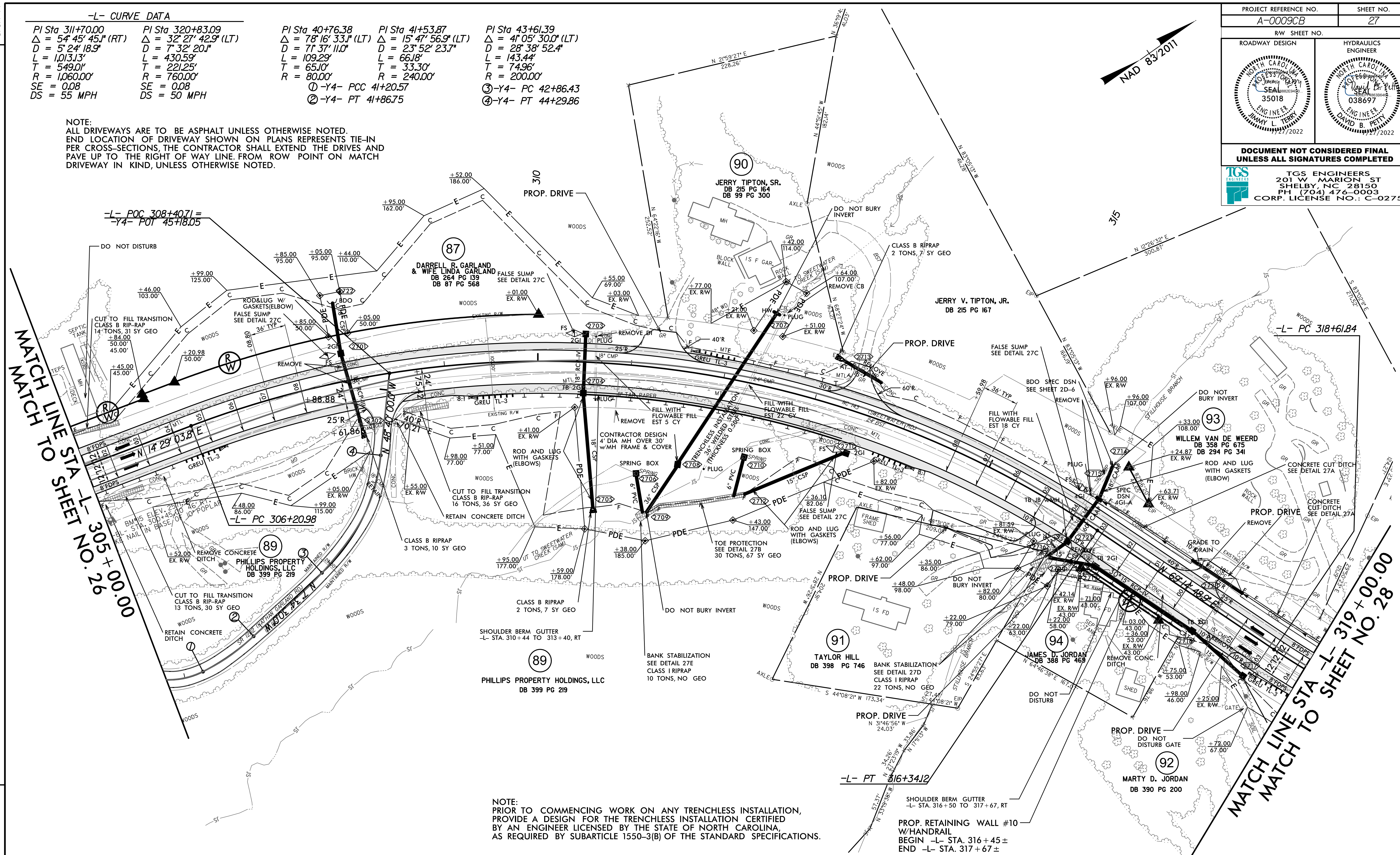

MATCH LINE TO SHEET NO. 26
-L- STA 305+00.00

MATCH LINE TO SHEET NO. 28
-L- STA 319+00.00

NOTE:
PRIOR TO COMMENCING WORK ON ANY TRENCHLESS INSTALLATION, PROVIDE A DESIGN FOR THE TRENCHLESS INSTALLATION CERTIFIED BY AN ENGINEER LICENSED BY THE STATE OF NORTH CAROLINA, AS REQUIRED BY SUBARTICLE 1550-3(B) OF THE STANDARD SPECIFICATIONS.

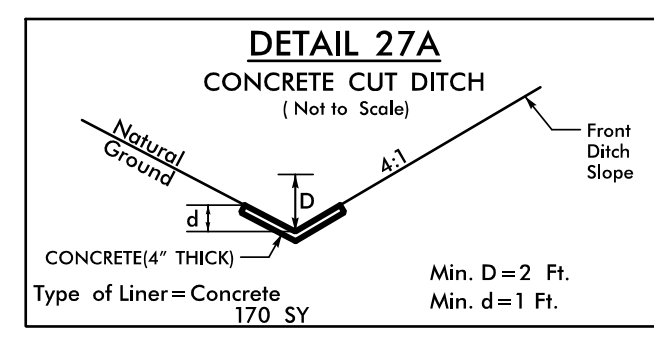

-L- STA. 316+17 TO 317+36 LT
-L- STA. 318+00 TO 319+23 LT
(SEE XSC FOR DITCH GRADE)

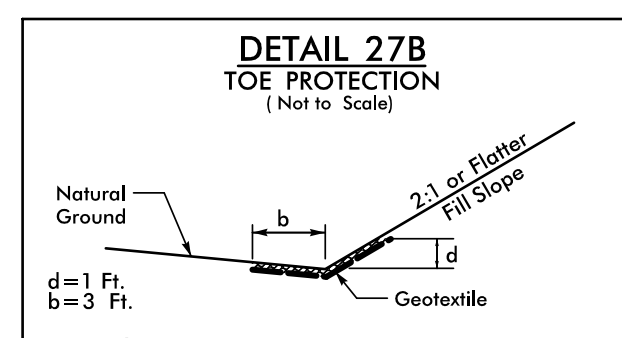

-L- STA. 311+37 TO STA. 312+50 RT

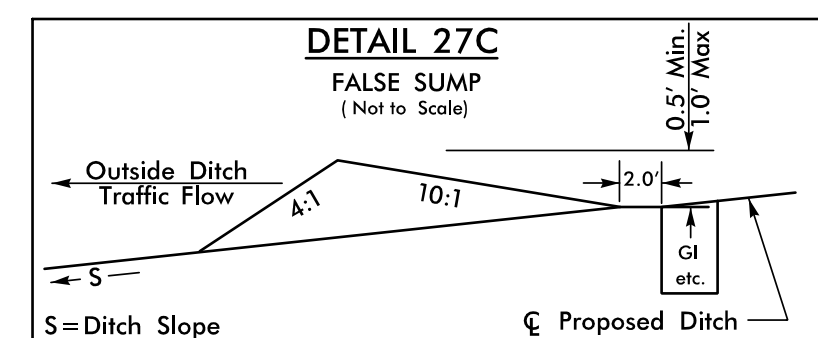

-L- STA. 307+80 LT
-L- STA. 310+38 LT
-L- STA. 315+94 LT
-L- STA. 313+35 RT (USE 4:1 FOR FRONT & BACK SLOPES)

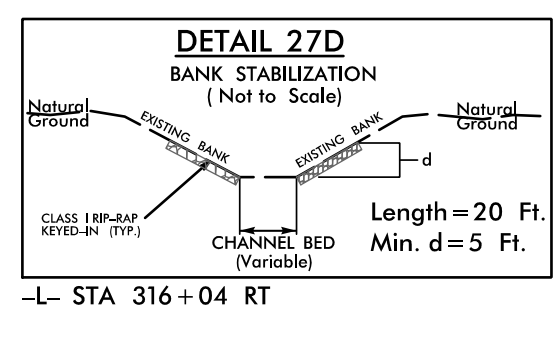

-L- STA 316+04 RT

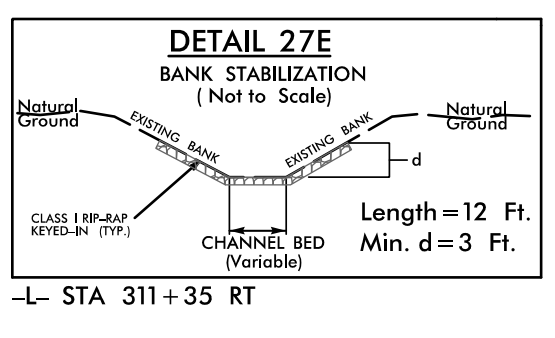

-L- STA 311+35 RT

--- ESA --- ELIGIBLE AND UNASSESSED SITES
FOR -L- PROFILE, SEE SHEET NO. 47

8/14/2009 A:\Roadway\Proj\A-0009CB\Plan Sheets\A-0009CB_Rdy_psh_27.dgn
User: jsm