

5

| | |
|-------------------------|----------------------|
| MESSAGE NO. 1 | MESSAGE NO. 2 |
| EXIT 96 CLOSED OVERNITE | US 64 DETOUR EXIT 94 |

CHANGEABLE MESSAGE SIGN
DAY BEFORE CLOSURE

| | |
|----------------------|----------------------|
| MESSAGE NO. 1 | MESSAGE NO. 2 |
| EXIT 96 US 64 CLOSED | US 64 DETOUR EXIT 94 |

CHANGEABLE MESSAGE SIGN
DURING CLOSURE

LOCATE CMS UNDER WITH THE DIRECTION OF THE ENGINEER

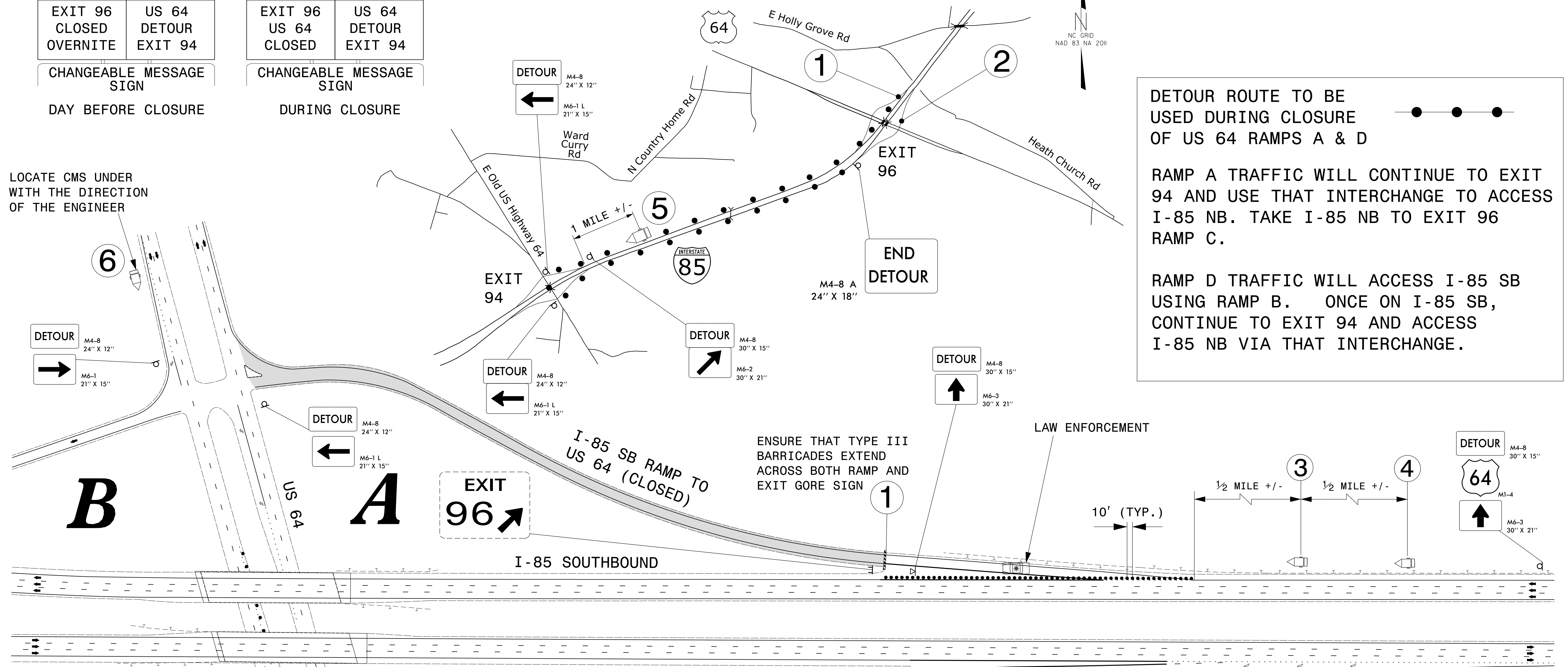

DETOUR ROUTE TO BE USED DURING CLOSURE OF US 64 RAMPS A & D

RAMP A TRAFFIC WILL CONTINUE TO EXIT 94 AND USE THAT INTERCHANGE TO ACCESS I-85 NB. TAKE I-85 NB TO EXIT 96 RAMP C.

RAMP D TRAFFIC WILL ACCESS I-85 SB USING RAMP B. ONCE ON I-85 SB, CONTINUE TO EXIT 94 AND ACCESS I-85 NB VIA THAT INTERCHANGE.

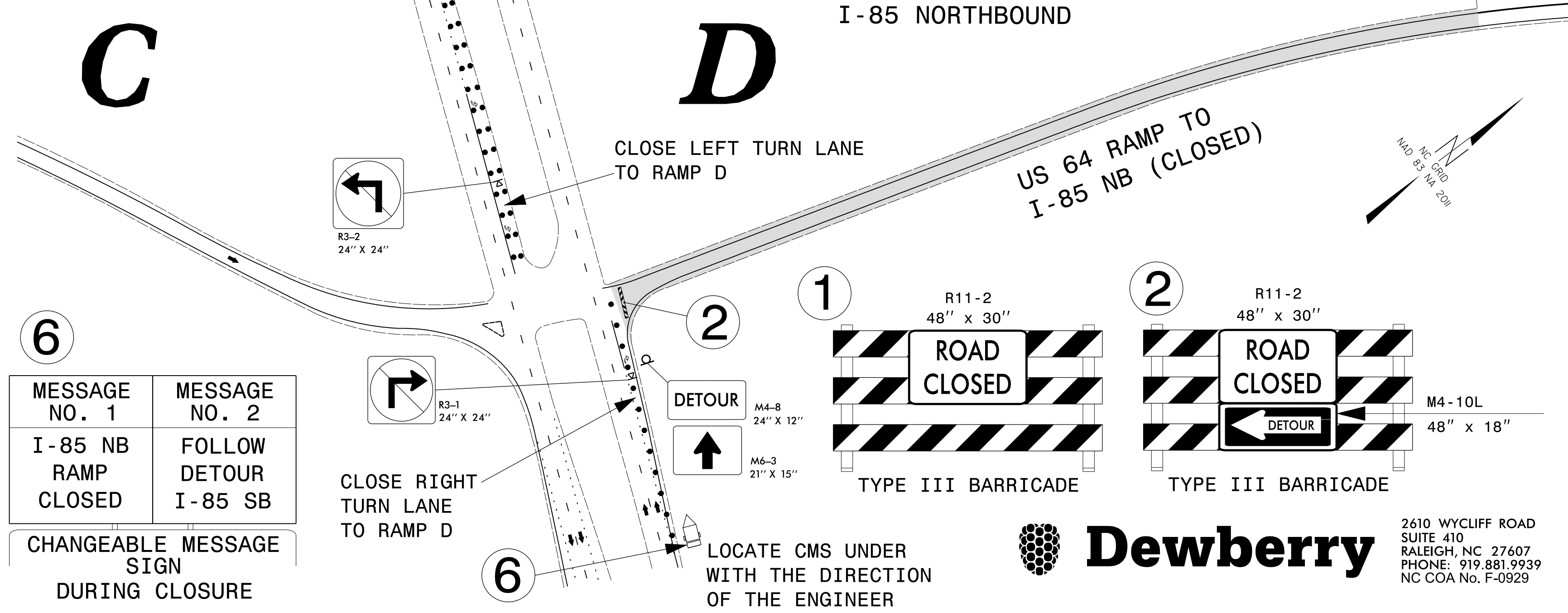

6

| | |
|---------------------|-----------------------|
| MESSAGE NO. 1 | MESSAGE NO. 2 |
| I-85 NB RAMP CLOSED | FOLLOW DETOUR I-85 SB |

CHANGEABLE MESSAGE SIGN
DURING CLOSURE

3

| | |
|-------------------|----------------------|
| MESSAGE NO. 1 | MESSAGE NO. 2 |
| US 64 EXIT CLOSED | US 64 DETOUR EXIT 94 |

CHANGEABLE MESSAGE SIGN
DURING CLOSURE

4

| | |
|-----------------------|----------------------|
| MESSAGE NO. 1 | MESSAGE NO. 2 |
| EXIT 96 CLOSED 1 MILE | US 64 DETOUR EXIT 94 |

CHANGEABLE MESSAGE SIGN
DURING CLOSURE

APPROVED: *[Signature]*
DATE: 6/29/2022

SEAL

DOCUMENT NOT CONSIDERED FINAL UNLESS ALL SIGNATURES COMPLETED

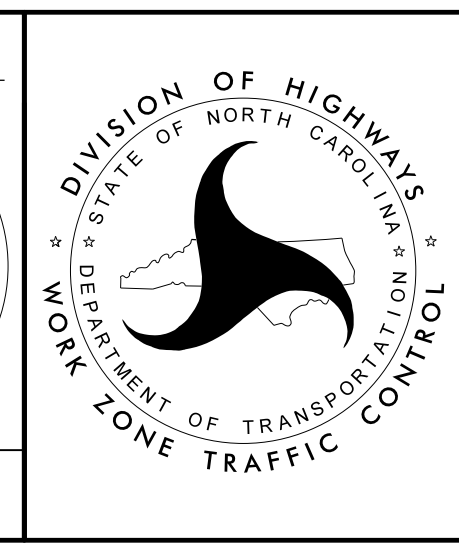

US 64
RAMPS A & D
DETOUR ROUTES

24-JUN-2022 11:27 P:\5015256\CAD\CIVIL\Plans\200_041_5950_TC_TCP_32.dgn lwiles AT 8908AV4