

— BAR TYPES —

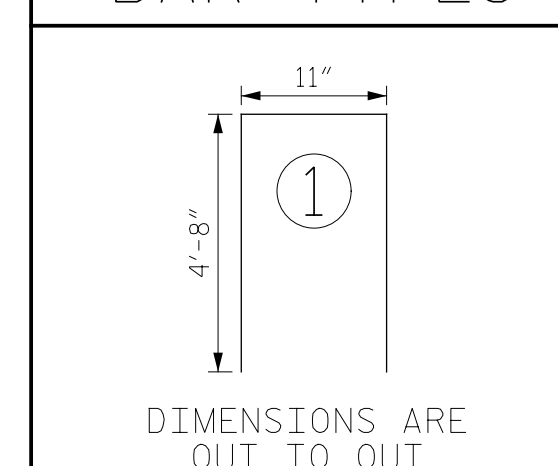

STRUT & COLUMN
BILL OF MATERIAL

BENT 139

BAR NO.	SIZE	TYPE	LENGTH	WEIGHT
B1 20	#5	STR.	14'-6"	302 LBS
S5 14	#3	* STR.	13'-6"	72 LBS
S6 24	#4	1	14'-3"	105 LBS

REINFORCING STEEL 479 LBS
CLASS AA CONCRETE 11 C.Y.

BENT 140

BAR NO.	SIZE	TYPE	LENGTH	WEIGHT
B1 20	#5	STR.	14'-6"	302 LBS
S5 14	#3	* STR.	13'-6"	72 LBS
S6 24	#4	1	14'-3"	105 LBS

REINFORCING STEEL 479 LBS
CLASS AA CONCRETE 11 C.Y.

NOTES:
* FIELD BEND BARS BASED ON FIELD MEASUREMENTS. OVERALL LENGTH IS BASED ON ANTICIPATED MAXIMUM DIMENSIONS. SEE FIELD BEND CHART.
FIELD CUT AS REQUIRED FOR FIT.

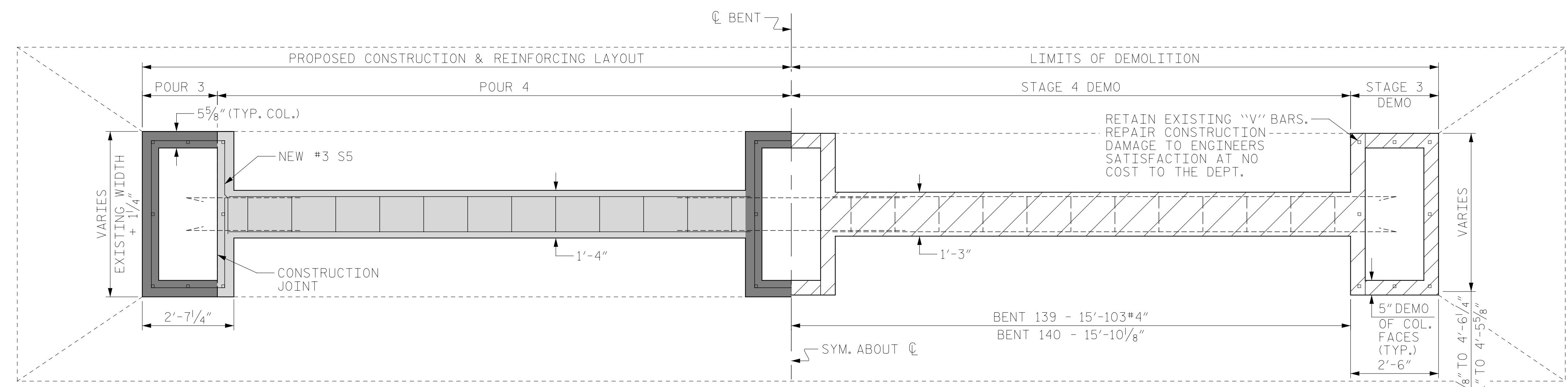

PLAN
COLUMN AND STRUT RESTORATION

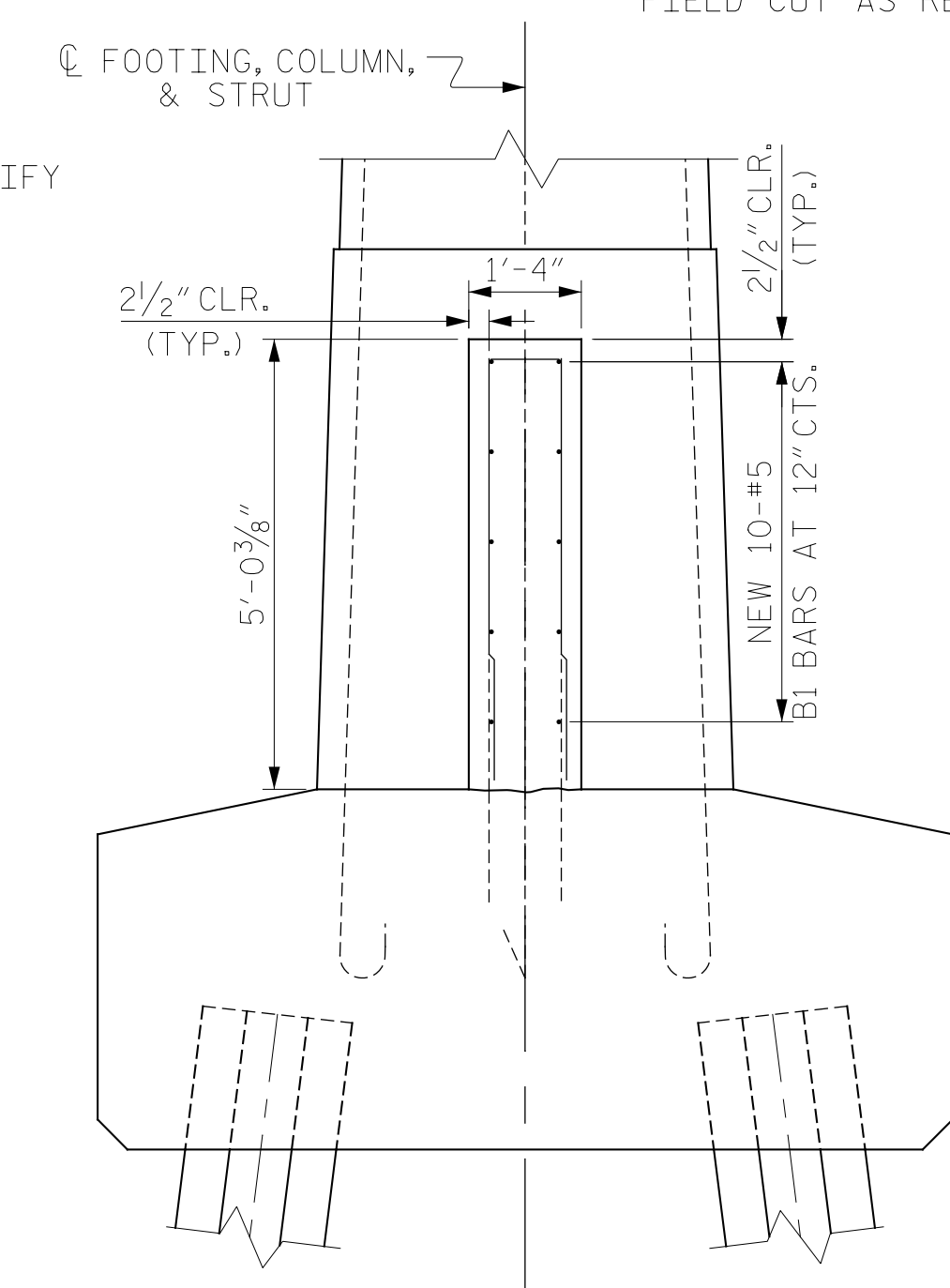

SIDE VIEW
PROPOSED COLUMN & STRUT

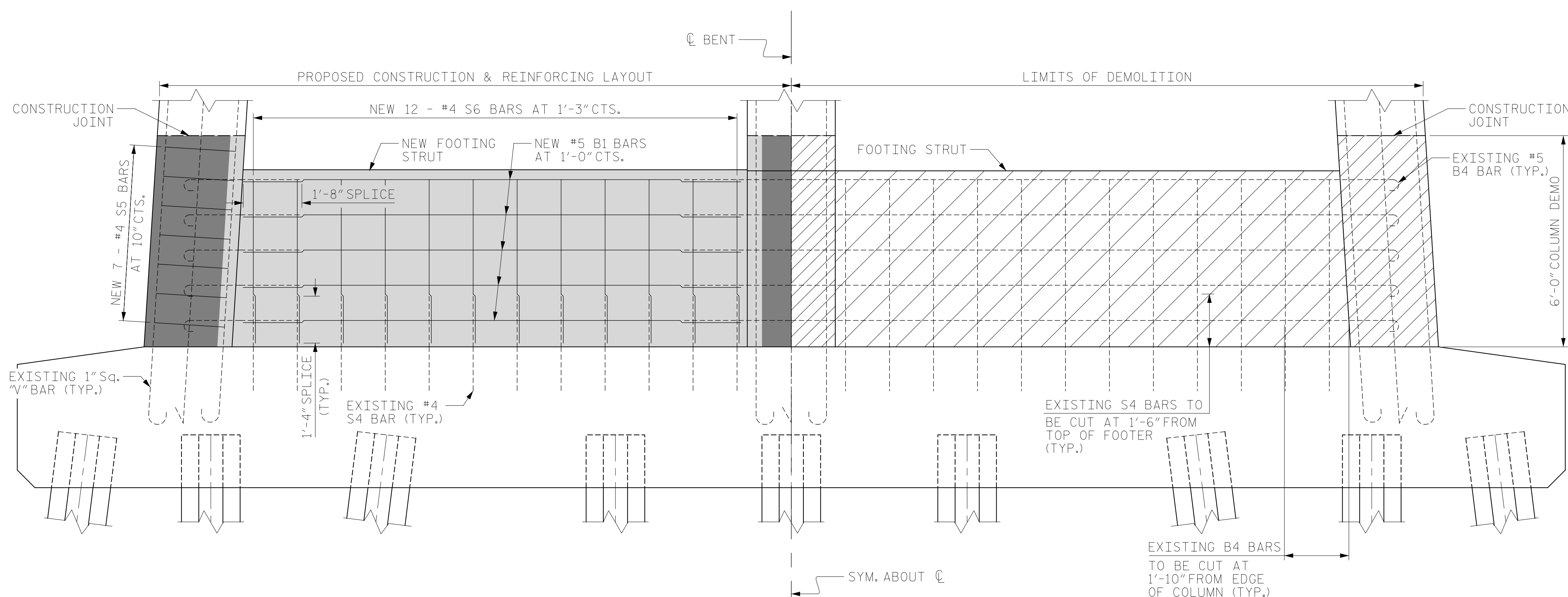
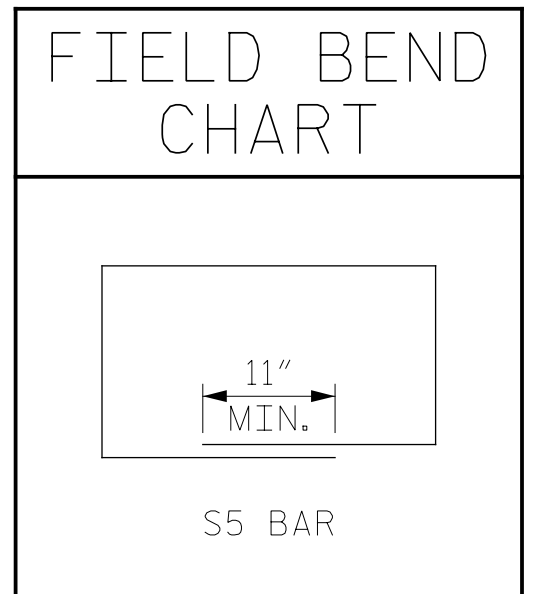

ELEVATION
COLUMN & STRUT RESTORATION

- STAGE 3 DEMOLITION
- STAGE 4 DEMOLITION
- POUR 3
- POUR 4

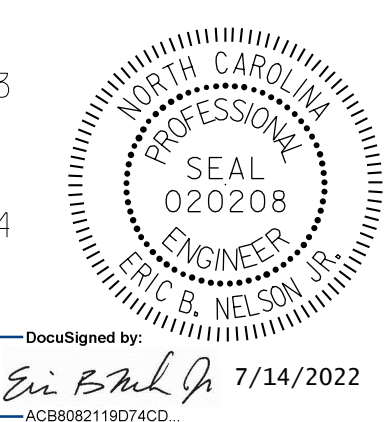

PROJECT NO. HB-0017
DARE COUNTY
BRIDGE NO. 270009

SHEET 3 OF 3

STATE OF NORTH CAROLINA
DEPARTMENT OF TRANSPORTATION
RALEIGH

PILE FOOTING
RESTORATION
BENT 139 AND 140

REVISIONS						SHEET NO.
NO.	BY:	DATE:	NO.	BY:	DATE:	S-354
1			3			TOTAL SHEETS
2			4			355

DRAWN BY: T. HARTLEY DATE: 4/2019
CHECKED BY: R. NELSON DATE: 4/2019



DOCUMENT NOT CONSIDERED
FINAL UNLESS ALL
SIGNATURES COMPLETED