

| SUMMARY OF QUANTITIES FOR SPAN 140   |           |        |
|--------------------------------------|-----------|--------|
|                                      | ESTIMATE  | ACTUAL |
| SHOTCRETE REPAIRS (UNDERDECK)        | 26.4 CF   |        |
| BRIDGE JOINT DEMOLITION              | 22.0 SF   |        |
| CLASS II SURFACE PREPARATION         | -         |        |
| CLASS III SURFACE PREPARATION        | -         |        |
| CONCRETE DECK REPAIR FOR MMA OVERLAY | -         |        |
| CRACK PRETREATMENT                   | 102.7 LF  |        |
| CONCRETE BRIDGE DECK CRACK SEALING   | 184.3 SY  |        |
| MMA OVERLAY SYSTEM                   | 2507.5 SF |        |

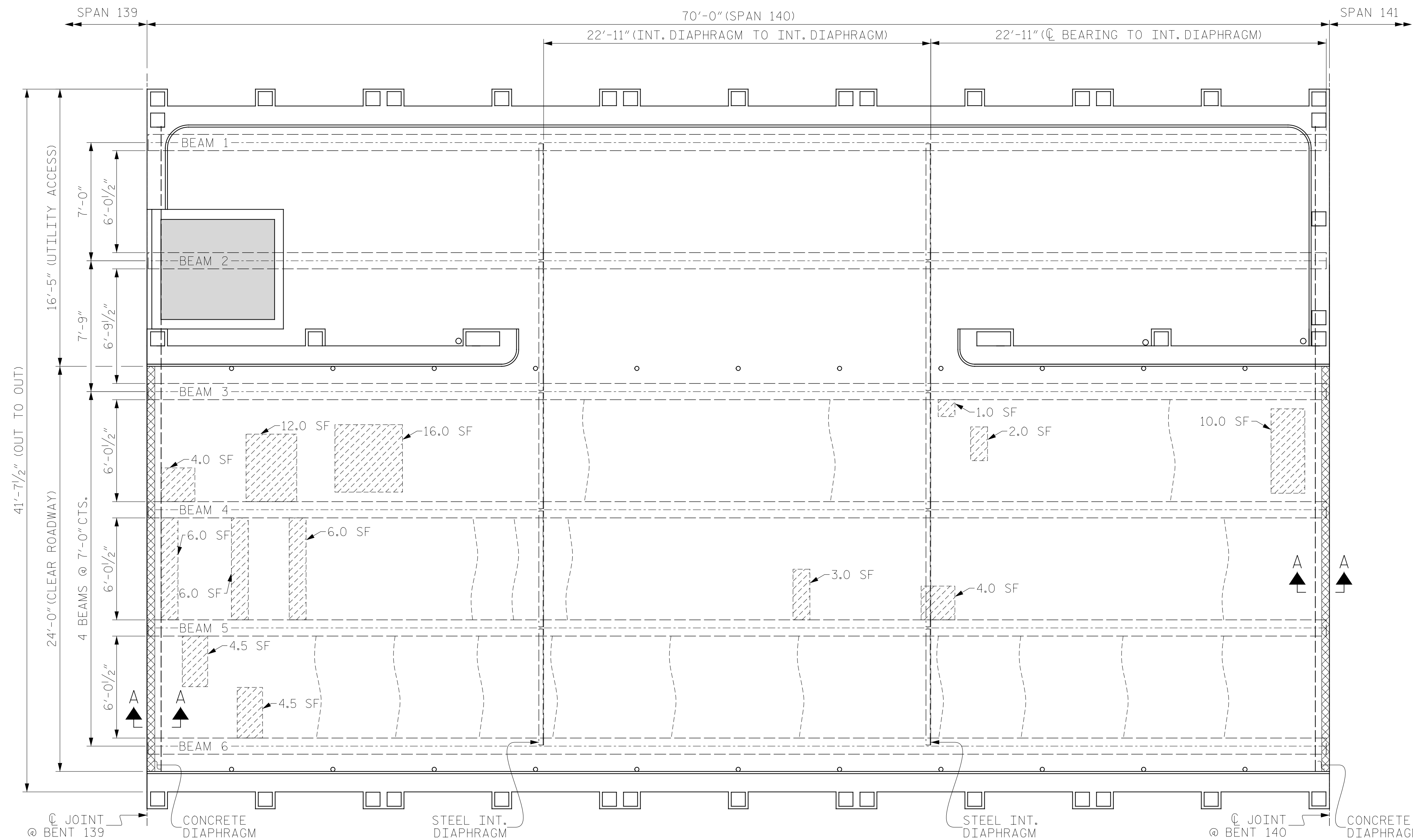

PLAN OF SPAN 140

- SHOTCRETE REPAIRS (UNDERDECK)
- BRIDGE JOINT DEMOLITION
- CLASS II DECK REPAIR
- CLASS III DECK REPAIR
- MMA OVERLAY SYSTEM
- CRACK PRETREATMENT

PROJECT NO. HB-0017  
DARE COUNTY  
 BRIDGE NO. 270009



STATE OF NORTH CAROLINA  
 DEPARTMENT OF TRANSPORTATION  
 RALEIGH  
 SURFACE PREPARATION  
 & UNDERDECK REPAIRS  
 SPAN 140

NOTE:  
 REPAIR LOCATIONS AND ESTIMATED QUANTITIES ARE GIVEN WITH THE BEST INFORMATION AVAILABLE. IF ADDITIONAL REPAIRS NOT SHOWN ON THE DRAWINGS ARE DEEMED NECESSARY BY THE ENGINEER, THE ENGINEER WILL NOTE ON THE DRAWINGS THE APPROXIMATE LOCATIONS AND DESCRIPTION OF THE REPAIRS AND ADJUST THE ACTUAL QUANTITIES ENTERED INTO THE AS-BUILT REPAIR QUANTITY TABLE.

DRAWN BY : M. SPENCER DATE : 12/2018  
 CHECKED BY : J. FARNHAM DATE : 03/2019



DOCUMENT NOT CONSIDERED  
 FINAL UNLESS ALL  
 SIGNATURES COMPLETED

| REVISIONS |     |       |     |     |       | SHEET NO.    |
|-----------|-----|-------|-----|-----|-------|--------------|
| NO.       | BY: | DATE: | NO. | BY: | DATE: | TOTAL SHEETS |
| 1         |     |       | 3   |     |       | 59           |
| 2         |     |       | 4   |     |       | 355          |