

S. HAVEN RD

\*\* SEE HIGH VISIBILITY DEVICES SPECIAL PROVISION

\* NOTE: INSTALL TRAFFIC BEARING PRECAST STRUCTURES 0501, 0502, 0503, 0518, 0519 AND WILL REMAIN NON FUNCTIONING UNTIL PHASE IV  
FIELD VERIFY TOP OF STRUCTURE ELEVATIONS PRIOR TO MANUFACTURE. BACKFILL/PLATE AND PAVE OVER AS DIRECTED BY THE ENGINEER.

TIE TO PCB INSTALLED IN PHASE 2  
-L- 307+01±

-L- 309+72±  
BEGIN GLARE SCREEN  
AS DIRECTED BY THE ENGINEER

TIE ANCHORED PCB TO  
ANCHORED PCB INSTALLED  
IN PHASE 2  
-L- 317+27±

MATCH LINE SHEET TMP-10  
-L- STA. 306+00

MATCH LINE SHEET TMP-12  
-L- STA. 319+00

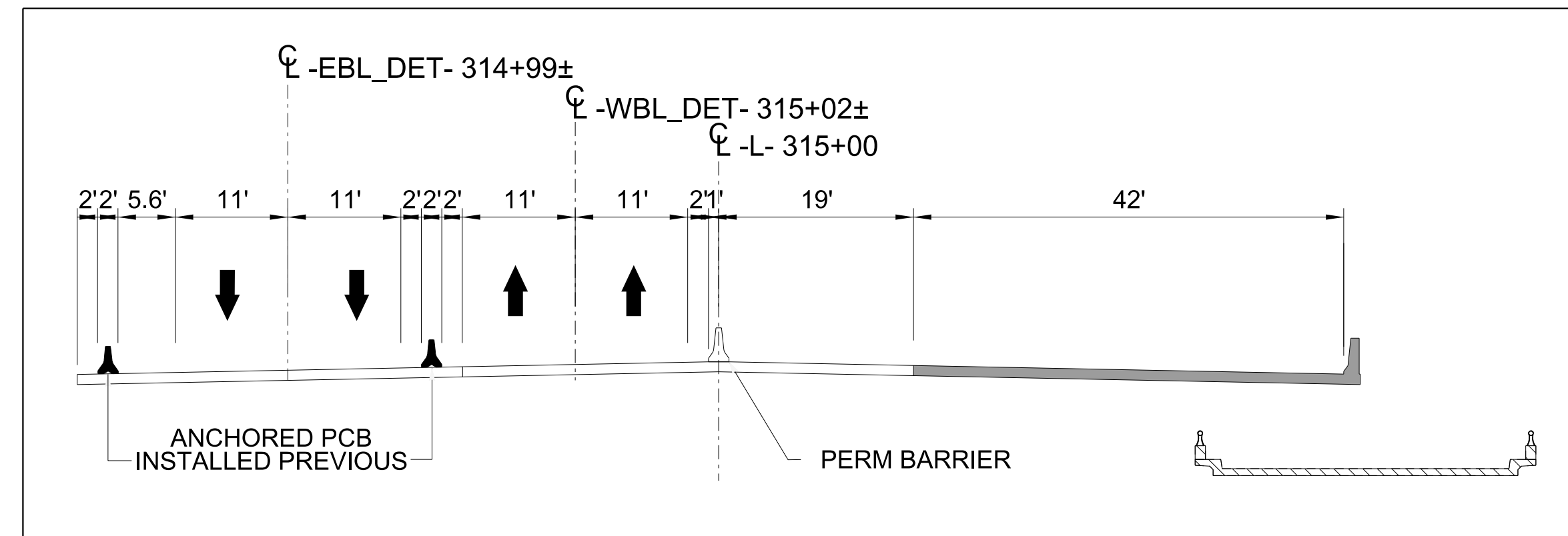
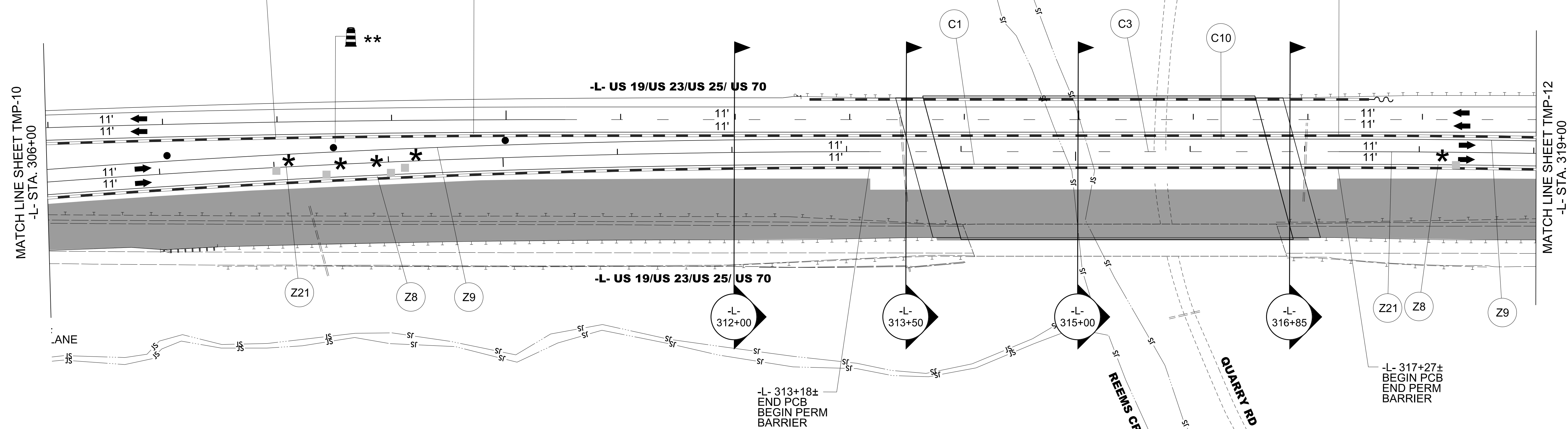

NOTE  
SEE TMP-11A FOR SECTION VIEW OF 313+50 AND 316+85

6/15/2022  
U:\Traffic\Transportation Management\Plan\TCP\PLAN SHEETS\B-4442-TMP-11-PHASE 3.dgn  
dorichardson

**Stantec**  
Stantec Consulting Services Inc.  
801 Jones Franklin Road  
Suite 300  
Raleigh, NC 27606  
Tel. 919.851.6866  
Fax. 919.851.7024  
www.stantec.com  
License No. F-0672

7/19/2022  
DOCUMENT NOT CONSIDERED FINAL  
UNLESS ALL SIGNATURES COMPLETED

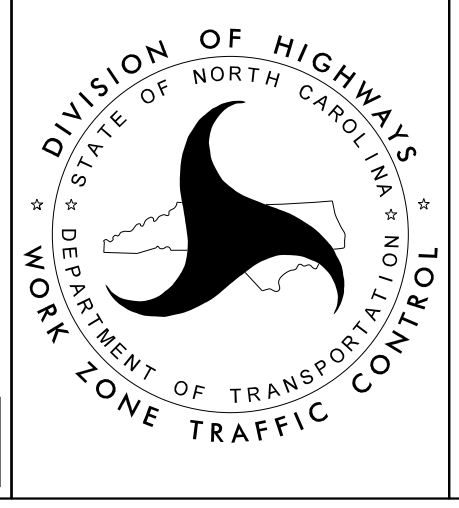

US 19/US 23/US 25/  
US 70/FUTURE I-26 -L-  
PHASE III