

STATE OF NORTH CAROLINA
DIVISION OF HIGHWAYS

TRANSPORTATION MANAGEMENT PLAN

BUNCOMBE COUNTY

DIVISION 13

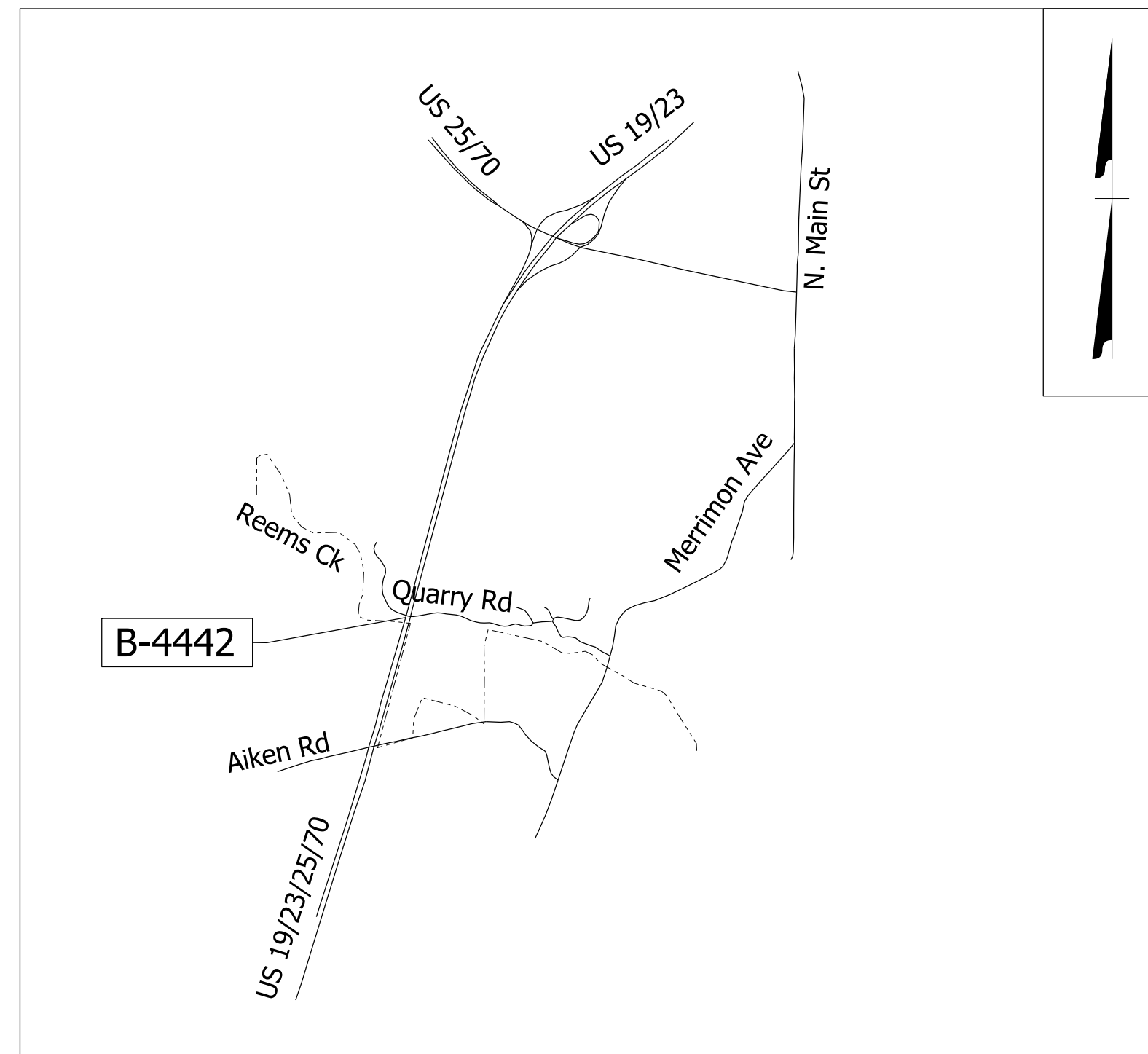
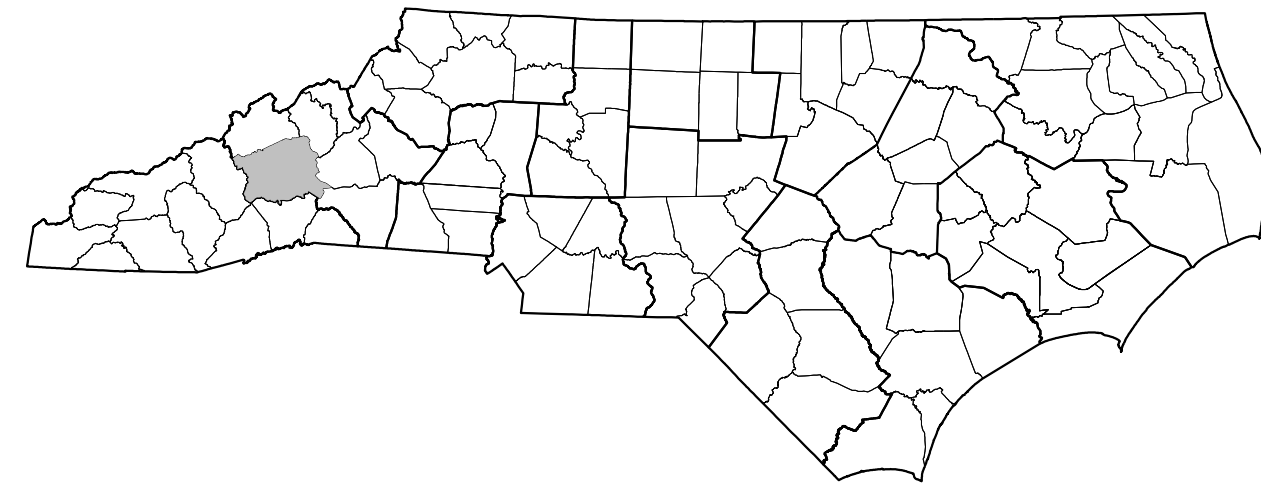

**LOCATION: REPLACE US-19, US-23, US-25, US-70, FUTURE I-26
BRIDGES OVER REEMS CREEK- STRUCTURES NO. 370 and 373**

TYPE OF WORK: GRADING, DRAINAGE, PAVING AND STRUCTURE

SHEET NO.	TITLE
TMP-1	TITLE SHEET, VICINITY MAP, AND INDEX OF SHEETS
TMP-1A	LIST OF APPLICABLE ROADWAY STANDARD DRAWINGS, AND LEGEND
TMP-1B, 1C	GENERAL NOTES
TMP-2	PORTABLE CONCRETE BARRIER AT TEMPORARY SHORING LOCATIONS
TMP-2A	TEMPORARY SHORING NOTES
TMP-2B	"WORK ZONE" SPEED LIMIT REDUCTION
TMP-3	TEMPORARY TRAFFIC CONTROL PHASING
TMP-4 THRU TMP-6	PHASE I
TMP-7 THRU TMP-9	PHASE II
TMP-10 THRU TMP-12	PHASE III
TMP-13 THRU TMP-15	PHASE IV
TMP-16	PHASE V

7/28/2022 U:\Traffic\Transportation Management Plan\TCP\PLAN SHEETS\B-4442-TMP-01-TITLE.dgn dorichardson

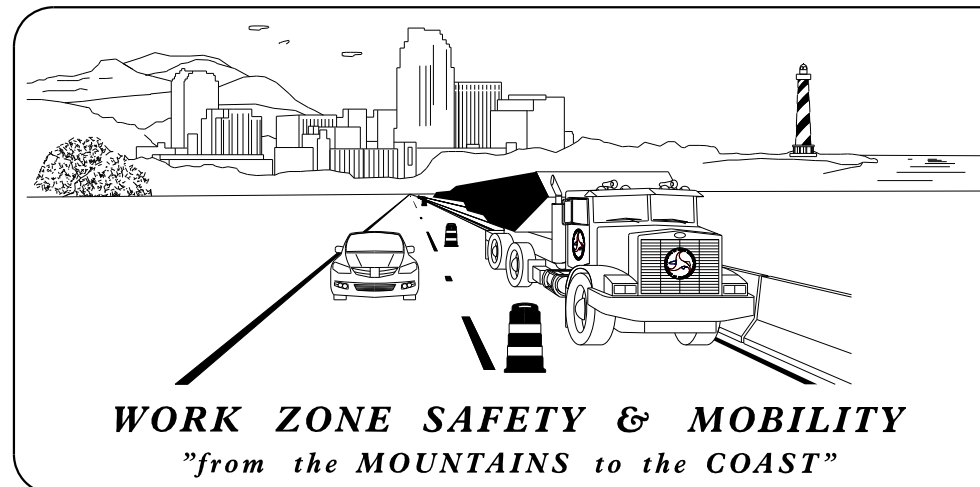

PLANS PREPARED BY:

 JAY WOOLARD, PE
 SENIOR TRANSPORTATION ENGINEER

 DONNIE RICHARDSON
 TRANSPORTATION DESIGNER

NCDOT CONTACTS:

 ZACHARY CLARK, PE
 PROJECT ENGINEER

 SHEENA GREEN
 PROJECT DESIGN ENGINEER

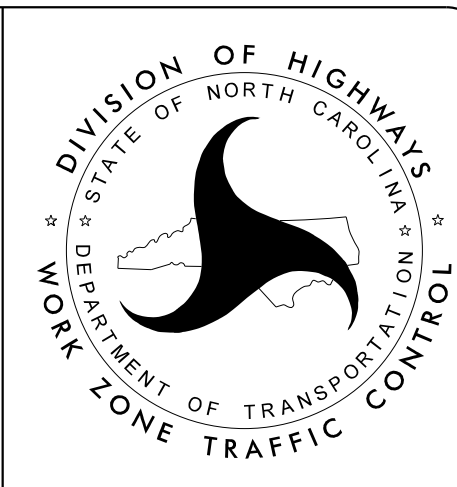

Stantec Consulting Services Inc.
801 Jones Franklin Road, Suite 300
Raleigh, NC 27606
Tel. 919.851.6866
Fax. 919.851.7024
www.stantec.com
License No. F-0672

**DOCUMENT NOT CONSIDERED FINAL
UNLESS ALL SIGNATURES COMPLETED**



DocuSigned by:
J. W. Woolard, Jr.
7/28/2022

TIP PROJECT: B-4442