

**This electronic collection of documents is provided  
for the convenience of the user  
and is Not a Certified Document –**

**The documents contained herein were originally issued  
and sealed by the individuals whose names and license  
numbers appear on each page, on the dates appearing  
with their signature on that page.**

**This file or an individual page  
shall not be considered a certified document.**

STATE OF NORTH CAROLINA  
DIVISION OF HIGHWAYS

# ***INDEX OF CROSS SECTION SHEETS***

-L-	US 13 /NC 11/NC 903 (MEMORIAL DRIVE)	X-1 TO X-13
-L- (TEMP)	(SHOWING -XOVR1- WORK)	X-14 TO X-17
-L- (TEMP)	(SHOWING -XOVR2- WORK)	X-18 TO X-22

**STATE OF NORTH CAROLINA  
DIVISION OF HIGHWAYS**

PROJ. REFERENCE NO.	SHEET NO.
B-4786	X-B

NOTE: EMBANKMENT COLUMN DOES NOT INCLUDE BACKFILL FOR UNDERCUT

**CROSS-SECTION SUMMARY**

Station	Uncl. Exc.	Embt	L Station	Uncl. Exc.	Embt										
L	(cu. yd.)	(cu. yd.)	XOVR2 (Const)	(cu. yd.)	(cu. yd.)										
22+00.00	0	0	33+21.43	0	0										
22+50.00	36	0	33+50.00	0	0										
23+00.00	51	1	34+00.00	3	4										
23+50.00	32	7	34+50.00	4	6										
24+00.00	56	18	35+00.00	6	6										
24+50.00	80	33	35+50.00	5	10										
25+00.00	56	46	36+00.00	3	8										
25+28.00	21	28	36+39.20	1	1										
						Approximate quantities only. Unclassified excavation, borrow excavation, fine grading, clearing and grubbing, and removal of existing pavement will be paid for at the lump sum price for "Grading".									
Station	Uncl. Exc.	Embt	L Station	Uncl. Exc.	Embt										
L	(cu. yd.)	(cu. yd.)	XOVR2 (Remove)	(cu. yd.)	(cu. yd.)										
30+78.00	0	0	33+21.43	0	0										
31+00.00	69	29	33+50.00	0	0										
31+50.00	168	70	34+00.00	4	3										
32+00.00	90	51	34+50.00	6	4										
32+50.00	2	23	35+00.00	6	6										
33+00.00	7	11	35+50.00	10	5										
33+50.00	14	4	36+00.00	8	3										
34+00.00	21	4	36+39.20	1	1										
34+50.00	30	3													
35+00.00	21	2													
L Station	Uncl. Exc.	Embt													
XOVR1 (Const)	(cu. yd.)	(cu. yd.)													
18+78.61	0	0													
19+00.00	1	0													
19+50.00	7	0													
20+00.00	9	0													
20+50.00	12	0													
21+00.00	14	0													
21+50.00	17	0													
22+00.00	20	0													
22+50.00	15	0													
22+95.70	4	0													
L Station	Uncl. Exc.	Embt													
XOVR1 (Remove)	(cu. yd.)	(cu. yd.)													
18+78.61	0	0													
19+00.00	0	1													
19+50.00	0	7													
20+00.00	0	9													
20+50.00	0	12													
21+00.00	0	14													
21+50.00	0	17													
22+00.00	0	20													
22+50.00	0	15													
22+95.70	0	4													

8/23/99

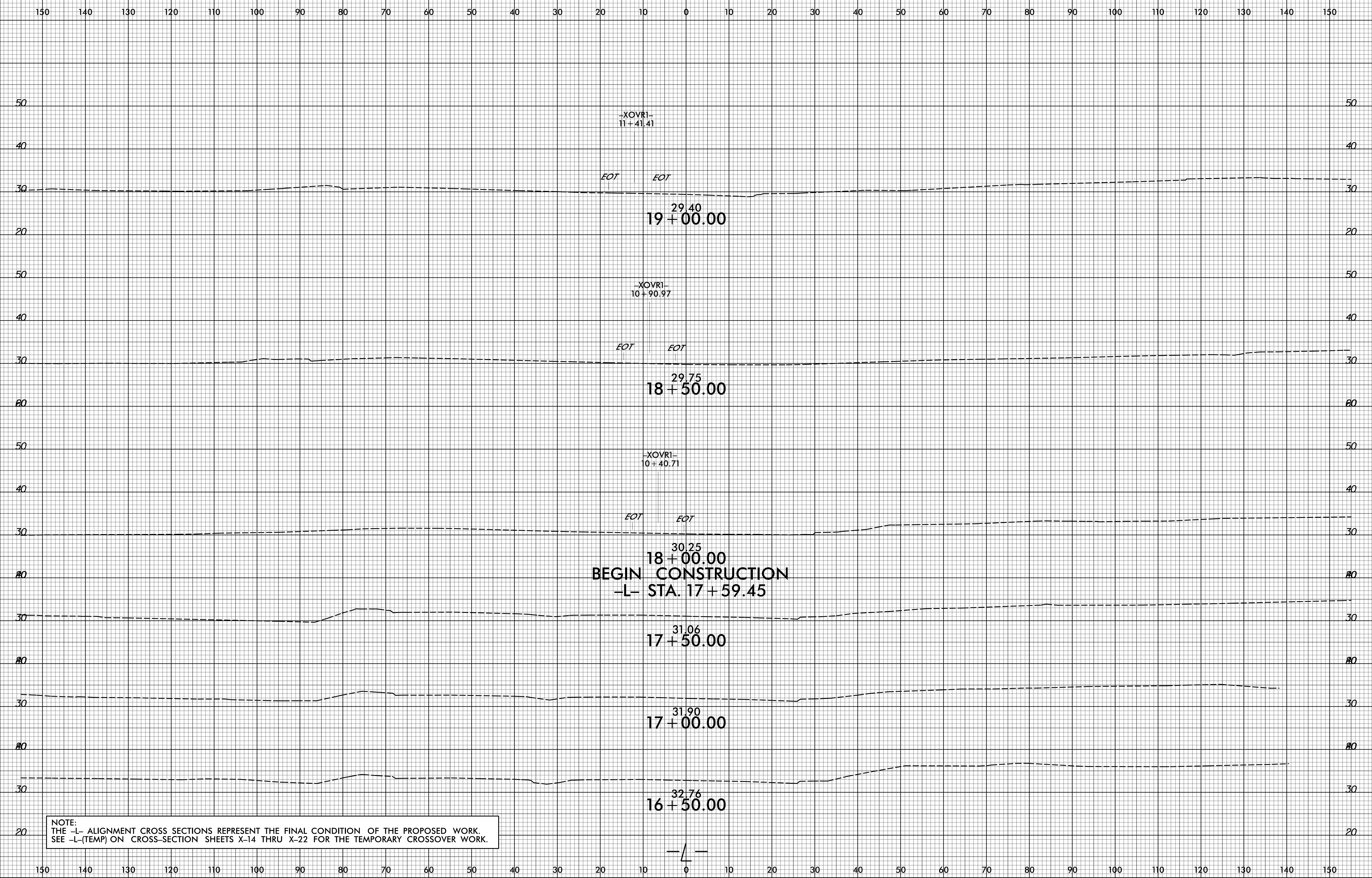

NOTE:  
 THE -L- ALIGNMENT CROSS SECTIONS REPRESENT THE FINAL CONDITION OF THE PROPOSED WORK.  
 SEE -L-(TEMP) ON CROSS-SECTION SHEETS X-14 THRU X-22 FOR THE TEMPORARY CROSSOVER WORK.

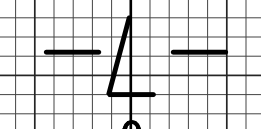

12/10/2021  
 G:\Projects\NCDOT\B-4786\Roadway\CorridorModeling\B-4786\_rdy\_xpl.dgn  
 User: jmcgovern

8/23/99

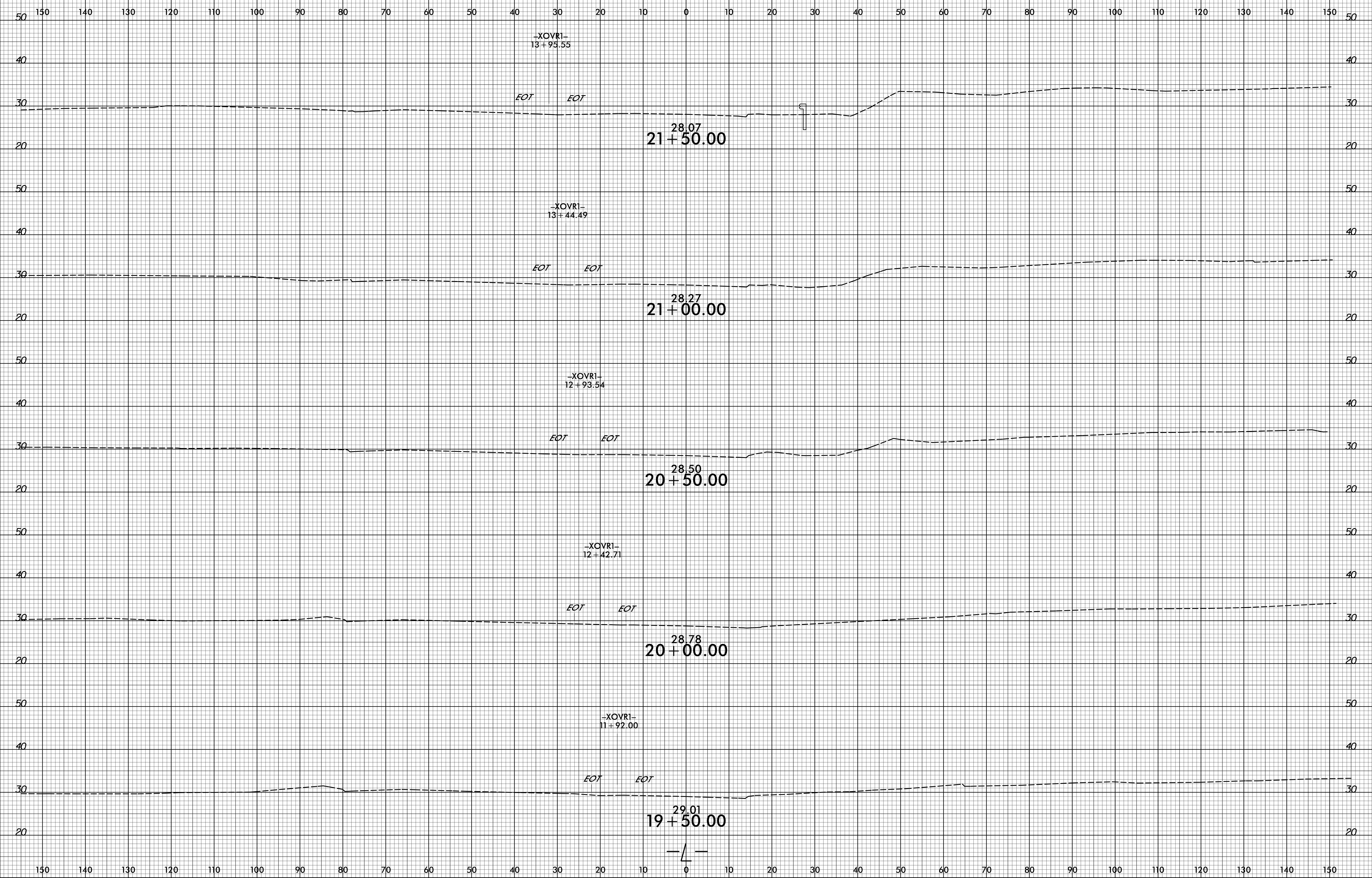

12/10/2021 G:\Projects\NCDOT\B-4786\Roadway\CorridorModeling\B4786\_rdy\_xpl.dgn

8/23/99

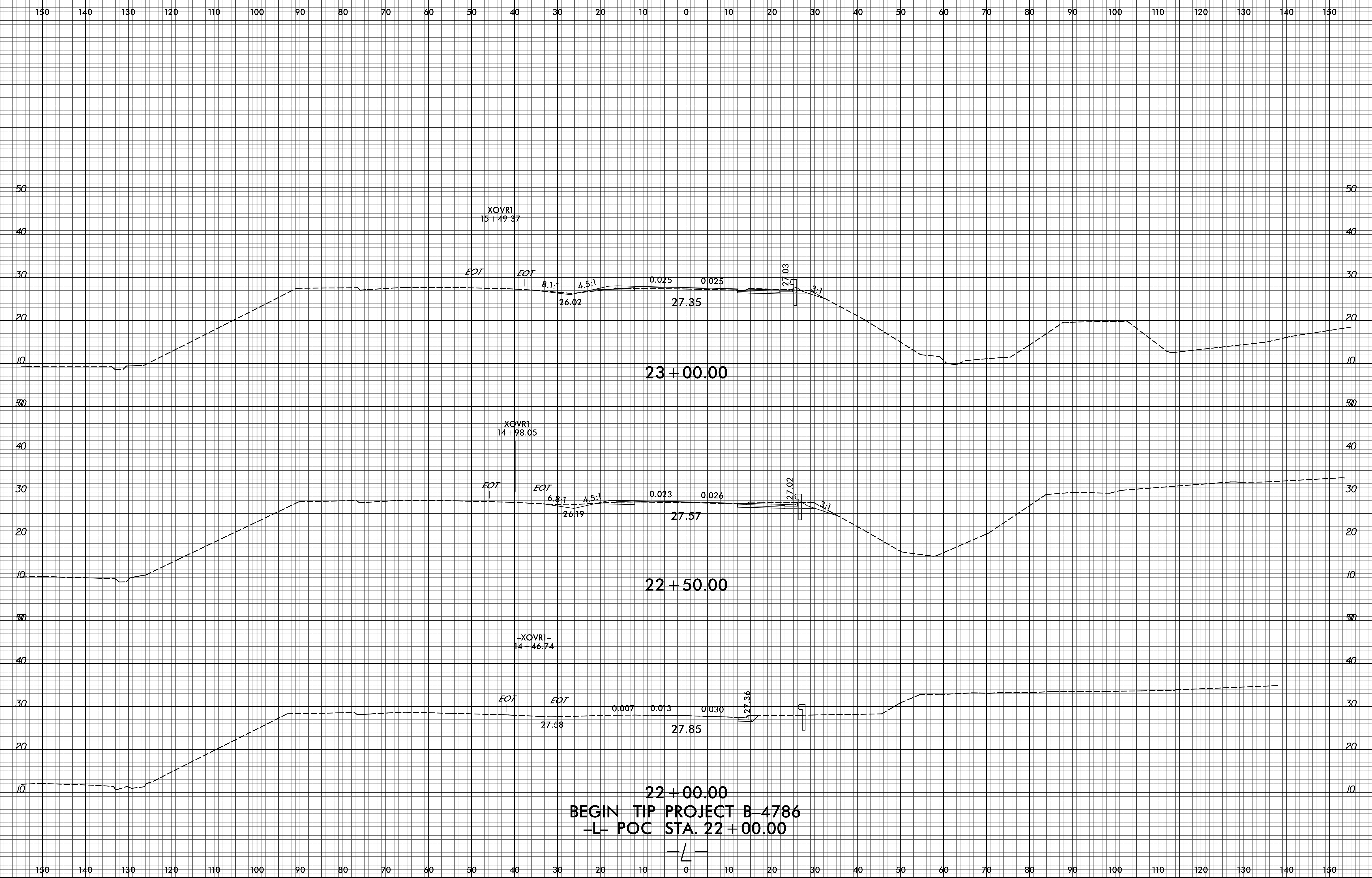

12/10/2021  
G:\Projects\NCDOT\B-4786\Roadway\CorridorModeling\B-4786\_rdy\_xpl.dgn  
User:dlower4

22 + 00.00  
 BEGIN TIP PROJECT B-4786  
 -L- POC STA. 22 + 00.00

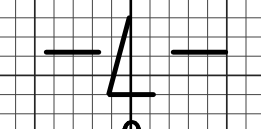

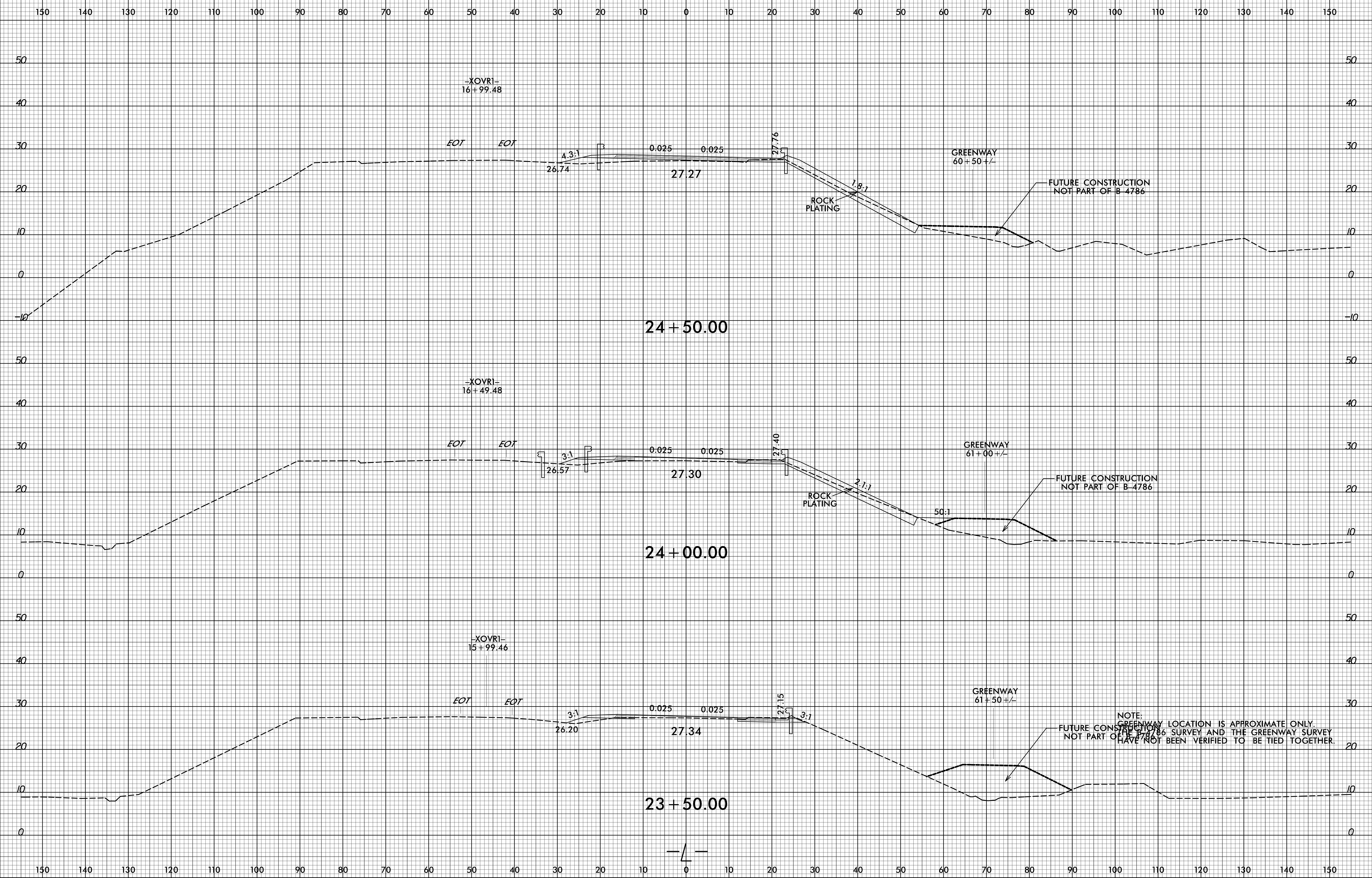

8/23/99

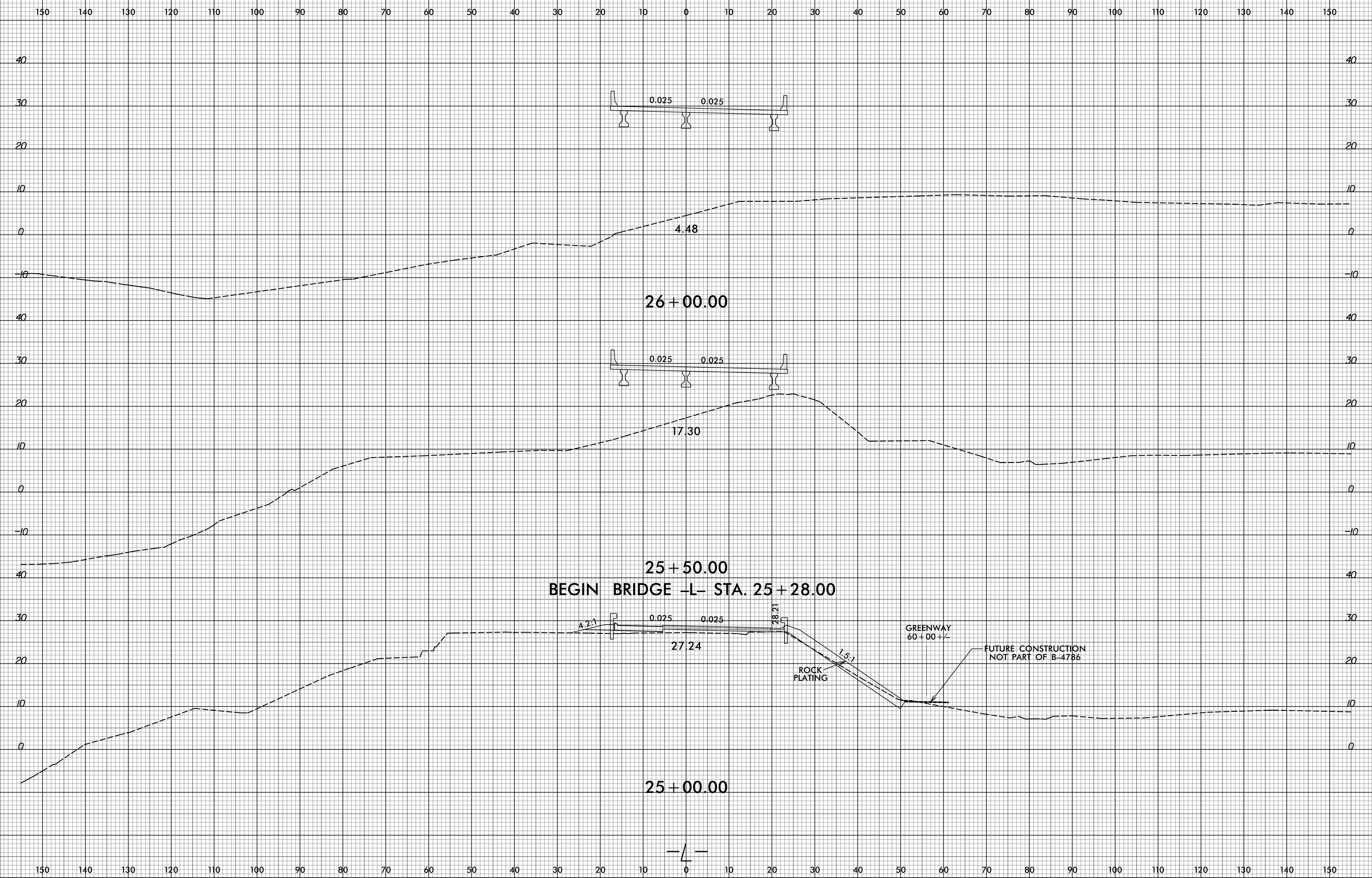

2/8/2022  
C:\Projects\NCDOT\B-4786\Roadway\CorridorModeling\B-4786\_rdy\_xpl.dgn  
User:dlower4



8/23/99

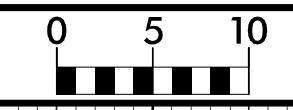

PROJ. REFERENCE NO.  
B-4786

SHEET NO.  
X-6

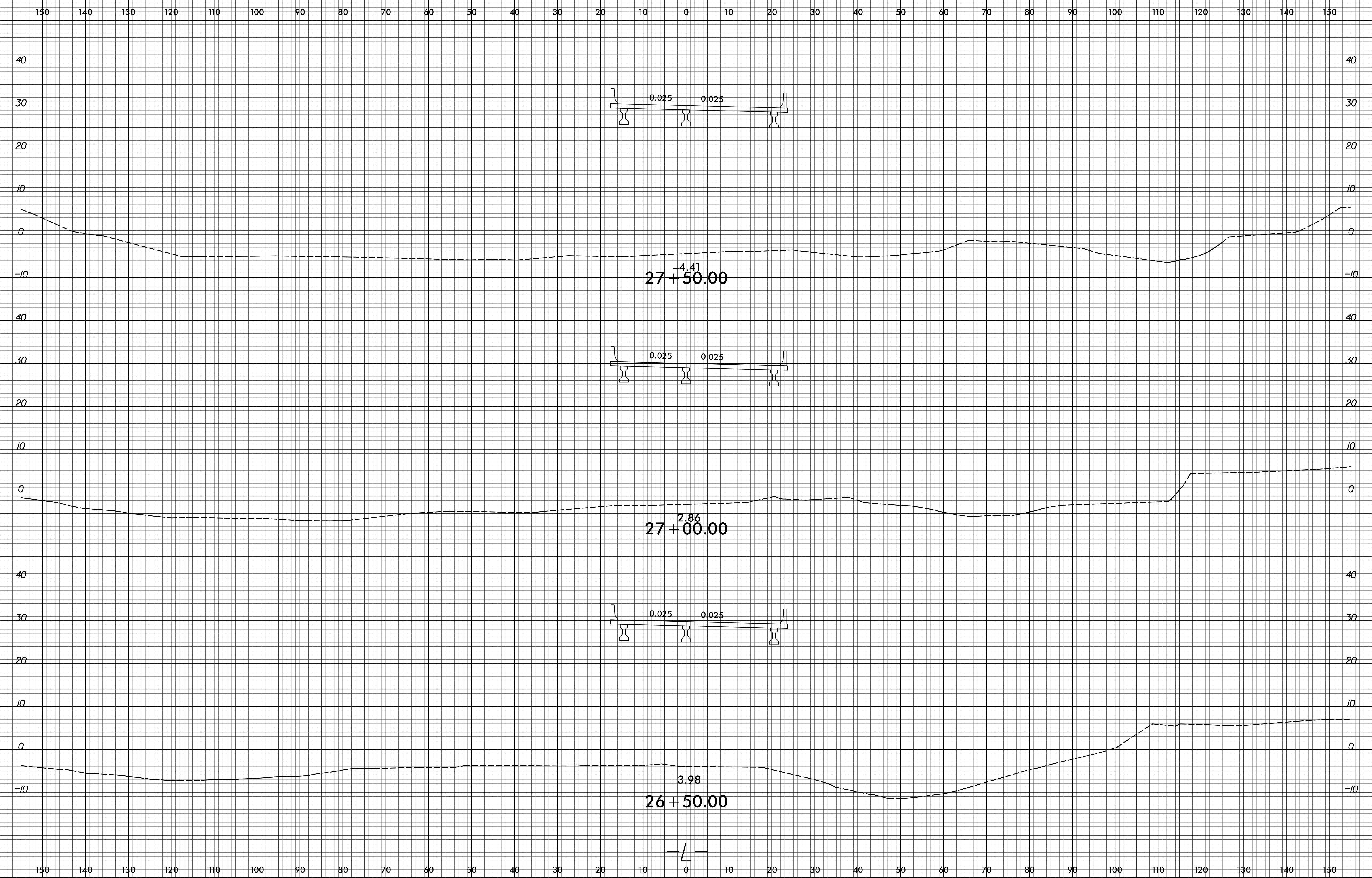

12/10/2021  
G:\Projects\NCDOT\B-4786\Roadway\CorridorModeling\B4786\_rdy\_xpl.dgn  
User:mlower4

8/23/99

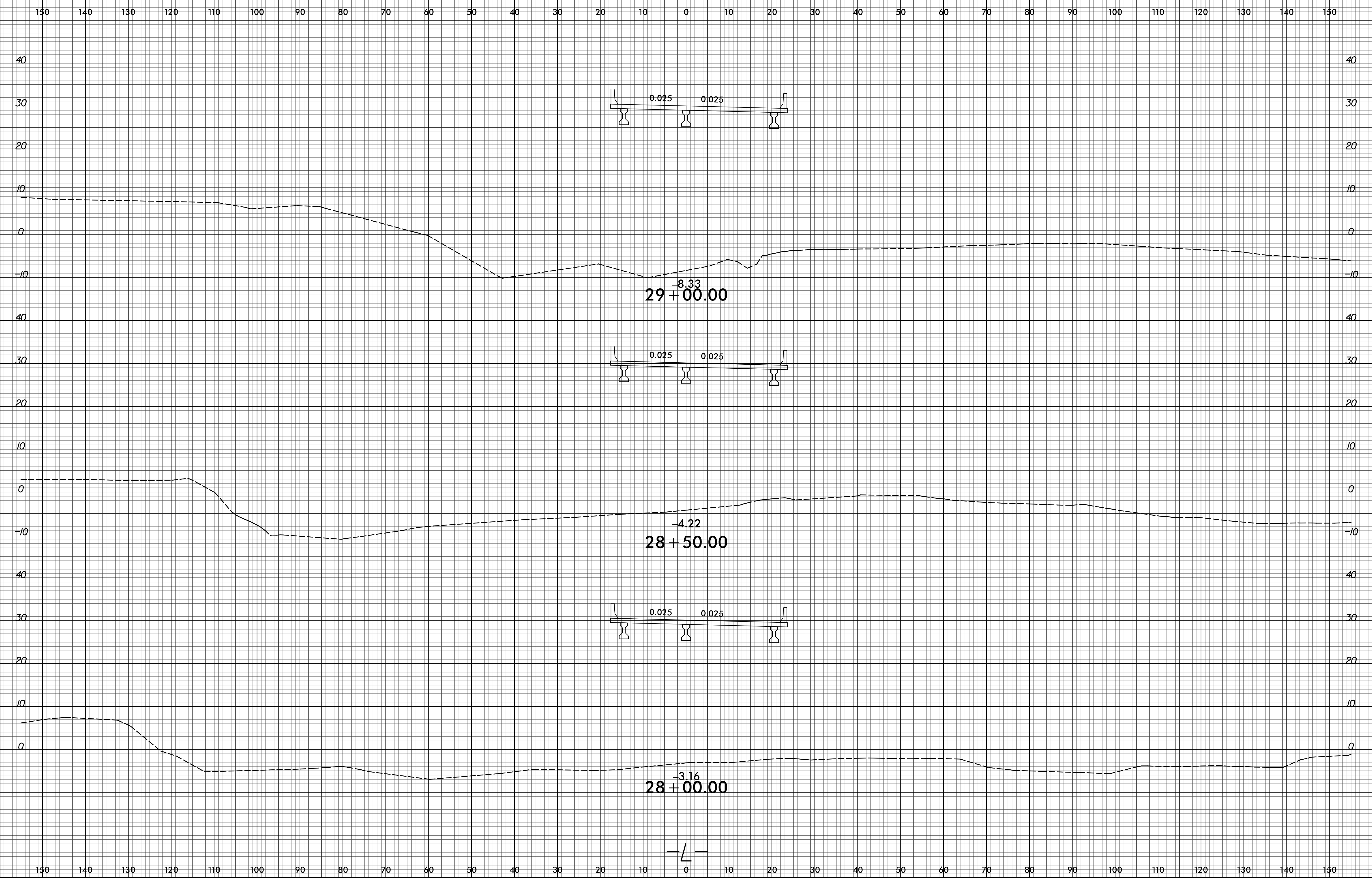

12/10/2021 G:\Projects\NC001\B-4786\Roadway\CorridorModeling\B4786\_rdy\_xpl.L.dgn

8/23/99

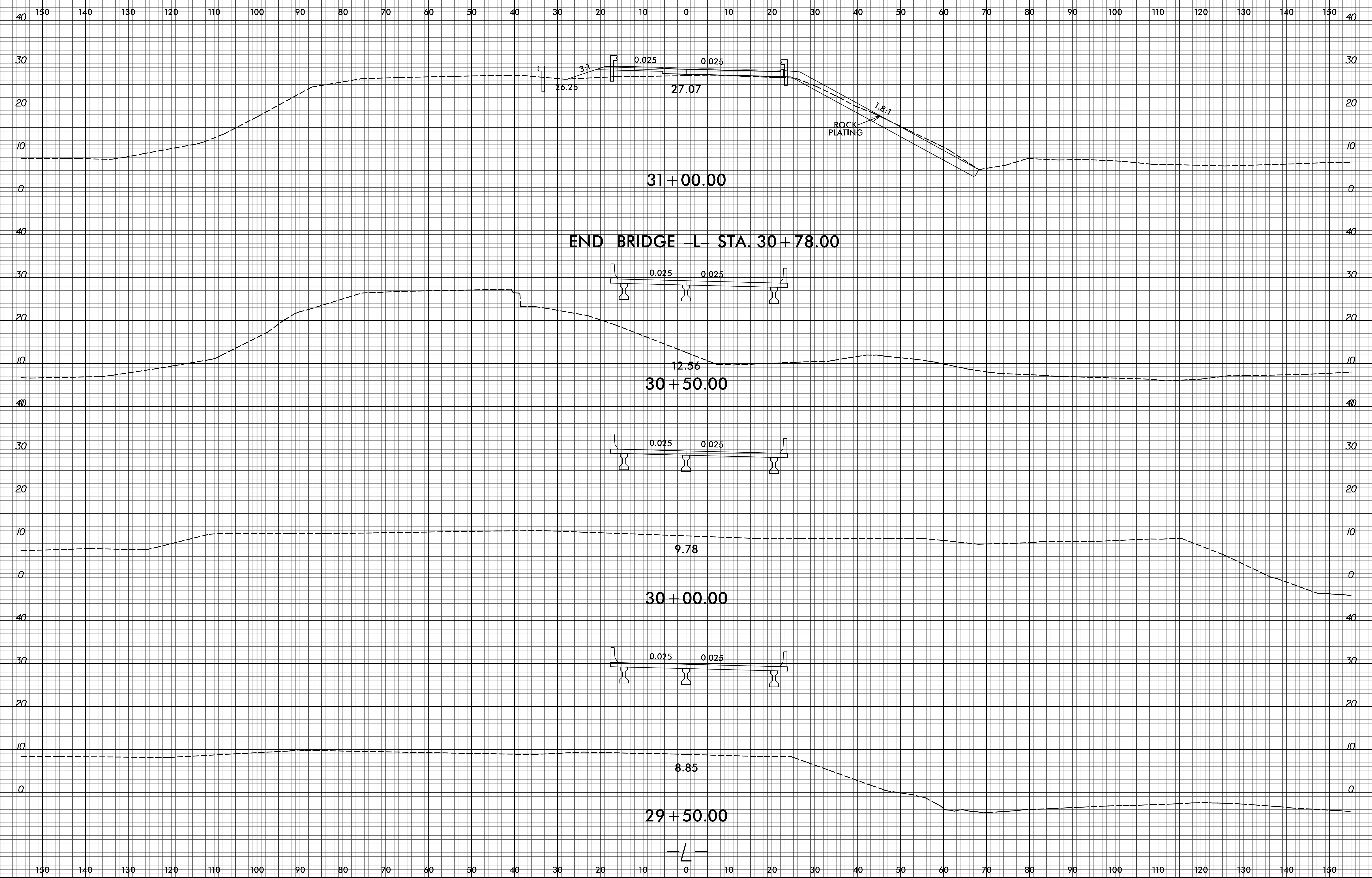

12/10/2021 G:\Projects\NC001\B-4786\Roadway\CorridorModeling\B-4786\_rdy\_xpl.dgn

8/23/99

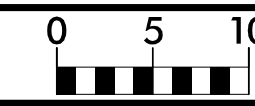

PROJ. REFERENCE NO.  
B-4786

SHEET NO.  
X-9

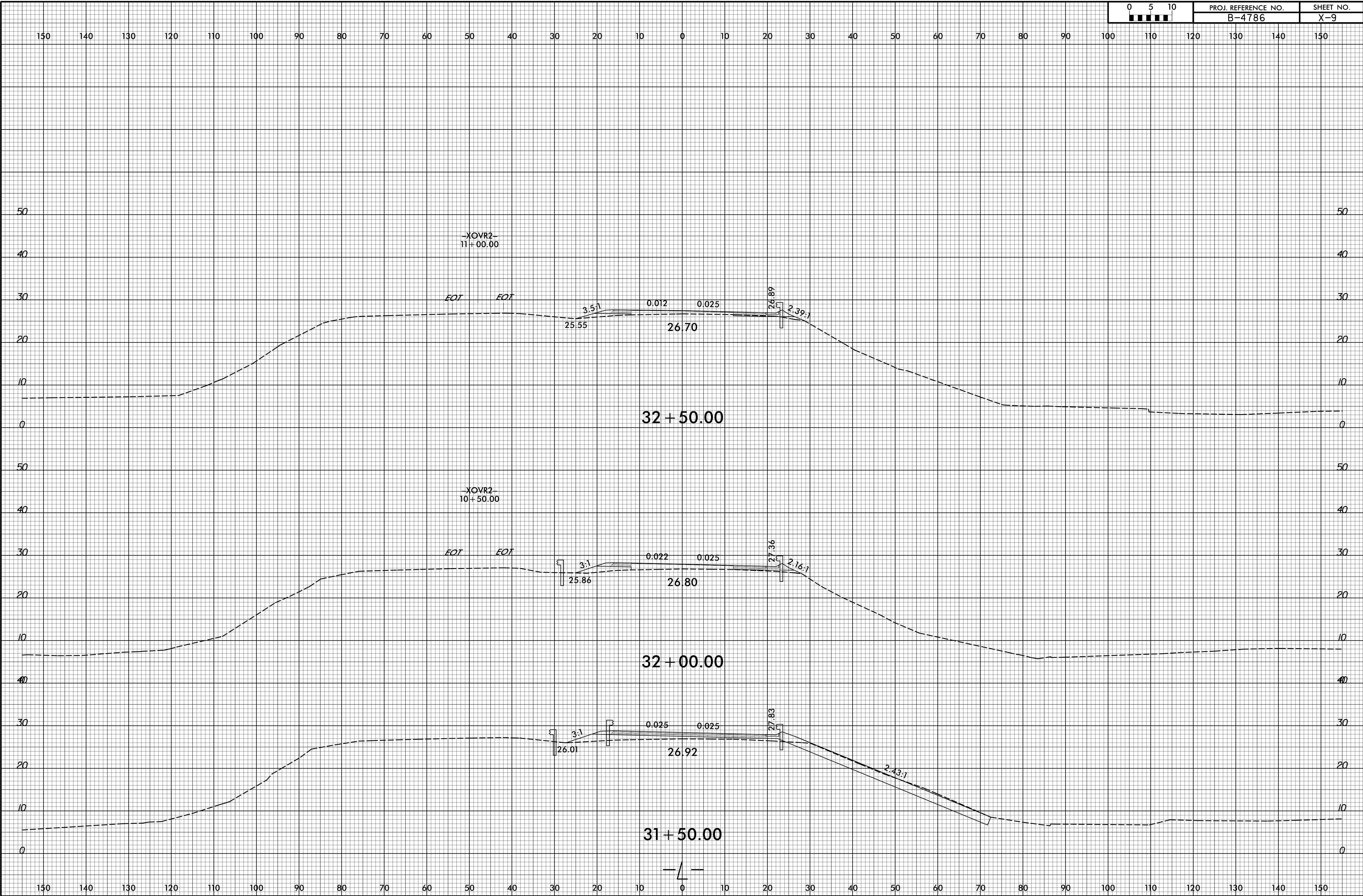

12/10/2021  
G:\Projects\NCDOT\B-4786\Roadway\CorridorModeling\B4786\_rdy\_xpl.dgn  
User:mlower

8/23/99

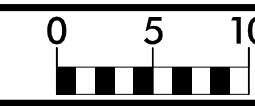

PROJ. REFERENCE NO.	SHEET NO.
B-4786	X-10

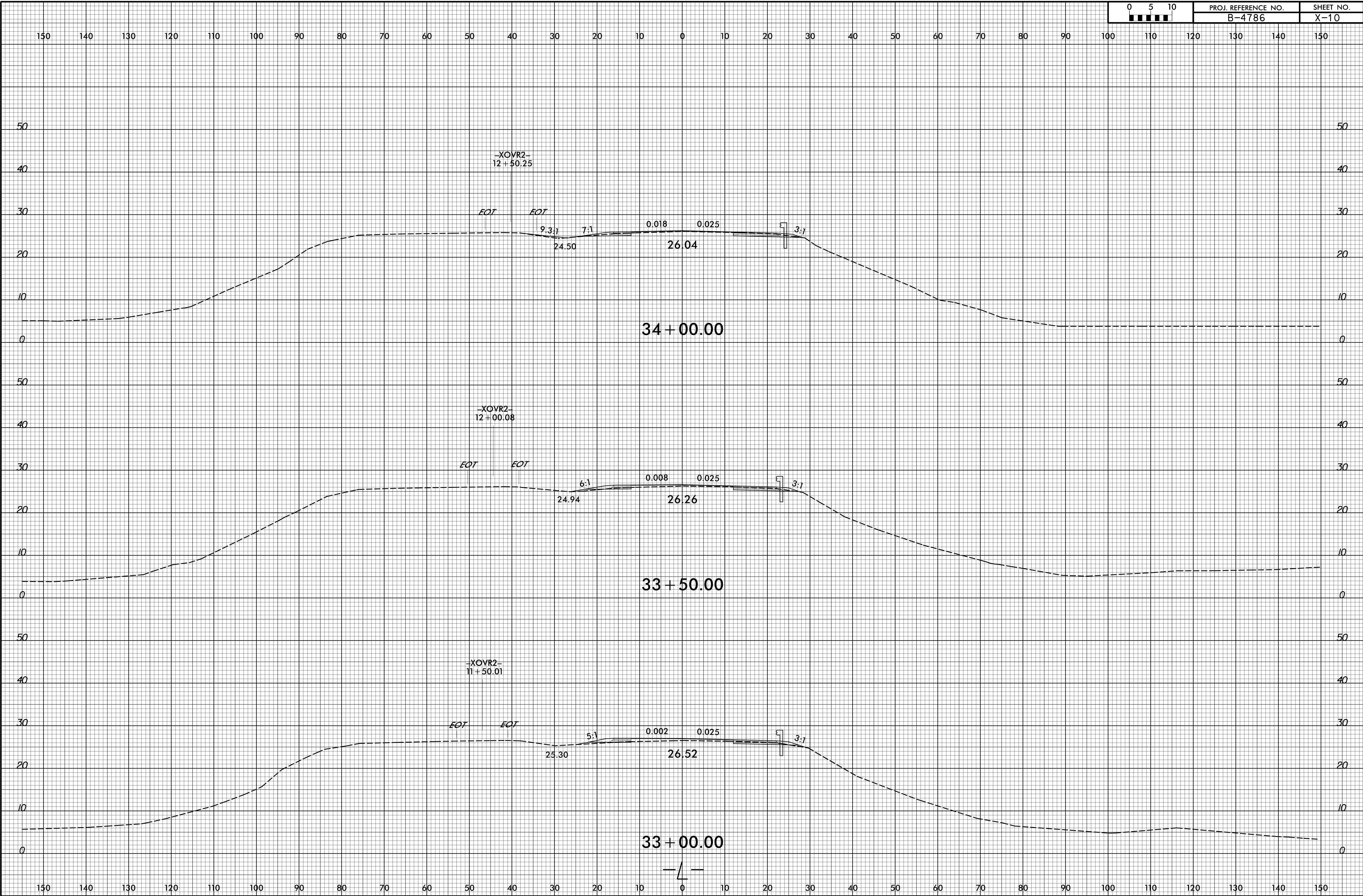

12/10/2021  
 G:\Projects\NCDOT\B-4786\Roadway\CorridorModeling\B4786\_rdy\_xpl.dgn  
 User:mlower4

8/23/99

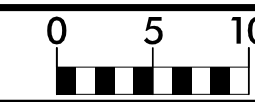

PROJ. REFERENCE NO.  
B-4786

SHEET NO.  
X-11

150 140 130 120 110 100 90 80 70 60 50 40 30 20 10 0 10 20 30 40 50 60 70 80 90 100 110 120 130 140 150

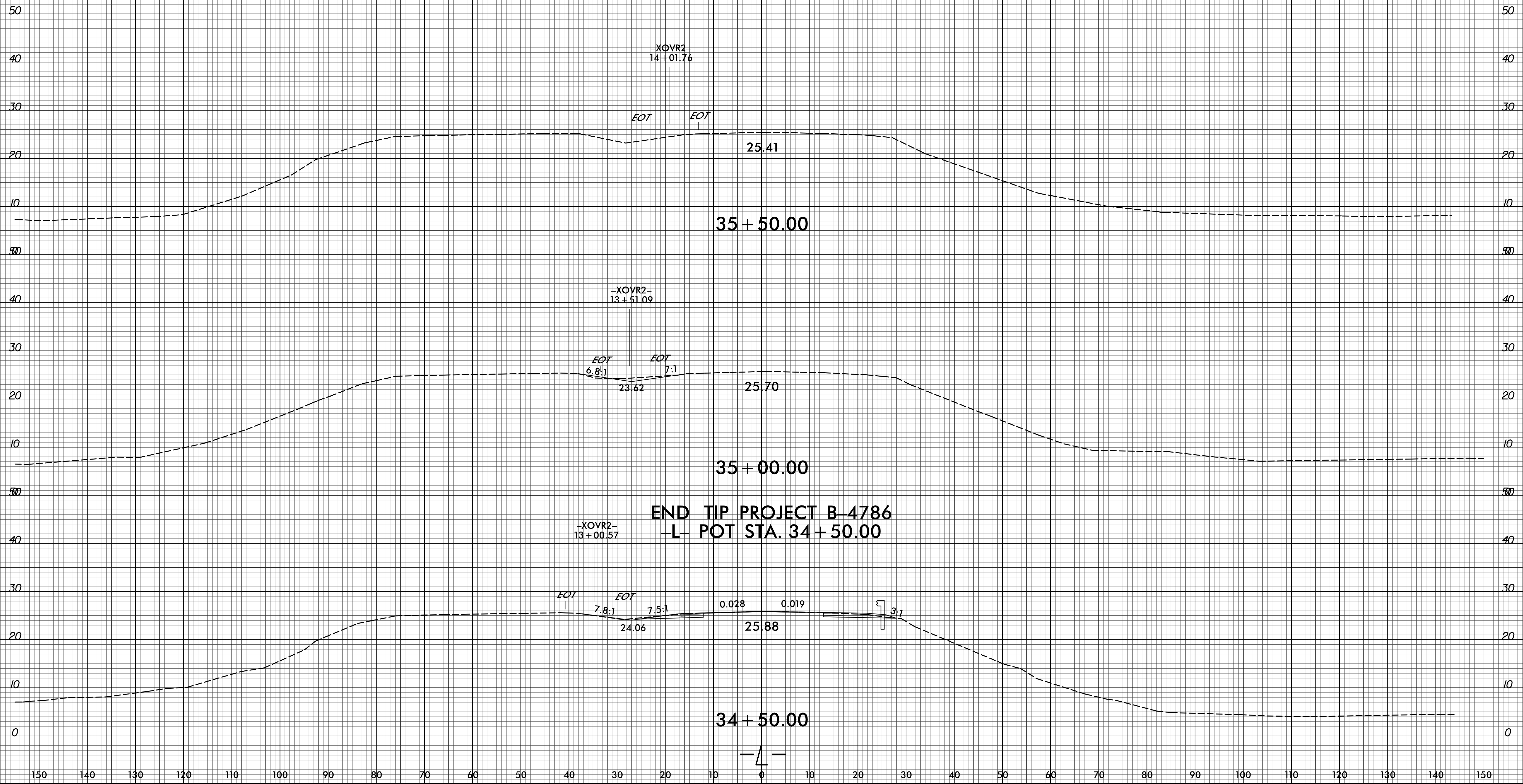

END TIP PROJECT B-4786  
-L- POT STA. 34 + 50.00

12/10/2021  
G:\Projects\NCDOT\B-4786\Roadway\CorridorModeling\B4786\_rdy\_xpl.L.dgn  
User:mlower4

150 140 130 120 110 100 90 80 70 60 50 40 30 20 10 0 10 20 30 40 50 60 70 80 90 100 110 120 130 140 150

8/23/99

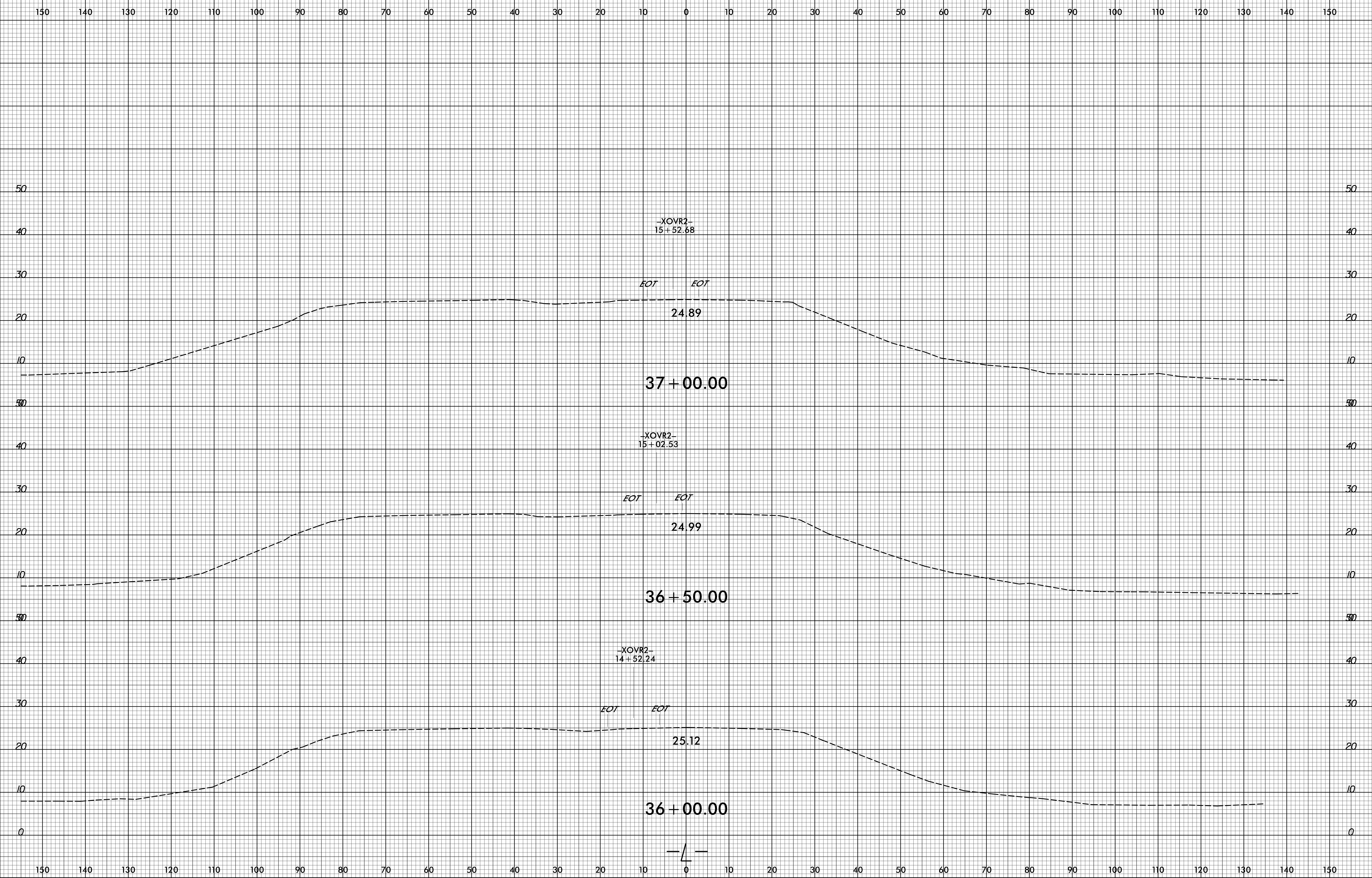

12/10/2021 G:\Projects\NCDOT\B-4786\Roadway\CorridorModeling\B4786\_rdy\_xpl.L.dgn

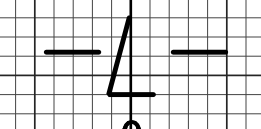

150 140 130 120 110 100 90 80 70 60 50 40 30 20 10 0 10 20 30 40 50 60 70 80 90 100 110 120 130 140 150

**END CONSTRUCTION**  
**-L- STA. 38+12.09**

-XOVR2-  
16+52.74

*FOT* *FOT*

24.88

**38+00.00**

-XOVR2-  
16+02.74

*FOT* *FOT*

24.86

**37+50.00**

-L-

50

40

30

20

10

0

40

30

20

10

0

50

40

30

20

10

0

40

30

20

10

0

150 140 130 120 110 100 90 80 70 60 50 40 30 20 10 0 10 20 30 40 50 60 70 80 90 100 110 120 130 140 150



8/23/99

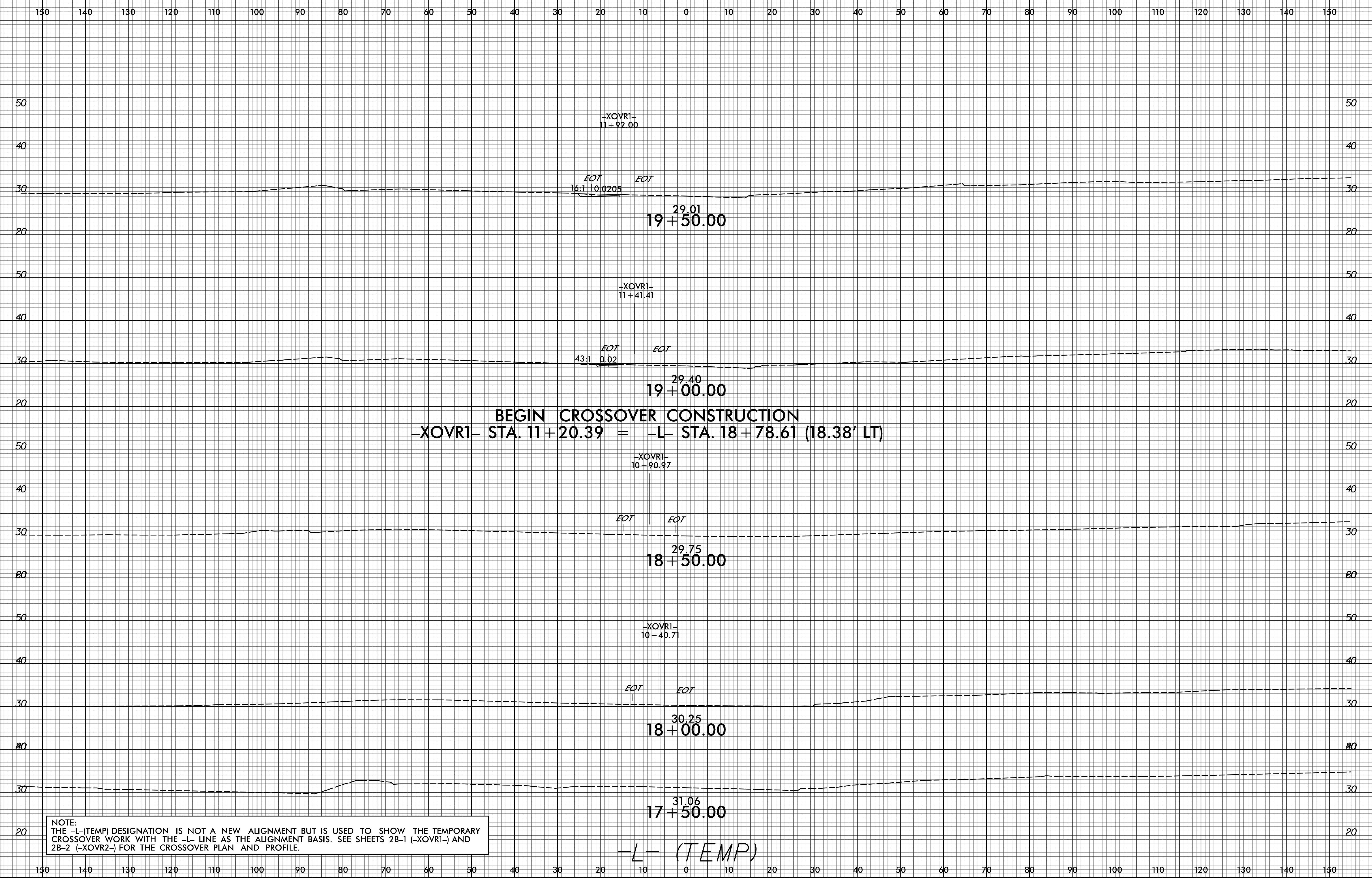

NOTE:  
 THE -L-(TEMP) DESIGNATION IS NOT A NEW ALIGNMENT BUT IS USED TO SHOW THE TEMPORARY CROSSOVER WORK WITH THE -L- LINE AS THE ALIGNMENT BASIS. SEE SHEETS 2B-1 (-XOVR1-) AND 2B-2 (-XOVR2-) FOR THE CROSSOVER PLAN AND PROFILE.

2/18/2022  
 G:\Projects\NCDOT\B-4786\Roadway\CorridorModeling\B4786\_rdu\_xpl.L\_TEMP.dgn  
 User: jlowery

8/23/99

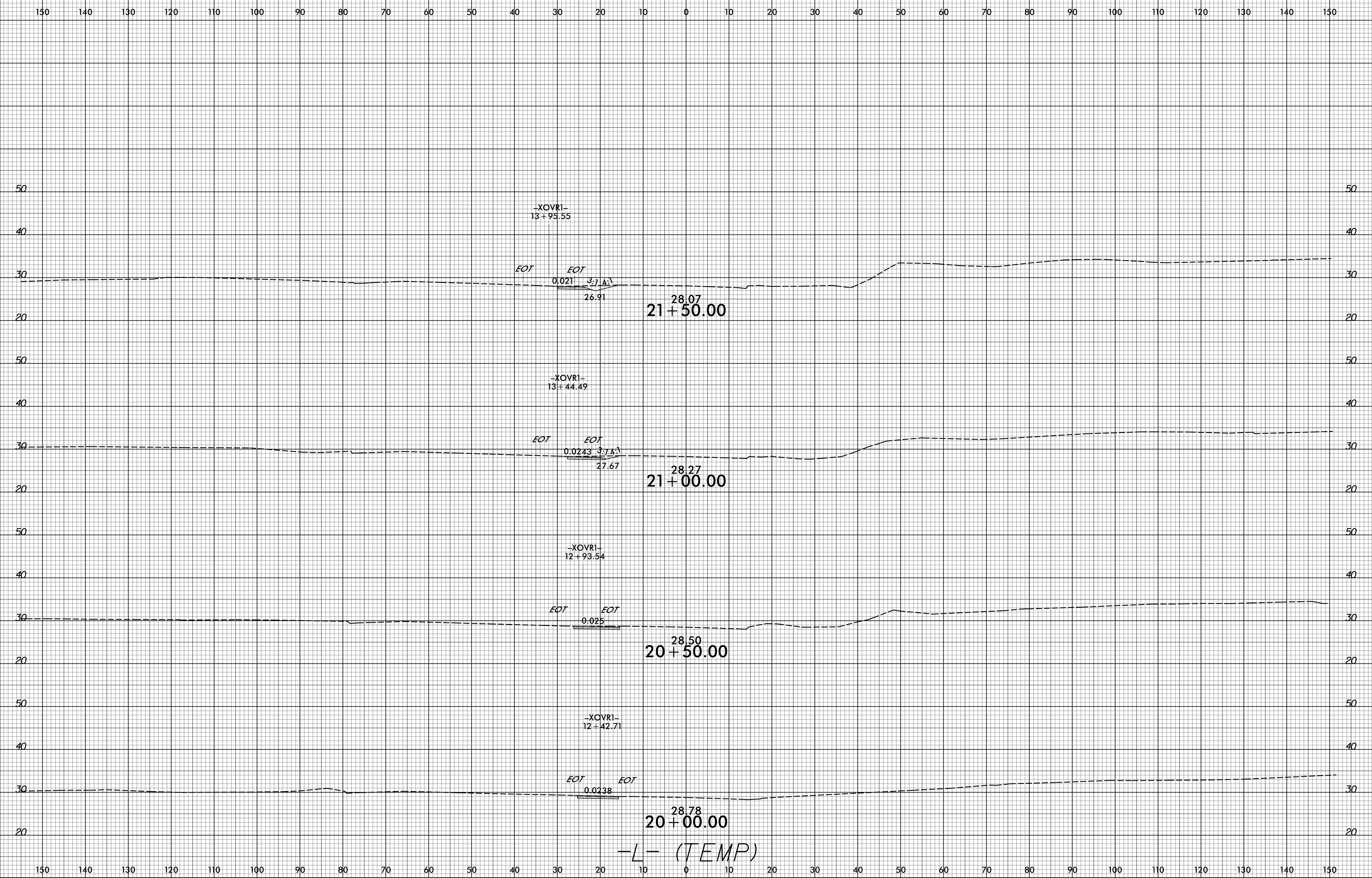

12/10/2021 G:\Projects\NCDOT\B-4786\Roadway\CorridorModeling\B4786\_rdu\_xpl\_L\_TEMP.dgn

8/23/99

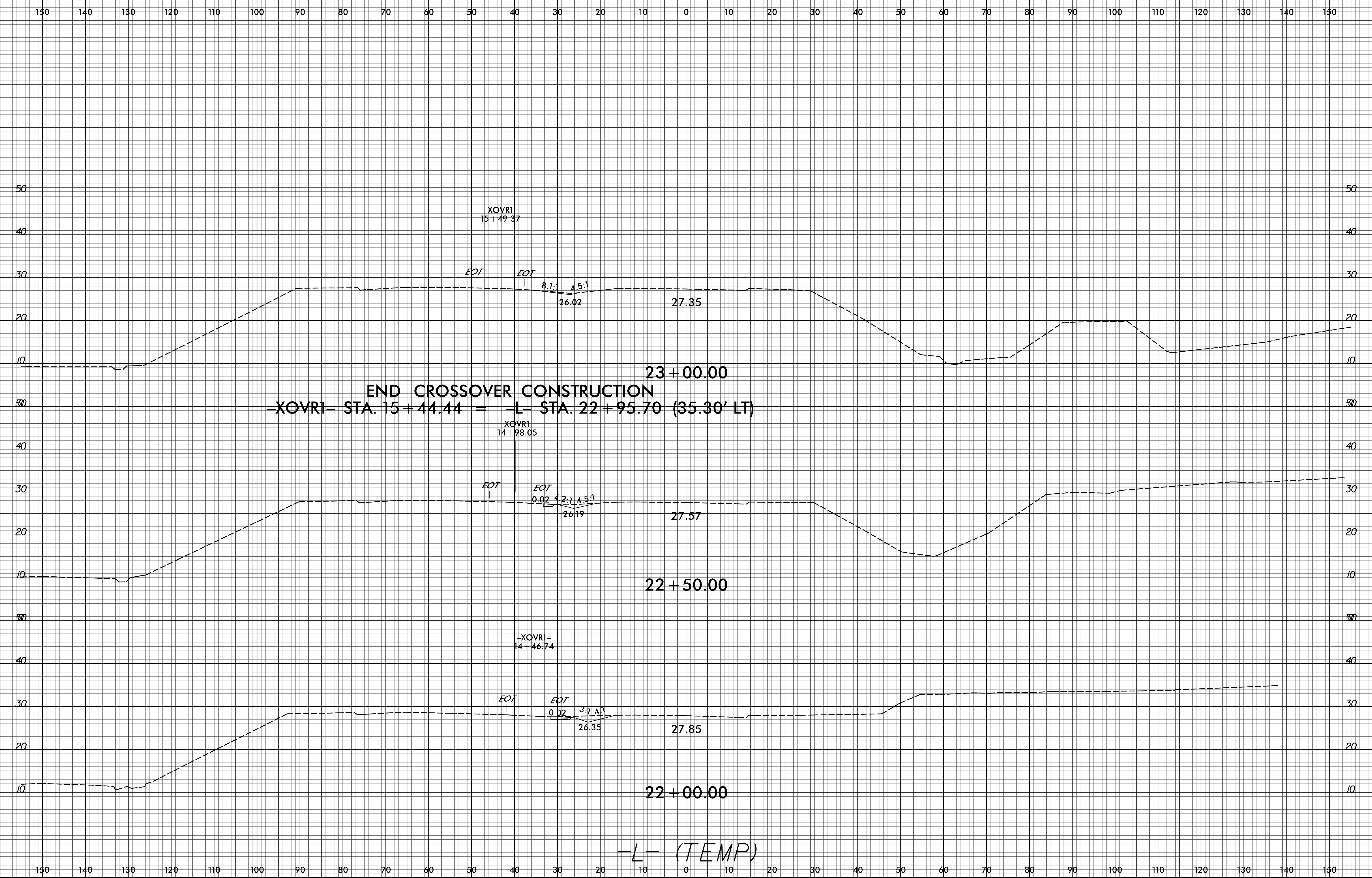

2/18/2022  
G:\Projects\NCDOT\B-4786\Roadway\CorridorModeling\B-4786\_rdy\_xpl.L\_TEMP.dgn  
User:mlower4

8/23/99

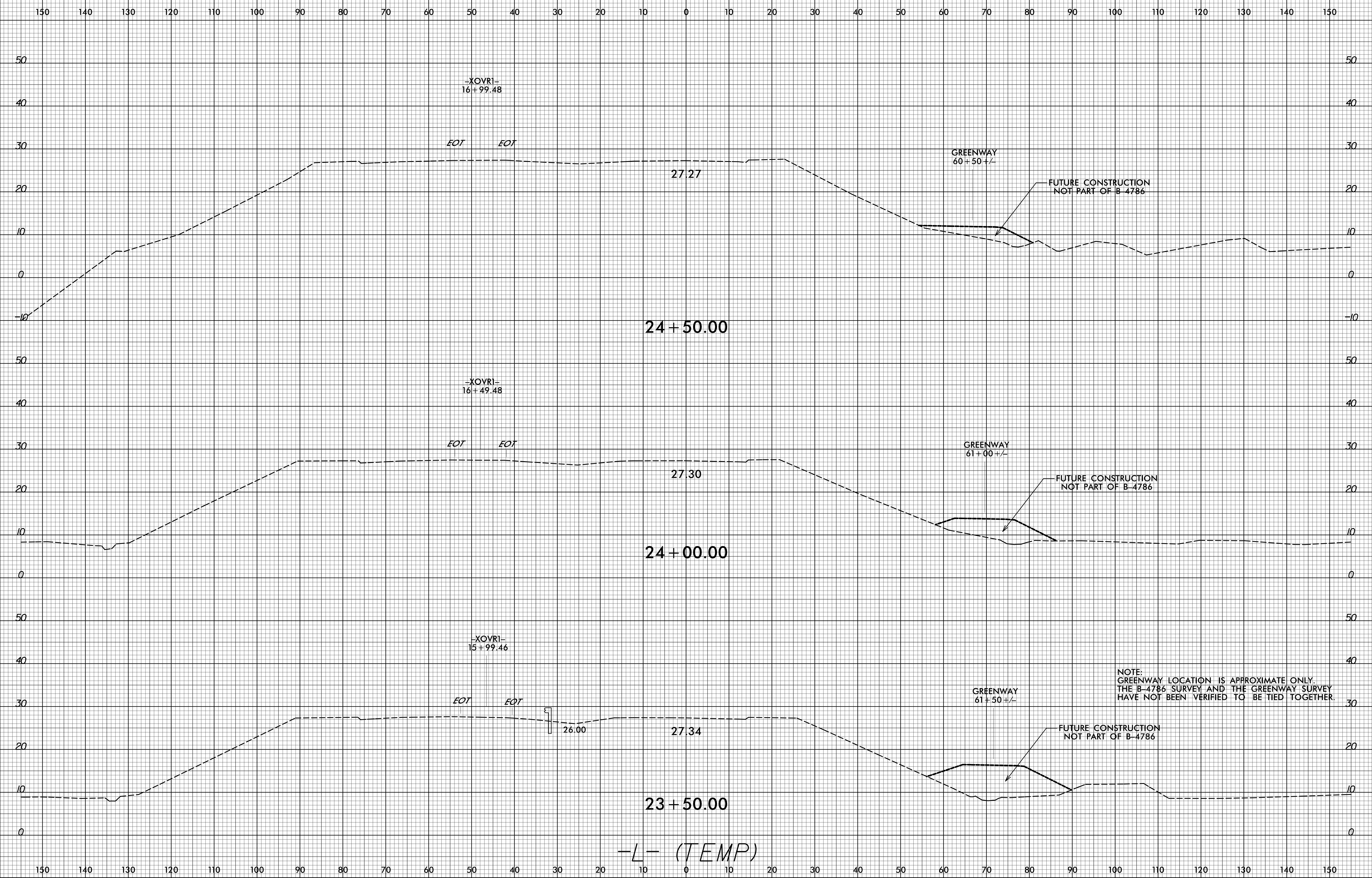

NOTE:  
 GREENWAY LOCATION IS APPROXIMATE ONLY.  
 THE B-4786 SURVEY AND THE GREENWAY SURVEY  
 HAVE NOT BEEN VERIFIED TO BE TIED TOGETHER.

-L- (TEMP)

2/18/2022  
 C:\Projects\NCDOT\B-4786\Roadway\CorridorModeling\B4786\_rdu\_xpl.L\_TEMP.dgn  
 User:mlower4

8/23/99

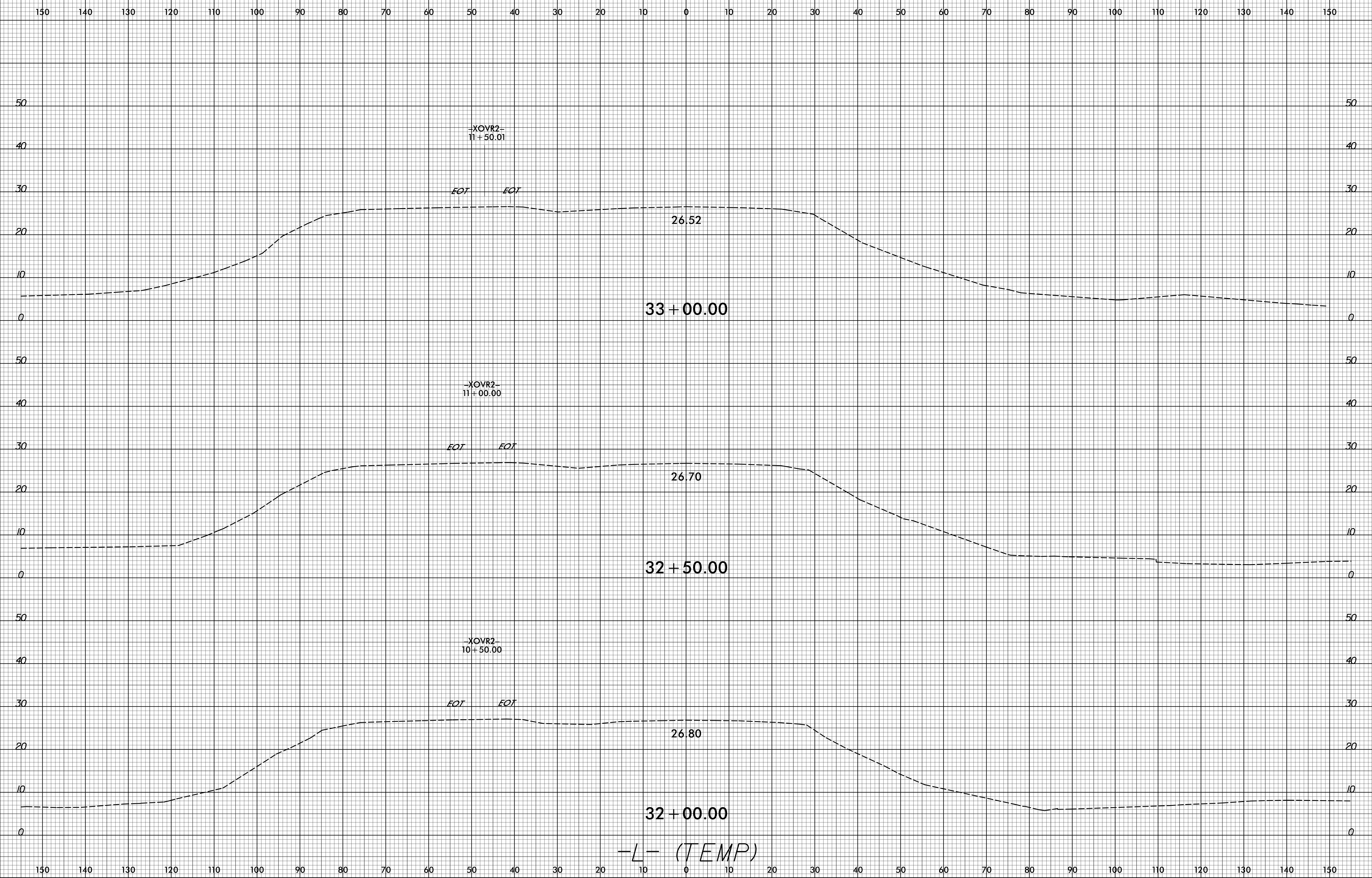

12/10/2021  
G:\Projects\NCDOT\B-4786\Roadway\CorridorModeling\B4786\_rdu\_xpl.L\_TEMP.dgn  
User:mlower4

8/23/99

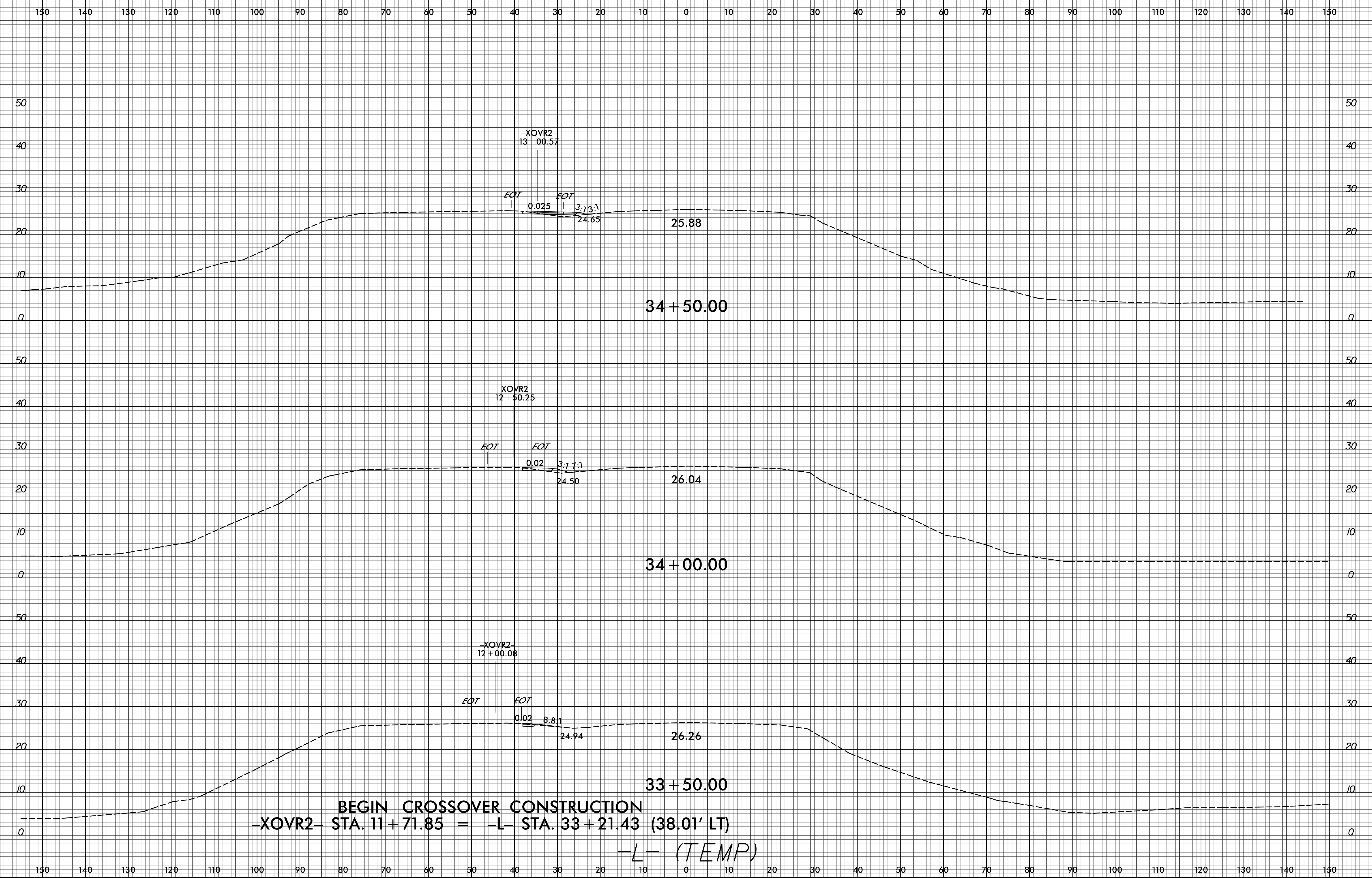

**BEGIN CROSSOVER CONSTRUCTION**  
**-XOVR2- STA. 11 + 71.85 = -L- STA. 33 + 21.43 (38.01' LT)**

**-L- (TEMP)**

2/18/2022  
 G:\Projects\NC001\B-4786\Roadway\CorridorModeling\B-4786\_rdu\_xpl.L\_TEMP.dgn  
 User:dlower

8/23/99

150 140 130 120 110 100 90 80 70 60 50 40 30 20 10 0 10 20 30 40 50 60 70 80 90 100 110 120 130 140 150

**END CROSSOVER CONSTRUCTION**  
 -XOVR2- STA. 14+90.89 = -L- STA. 36+39.20 (15.94' LT)

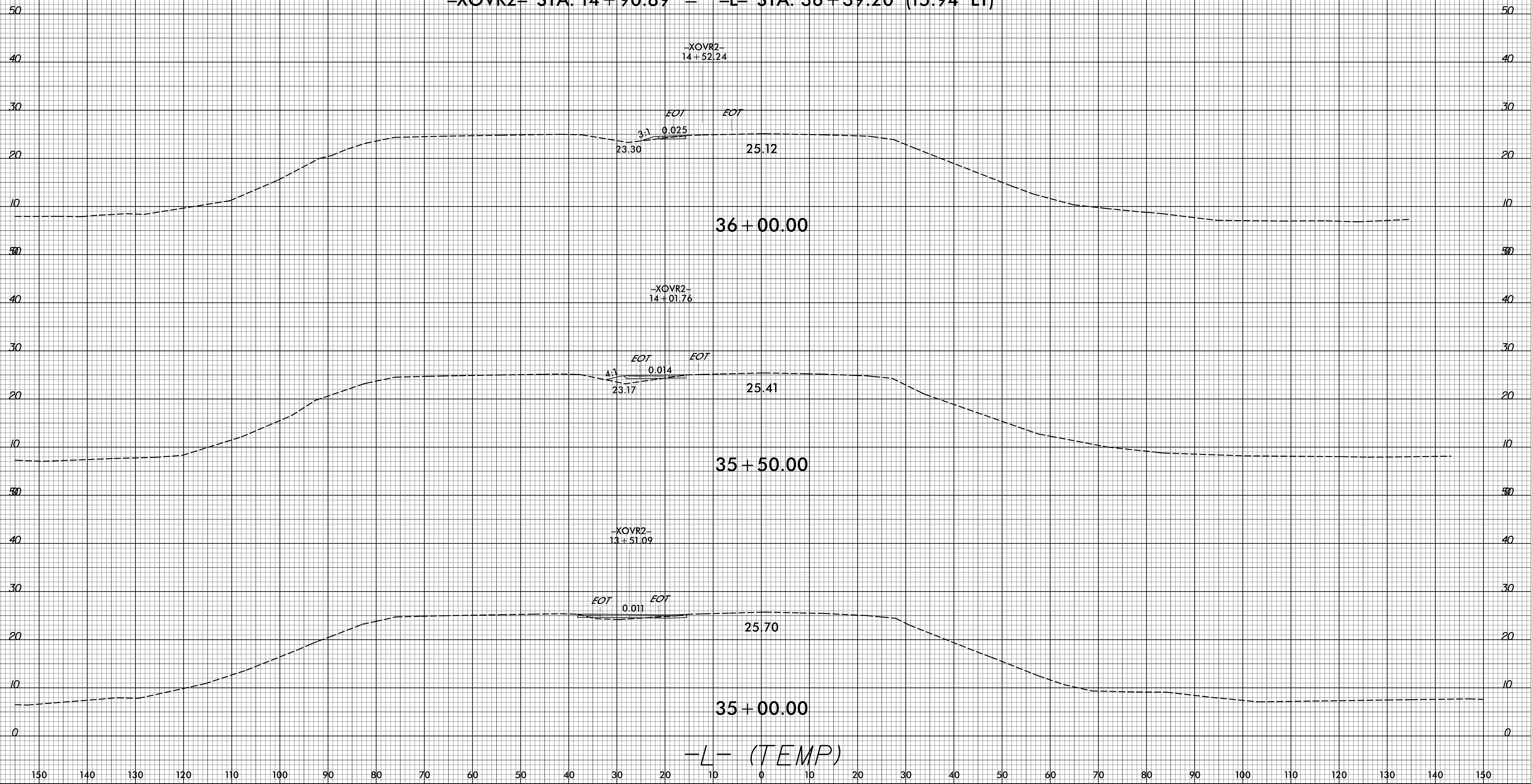

-L- (TEMP)

2/18/2022  
 C:\Projects\NCDOT\B-4786\Roadway\CorridorModeling\B-4786\_rdu\_xpl.L\_TEMP.dgn  
 User:mlower

150 140 130 120 110 100 90 80 70 60 50 40 30 20 10 0 10 20 30 40 50 60 70 80 90 100 110 120 130 140 150

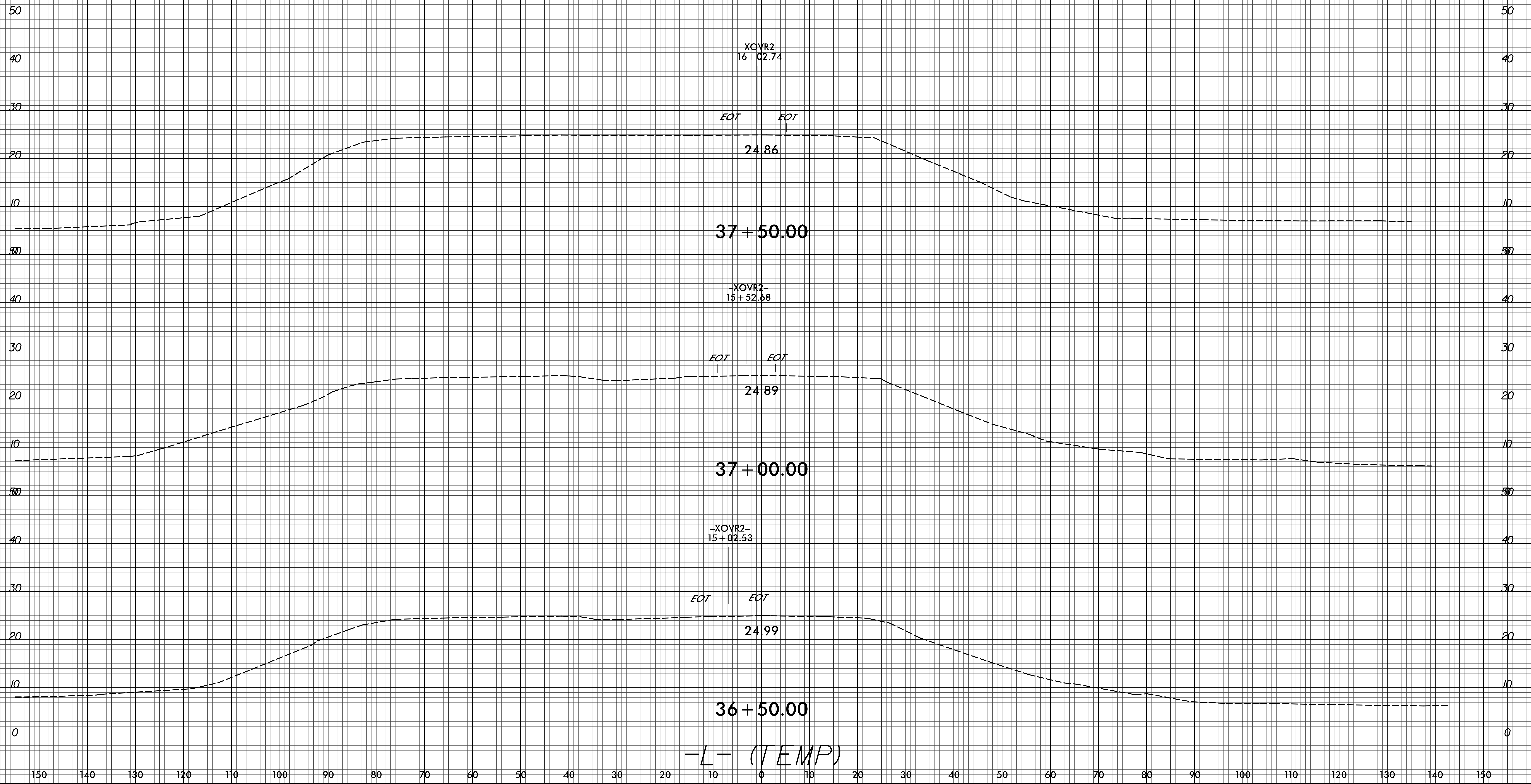

-L- (TEMP)



8/23/99

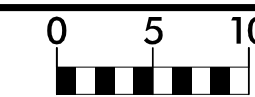

PROJ. REFERENCE NO.
B-4786

SHEET NO.
X-22

150 140 130 120 110 100 90 80 70 60 50 40 30 20 10 0 10 20 30 40 50 60 70 80 90 100 110 120 130 140 150

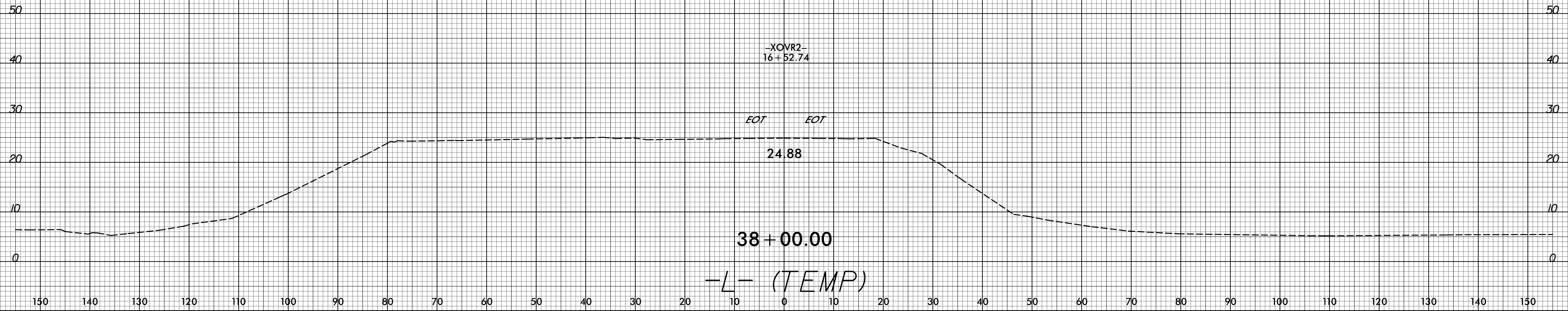

12/10/2021  
G:\Projects\NC001\B-4786\Roadway\CorridorModeling\B4786\_rdu\_xpl.L\_TEMP.dgn  
User:mlower4