

NOTE:
Temporary raised pavement markers will be used along both edge lines to further delineate each direction of travel.

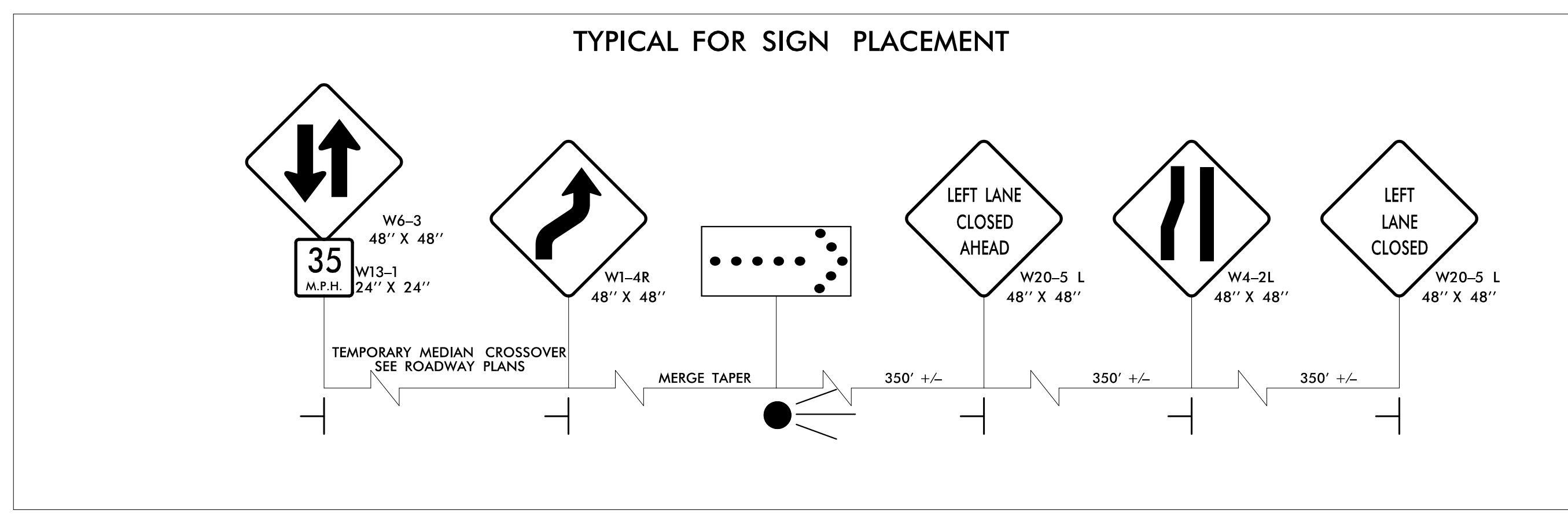

-L- STA. 34 + 50.00
END PROJECT
B-4786

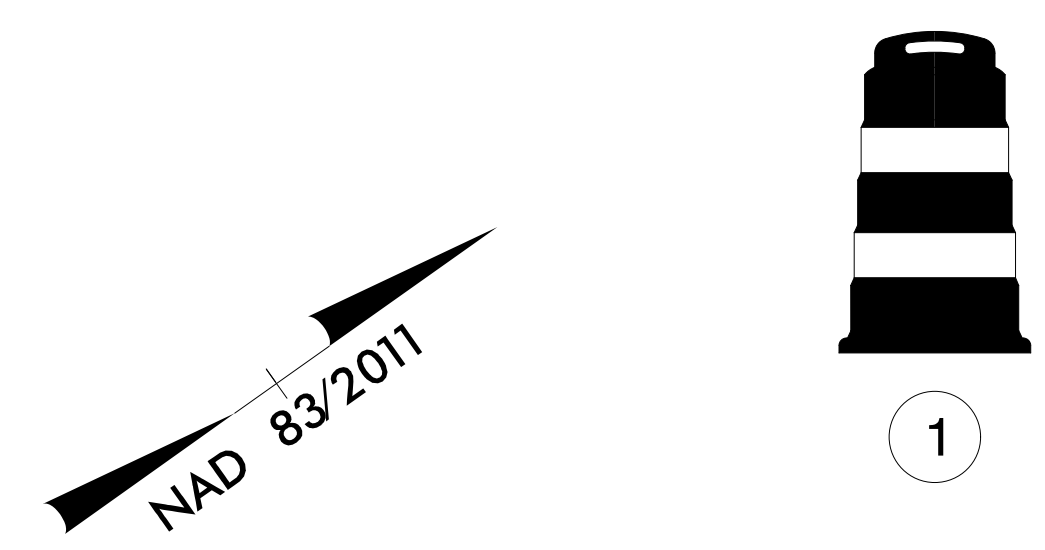
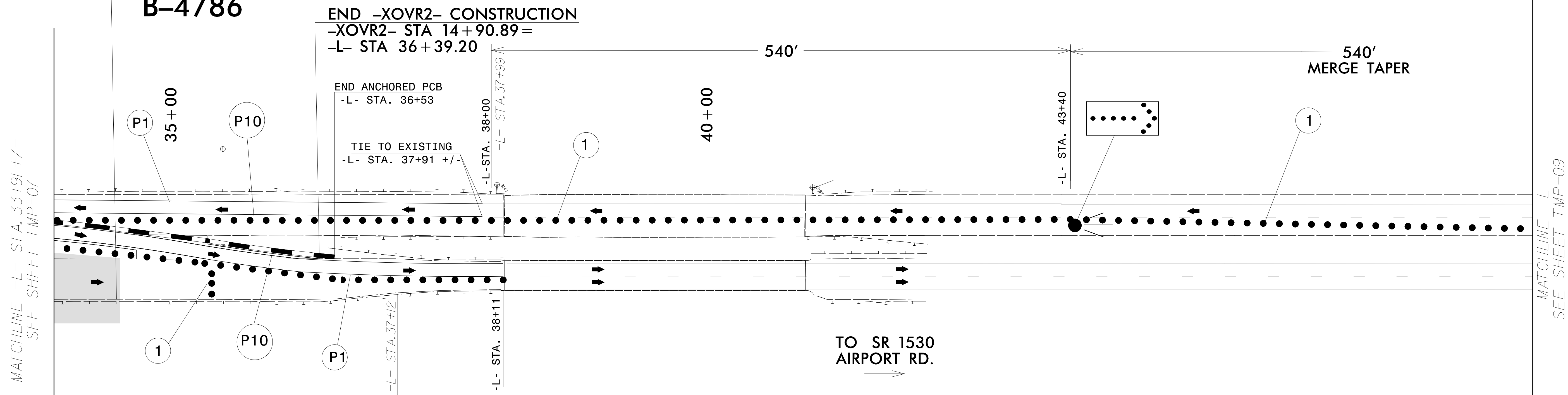

PHASE II NOTES

- STEP 1:** USING RSD 1101.03 (IN CONJUNCTION WITH RSD 1101.02), INSTALL THE TEMPORARY ROAD CLOSURE FOR NORTHBOUND TRAFFIC UTILIZING THE TEMPORARY MEDIAN CROSSOVERS, -XOVR1- AND -XOVR2-. THIS STEP WILL INCLUDE: PLACING ALL SIGNING, PORTABLE CONCRETE BARRIER, FROM STATION -L- STA. 19+06 TO -L- STA. 36+53 TYPE III BARRICADES, TEMPORARY PAVEMENT MARKINGS, AND SIGNAL TIMING ADJUSTMENT FOR THE INTERSECTION WITH W. 3RD STREET. THIS STEP WILL ALSO INCLUDE TEMPORARY ADJUSTMENT OF EXISTING SOUTHBOUND MEDIAN GUARDRAIL TO ACCOMMODATE NORTHBOUND DETOUR TRAFFIC.
- STEP 2:** WITH THE TEMPORARY ROAD CLOSURE IN PLACE, REMOVE THE EXISTING NORTHBOUND BRIDGE AND CONSTRUCT THE NEW NORTHBOUND BRIDGE AND APPROACHES UP TO BUT NOT INCLUDING THE FINAL LIFT OF SURFACE COURSE. ADDITIONALLY, FINAL MEDIAN GRADING AND DRAINAGE WILL NECESSARILY WAIT FOR THE REMOVAL OF THE TEMPORARY MEDIAN CROSSOVERS.

APPROVED: _____
DATE: 3/21/2022 | 10:43

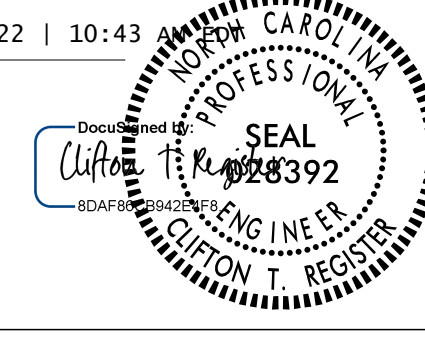

DOCUMENT NOT CONSIDERED FINAL UNLESS ALL SIGNATURES COMPLETED

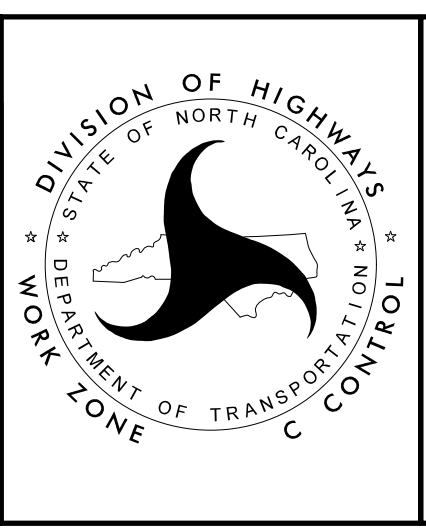

**OVERVIEW
AND PHASING
PHASE II
DETAIL**