

**This electronic collection of documents is provided
for the convenience of the user
and is Not a Certified Document –**

**The documents contained herein were originally issued
and sealed by the individuals whose names and license
numbers appear on each page, on the dates appearing
with their signature on that page.**

**This file or an individual page
shall not be considered a certified document.**



DocuSigned by: Roger C. Kluckman

DOCUMENT NOT CONSIDERED FINAL UNLESS ALL SIGNATURES COMPLETED

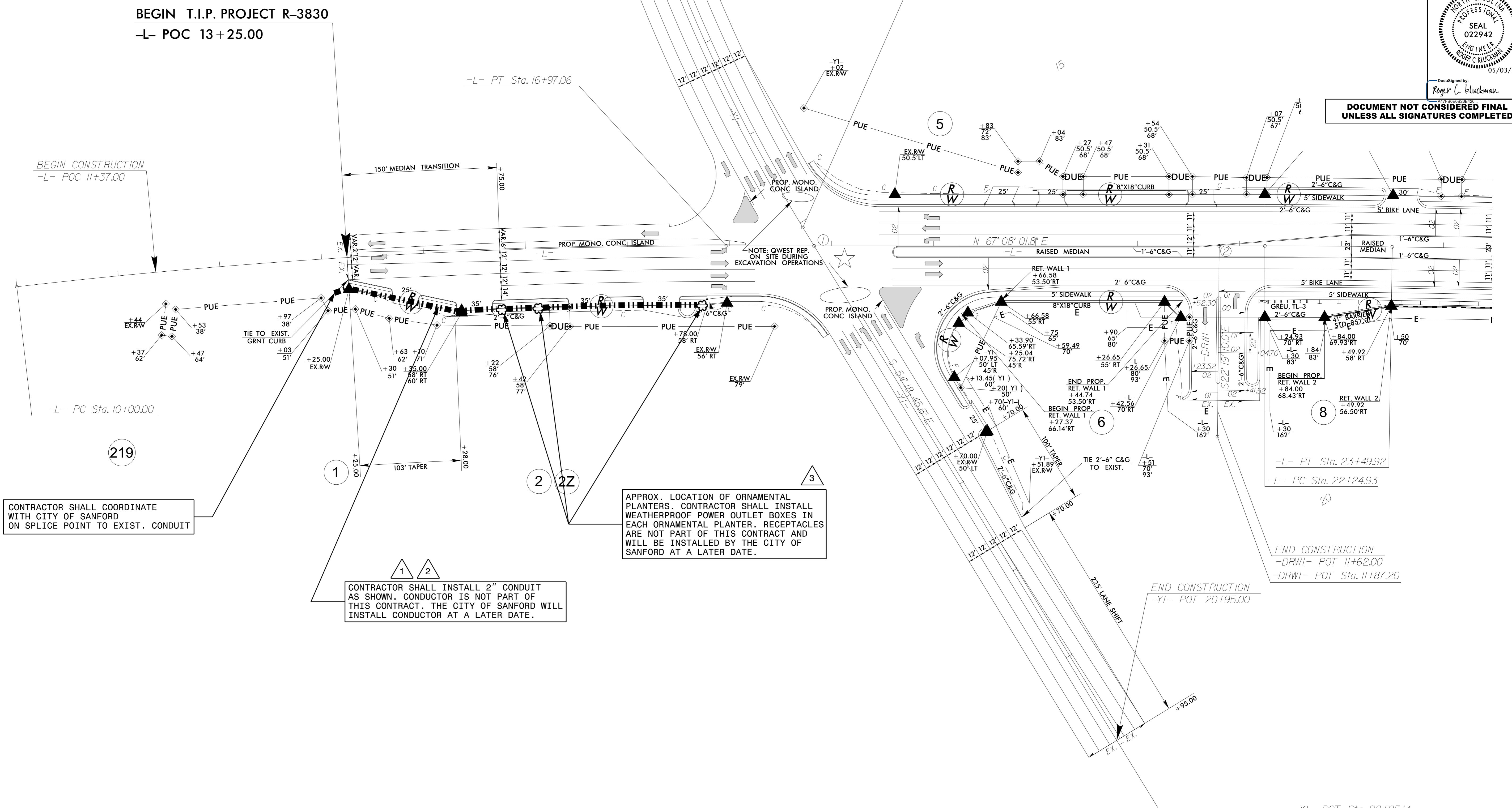

CONTRACTOR SHALL COORDINATE WITH CITY OF SANFORD ON SPLICE POINT TO EXIST. CONDUIT

APPROX. LOCATION OF ORNAMENTAL PLANTERS. CONTRACTOR SHALL INSTALL WEATHERPROOF POWER OUTLET BOXES IN EACH ORNAMENTAL PLANTER. RECEPTACLES ARE NOT PART OF THIS CONTRACT AND WILL BE INSTALLED BY THE CITY OF SANFORD AT A LATER DATE.

CONTRACTOR SHALL INSTALL 2" CONDUIT AS SHOWN. CONDUIT IS NOT PART OF THIS CONTRACT. THE CITY OF SANFORD WILL INSTALL CONDUIT AT A LATER DATE.

SCOPE OF WORK

INSTALL 2" PVC CONDUIT ALONG E. MAIN STREET AND WEATHERPROOF OUTLET BOXES IN ORNAMENTAL PLANTERS LOCATED ALONG E. MAIN STREET.

LEGEND

- ORNAMENTAL PLANTER WITH WEATHERPROOF OUTLET
- 2" PVC CONDUIT

ROADWAY STANDARDS

THE FOLLOWING ROADWAY ENGLISH STANDARDS AS APPEAR IN "NCDOT ROADWAY STANDARD DRAWINGS", ROADWAY DESIGN UNIT-N.C. DEPARTMENT OF TRANSPORTATION RALEIGH, N.C., DATED JANUARY 2018 ARE APPLICABLE TO THIS PROJECT AND BY REFERENCE HEREBY ARE CONSIDERED A PART OF THESE PLANS:

STD NO.	TITLE
1409.01	ELECTRICAL DUCT

ALL WORK SHALL BE IN CONFORMANCE WITH DIVISION 14 OF THE STANDARD SPECIFICATIONS FOR ROADS AND STRUCTURES, DATED JANUARY 2018.

NOTES

- 1 PROVIDE ELECTRICAL DUCT IN ACCORDANCE WITH NEC REQUIREMENTS FOR AN APPROVED RACEWAY FOR ELECTRICAL CIRCUITS.
- 2 CONTRACTOR SHALL INSTALL ALL CONDUIT WITHIN THE NCDOT RIGHT OF WAY.
- 3 SEE SHEET E2 FOR DETAILS ON RECEPTACLES FOR ORNAMENTAL PLANTERS.

Rev.	Date	Description	Approved
2			
1			

NORTH CAROLINA DEPARTMENT OF TRANSPORTATION
ROADWAY DESIGN LIGHTING/ELECTRICAL SECTION

CONDUIT SYSTEM LAYOUT

EAST MAIN ST (NC 78) AT HORNER BLVD (NC 87)

LEE COUNTY

Drawn By: RGH Approved By: Dwg No.:

03-MAY-2022 14:16 R:\Lighting\Lighting Design\3830\LE_psh_e1.dgn rghal AT RD-328781L

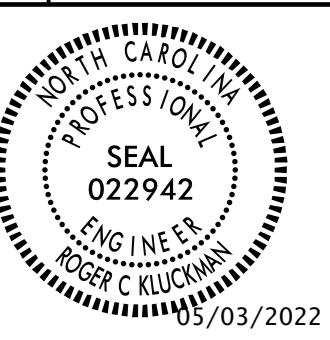

DocuSigned by:
Roger C. Kluckman

**DOCUMENT NOT CONSIDERED FINAL
UNLESS ALL SIGNATURES COMPLETED**

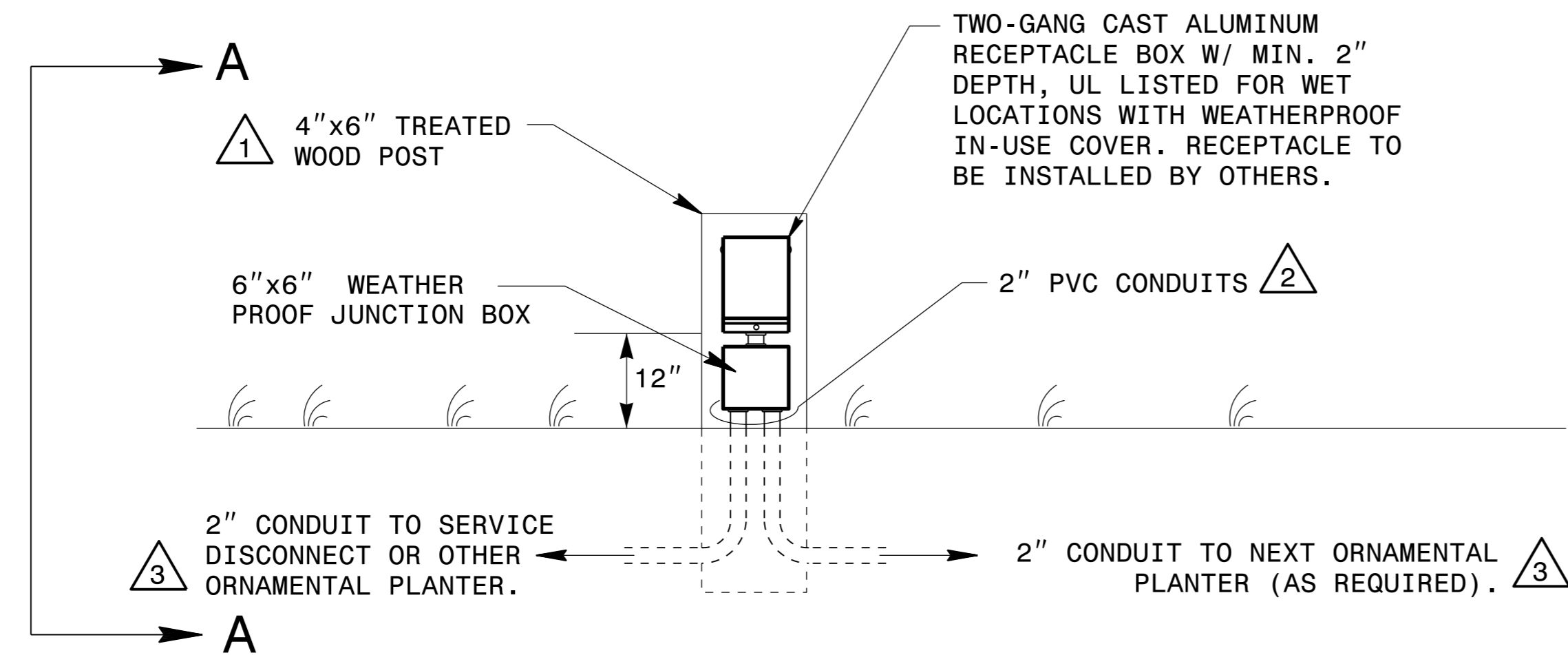

POST MOUNTED RECEPTACLE

SEE SHEETS E1 AND O4 FOR LOCATIONS AND ADDITIONAL DETAILS

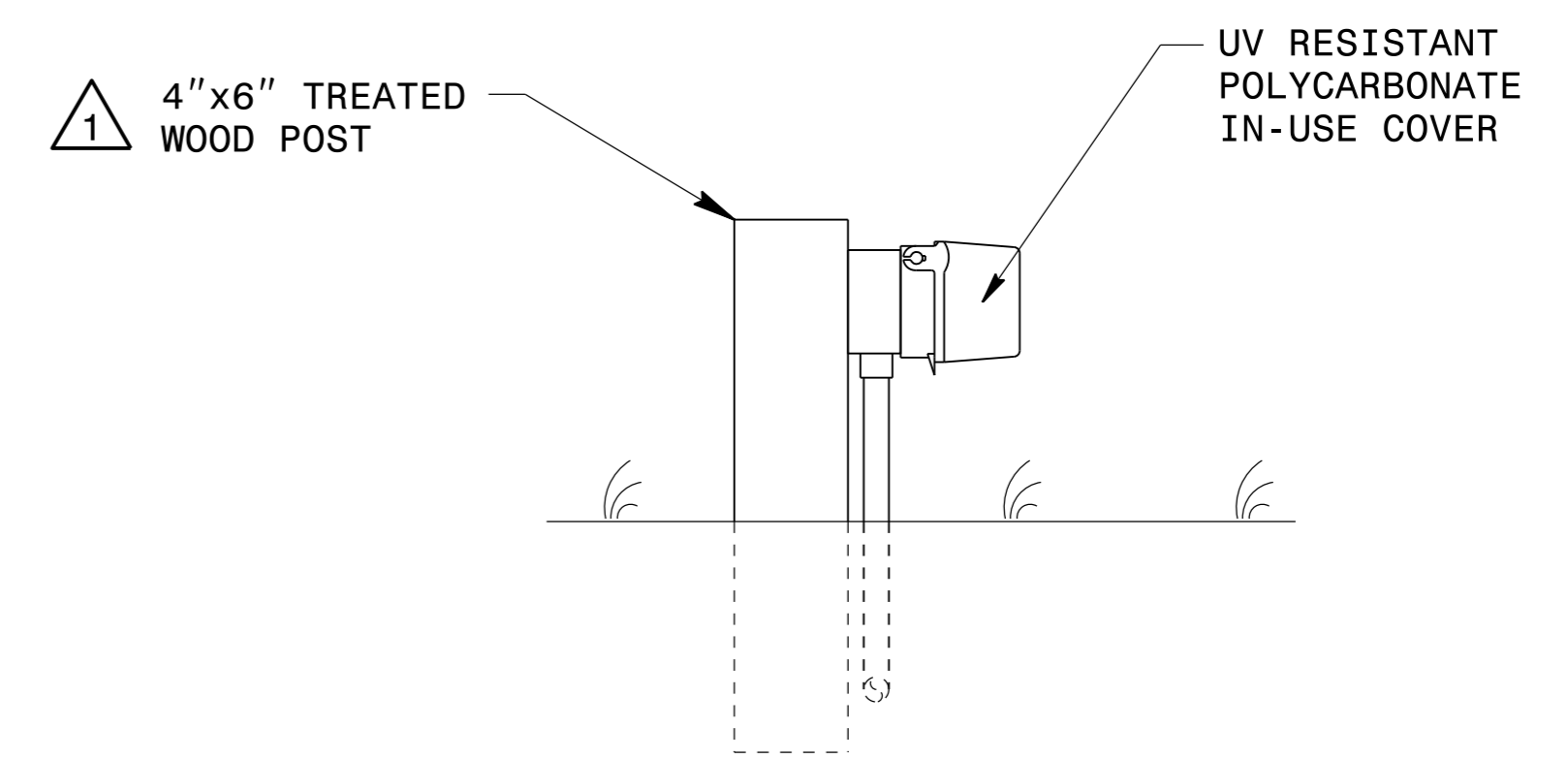

SECTION A-A

NOTES:

- 1 USE TREATED WOODEN POST RATED FOR GROUND CONTACT. EMBED WOOD POST IN GROUND A MINIMUM OF 18". BACK FILL AND COMPACT FILL MATERIAL TO SECURE POST IN GROUND.
- 2 SECURELY STRAP CONDUIT TO WOOD POST PER NEC SPACING REQUIREMENTS.
- 3 INSTALL CONDUIT ONLY. INCLUDE NON-ROTTING PULL STRING. CONDUCTOR TO BE INSTALLED BY OTHERS.

2			
1			
Rev.	Date	Description	Approved
NORTH CAROLINA DEPARTMENT OF TRANSPORTATION ROADWAY DESIGN LIGHTING/ELECTRICAL SECTION WEATHERPROOF RECEPTACLE BOX EAST MAIN ST (NC 78) AT HORNER BLVD (NC 87) LEE COUNTY			
Drawn By:	RGH	Approved By:	Dwg No.: