

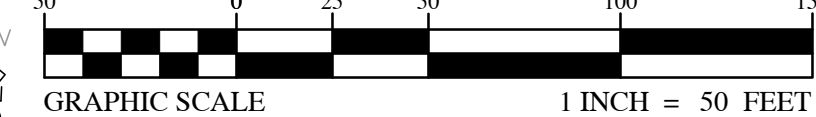

112 CONNECT TO EXISTING 16" WATER MAIN IN SHOULDER, 16" CAP

EXISTING 10" WATER MAIN TO BE ABANDONED

PLAN



PROJECT REFERENCE NO.	R-3830	SHEET NO.	UC-16
DESIGNED BY:	DLH		
DRAWN BY:	WW, MJ, BB		
CHECKED BY:	DLH		
APPROVED BY:		UTILITY CONSTRUCTION PLANS ONLY	
REVISED:	NORTH CAROLINA DEPARTMENT OF TRANSPORTATION		
	UTILITIES ENGINEERING SEC. PHONE: (919) 707-6690 FAX: (919) 250-4151		

McGill Associates, P.A. 5 Regional Circle, Suite A Pinehurst, NC 28374 Tel: 910-295-3159 Fax: 910-295-3647 www.mcgillassociates.com License No. C-0459

MATCHLINE STA. 164+00 W-1 BASELINE -L- 163+72.75

MATCHLINE STA. 178+00 W-1 BASELINE -L- 178+00.27

- NOTES:
1. RELOCATE ALL EXISTING WATER LINE SERVICES TO THE NEW WATER LINE. FOLLOW CITY OF SANFORD STANDARD SERVICE CONNECTION DETAILS. COORDINATE SERVICE TIE OVER WITH PROPERTY OWNER AND CITY OF SANFORD.
 2. PROVIDE 18" MINIMUM VERTICAL CLEARANCE AT ALL DRAINAGE SYSTEM CROSSINGS.
 3. ABANDON WATER LINE IN LOCATIONS SHOWN. ABANDONMENT INCLUDES ALL FITTINGS AND APPURTENANCES. ABANDONMENT OF THE WATER LINE TO BE IN ACCORDANCE WITH THE CITY OF SANFORD'S AND NCDOT'S REQUIREMENTS.
 4. ALL ABANDONED LINES 8" OR LARGER SHALL BE FILLED WITH CDF.
 5. MAINTAIN MINIMUM 36" COVER BELOW FINISHED GRADE FOR ALL WATER LINES.

PROPOSED 42 LF 30" DIA. x 0.312" THICKNESS STEEL ENCASMENT PIPE BY BORE AND JACK WITH 16" DIP CARRIER PIPE

PROPOSED 40 LF 30" DIA. x 0.312" THICKNESS STEEL ENCASMENT PIPE BY OPEN CUT WITH 16" DIP CARRIER PIPE

PROPOSED 16"x16" TEE 16" GATE VALVE 12" GATE VALVE 16"x12" REDUCER 2-10" CAPS

PROPOSED 16"x6" TEE FIRE HYDRANT ASSEMBLY 4 LF FH LEG 6" GATE VALVE

- PROPOSED 1,030 LF OF 12" WATER MAIN
- PROPOSED 370 LF OF 16" WATER MAIN
- PROPOSED 270 LF OF 1" WATER SERVICE
- ABANDON EXISTING 6" WATER MAIN SHEET UC-16 TOTAL LENGTH = 10 LF
- ABANDON EXISTING 10" WATER MAIN SHEET UC-16 TOTAL LENGTH = 1,418 LF
- ABANDON EXISTING 16" WATER MAIN SHEET UC-16 TOTAL LENGTH = 50 LF

THE ESTIMATED QUANTITY OF DUCTILE IRON WATER PIPE FITTINGS ON THIS PLAN SHEET IS 2,375 POUNDS. THE ACTUAL QUANTITY AND TYPE OF FITTINGS WILL VARY BASED ON FIELD CONDITIONS.

NOTE: LOCATIONS OF EXISTING UTILITIES AS SHOWN ARE APPROXIMATE ONLY. EXACT LOCATIONS ARE TO BE VERIFIED IN THE FIELD BY THE CONTRACTOR.

NO.	DATE	BY	REVISION DESCRIPTION

PROFILE W-1 SCALE: HORIZ. 1"= 50' VERT. 1"= 5'

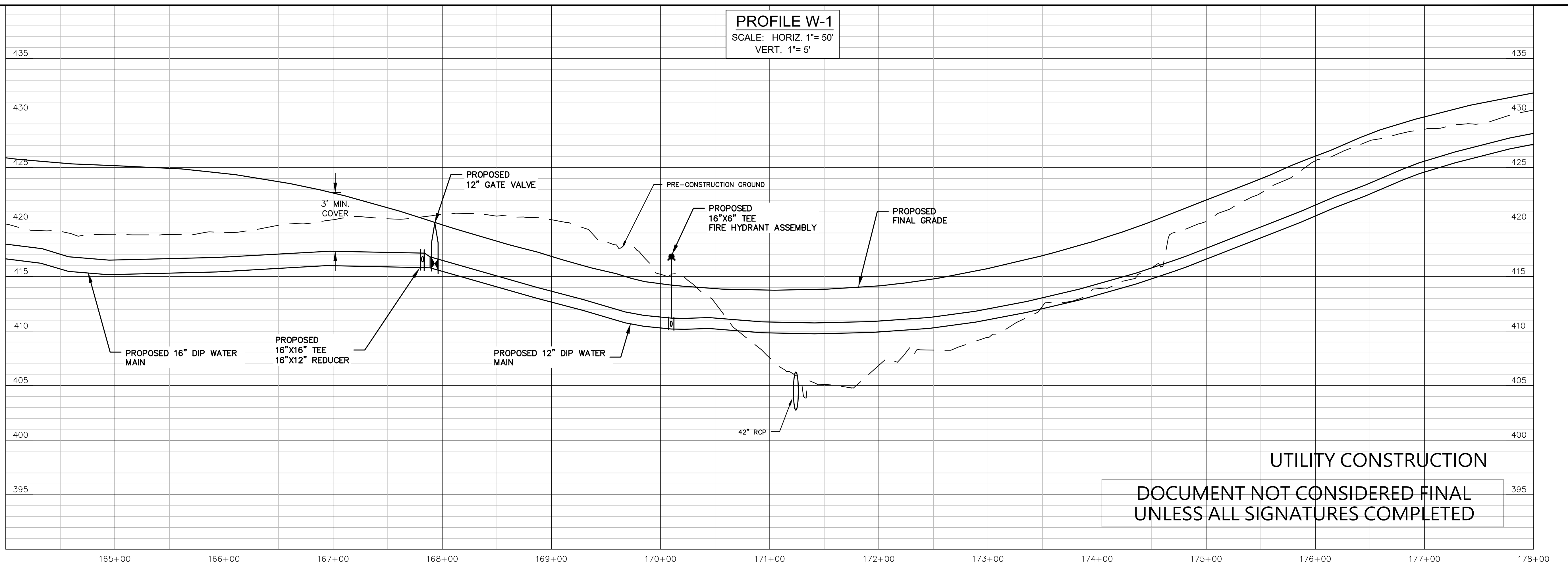

UTILITY CONSTRUCTION DOCUMENT NOT CONSIDERED FINAL UNLESS ALL SIGNATURES COMPLETED