

-L-  
 PI Sta 157+76.14  
 $\Delta = 8^{\circ} 06' 07.1''$  (LT)  
 $D = 2^{\circ} 17' 30.6''$   
 $L = 353.51'$   
 $T = 177.05'$   
 $R = 2,500.00'$   
 $SE = 0.03$   
 $Lr = 150'$

-Y15-  
 PI Sta 10+93.49  
 $\Delta = 41^{\circ} 43' 00.3''$  (RT)  
 $D = 38^{\circ} 11' 49.9''$   
 $L = 109.21'$   
 $T = 57.15'$   
 $R = 150.00'$   
 $SE = \text{SEE PLANS}$

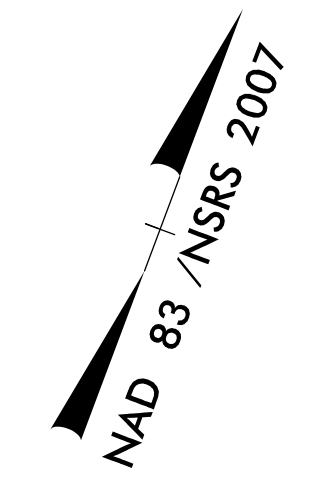

PROJECT REFERENCE NO. R-3830		SHEET NO. EC-39/CONST.14	
ROADWAY DESIGN ENGINEER		HYDRAULICS ENGINEER	
TGS ENGINEERS 804-C N. LAFAYETTE ST SHELBY, NC 28150 PH (704) 476-0003 CORP. LICENSE NO.: C-0275			

MATCHLINE -L- STA. 147+00.00  
SEE SHEET 13

MATCHLINE -L- STA. 160+50.00  
SEE SHEET 15

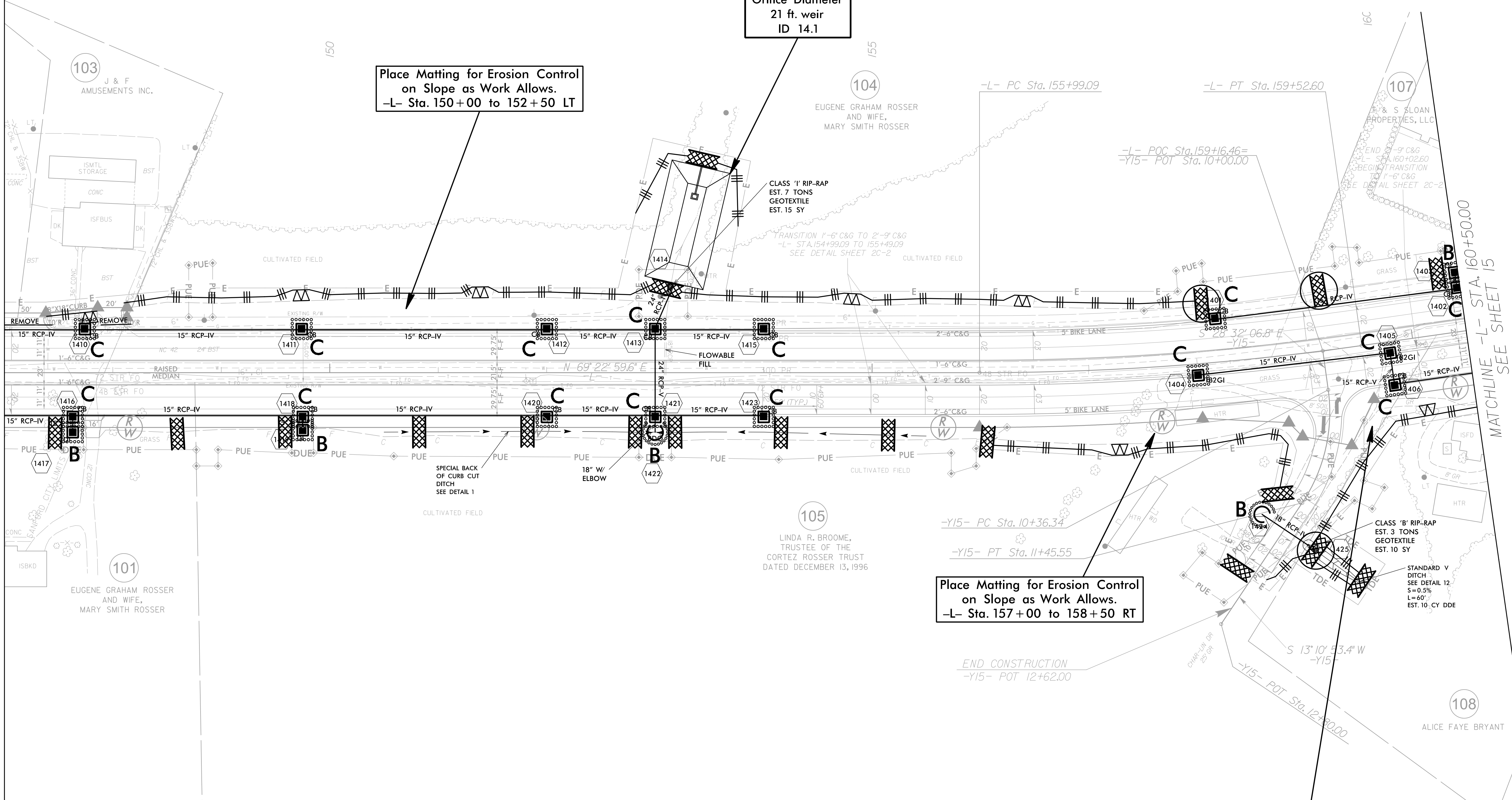

110 x 55 x 3  
 2.5 inch Skimmer  
 with 2.125 inch  
 Orifice Diameter  
 21 ft. weir  
 ID 14.1

Place Matting for Erosion Control  
 on Slope as Work Allows.  
 -L- Sta. 150+00 to 152+50 LT

Place Matting for Erosion Control  
 on Slope as Work Allows.  
 -L- Sta. 157+00 to 158+50 RT

Place Matting for Erosion Control  
 on Slope as Work Allows.  
 -Y15- Sta. 10+50 to 10+75 LT

