

|   |  |  |
|---|--|--|
| <p>-L-</p> <p>PI Sta 130+71.82<br/> <math>\Delta = 31' 44" 13.7" (LT)</math><br/> <math>D = 2' 51" 53.2"</math><br/> <math>L = 1,107.84'</math><br/> <math>T = 568.53'</math><br/> <math>R = 2,000.00'</math><br/> <math>SE = 0.04</math><br/> <math>Lr = 200'</math></p> | <p>-Y14-</p> <p>PI Sta 10+84.57<br/> <math>\Delta = 11' 37" 11.9" (LT)</math><br/> <math>D = 9' 32" 57.5"</math><br/> <math>L = 121.68'</math><br/> <math>T = 61.05'</math><br/> <math>R = 600.00'</math><br/> <math>SE = SEE PLANS</math></p> | <p>-DRW3-</p> <p>PI Sta 11+31.13<br/> <math>\Delta = 30' 19" 01.4" (RT)</math><br/> <math>D = 23' 28" 54.8"</math><br/> <math>L = 129.11'</math><br/> <math>T = 66.10'</math><br/> <math>R = 244.00'</math><br/> <math>SE = SEE PLANS</math></p> |
|---|--|--|

① -L- POT Sta. 146+04.00=  
 -DRW3- POT Sta. 10+00.00

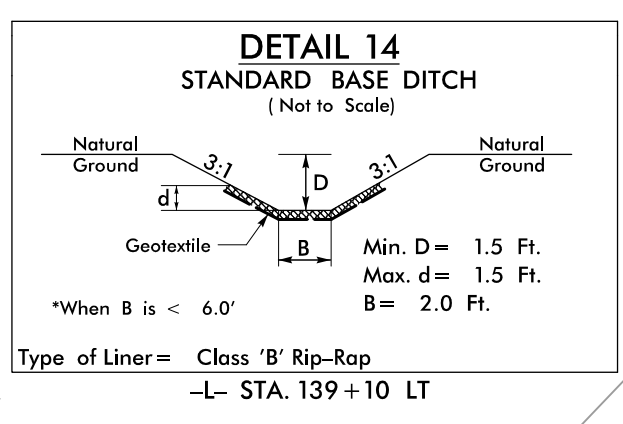

**60 x 40 x 3  
 2.0 inch Skimmer  
 with 1.75 inch  
 Orifice Diameter  
 18 ft. weir  
 (See Tiered Skimmer  
 Basin Detail)  
 ID 13.2**

**Modified Silt Basin  
 Type 'B'  
 60 x 40 x 3  
 18 ft. weir  
 (See Tiered Skimmer  
 Basin Detail)  
 ID 13.2**

**Place Matting for Erosion Control  
 on Slope as Work Allows.  
 -L- Sta. 139+00 to 140+00 LT**

**65 x 20 x 3  
 1.5 inch Skimmer  
 with 1.0 inch  
 Orifice Diameter  
 5 ft. weir  
 ID 13.1**

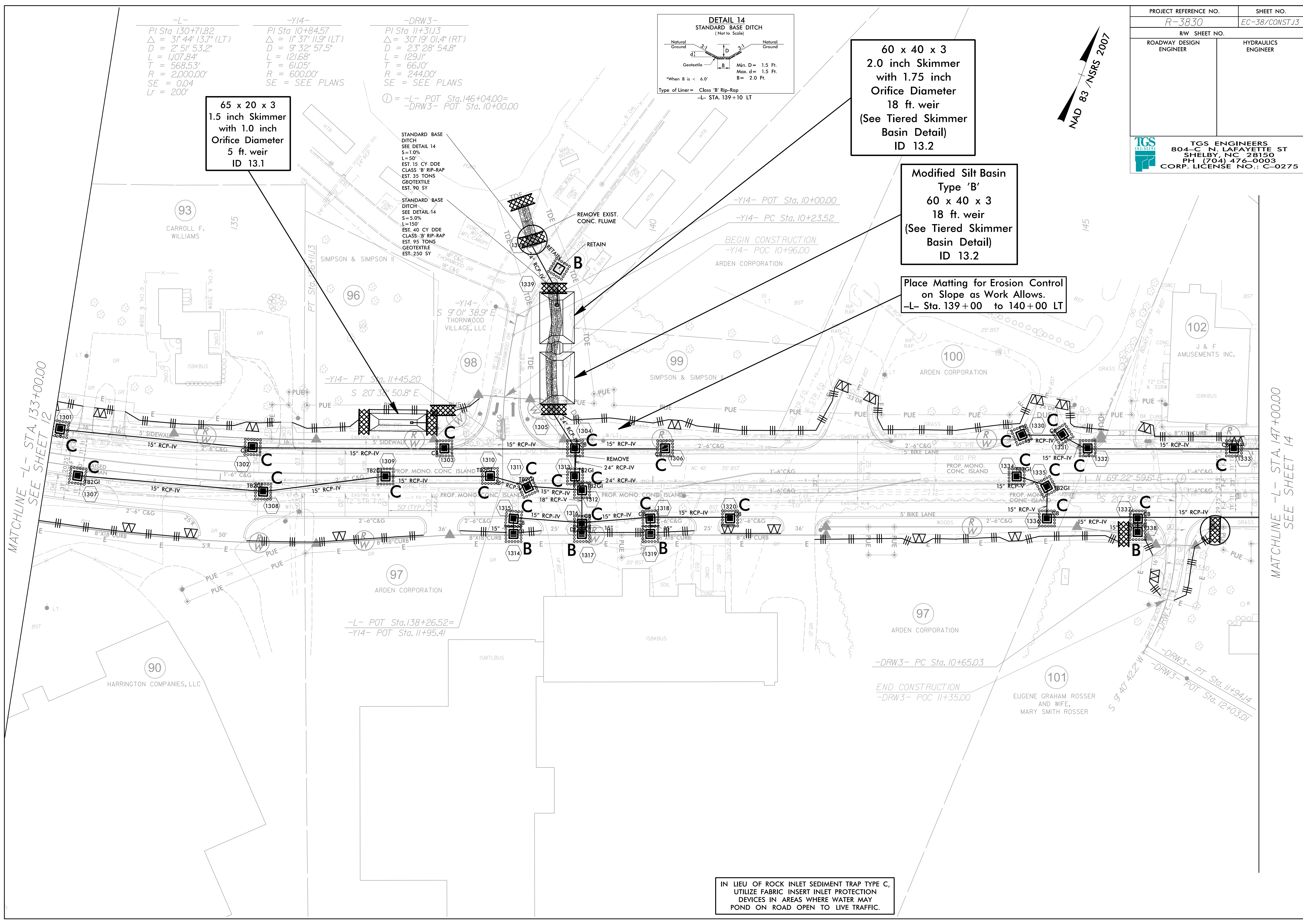

IN LIEU OF ROCK INLET SEDIMENT TRAP TYPE C,  
 UTILIZE FABRIC INSERT INLET PROTECTION  
 DEVICES IN AREAS WHERE WATER MAY  
 POND ON ROAD OPEN TO LIVE TRAFFIC.

MATCHLINE -L- STA. 133+00.00  
SEE SHEET 12

MATCHLINE -L- STA. 147+00.00  
SEE SHEET 14