

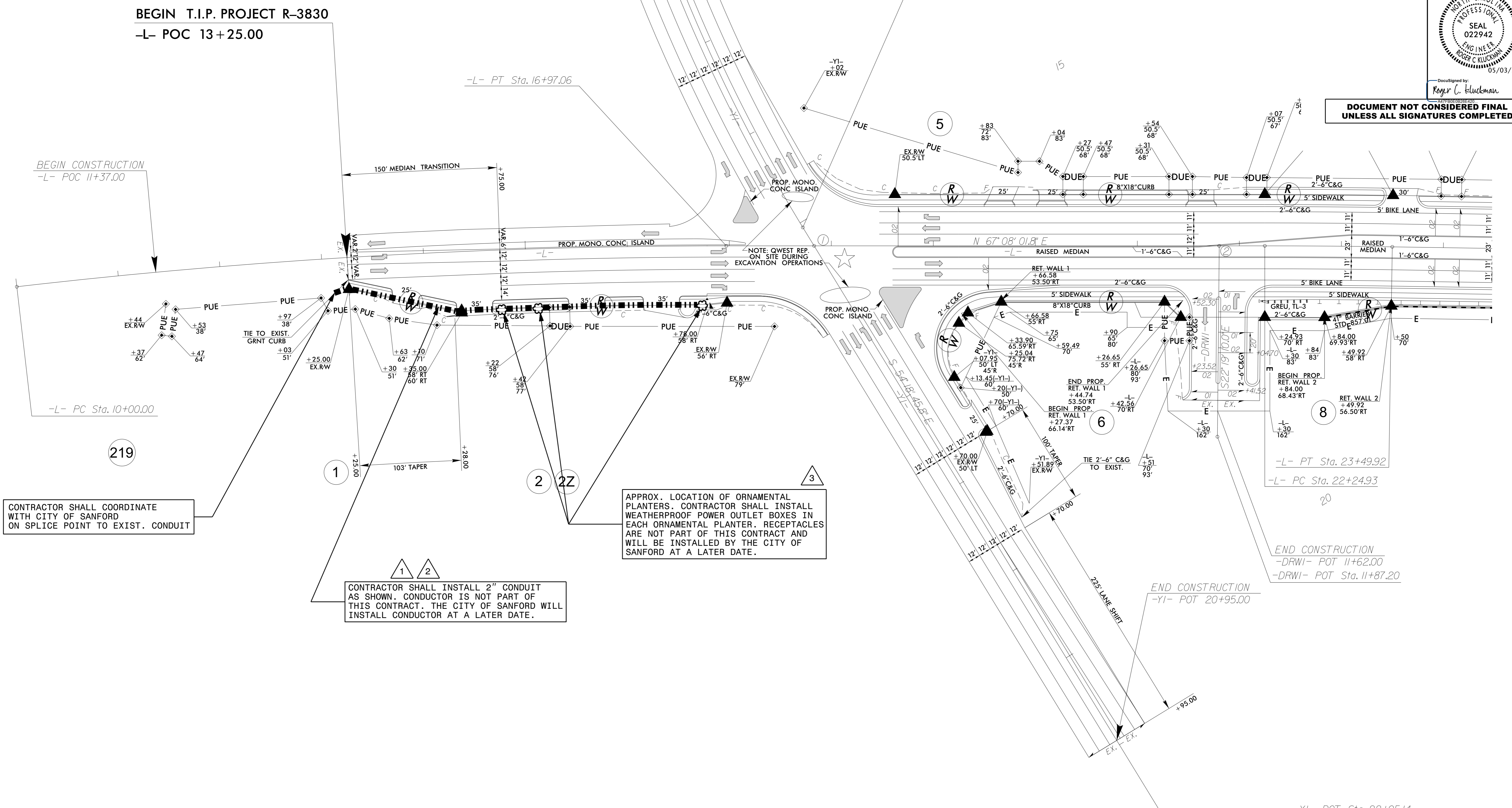

DocuSigned by: Roger C. Kluckman

DOCUMENT NOT CONSIDERED FINAL UNLESS ALL SIGNATURES COMPLETED



CONTRACTOR SHALL COORDINATE WITH CITY OF SANFORD ON SPLICE POINT TO EXIST. CONDUIT

APPROX. LOCATION OF ORNAMENTAL PLANTERS. CONTRACTOR SHALL INSTALL WEATHERPROOF POWER OUTLET BOXES IN EACH ORNAMENTAL PLANTER. RECEPTACLES ARE NOT PART OF THIS CONTRACT AND WILL BE INSTALLED BY THE CITY OF SANFORD AT A LATER DATE.

CONTRACTOR SHALL INSTALL 2" CONDUIT AS SHOWN. CONDUIT IS NOT PART OF THIS CONTRACT. THE CITY OF SANFORD WILL INSTALL CONDUIT AT A LATER DATE.

SCOPE OF WORK

INSTALL 2" PVC CONDUIT ALONG E. MAIN STREET AND WEATHERPROOF OUTLET BOXES IN ORNAMENTAL PLANTERS LOCATED ALONG E. MAIN STREET.

NOTES

- 1 PROVIDE ELECTRICAL DUCT IN ACCORDANCE WITH NEC REQUIREMENTS FOR AN APPROVED RACEWAY FOR ELECTRICAL CIRCUITS.
- 2 CONTRACTOR SHALL INSTALL ALL CONDUIT WITHIN THE NCDOT RIGHT OF WAY.
- 3 SEE SHEET E2 FOR DETAILS ON RECEPTACLES FOR ORNAMENTAL PLANTERS.

LEGEND

- ORNAMENTAL PLANTER WITH WEATHERPROOF OUTLET
- 2" PVC CONDUIT

ROADWAY STANDARDS

THE FOLLOWING ROADWAY ENGLISH STANDARDS AS APPEAR IN "NCDOT ROADWAY STANDARD DRAWINGS", ROADWAY DESIGN UNIT-N.C. DEPARTMENT OF TRANSPORTATION RALEIGH, N.C., DATED JANUARY 2018 ARE APPLICABLE TO THIS PROJECT AND BY REFERENCE HEREBY ARE CONSIDERED A PART OF THESE PLANS:

STD NO.	TITLE
1409.01	ELECTRICAL DUCT

ALL WORK SHALL BE IN CONFORMANCE WITH DIVISION 14 OF THE STANDARD SPECIFICATIONS FOR ROADS AND STRUCTURES, DATED JANUARY 2018.

Rev.	Date	Description	Approved
2			
1			

NORTH CAROLINA DEPARTMENT OF TRANSPORTATION
ROADWAY DESIGN LIGHTING/ELECTRICAL SECTION

CONDUIT SYSTEM LAYOUT

EAST MAIN ST (NC 78) AT HORNER BLVD (NC 87)

LEE COUNTY

Drawn By: RGH Approved By: Dwg No.:

03-MAY-2022 14:16 R:\Lighting\Lighting Design\3830\LE.psh_e1.dgn rghal AT RD-328781L