

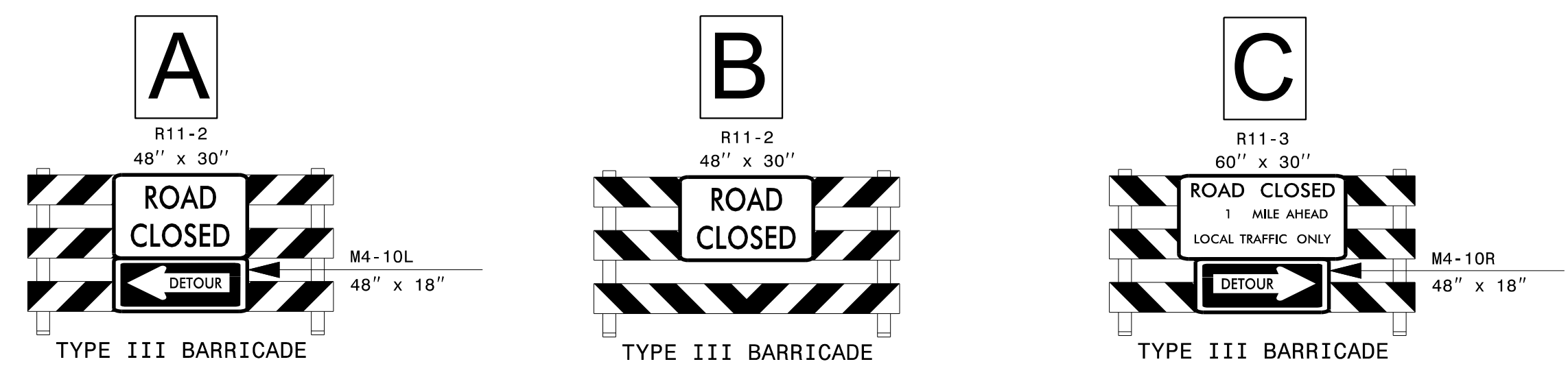

- 1 ROAD CLOSED AHEAD  
W20-3  
48" X 48"
- 2 ROAD CLOSED 1000 FT  
W20-3  
48" X 48"
- 3 ROAD CLOSED 500 FT  
W20-3  
48" X 48"
- 4 ROAD CLOSED AHEAD  
W20-3  
48" X 48"
- 5 ROAD CLOSED AHEAD  
W20-3  
48" X 48"
- 6 DETOUR  
M4-8  
24" X 12"
- 7 DETOUR  
M4-8  
24" X 12"
- 8 DETOUR  
M4-8  
24" X 12"
- 9 END DETOUR  
M4-8 A  
24" X 18"
- NEXT LEFT  
SP-4L  
42" X 12"
- NEXT RIGHT  
SP-4R  
42" X 12"
- M6-1  
21" X 15"
- M6-1 L  
21" X 15"
- M6-3  
21" X 15"

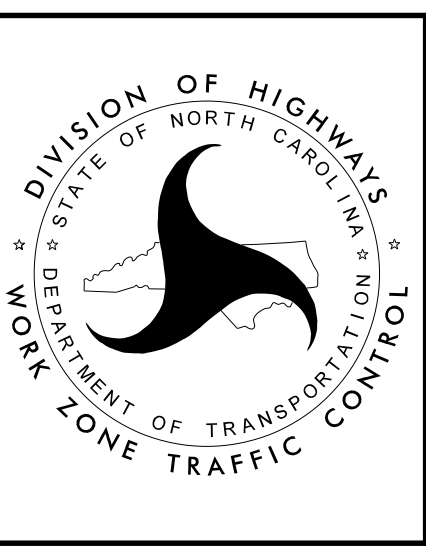

APPROVED: *Ken Thomwell*  
 DATE: 06/07/2022  
 SEAL  
 DOCUMENT NOT CONSIDERED FINAL  
 UNLESS ALL SIGNATURES COMPLETED



DETOUR FOR  
 RAILROAD REMOVAL  
 NASH ST

6/6/2022  
 P:\TIP\Projects-R\3830\TrafficControl\TCP\R-3830\_Detour\_NashSt.dgn  
 User: jdbear1