

5/28/22

TGS ENGINEERS
 706 HILLSBOROUGH ST. SUITE 200
 RALEIGH, NC 27603
 PH (919) 773-8887
 CORP. LICENSE NO.: C-0275

EXISTING GROUND

PROPOSED GRADE

LEFT DITCH GRADE

RIGHT DITCH GRADE

PROJECT REFERENCE NO. R-3830	SHEET NO. 29
ROADWAY DESIGN ENGINEER MARCUSE LOWER 027418 6/30/2022 3:01 PM EDT	HYDRAULICS ENGINEER BENJAMIN J. HENKE 04158 6/30/2022 3:10 PM EDT

**DOCUMENT NOT CONSIDERED FINAL
UNLESS ALL SIGNATURES COMPLETED**

BM4 ELEVATION = 458.30
N 623090 E 1959403
-L- STA 47+36.63 RT.
RR SPIKE SET IN BASE OF 22" OAK

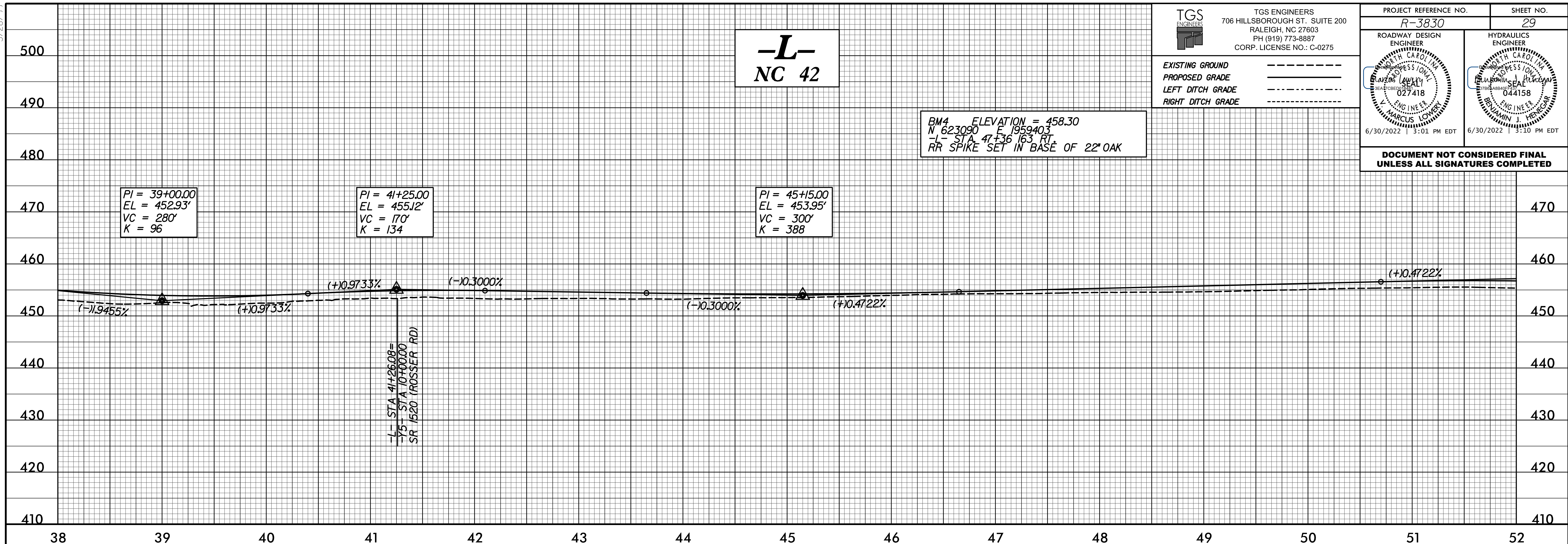

BM5 ELEVATION = 445.66
N 623495 E 1961040
-L- STA 64+77.143 RT.
RR SPIKE SET IN BASE OF 15" PINE

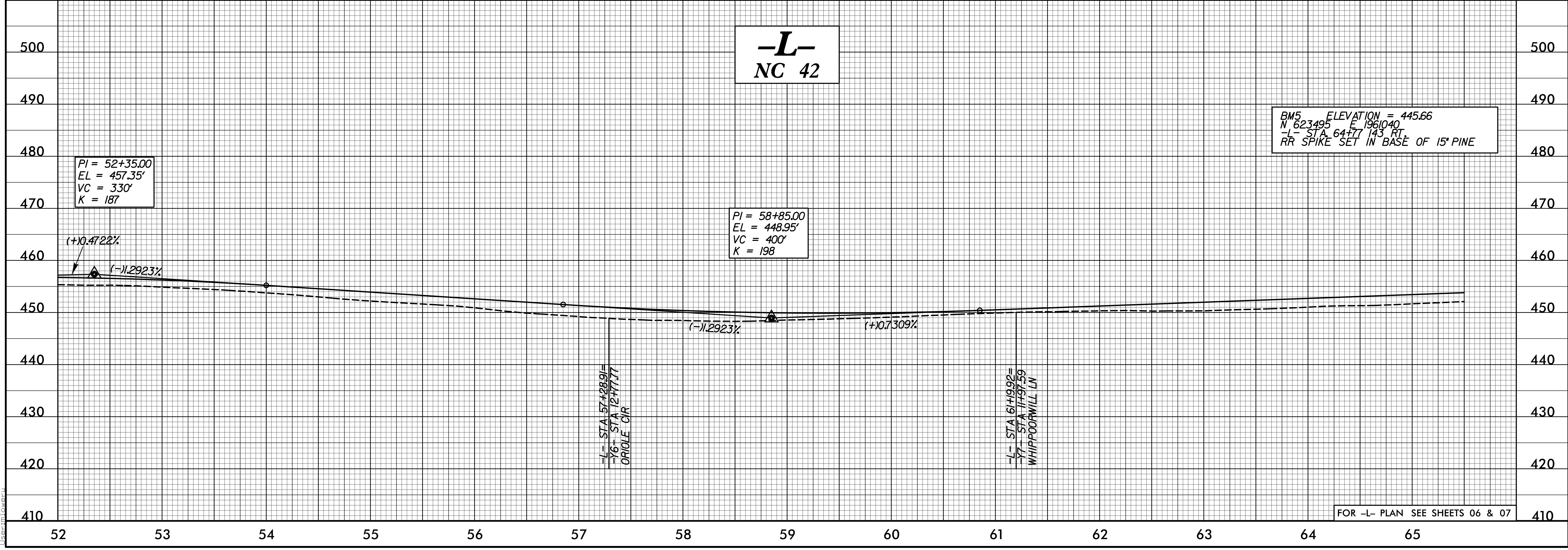

FOR -L- PLAN SEE SHEETS 06 & 07

4/8/2022
C:\Users\mlo\OneDrive\Documents\Roadway\Proj\R-3830\Roadway\Profile\1_29.dgn
User:mlo