

5/14/2022

PROJECT REFERENCE NO. R-3830		SHEET NO. 27	
RW SHEET NO.			
ROADWAY DESIGN ENGINEER MARKUS LOVRY 027418 6/30/2022 3:01 PM EDT		HYDRAULICS ENGINEER DANIEL J. HENDERSON 044158 6/30/2022 3:10 PM EDT	
DOCUMENT NOT CONSIDERED FINAL UNLESS ALL SIGNATURES COMPLETED			
TGS ENGINEERS 706 HILLSBOROUGH ST. SUITE 200 RALEIGH, NC 27603 PH (919) 773-8887 CORP. LICENSE NO.: C-0275		TGS ENGINEERS 706 HILLSBOROUGH ST. SUITE 200 RALEIGH, NC 27603 PH (919) 773-8887 CORP. LICENSE NO.: C-0275	

-Y13-
 PI Sta 11+54.71
 $\Delta = 44^{\circ} 10' 17.0''$ (LT)
 $D = 19^{\circ} 05' 54.9''$
 $L = 231.28'$
 $T = 121.73'$
 $R = 300.00'$
 SE = SEE PLANS

PI Sta 22+03.97
 $\Delta = 0^{\circ} 10' 23.4''$ (LT)
 $D = 0^{\circ} 17' 11.3''$
 $L = 60.44'$
 $T = 30.22'$
 $R = 20,000.00'$

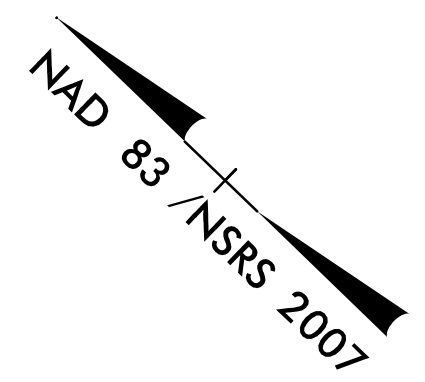

MATCHLINE -Y13- STA.12+50.00
 SEE SHEET 12

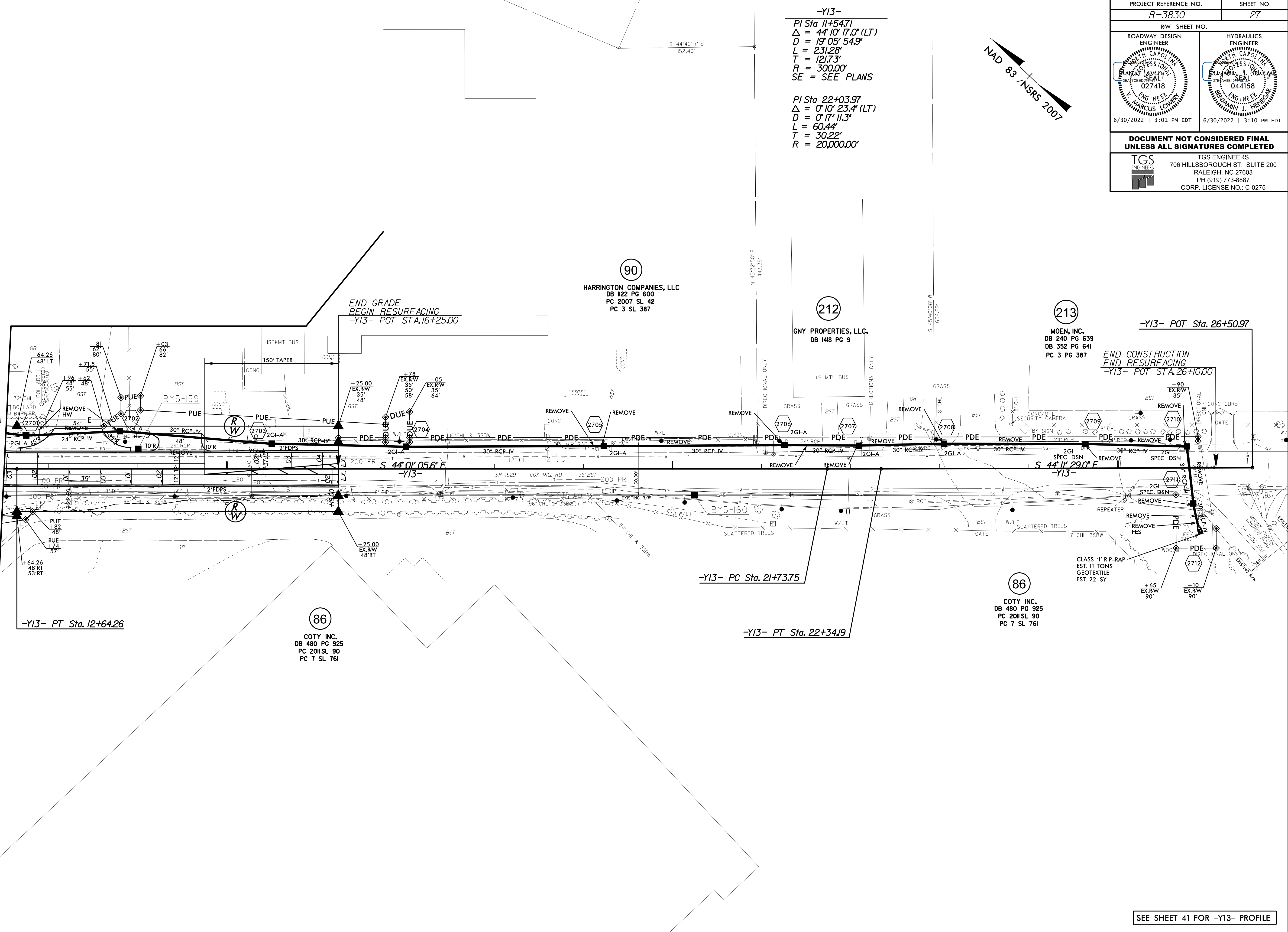

90
 HARRINGTON COMPANIES, LLC
 DB 1122 PG 600
 PC 2007 SL 42
 PC 3 SL 387

212
 GNY PROPERTIES, LLC.
 DB 1418 PG 9
 15 MTL BUS

213
 MOEN, INC.
 DB 240 PG 639
 DB 352 PG 641
 PC 3 PG 387

86
 COTY INC.
 DB 480 PG 925
 PC 2011 SL 90
 PC 7 SL 761

86
 COTY INC.
 DB 480 PG 925
 PC 2011 SL 90
 PC 7 SL 761

CLASS 1' RIP-RAP
 EST. 11 TONS
 GEOTEXTILE
 EST. 22 SY

END CONSTRUCTION
 END RESURFACING
 -Y13- POT STA. 26+10.00

END GRADE
 BEGIN RESURFACING
 -Y13- POT STA. 16+25.00

-Y13- PC Sta. 21+73.75

-Y13- PT Sta. 22+34.19

-Y13- PT Sta. 12+64.26

SEE SHEET 41 FOR -Y13- PROFILE

REVISIONS

4/8/2022 10:38:30 Roadway\Proj\N-3830_rdy_psh_27.dgn
 User: jmlower