

PROJECT REFERENCE NO. R-3830	SHEET NO. 2B-14
RW SHEET NO.	
ROADWAY DESIGN ENGINEER	
6/30/2022 3:01 PM EDT	
DOCUMENT NOT CONSIDERED FINAL UNLESS ALL SIGNATURES COMPLETED	
TGS ENGINEERS 706 HILLSBOROUGH ST., SUITE 200 RALEIGH, NC 27603 PH (919) 773-8887 CORP. LICENSE NO.: C-0275	

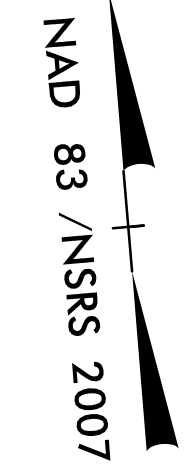

-L-

PI Sta 211+4.26 Δ = 12° 08' 25.1" (RT) D = 3' 22' 13.2" L = 360.21' T = 180.78' R = 1,700.00' SE = 0.04 Lr = 132'	PI Sta 224+45.04 Δ = 16° 06' 19.2" (RT) D = 4' 46' 28.7" L = 337.31' T = 169.77' R = 1,200.00' SE = 0.04 Lr = 132'
--	---

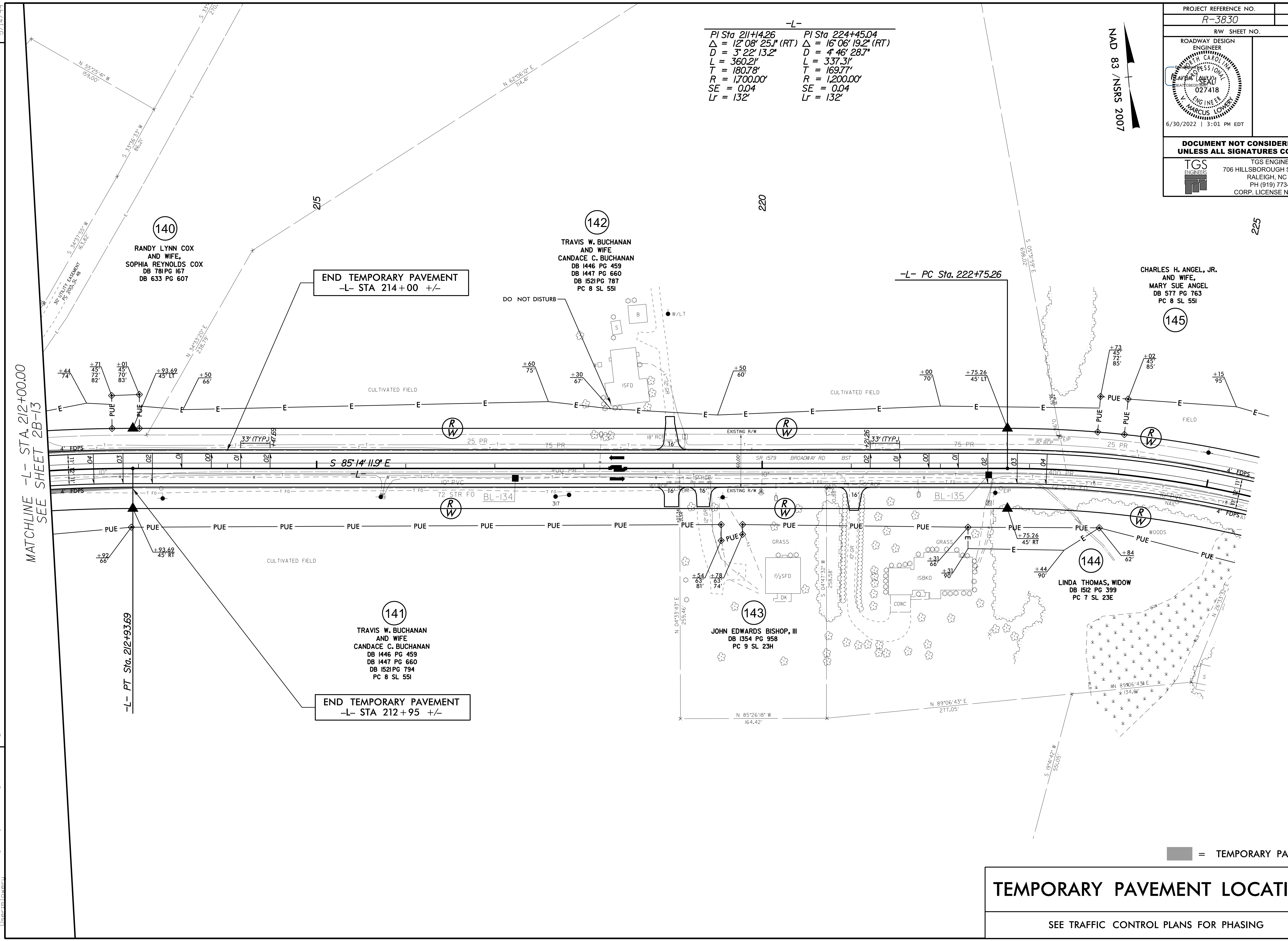

MATCHLINE -L- STA. 212+00.00
SEE SHEET 2B-13

REVISIONS

4/1/2022
Projects\NC DOT\3830\Roadway\Proj\3830_rdy_psh_2b-14.dgn
User:tmlovey

= TEMPORARY PAVEMENT

TEMPORARY PAVEMENT LOCATIONS

SEE TRAFFIC CONTROL PLANS FOR PHASING