

6/2/2022

C:\Users\mloves\OneDrive\Documents\Roadway\Proj\R3830\Roadway\Twp.dgn  
 User:mloves  
 6/3/2022

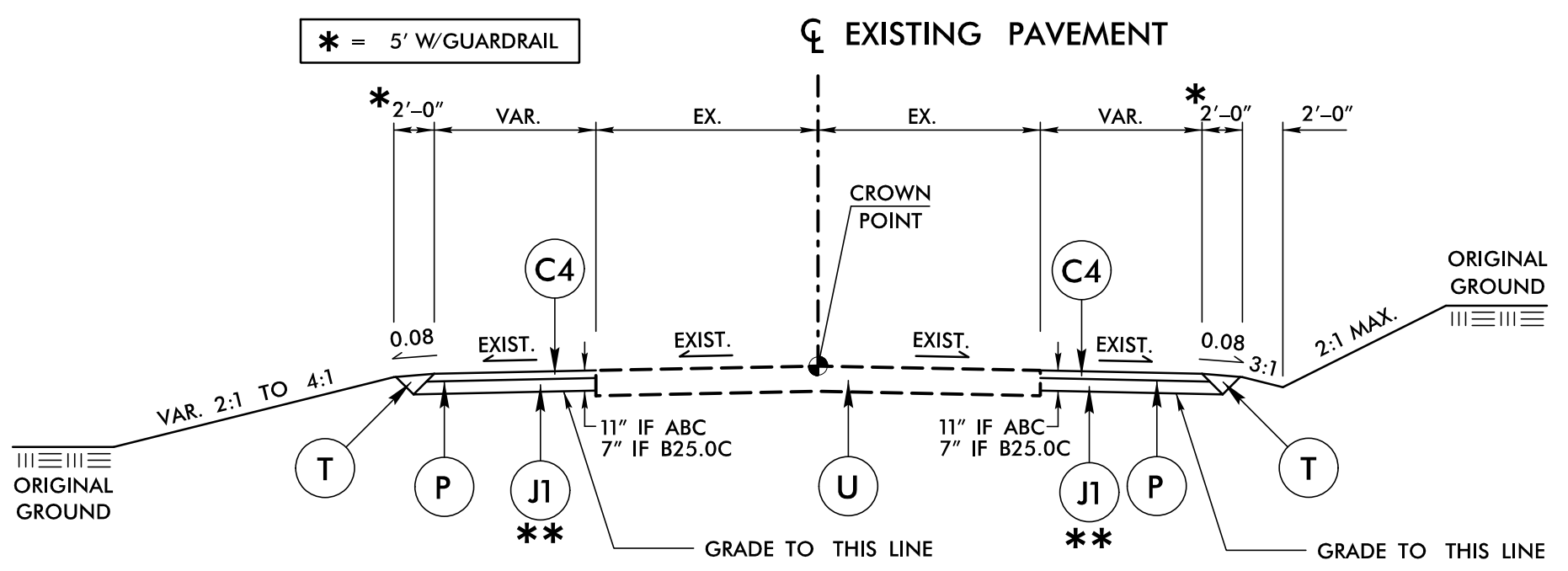

**TYPICAL SECTION NO. 28**

USE TYPICAL SECTION NO. 28:  
 AT TEMPORARY WIDENING LOCATIONS AS SHOWN IN THE WORK ZONE TRAFFIC CONTROL PLANS.  
 DIMENSIONS SHOWN ARE MINIMUMS AND SUBJECT TO CHANGE AS DIRECTED BY THE ENGINEER TO SUIT FIELD CONDITIONS.

WIDENING IS SHOWN ON BOTH SIDES OF THE TYPICAL TO REFLECT THE CUT AND FILL SECTIONS. HOWEVER, ACTUAL TEMPORARY WIDENING WILL TYPICALLY OCCUR ONLY ON ONE SIDE OF THE EXISTING PAVEMENT AT ONE TIME - SEE THE TRAFFIC CONTROL PLANS FOR PHASING.

NOTE:  
 \*\* FOR TEMPORARY PAVEMENT, IN AREAS OF NARROW WIDENING, 4.0" OF B25.0C MAY BE USED IN LIEU OF THE 8.0" OF ABC IN WHICH CASE THE PRIME COAT IS NOT NEEDED.

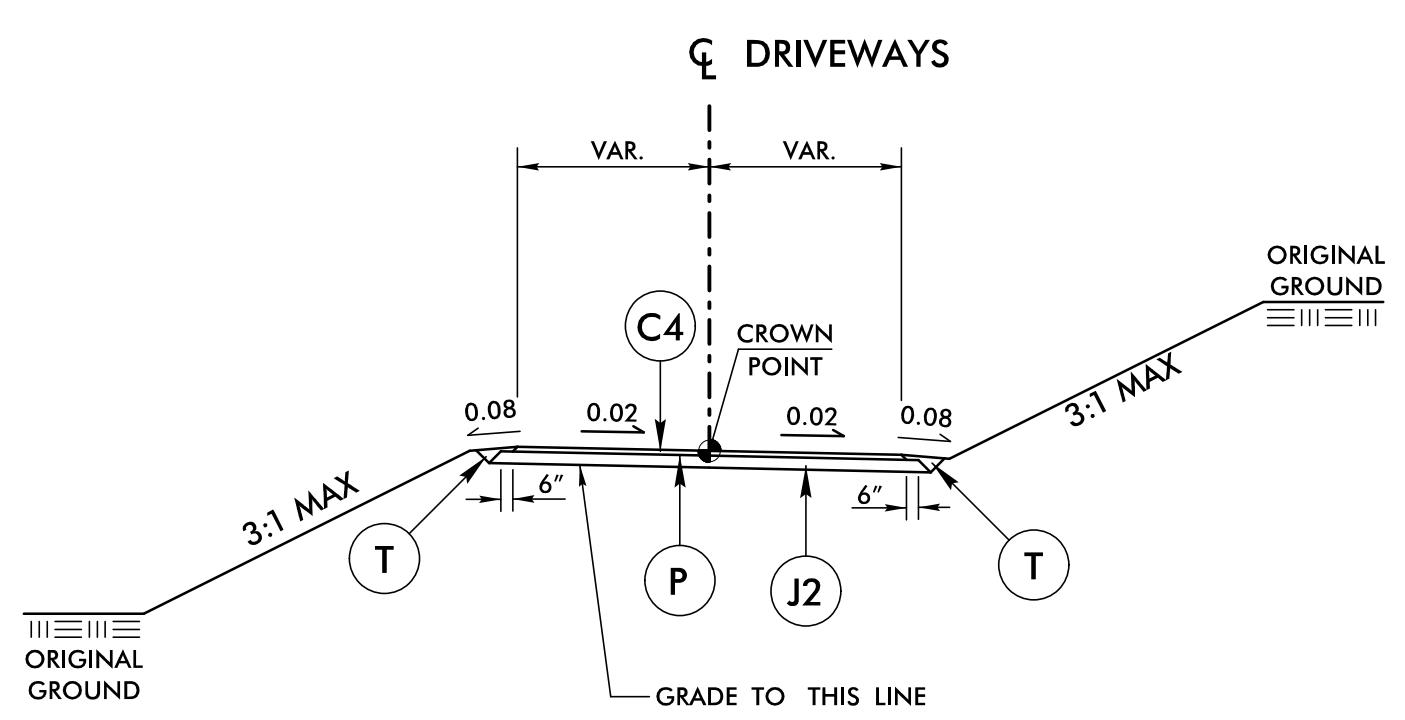

**TYPICAL SECTION NO. 29**

USE TYPICAL SECTION NO. 29:  
 AT DRIVEWAY LOCATIONS TO THE DIMENSIONS SHOWN IN THE PLANS OR AS DIRECTED BY THE ENGINEER.

NOTE:  
 DRIVEWAY PAVEMENT TO BE REPLACED "IN KIND".  
 - IF EXISTING DRIVEWAY IS GRAVEL, REPLACE WITH 6" ABC.  
 - IF EXISTING DRIVEWAY IS ASPHALT, REPLACE WITH 3" S9.5B ON 6" ABC (PER THE TYPICAL SHOWN).  
 - NOTABLE EXCEPTION: IF PROPOSED DRIVEWAY GRADE IS >7%, PAVE WITH 3" S9.5B ON 8" ABC.  
 - IF EXISTING DRIVEWAY IS CONCRETE, REPLACE WITH AT LEAST 6" JOINTED CONCRETE REINFORCED WITH WIRE MESH.

**RAILROAD CROSSING REMOVAL DETAIL**

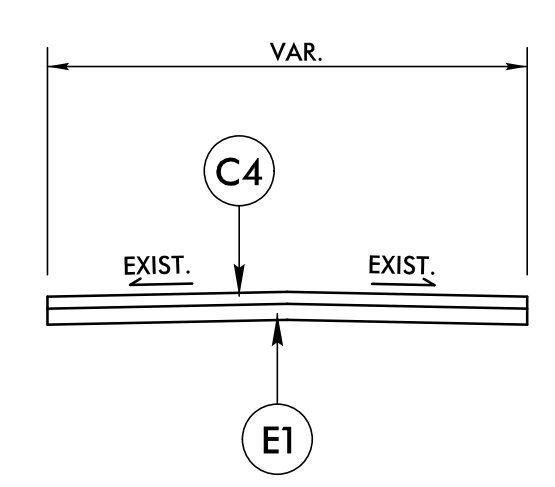

**TYPICAL SECTION NO. 30**

USE TYPICAL SECTION NO. 30:  
 AT THE FOLLOWING RAILROAD CROSSING LOCATIONS:  
 -Y4- @ -Y3- (NASH ST.)  
 -Y4- @ -L- (NC 42)  
 -Y4- @ -Y5- (ROSSER RD.)

NOTE:  
 - CONTRACTOR TO SAWCUT AND REMOVE EXISTING PAVEMENT AS DIRECTED BY THE ENGINEER  
 - ATLANTIC & WESTERN RAILWAY TO REMOVE THE RAILROAD CROSSING  
 - CONTRACTOR TO PERFORM PAVEMENT REPAIR USING THIS TYPICAL OR AS DIRECTED BY THE ENGINEER

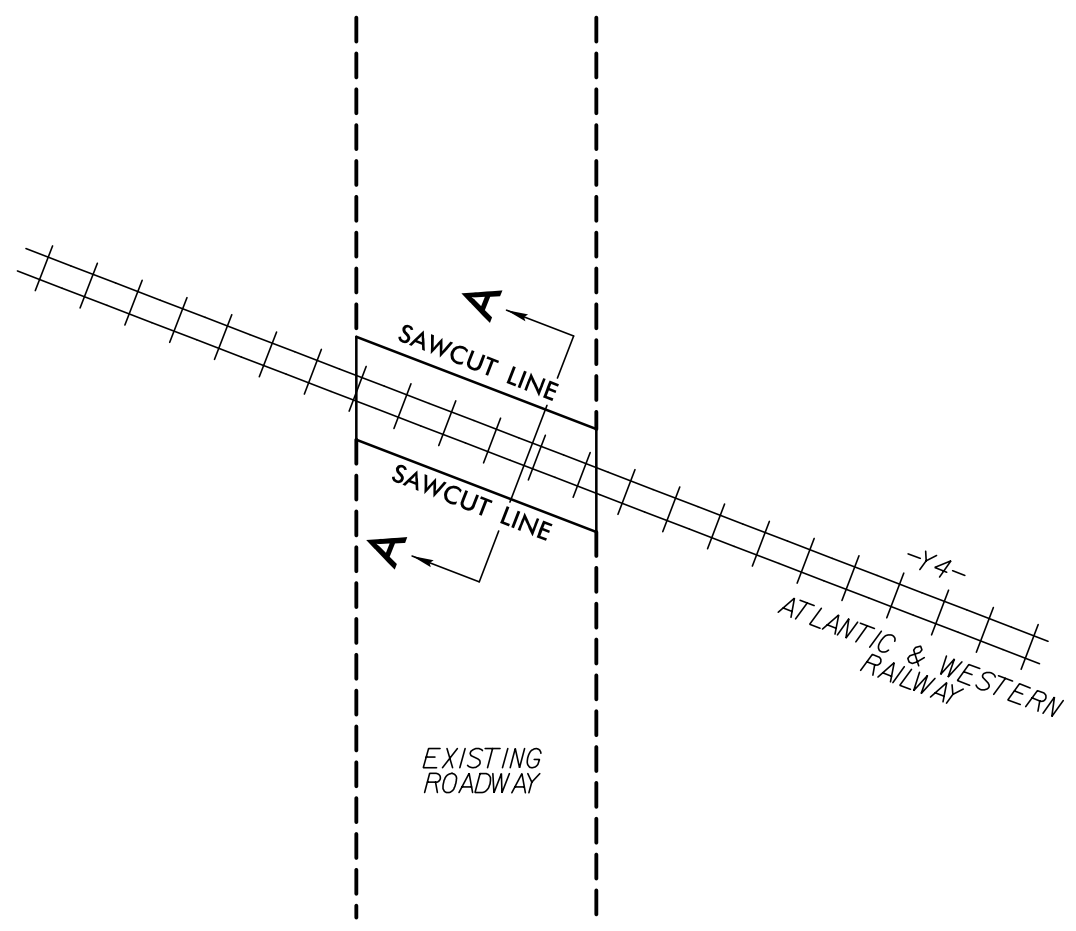

**PLAN VIEW**

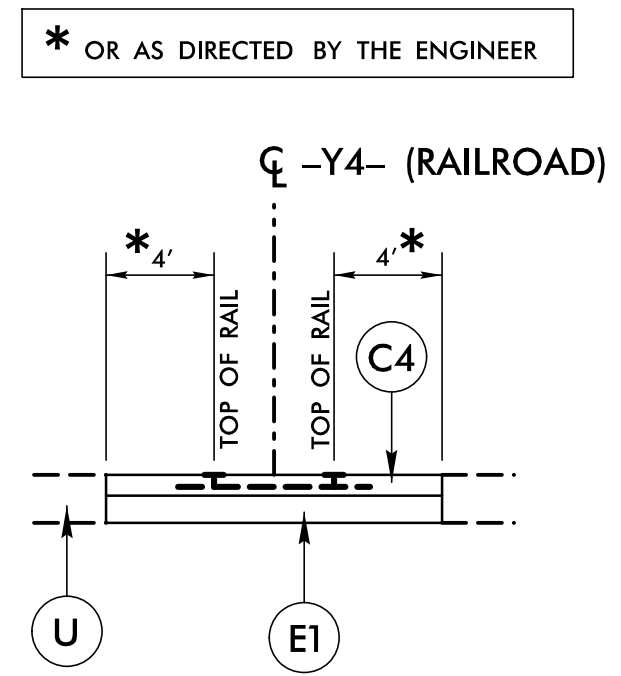

**SECTION A-A**

PROJECT REFERENCE NO. <b>R-3830</b>	SHEET NO. <b>2A-10</b>
ROADWAY DESIGN ENGINEER <b>MARCUS LOWERY</b> 027418 8/3/2022   12:42 PM EDT	PAVEMENT DESIGN ENGINEER <b>MARCUS LOWERY</b> 022896 8/3/2022   11:55 AM PDT
<b>DOCUMENT NOT CONSIDERED FINAL UNLESS ALL SIGNATURES COMPLETED</b>	
TGS ENGINEERS 706 HILLSBOROUGH ST. SUITE 200 RALEIGH, NC 27603 PH (919) 773-8887 CORP. LICENSE NO.: C-0275	

C1	1 1/2" S9.5C
C2	3" S9.5C
C3	VAR. S9.5C
C4	3" S9.5B
C5	VAR. S9.5B
D1	2 1/2" I19.0C
D2	4" I19.5C
D3	VAR. I19.0C
E1	4" B25.0C
E2	5 1/2" B25.0C
E3	VAR. B25.0C
J1	8" ABC
J2	6" ABC
L	CLASS IV STAB.
N	GEOTEXTILE
P	PRIME COAT
R1	2'-6" C & G
R2	1'-6" C & G
R3	5" CONC. ISLAND
R4	EXIST. C & G
R5	2'-9" C & G
R6	8"X18" CURB
R7	GRANITE CURB
S	4" SIDEWALK
T	EARTH MATERIAL
U	EXIST. PAVEMENT
V1	1 1/2" MILLING
V2	3" MILLING
V3	2 1/2" MILLING
W1	WEDGING
W2	WEDGING
W3	WEDGING