

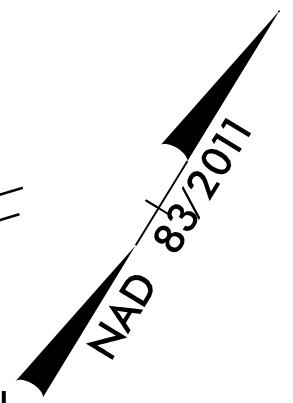

### UTILITIES BY OTHERS

ALL PROPOSED UTILITY WORK SHOWN ON THIS SHEET WILL BE DONE BY OTHERS. NO PAYMENT WILL BE MADE TO THE CONTRACTOR FOR PROPOSED UTILITY WORK SHOWN ON THIS SHEET.

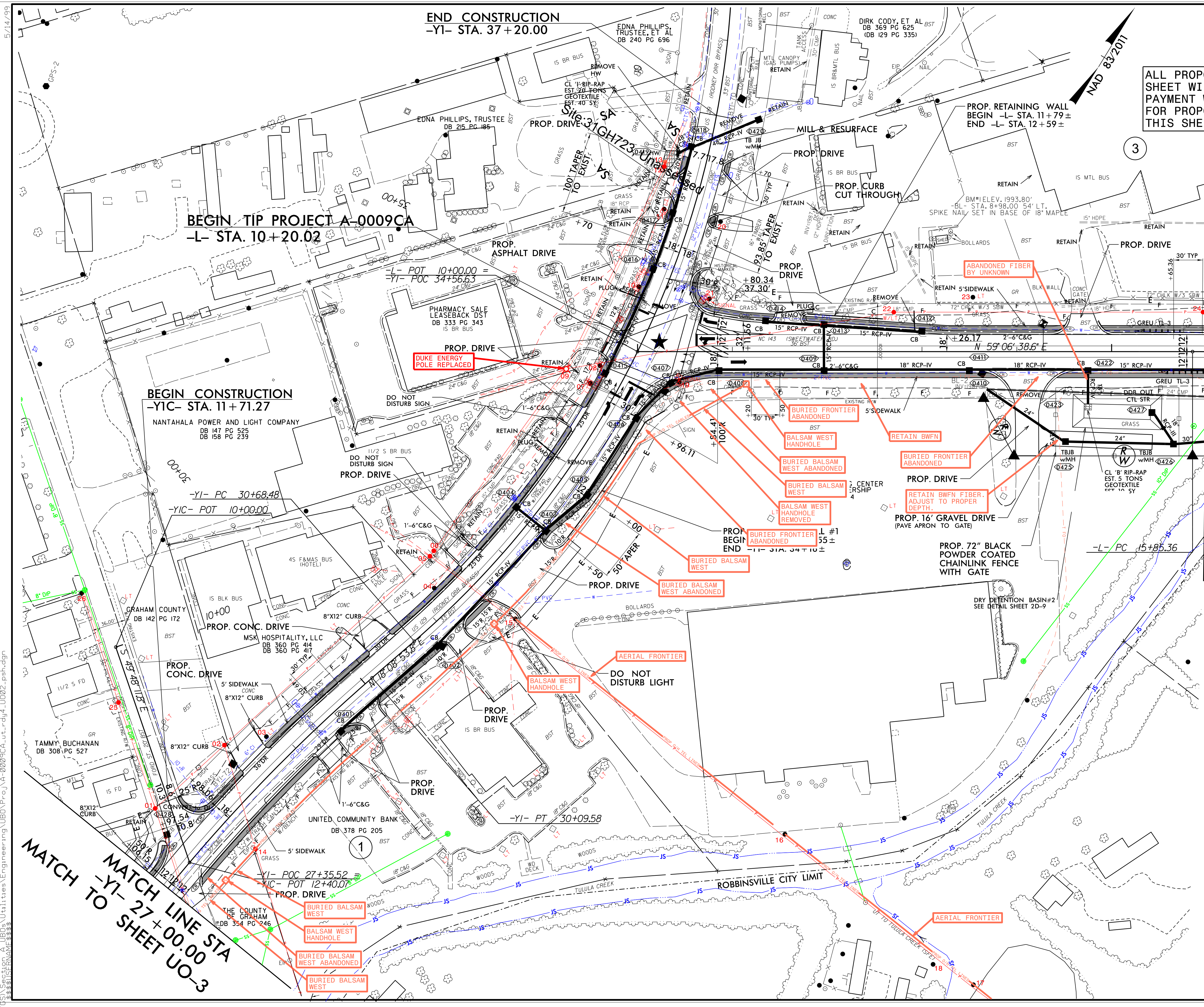

5/14/09  
 27-MAY-2022 15:09  
 U:\GIS\Utilities\Engineering\UBO\Pre\VA-0009CA.ut.rdy.4\_UO02.esh.dgn  
 \$\$\$\$\$\$RENDER\$\$\$\$\$\$

### UTILITIES BY OTHERS

ALL PROPOSED UTILITY WORK SHOWN ON THIS SHEET WILL BE DONE BY OTHERS. NO PAYMENT WILL BE MADE TO THE CONTRACTOR FOR PROPOSED UTILITY WORK SHOWN ON THIS SHEET.

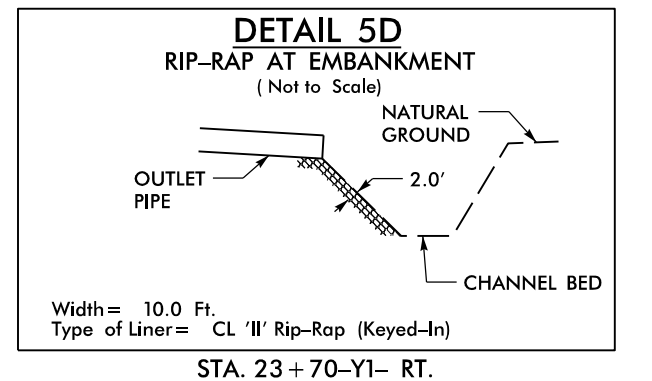
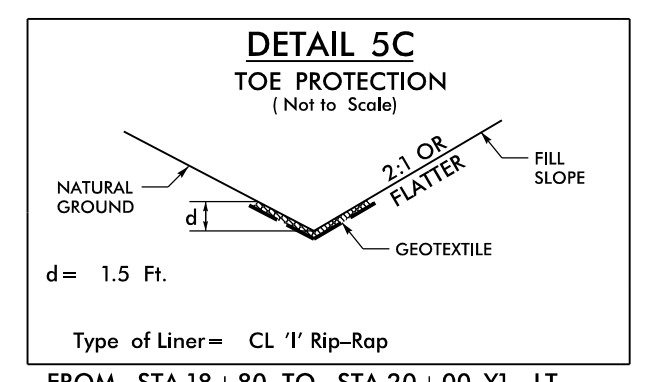
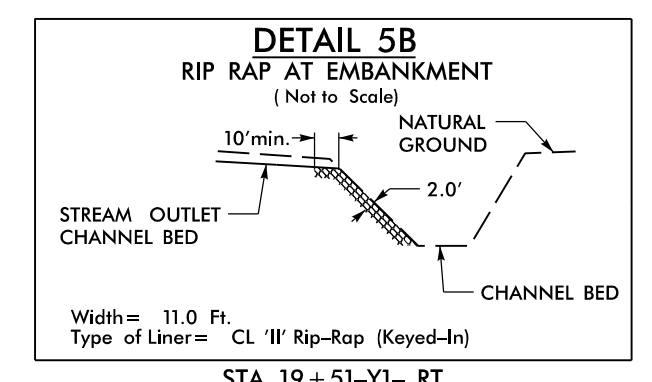
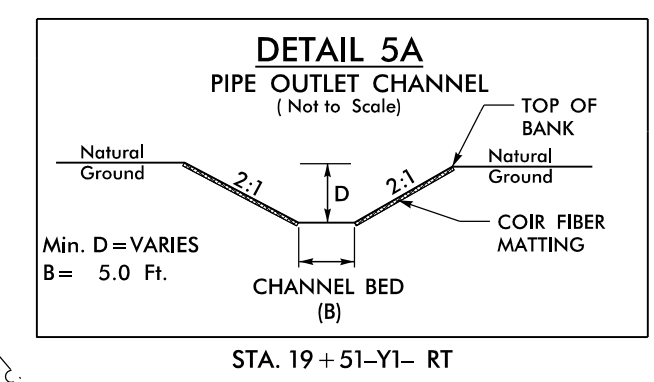

8	EDDIE R. BROOMS, JR. DB 335 PG 807
8A	CLARA BELLE SHULER HEIRS DB 52 PG 435 DB 53 PG 42

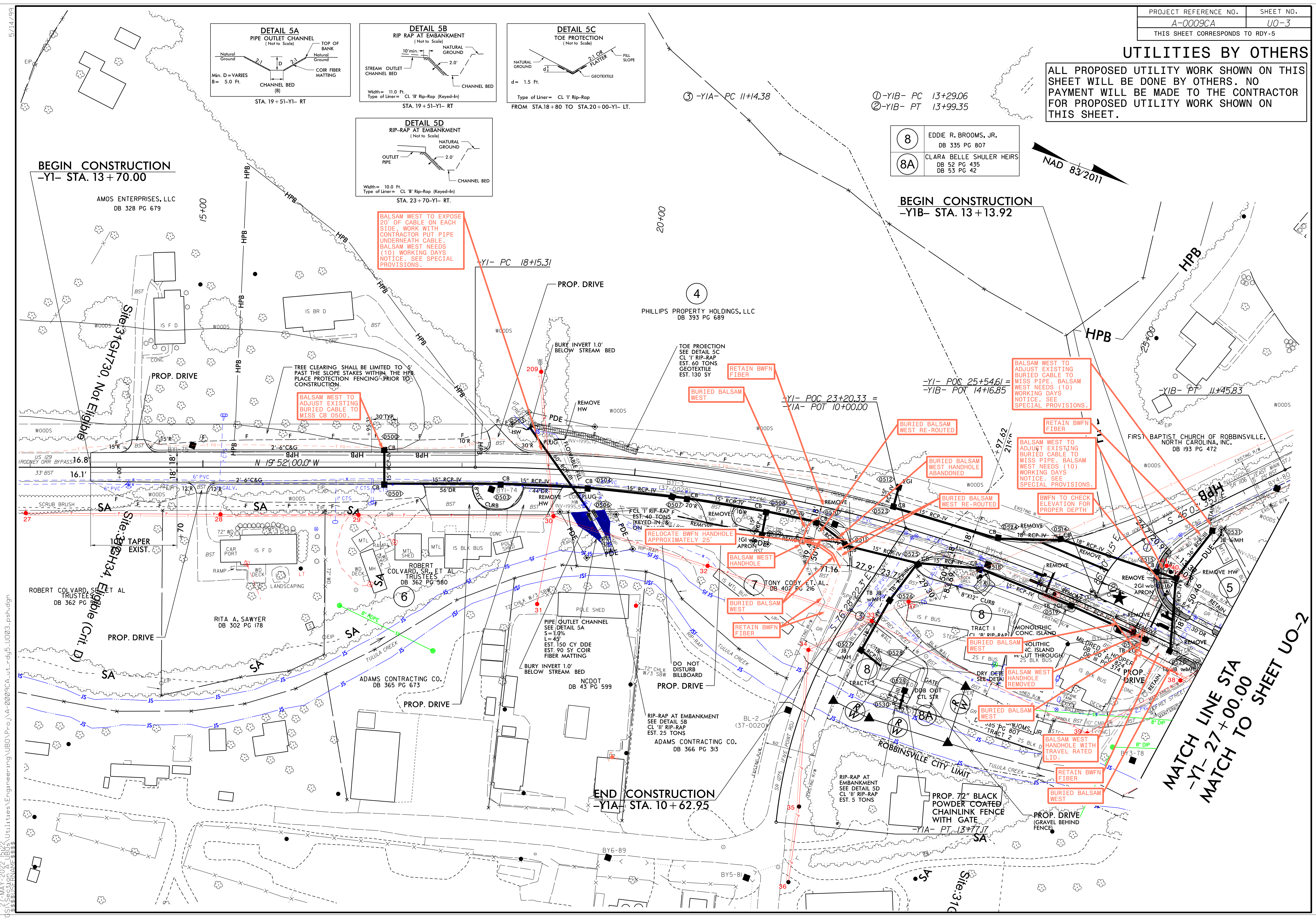
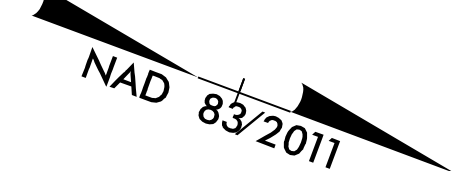

**BEGIN CONSTRUCTION**  
-YI- STA. 13+70.00

**BEGIN CONSTRUCTION**  
-YIB- STA. 13+13.92

**END CONSTRUCTION**  
-YIA- STA. 10+62.95

**MATCH LINE STA**  
-YI- 27+00.00  
**MATCH TO SHEET UO-2**

27-MAY-2022 15:22 Utilities\Engineering\UBD\Pro\A-0009CA.ut\_rdu5\_U003\_psh.dgn



5/14/2022  
27-MAY-2022 15:30  
C:\Users\psh.dgm\Documents\Projects\2022\05\0009CA\Utilities\Engineering\UBO\Pro\0009CA-ut-rd17\_U005\_psh.dgm

PROJECT REFERENCE NO.	SHEET NO.
A-0009CA	U0-5
THIS SHEET CORRESPONDS TO RDY-7	

### UTILITIES BY OTHERS

ALL PROPOSED UTILITY WORK SHOWN ON THIS SHEET WILL BE DONE BY OTHERS. NO PAYMENT WILL BE MADE TO THE CONTRACTOR FOR PROPOSED UTILITY WORK SHOWN ON THIS SHEET.

MATCH LINE STA -L- 30+00.00  
MATCH TO SHEET UO-4

MATCH LINE STA -L- 44+00.00  
MATCH TO SHEET UO-6

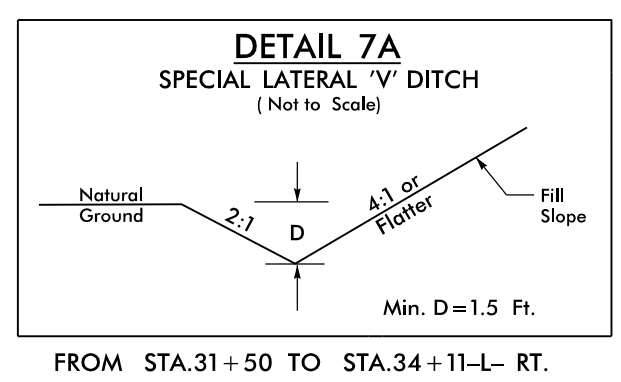
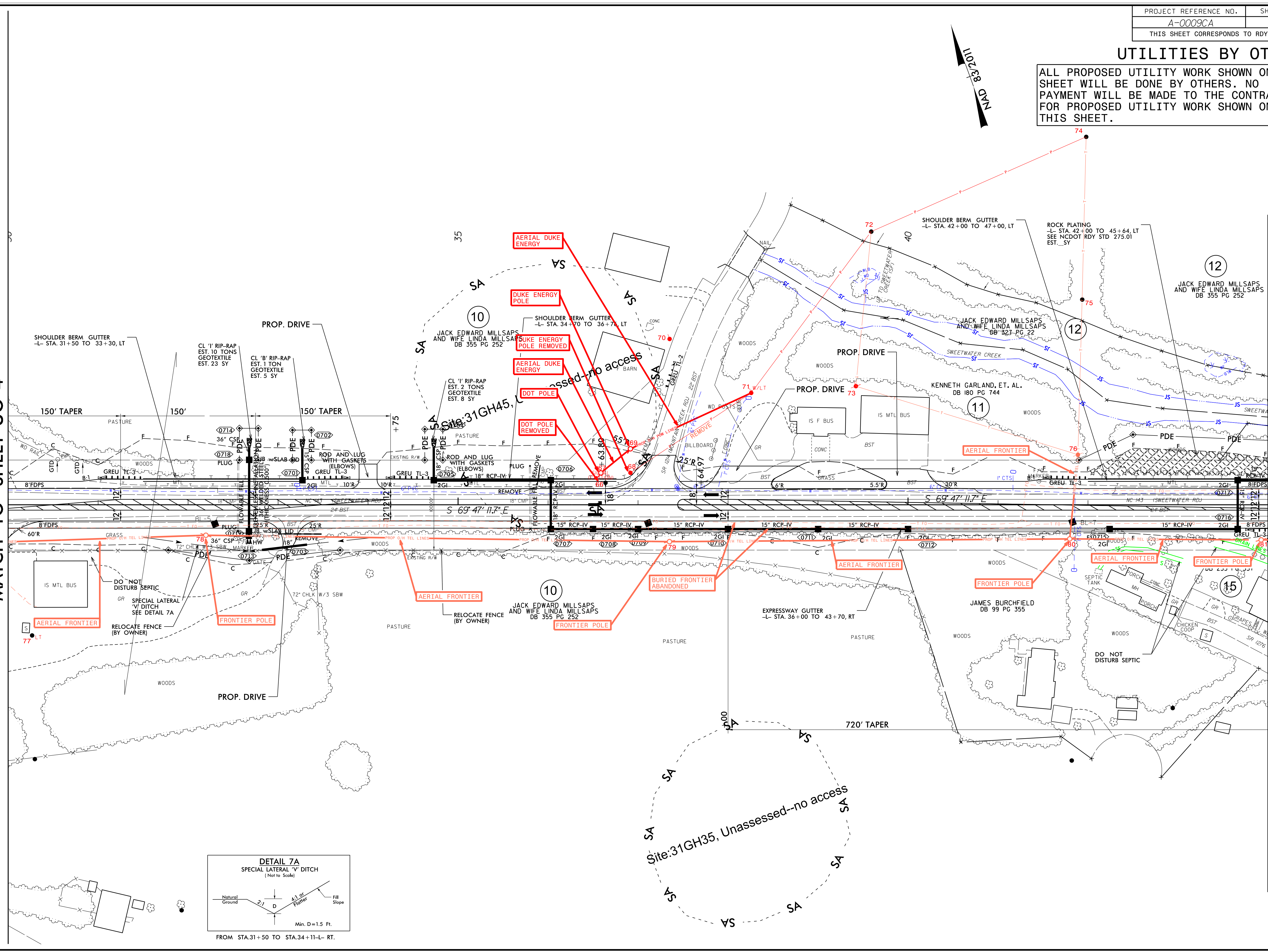

### UTILITIES BY OTHERS

ALL PROPOSED UTILITY WORK SHOWN ON THIS SHEET WILL BE DONE BY OTHERS. NO PAYMENT WILL BE MADE TO THE CONTRACTOR FOR PROPOSED UTILITY WORK SHOWN ON THIS SHEET.

5/14/22  
 27-MAY-2022 15:34  
 I:\GIS\Section\A\Utilities\Engineering\UBO\Proj\A-0009CA\_ut\_rdy8\_U006\_psh.dgn  
 USER:RNMM

MATCH LINE STA -L- 44+00.00  
 MATCH TO SHEET UO-5

MATCH LINE STA -L- 56+00.00  
 MATCH TO SHEET UO-7

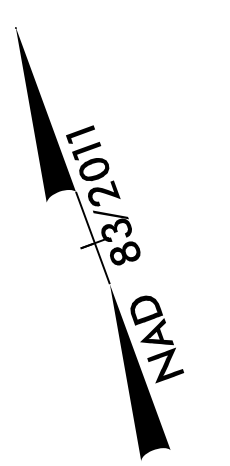
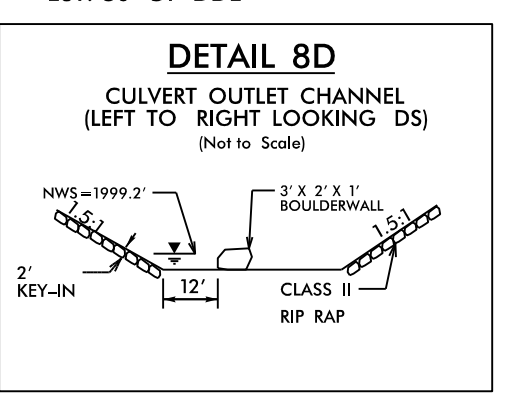
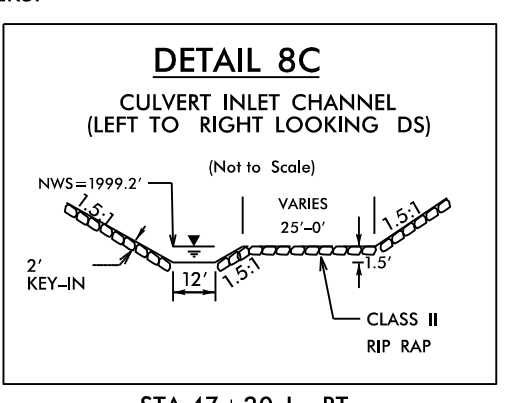
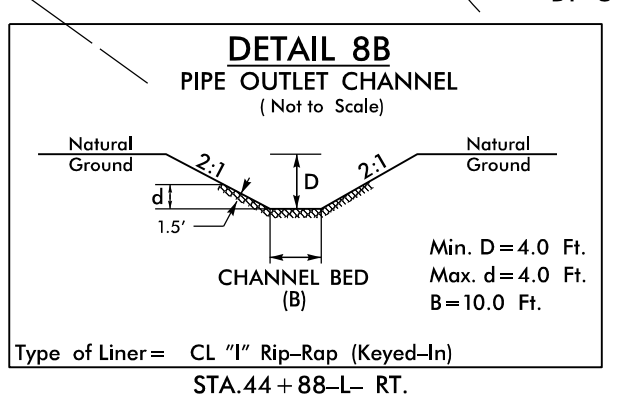
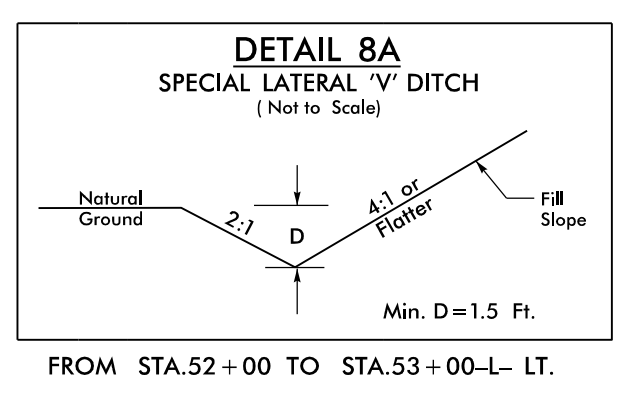
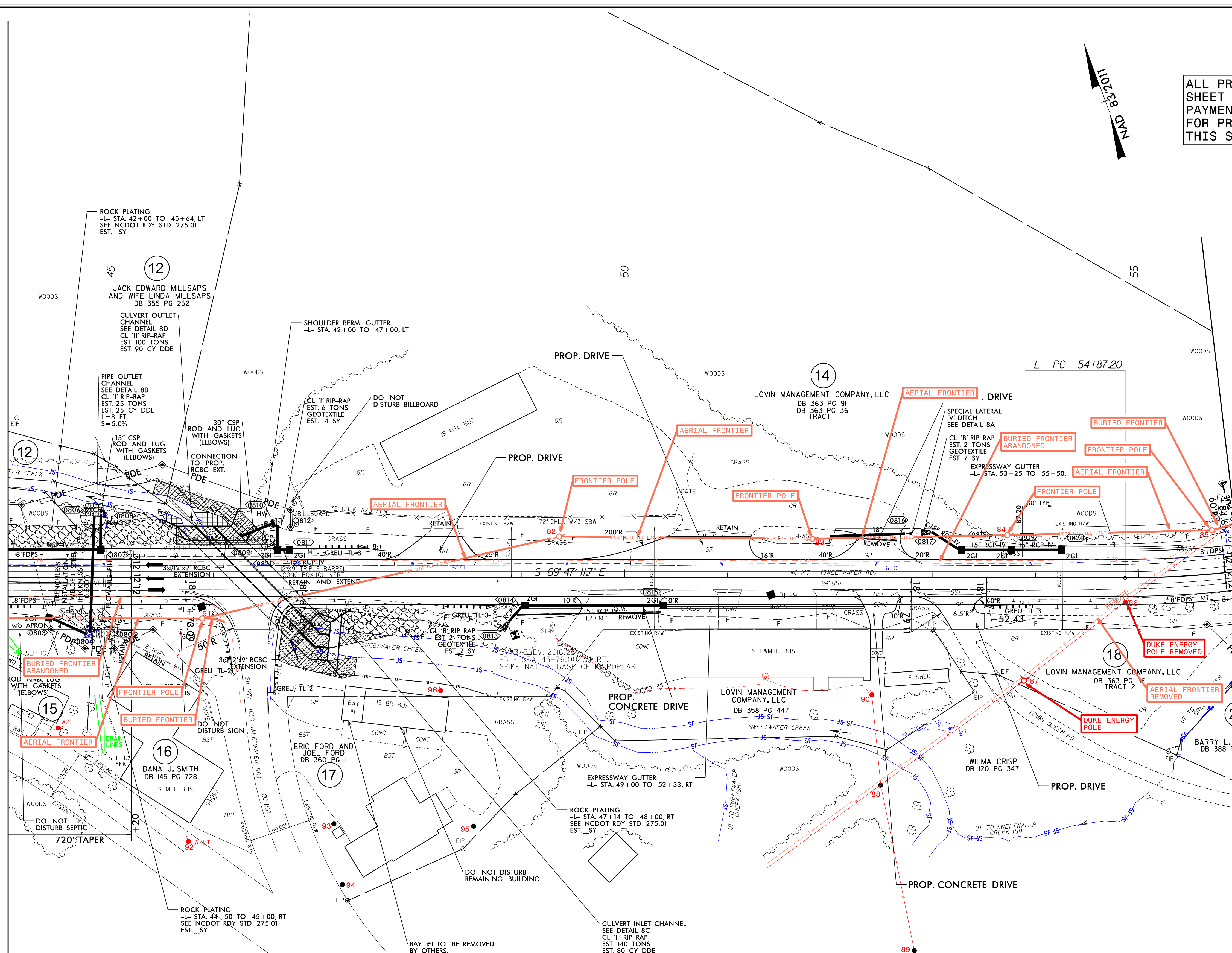

5/14/99  
27-MAY-2022 15:37  
C:\Users\jramm\OneDrive\Documents\Projects\0009CA\Utilities\Engineering\UB0\ProJA-0009CA\rdy9\_U007\_esh.dgn  
jramm

PROJECT REFERENCE NO.	SHEET NO.
A-0009CA	U0-7
THIS SHEET CORRESPONDS TO RDY-9	

### UTILITIES BY OTHERS

ALL PROPOSED UTILITY WORK SHOWN ON THIS SHEET WILL BE DONE BY OTHERS. NO PAYMENT WILL BE MADE TO THE CONTRACTOR FOR PROPOSED UTILITY WORK SHOWN ON THIS SHEET.

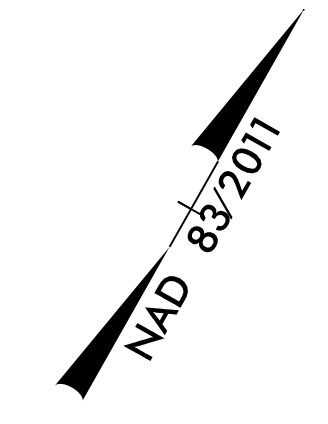

MATCH LINE STA L- 56+00.00  
MATCH TO SHEET UO-6

MATCH LINE STA L- 68+00.00  
MATCH TO SHEET UO-8

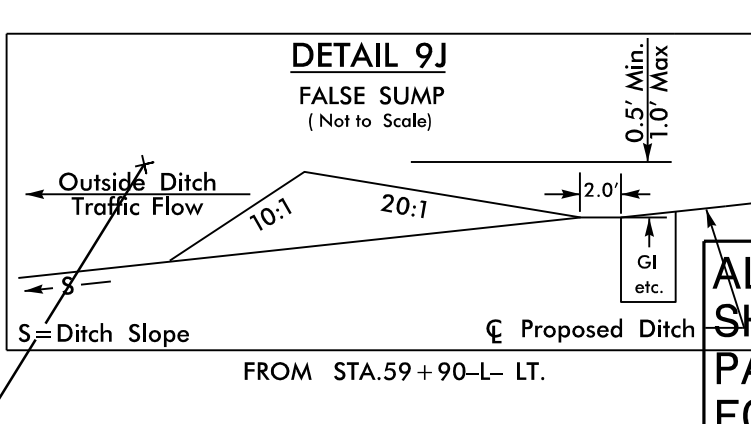
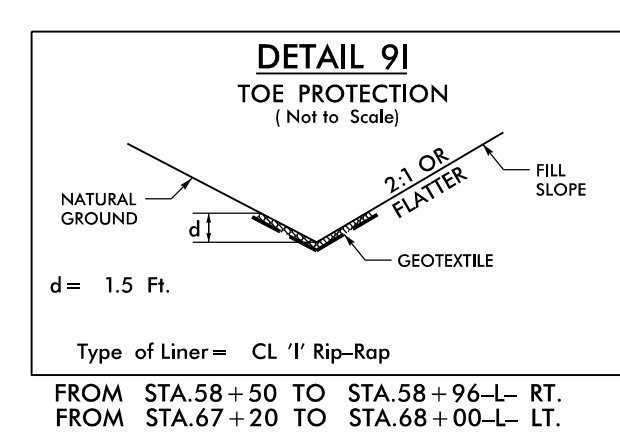
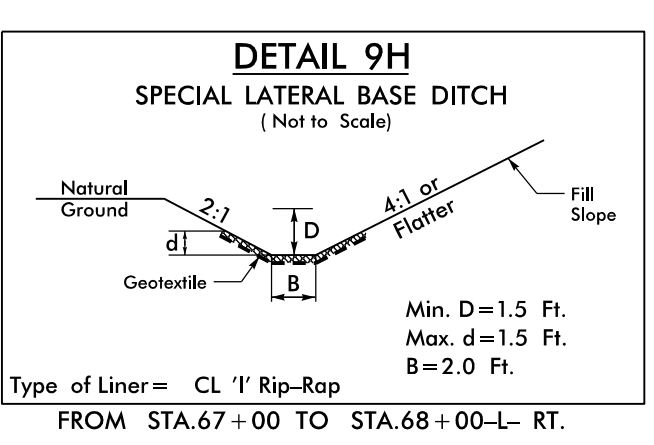
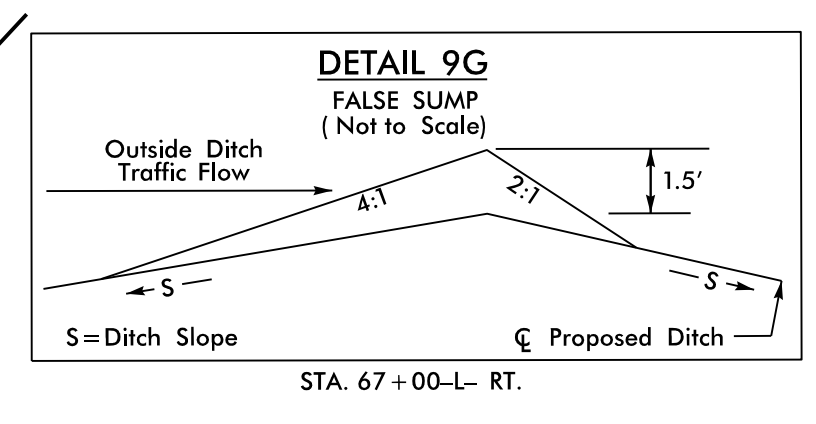
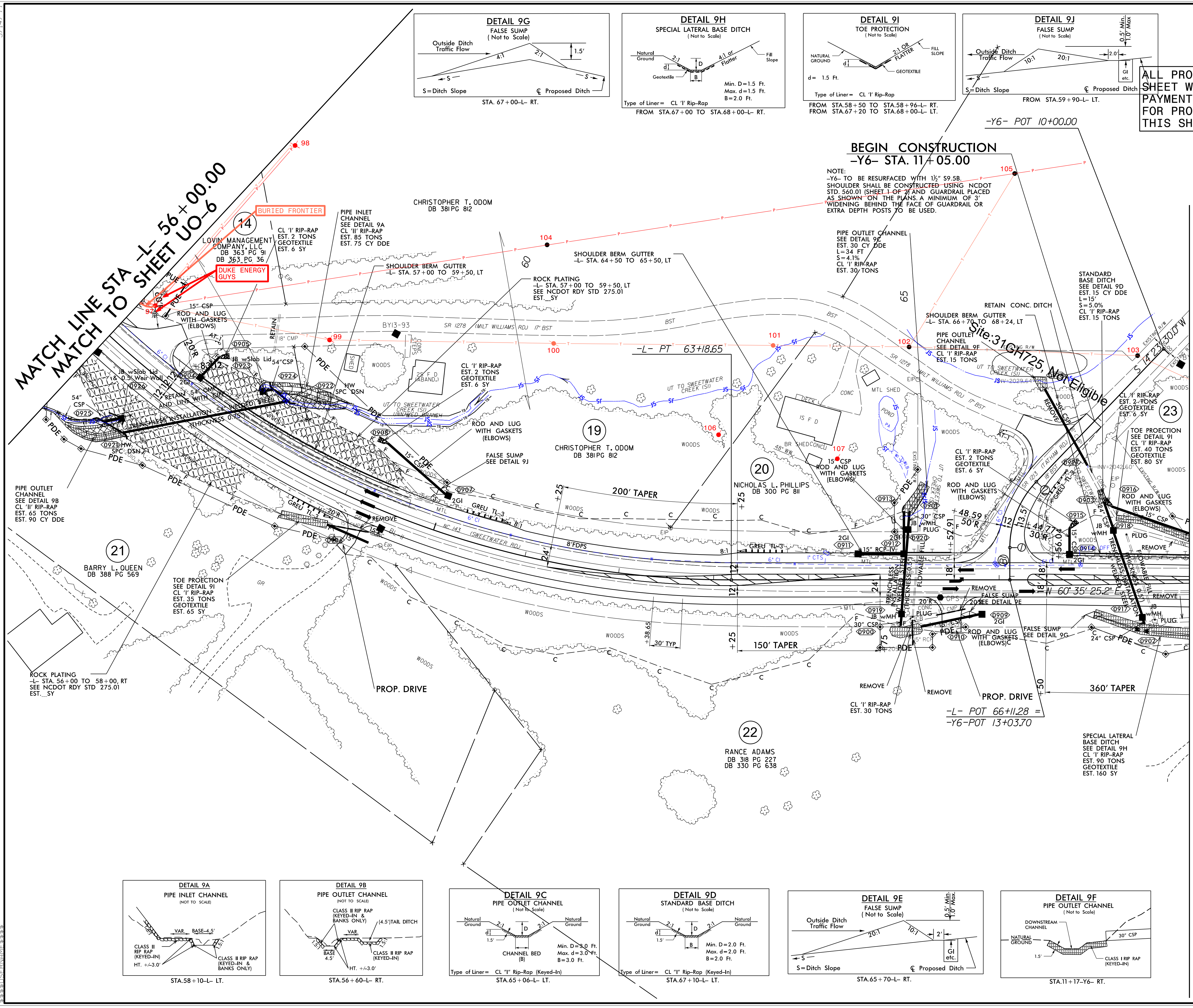

**BEGIN CONSTRUCTION**  
-Y6- STA. 11+05.00

NOTE:  
-Y6- TO BE RESURFACED WITH 1 1/2" S9.5B. SHOULDER SHALL BE CONSTRUCTED USING NCDOT STD. 560.01 (SHEET 1 OF 2) AND GUARDRAIL PLACED AS SHOWN ON THE PLANS. A MINIMUM OF 3' WIDENING BEHIND THE FACE OF GUARDRAIL OR EXTRA DEPTH POSTS TO BE USED.

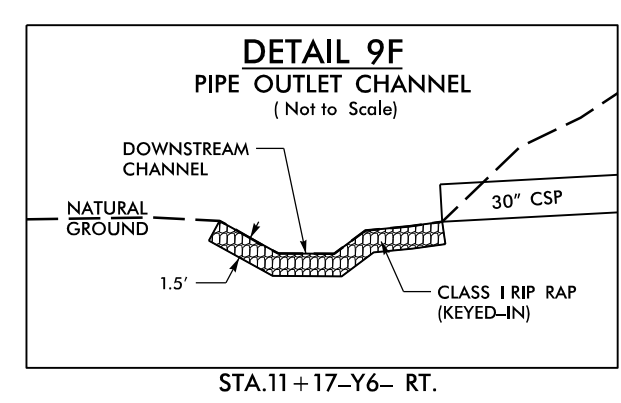
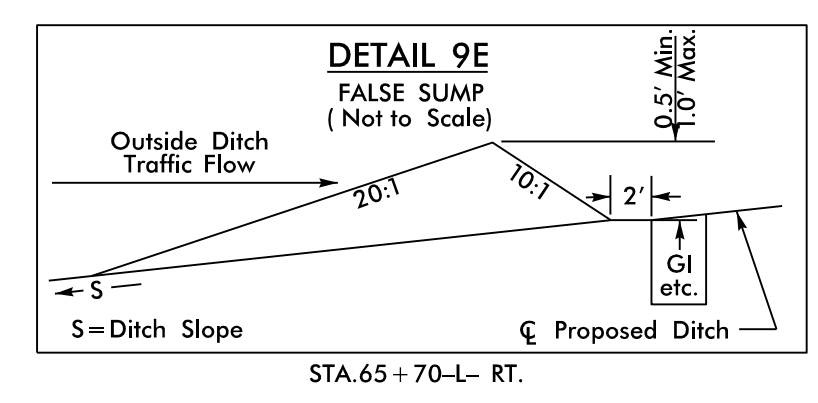
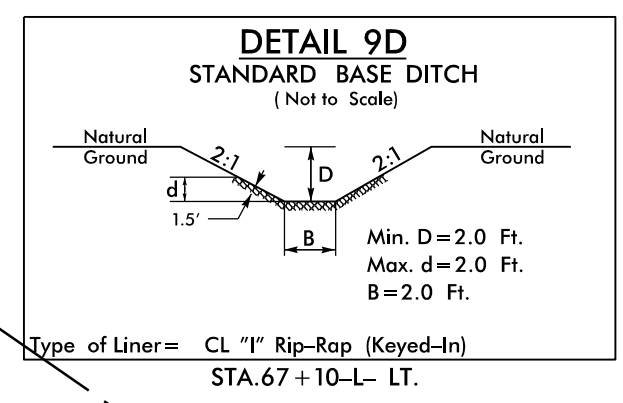
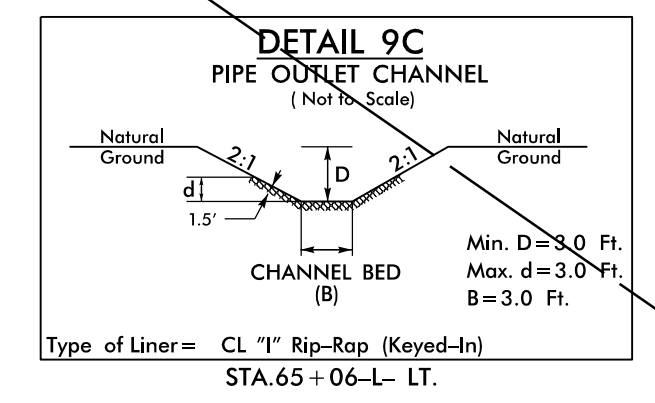
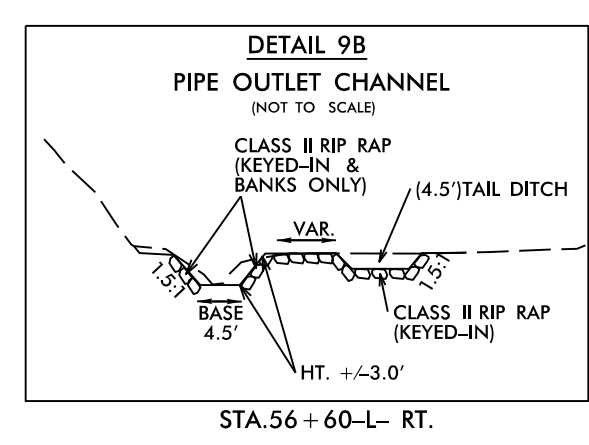
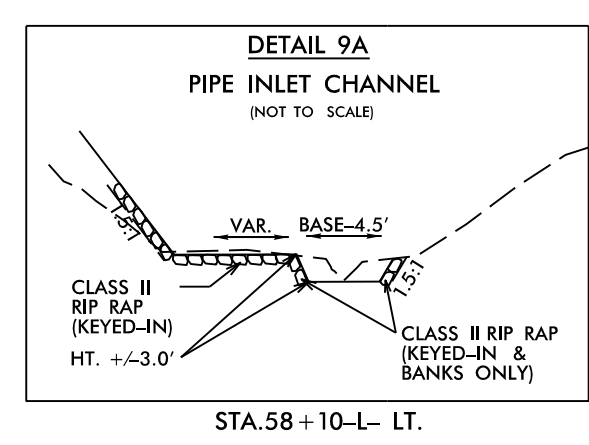

### UTILITIES BY OTHERS

ALL PROPOSED UTILITY WORK SHOWN ON THIS SHEET WILL BE DONE BY OTHERS. NO PAYMENT WILL BE MADE TO THE CONTRACTOR FOR PROPOSED UTILITY WORK SHOWN ON THIS SHEET.

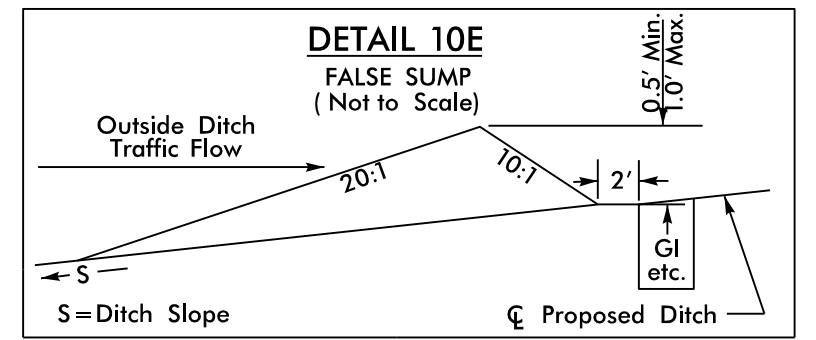
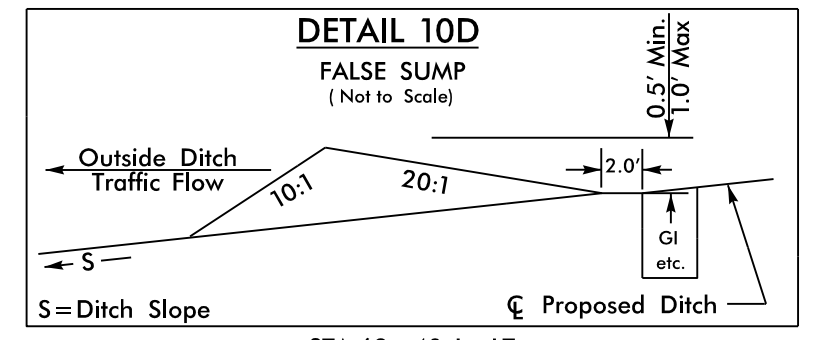
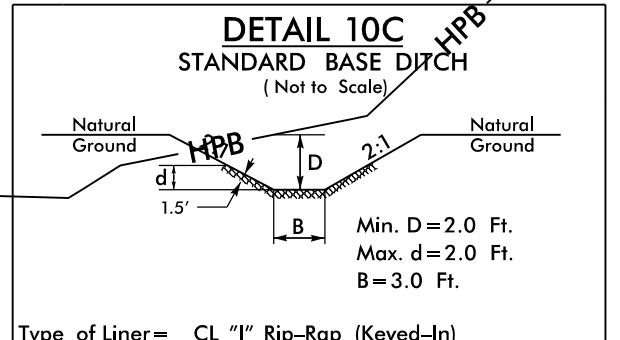
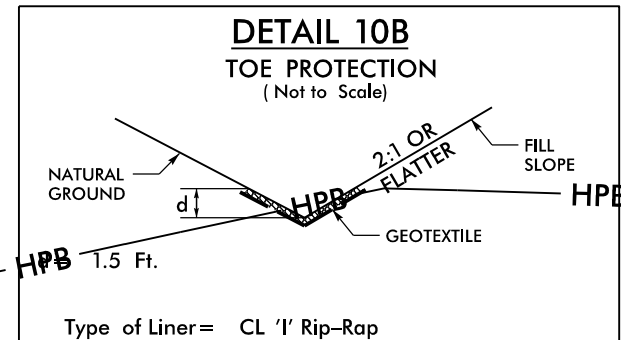
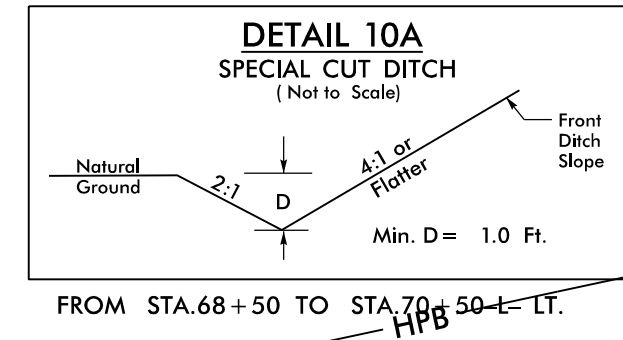

MATCH LINE STA -L- 68+00.00  
MATCH TO SHEET UO-7

MATCH LINE STA -L- 82+00.00  
MATCH TO SHEET UO-9

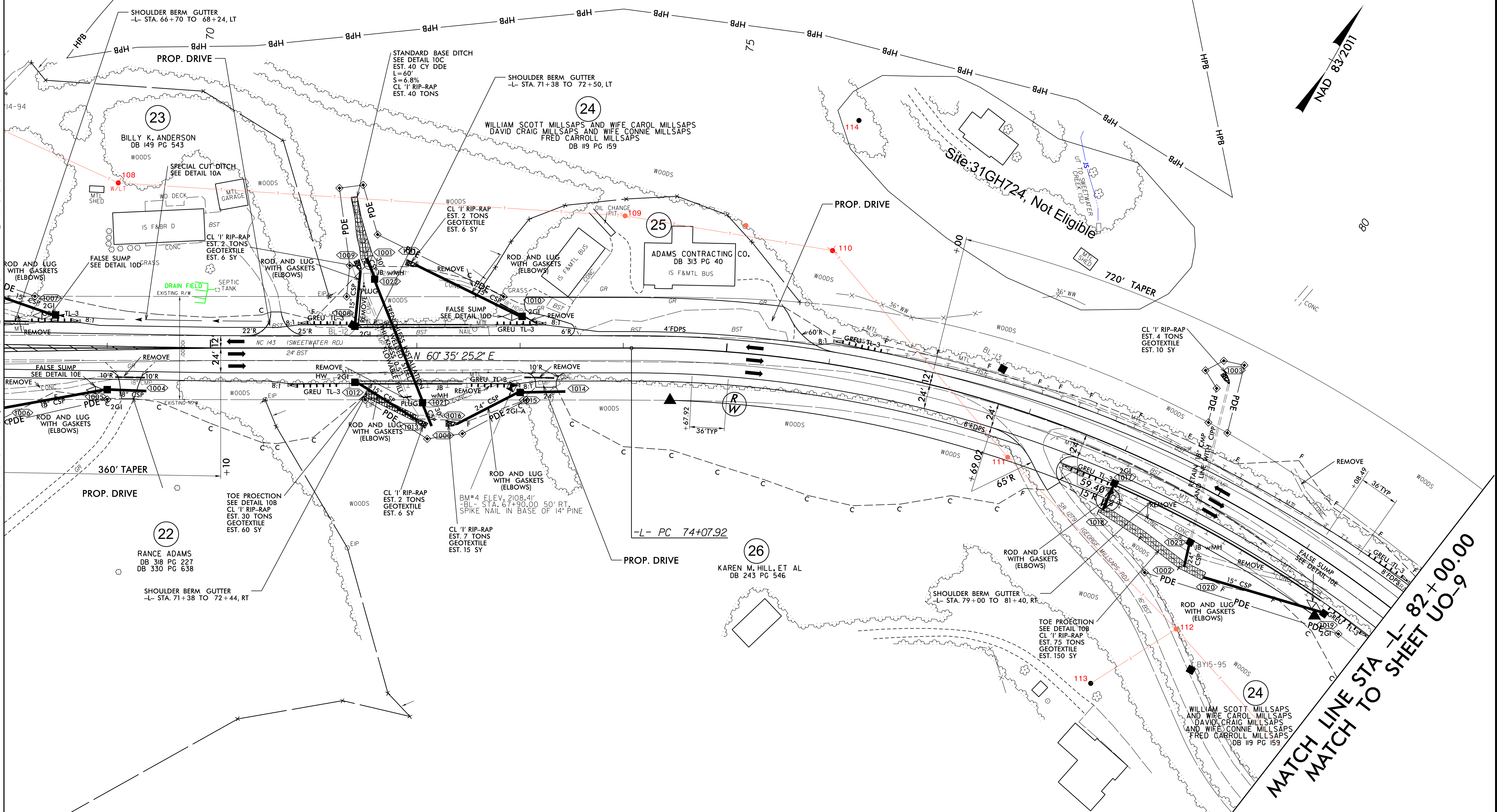



### UTILITIES BY OTHERS

ALL PROPOSED UTILITY WORK SHOWN ON THIS SHEET WILL BE DONE BY OTHERS. NO PAYMENT WILL BE MADE TO THE CONTRACTOR FOR PROPOSED UTILITY WORK SHOWN ON THIS SHEET.

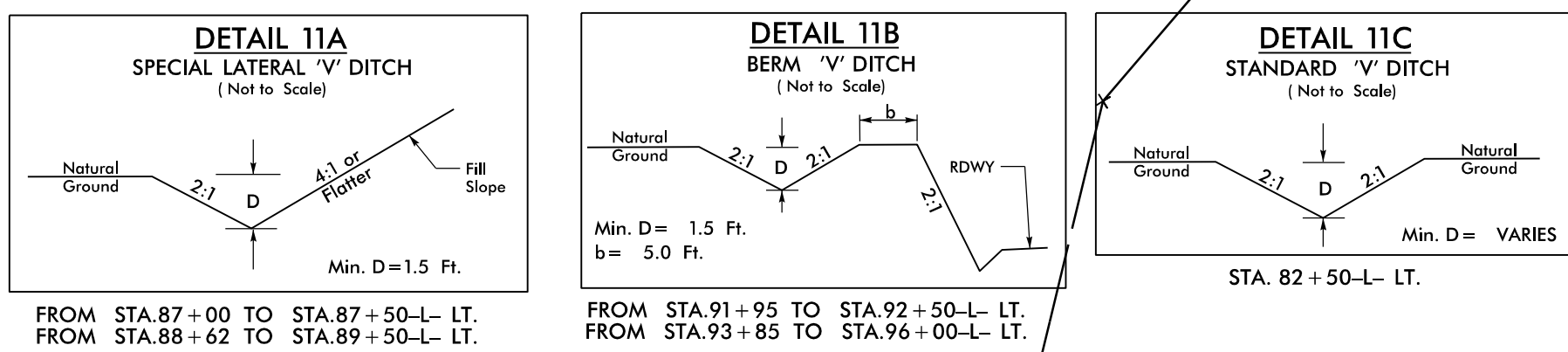

NAD 83/2011

5/14/09

MATCH LINE STA -L- 82+00.00  
MATCH TO SHEET UO-8

MATCH LINE TO SHEET UO-10  
-L- 96+00.00

27-MAY-2022 15:46 ITC:\Section\A\_UO\Utilities\Engineering\UBO\Proj\A-0009CA\_ut\_rdy\11\_UO09\_pah.dgn

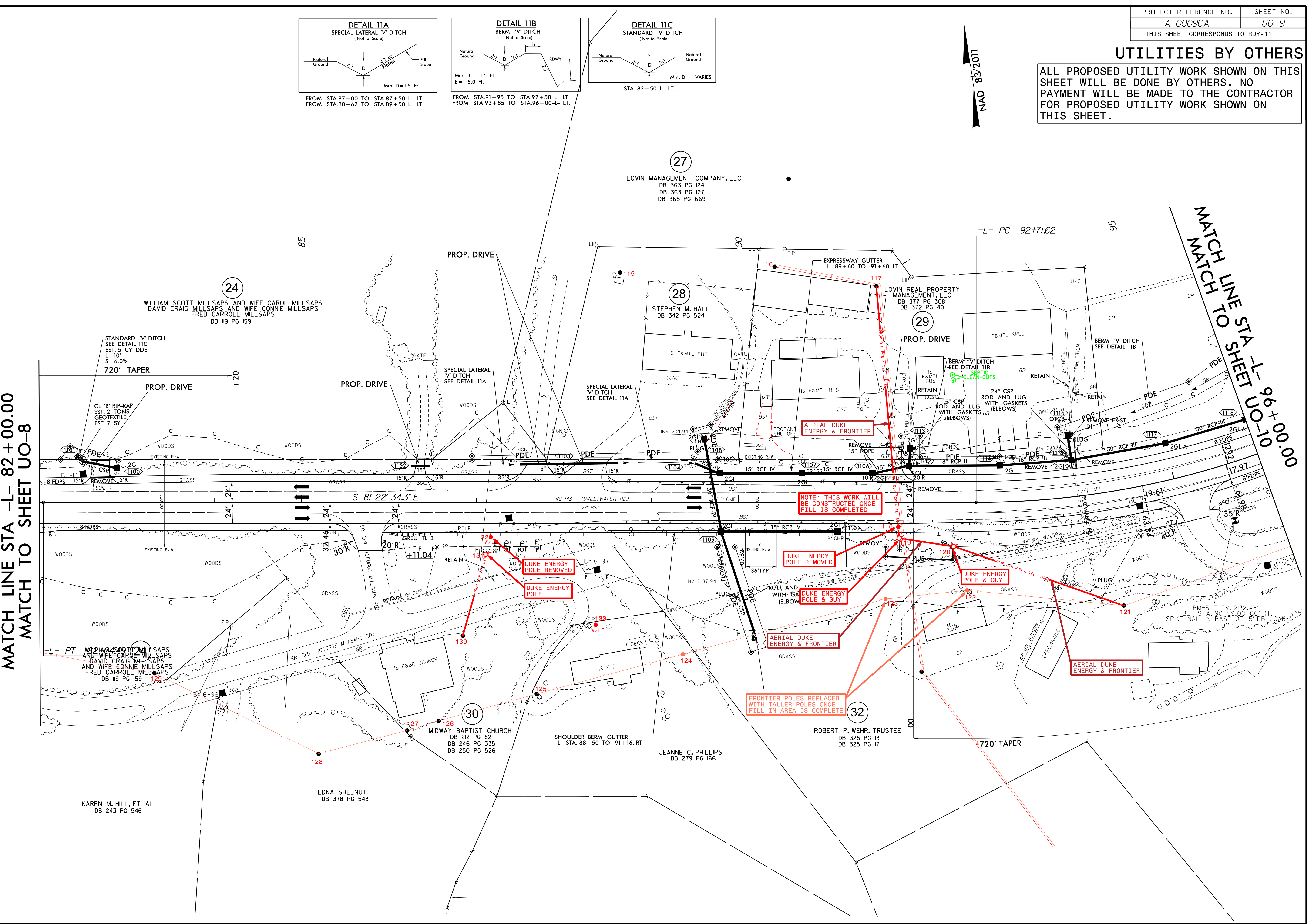

5/14/2022 15:50  
27-MAY-2022 15:50  
C:\Users\jramm\Documents\Engineering\UBO\Pro\A\A-0009CA\ut\_rdlj2\_LU0010\_psh.dgn  
27-MAY-2022 15:50  
C:\Users\jramm\Documents\Engineering\UBO\Pro\A\A-0009CA\ut\_rdlj2\_LU0010\_psh.dgn

PROJECT REFERENCE NO.	SHEET NO.
A-0009CA	UO-10
THIS SHEET CORRESPONDS TO R0Y-12	

### UTILITIES BY OTHERS

ALL PROPOSED UTILITY WORK SHOWN ON THIS SHEET WILL BE DONE BY OTHERS. NO PAYMENT WILL BE MADE TO THE CONTRACTOR FOR PROPOSED UTILITY WORK SHOWN ON THIS SHEET.



MATCH LINE STA -L- 96+00.00  
MATCH TO SHEET UO-9

MATCH LINE STA -L- 110+00.00  
MATCH TO SHEET UO-11

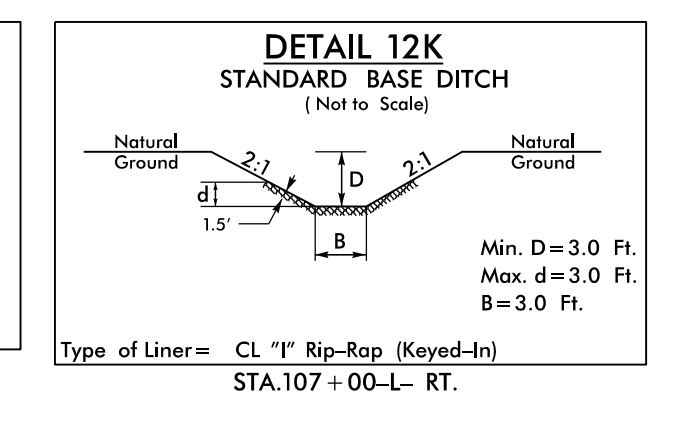
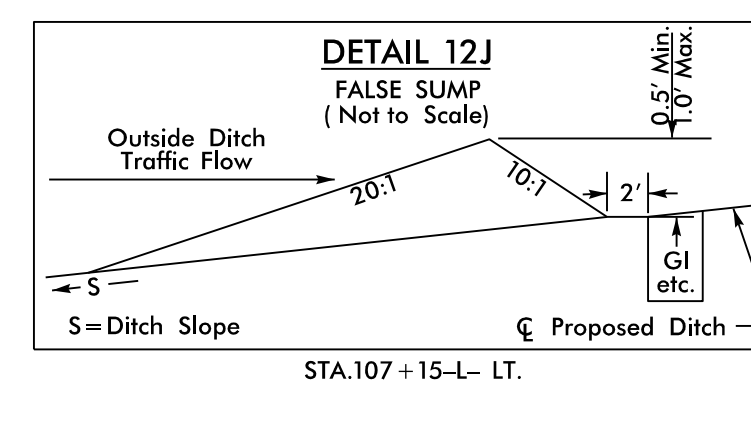
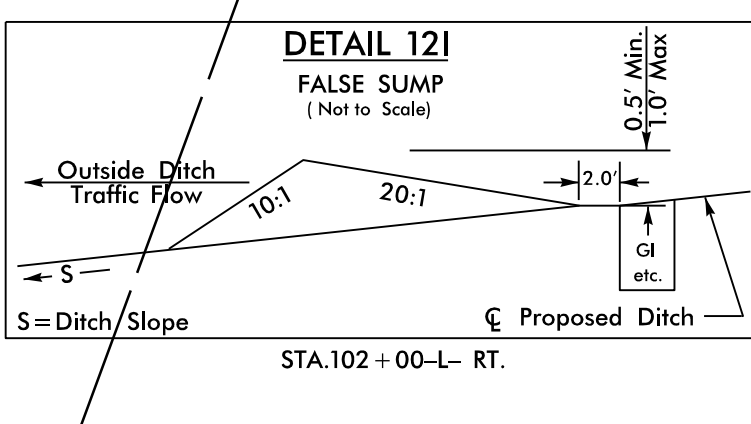
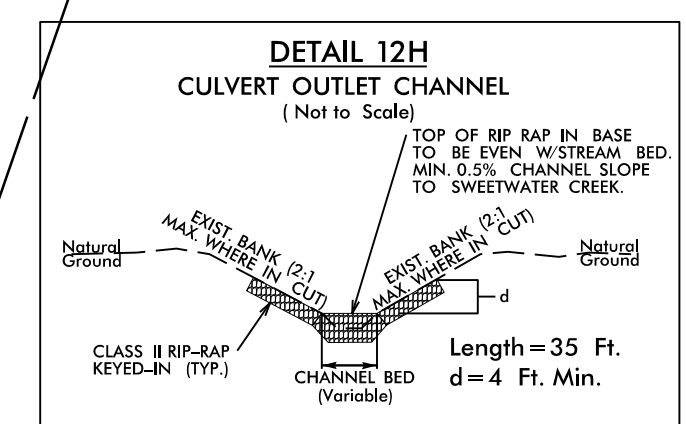
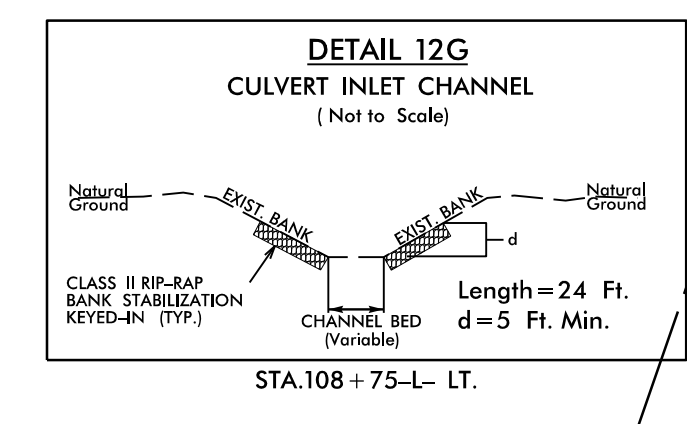
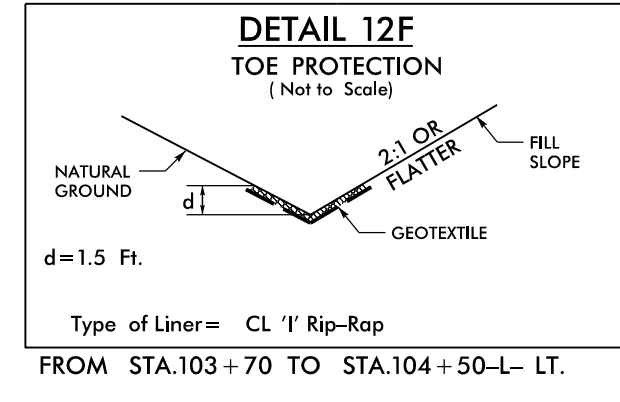
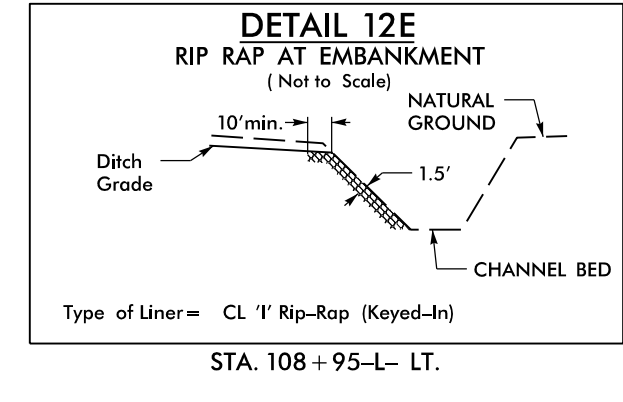
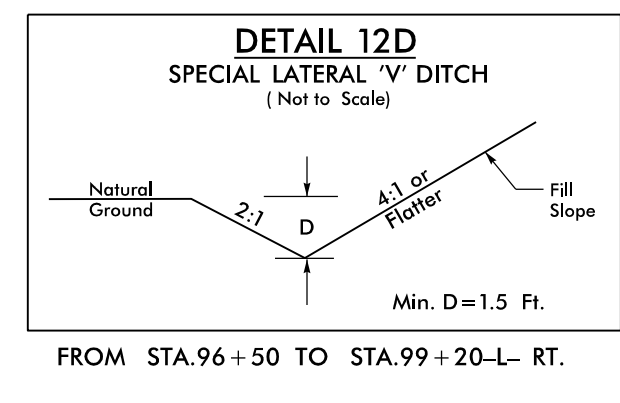
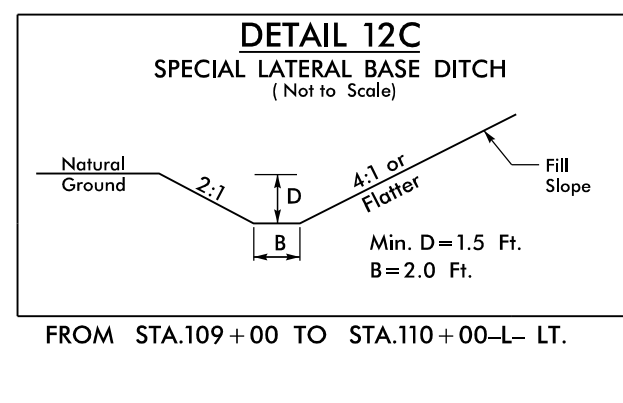
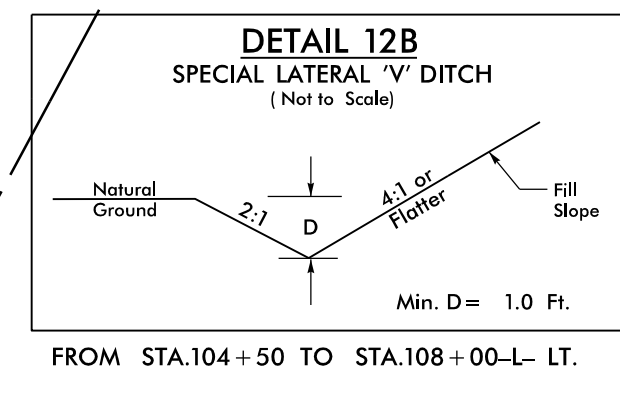
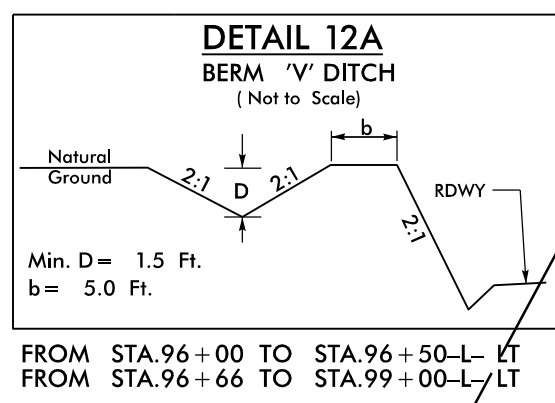
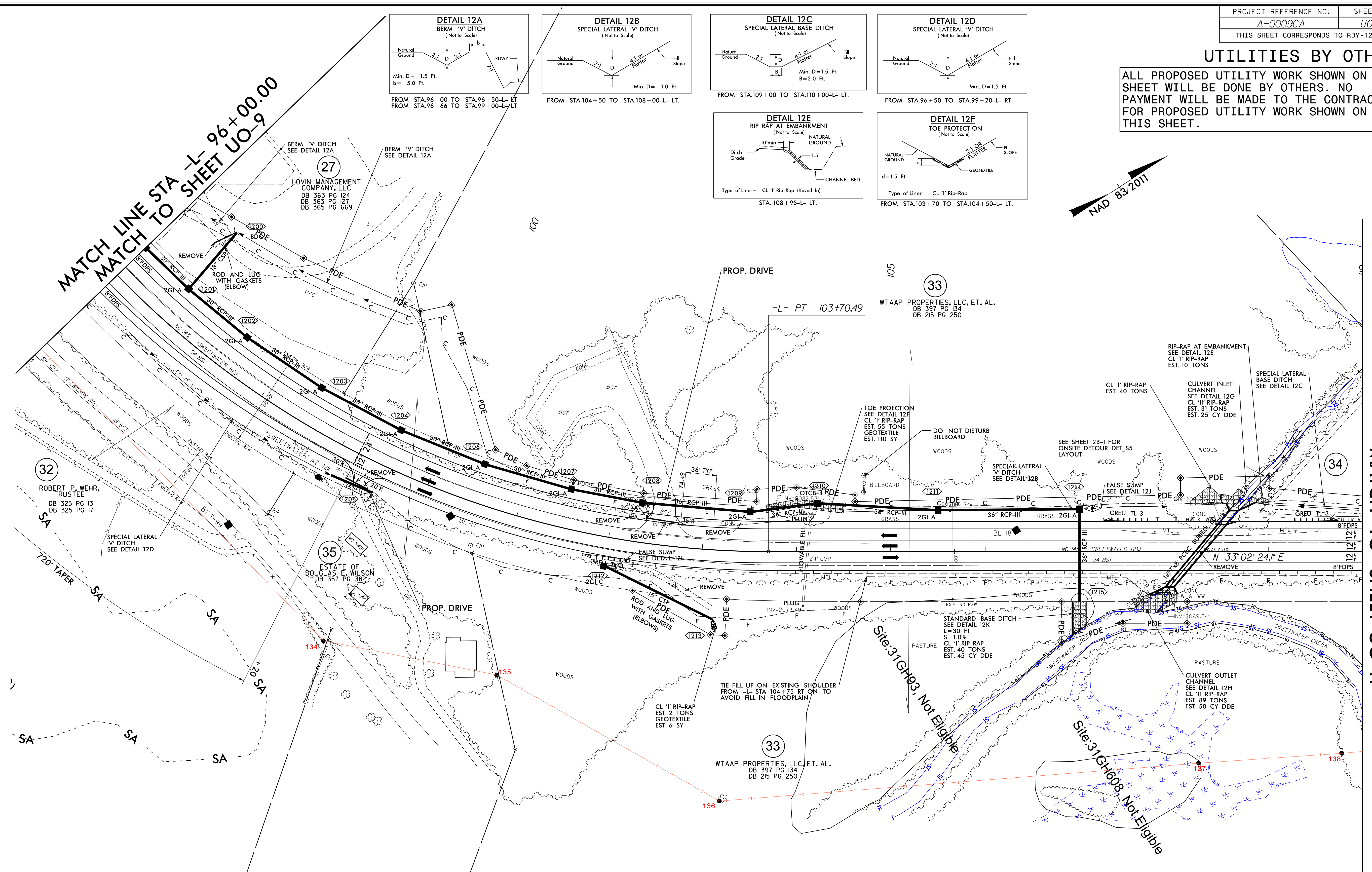

### UTILITIES BY OTHERS

ALL PROPOSED UTILITY WORK SHOWN ON THIS SHEET WILL BE DONE BY OTHERS. NO PAYMENT WILL BE MADE TO THE CONTRACTOR FOR PROPOSED UTILITY WORK SHOWN ON THIS SHEET.

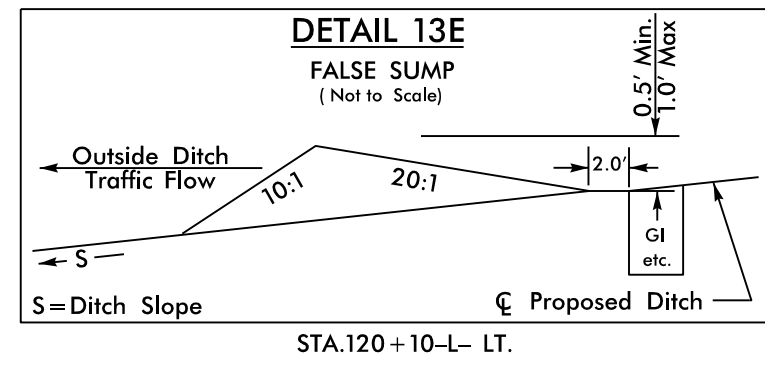
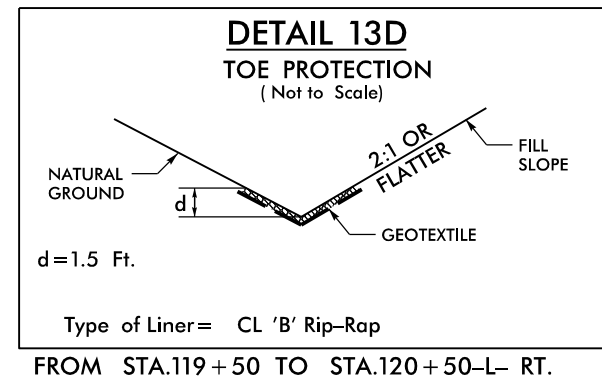
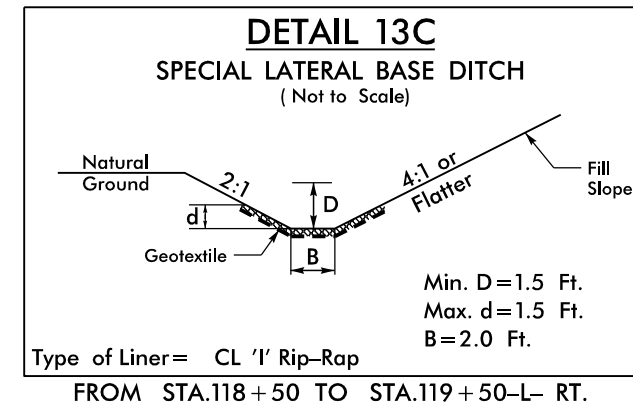
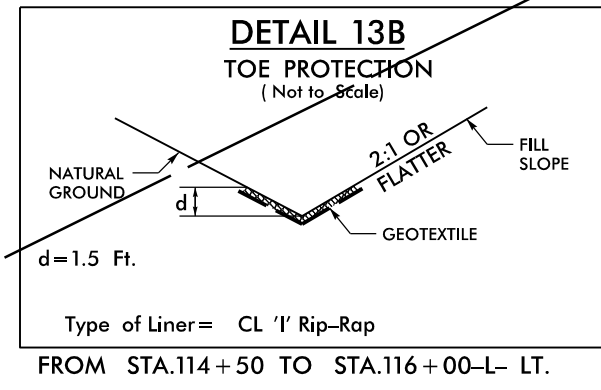
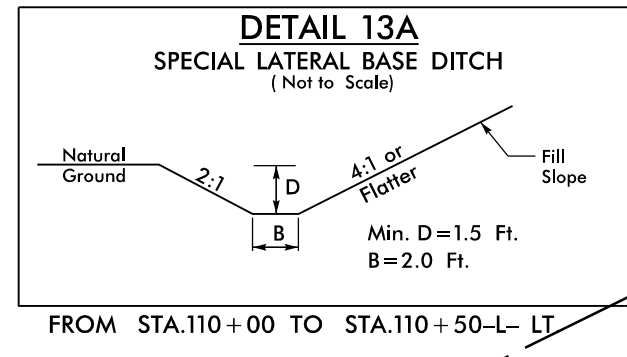

MATCH LINE STA -L- 110+00.00  
MATCH TO SHEET UO-10



MATCH LINE STA -L- 124+00.00  
MATCH TO SHEET UO-12

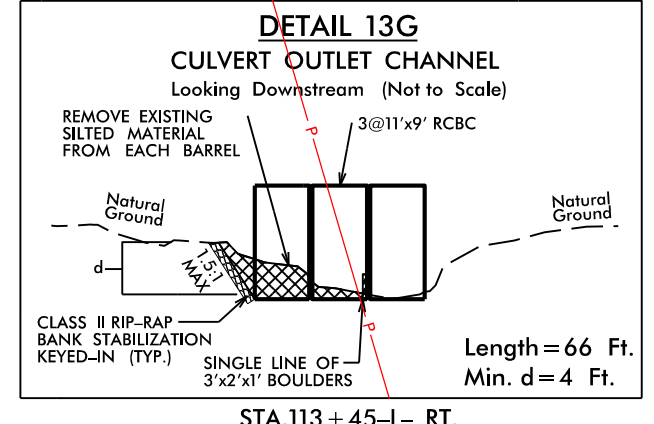
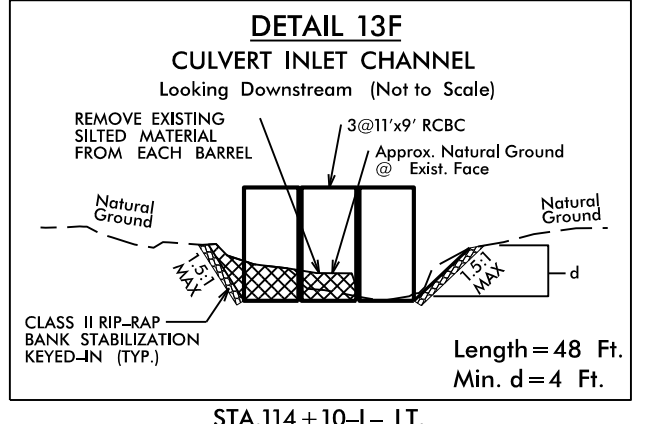
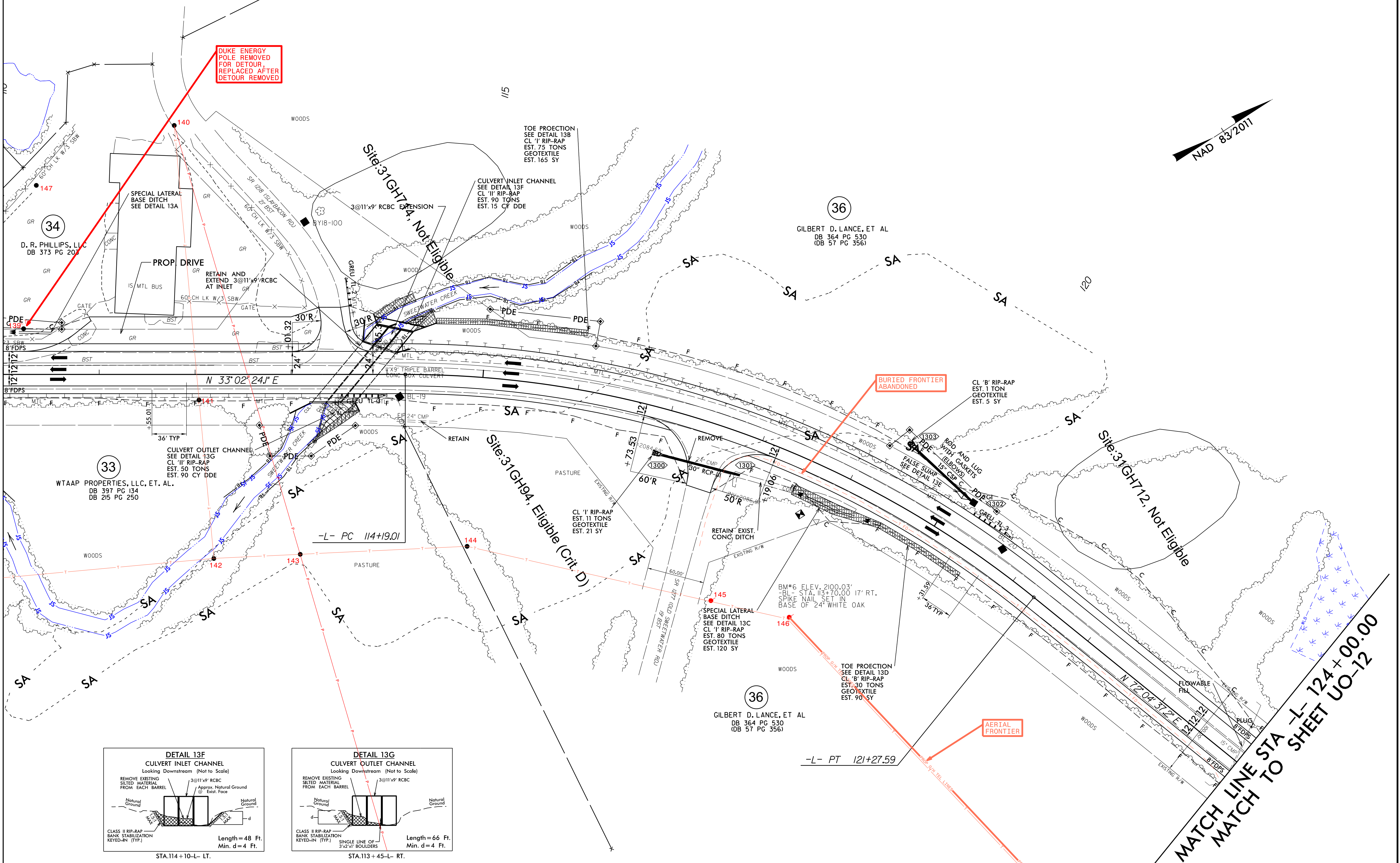



### UTILITIES BY OTHERS

ALL PROPOSED UTILITY WORK SHOWN ON THIS SHEET WILL BE DONE BY OTHERS. NO PAYMENT WILL BE MADE TO THE CONTRACTOR FOR PROPOSED UTILITY WORK SHOWN ON THIS SHEET.

5/14/19

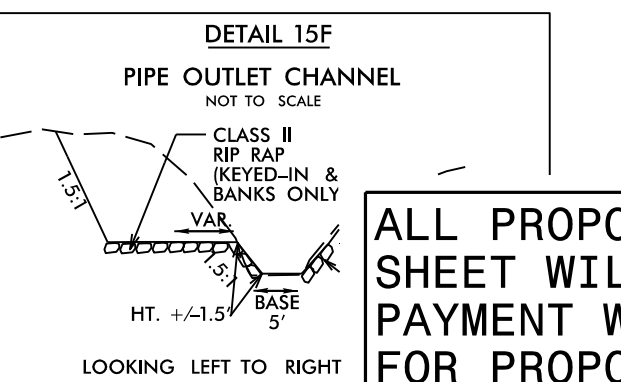
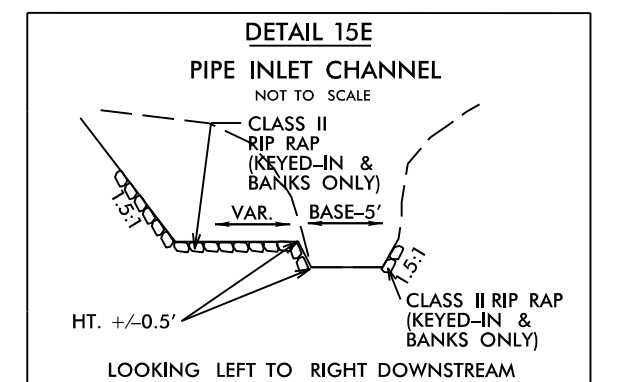
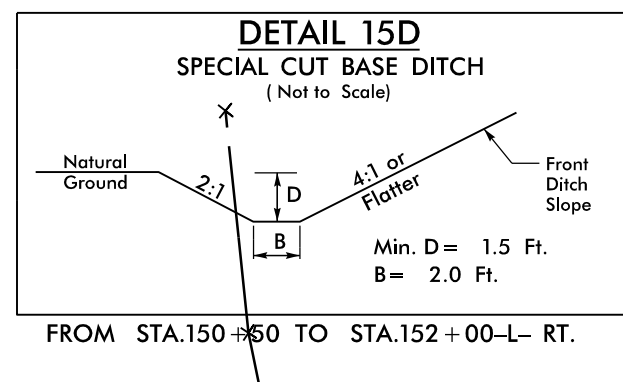
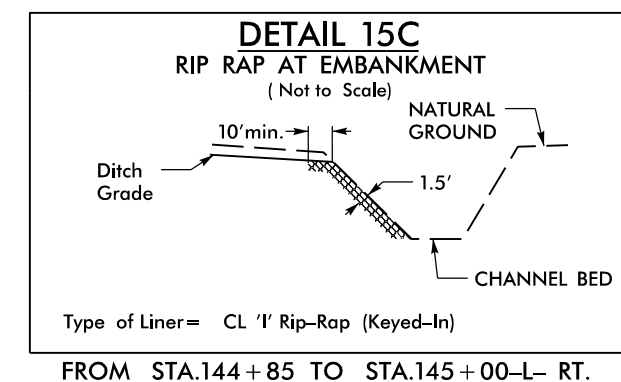
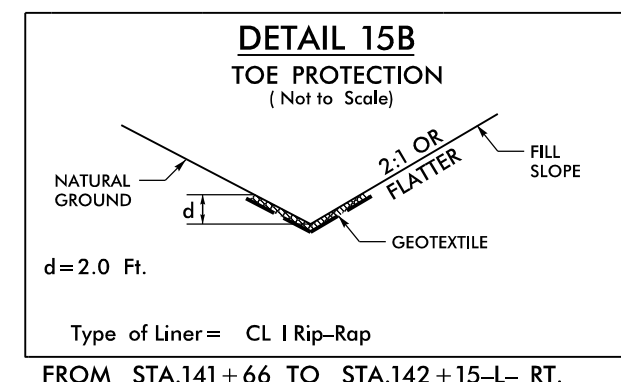
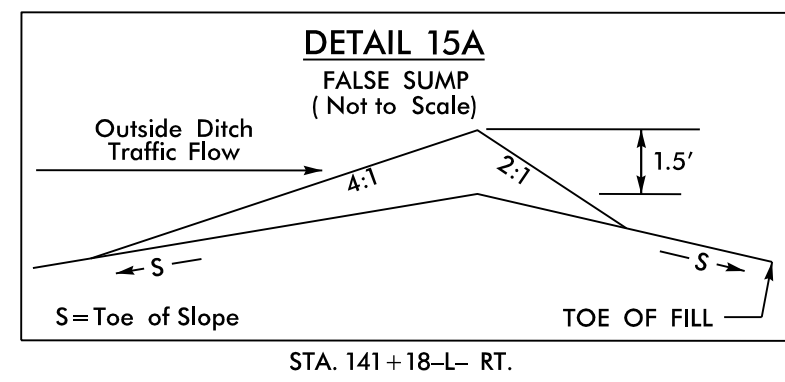

MATCH LINE STA -L- 138+00.00  
MATCH TO SHEET UO-12

MATCH LINE STA -L- 152+00.00  
MATCH TO SHEET UO-14

I:\Projects\27-MAY-2022\_1603\Utilities\Engineering\UBO\Project\A-0009CA-ut\_rdu\15\_UO013\_pshh.dgn

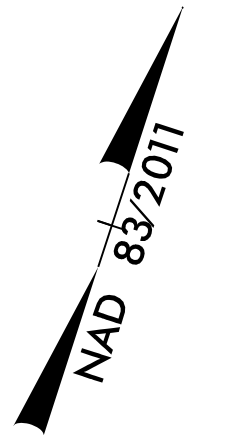
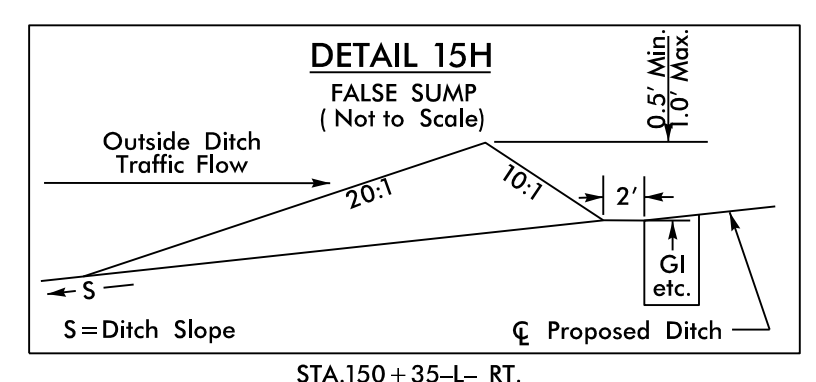
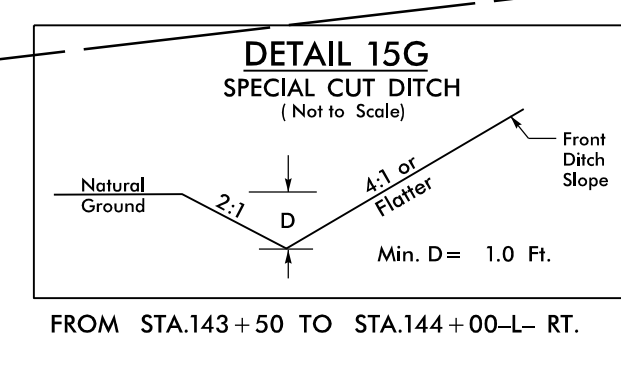
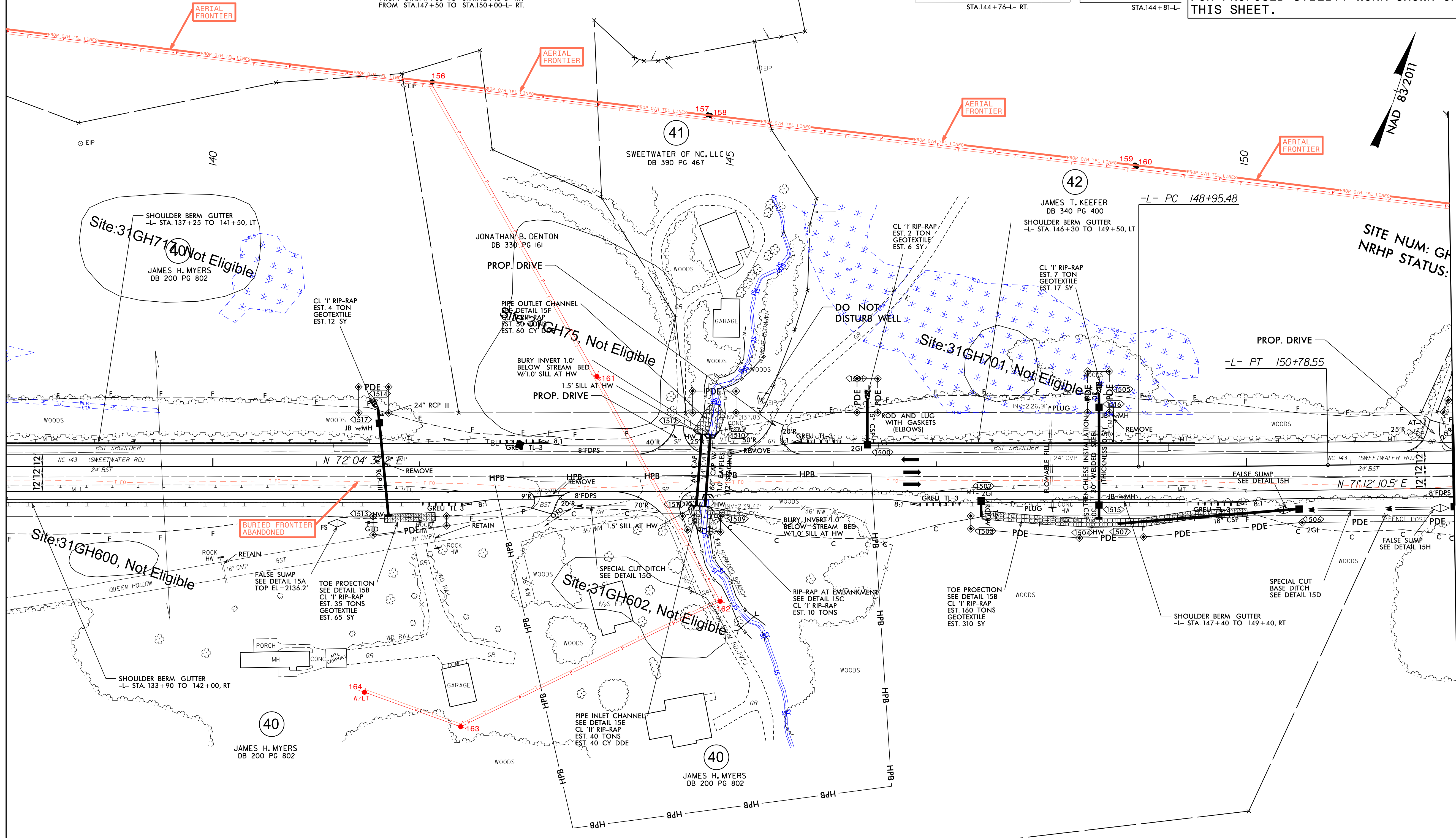

### UTILITIES BY OTHERS

ALL PROPOSED UTILITY WORK SHOWN ON THIS SHEET WILL BE DONE BY OTHERS. NO PAYMENT WILL BE MADE TO THE CONTRACTOR FOR PROPOSED UTILITY WORK SHOWN ON THIS SHEET.

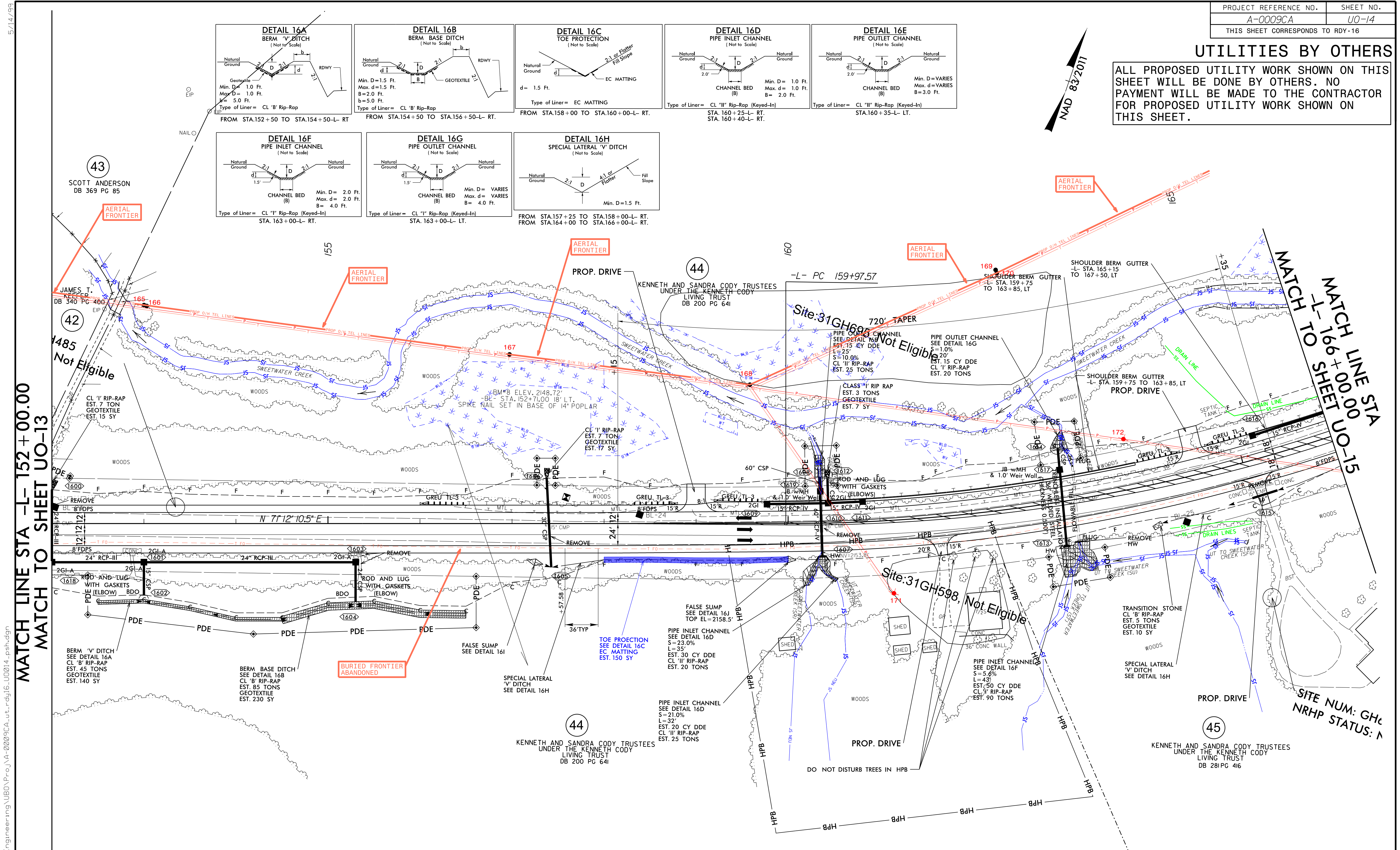
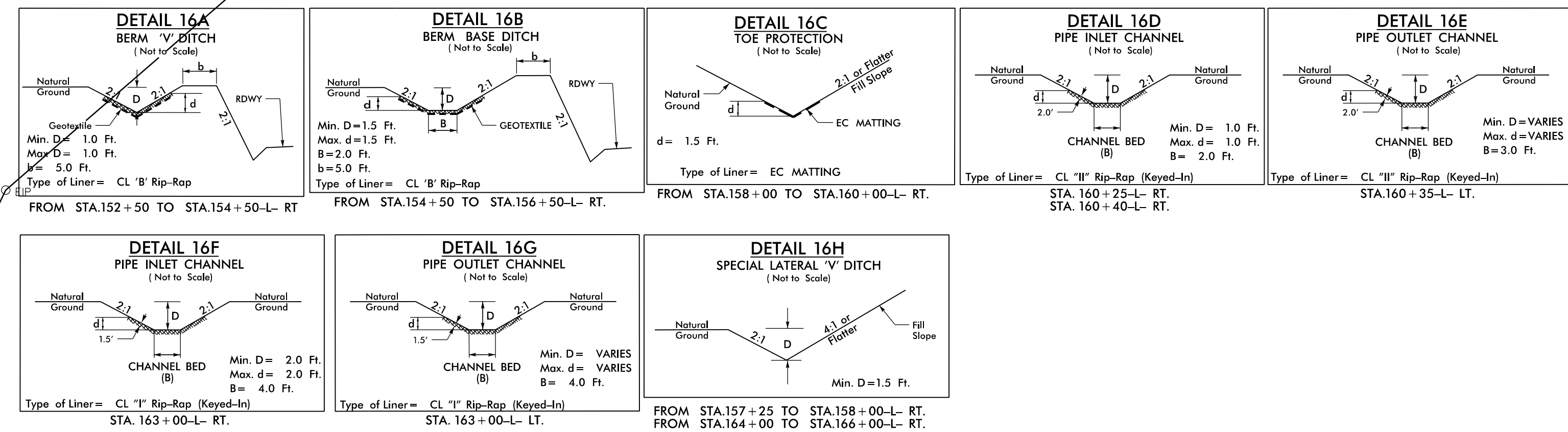
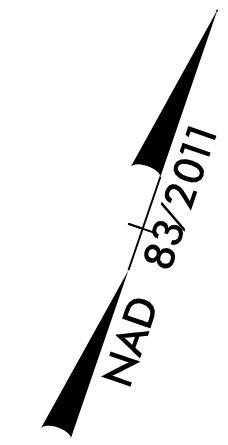

MATCH LINE STA -L- 152+00.00  
MATCH TO SHEET UO-13

MATCH LINE STA -L- 166+00.00 UO-15  
SHEET UO-15

SITE NUM: GHc  
NRHP STATUS: N

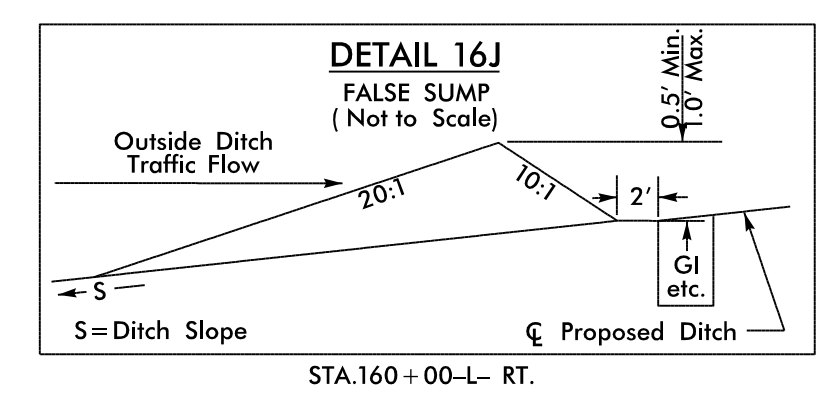
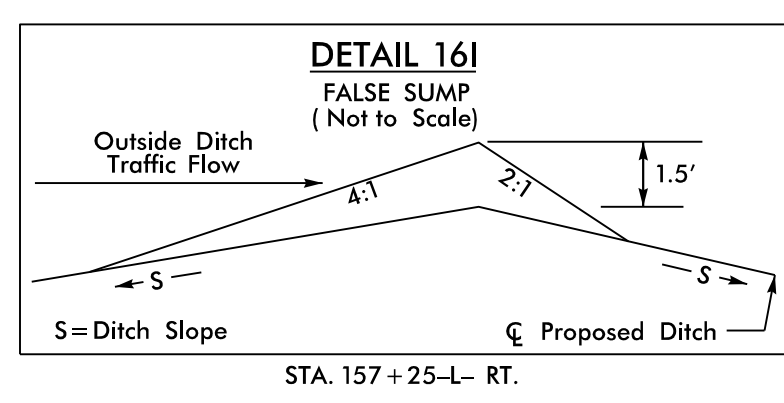

5/14/1999  
27-MAY-2022 16:07 Utilities\Engineer\ng\UB0\p-r-o\A-0009CA-rt-r.dwg:16\_U0014\_psh.dgn  
SASSET:ENR\COMPLESS

### UTILITIES BY OTHERS

ALL PROPOSED UTILITY WORK SHOWN ON THIS SHEET WILL BE DONE BY OTHERS. NO PAYMENT WILL BE MADE TO THE CONTRACTOR FOR PROPOSED UTILITY WORK SHOWN ON THIS SHEET.

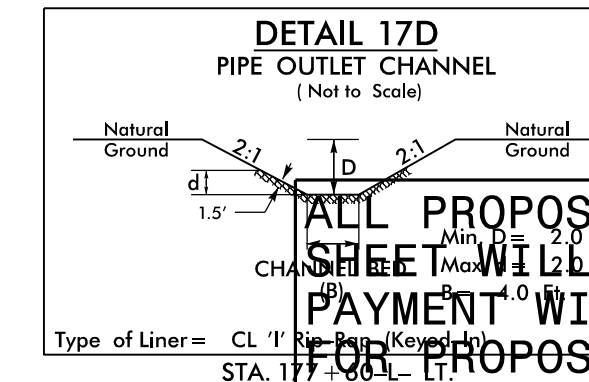
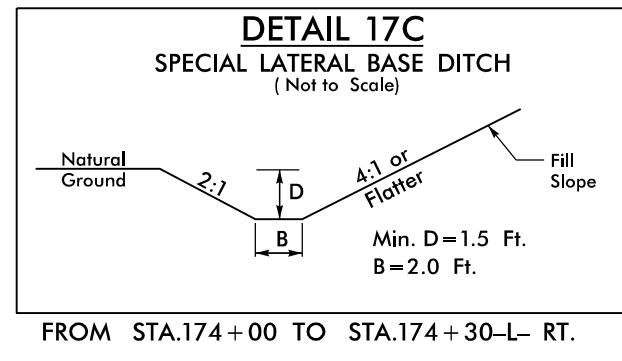
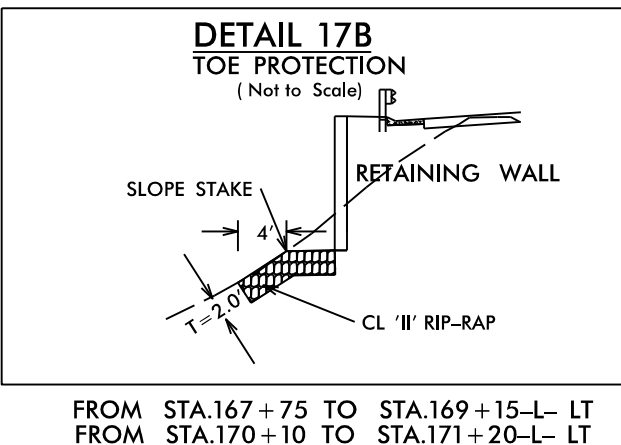
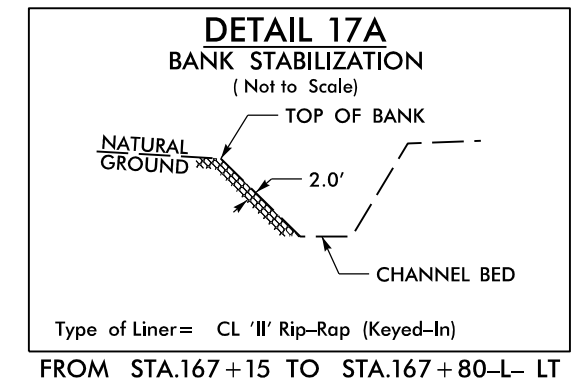
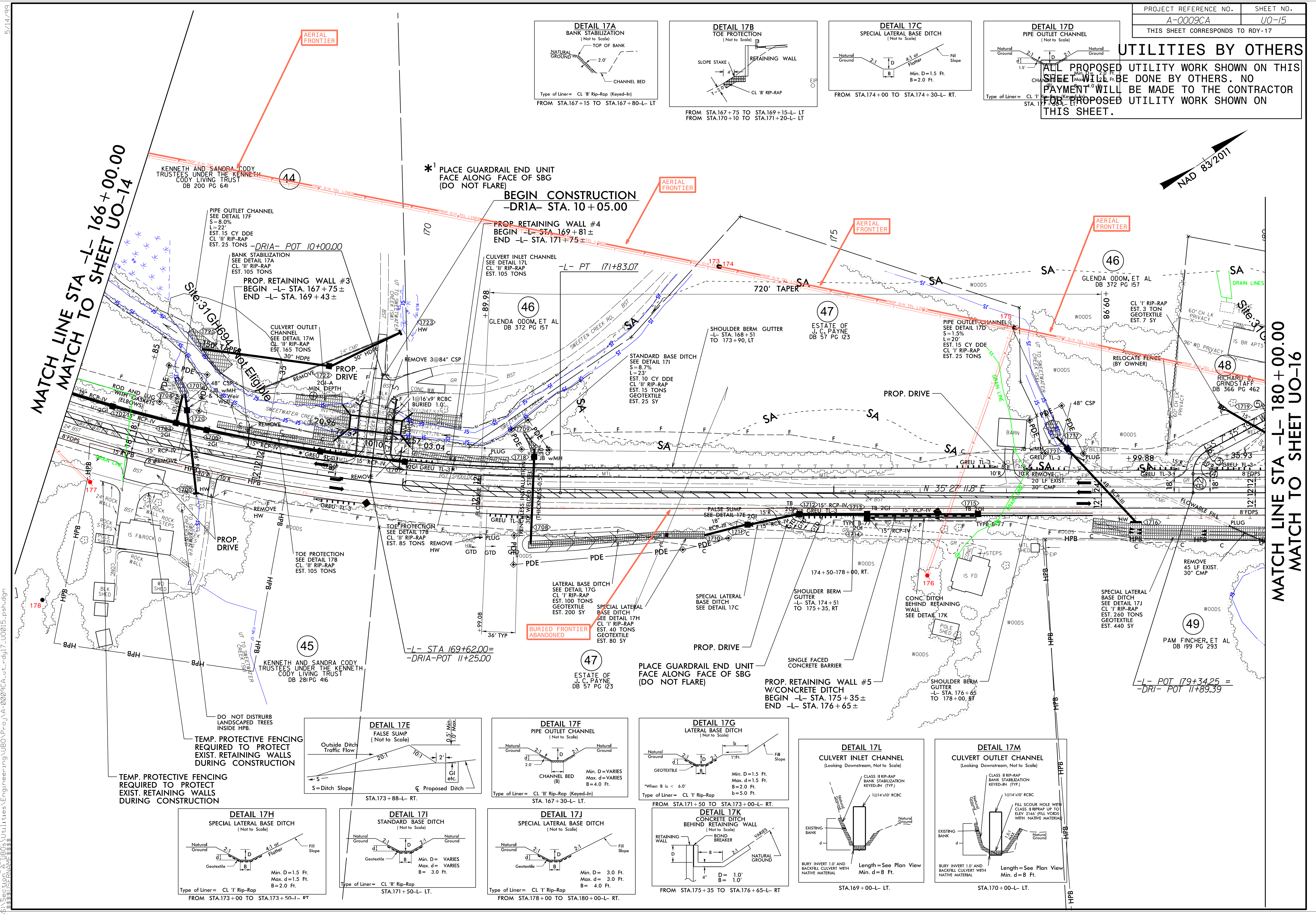

MATCH LINE STA -L- 166+00.00  
MATCH TO SHEET UO-14

MATCH LINE STA -L- 180+00.00  
MATCH TO SHEET UO-16

\*1 PLACE GUARDRAIL END UNIT  
FACE ALONG FACE OF SBG  
(DO NOT FLARE)

BEGIN CONSTRUCTION  
-DRIA- STA. 10+05.00

PROP RETAINING WALL #4  
BEGIN -L- STA. 169+81±  
END -L- STA. 171+75±

PIPE OUTLET CHANNEL  
SEE DETAIL 17F  
S=8.0%  
L=22'  
EST. 15 CY DDE  
CL '1' RIP-RAP  
EST. 25 TONS

BANK STABILIZATION  
SEE DETAIL 17A  
CL '1' RIP-RAP  
EST. 105 TONS

PROP RETAINING WALL #3  
BEGIN -L- STA. 167+75±  
END -L- STA. 169+43±

CULVERT INLET CHANNEL  
SEE DETAIL 17L  
CL '1' RIP-RAP  
EST. 105 TONS

GLENDA ODOM, ET AL  
DB 372 PG 157

STANDARD BASE DITCH  
SEE DETAIL 17I  
S=8.7%  
L=23'  
EST. 10 CY DDE  
CL '1' RIP-RAP  
EST. 15 TONS  
GEOTEXTILE  
EST. 25 SY

ESTATE OF  
J. C. PAYNE  
DB 57 PG 123

PIPE OUTLET CHANNEL  
SEE DETAIL 17D  
S=1.5%  
L=20'  
EST. 15 CY DDE  
CL '1' RIP-RAP  
EST. 25 TONS

GLENDA ODOM, ET AL  
DB 372 PG 157

CL '1' RIP-RAP  
EST. 3 TON  
GEOTEXTILE  
EST. 7 SY

RELOCATE FENCE  
(BY OWNER)

RICHARD C.  
GRINDSTAFF  
DB 366 PG 462

LATERAL BASE DITCH  
SEE DETAIL 17G  
CL '1' RIP-RAP  
EST. 100 TONS  
GEOTEXTILE  
EST. 200 SY

SPECIAL LATERAL  
BASE DITCH  
SEE DETAIL 17H  
CL '1' RIP-RAP  
EST. 40 TONS  
GEOTEXTILE  
EST. 80 SY

PLACE GUARDRAIL END UNIT  
FACE ALONG FACE OF SBG  
(DO NOT FLARE)

PROP RETAINING WALL #5  
W/ CONCRETE DITCH  
BEGIN -L- STA. 175+35±  
END -L- STA. 176+65±

SPECIAL LATERAL  
BASE DITCH  
SEE DETAIL 17J  
CL '1' RIP-RAP  
EST. 260 TONS  
GEOTEXTILE  
EST. 440 SY

PAM FINCHER, ET AL  
DB 199 PG 293

SHOULDER BERM  
GUTTER  
-L- STA. 174+51  
TO 175+35, RT

CONC. DITCH  
BEHIND RETAINING  
WALL  
SEE DETAIL 17K

SHOULDER BERM  
GUTTER  
-L- STA. 176+65  
TO 178+00, RT

PROP DRIVE

SINGLE FACED  
CONCRETE BARRIER

WOODS

REMOVE 45 LF EXIST.  
30" CMP

REMOVE 3@84" CSP

REMOVE 3@84" CSP

REMOVE 3@84" CSP

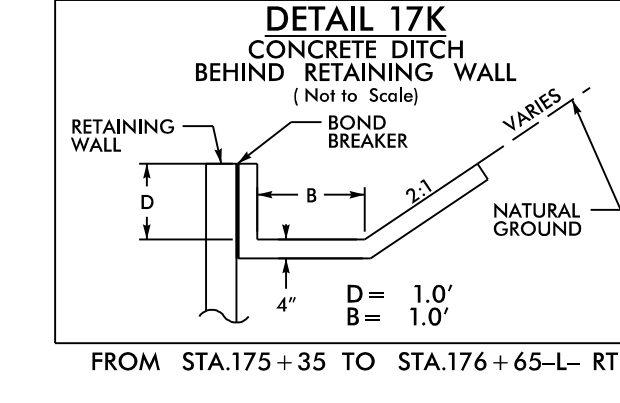
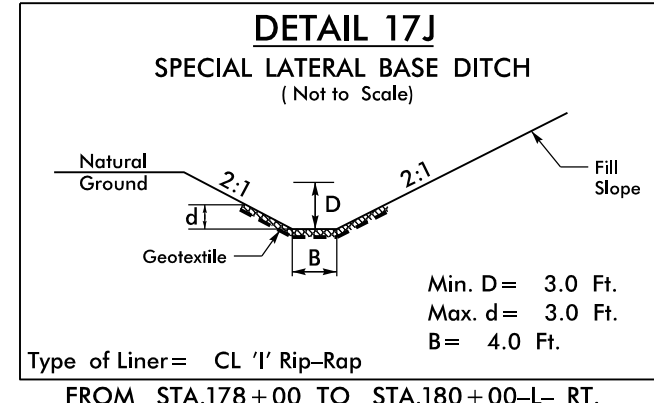
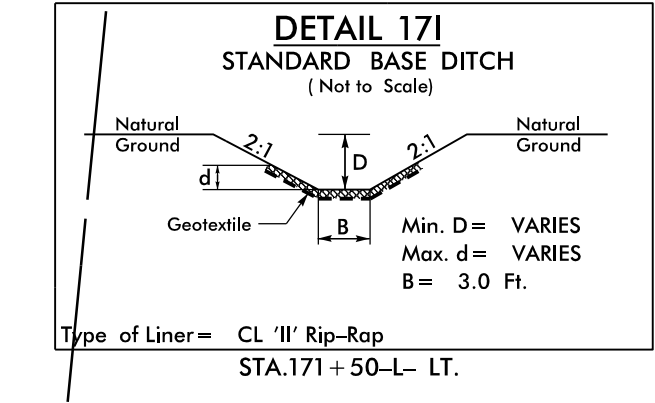
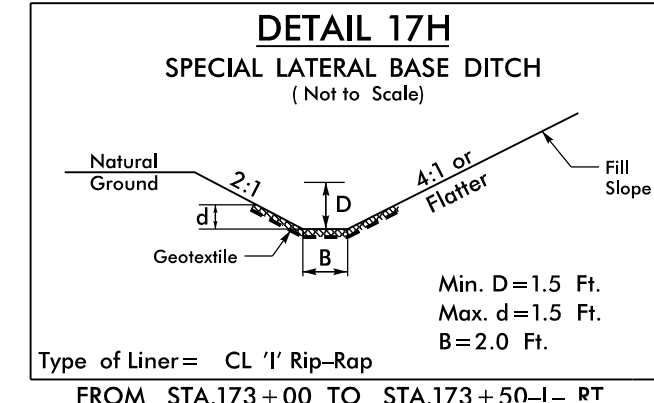
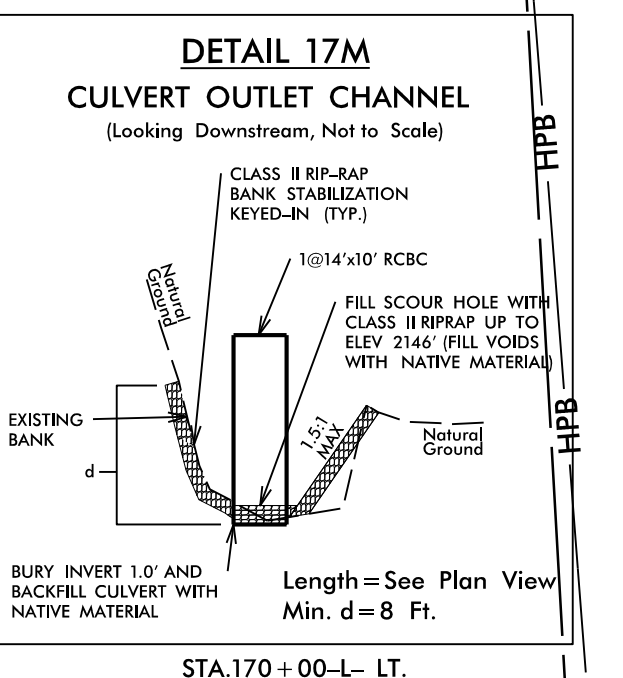
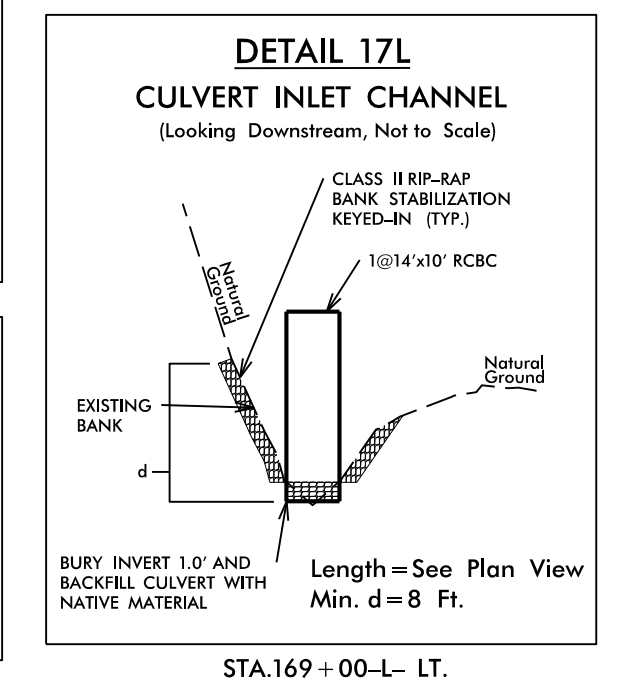
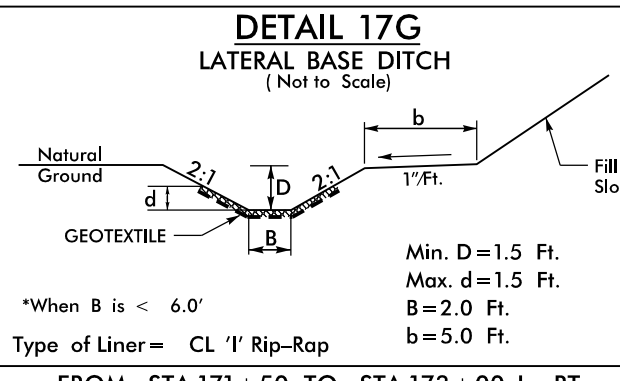
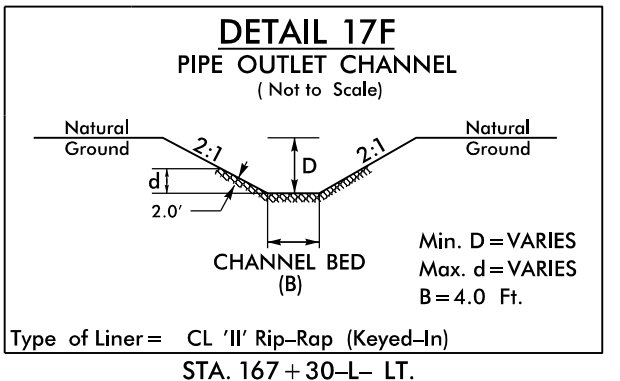
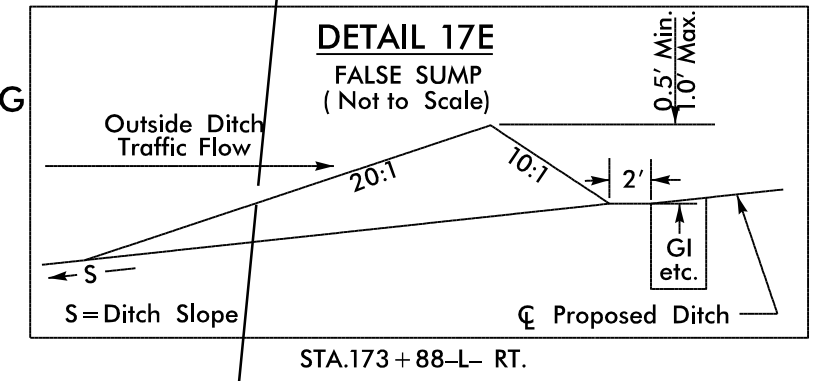

TEMP. PROTECTIVE FENCING  
REQUIRED TO PROTECT  
EXIST. RETAINING WALLS  
DURING CONSTRUCTION

TEMP. PROTECTIVE FENCING  
REQUIRED TO PROTECT  
EXIST. RETAINING WALLS  
DURING CONSTRUCTION

27 MAY 2022 16:40 Utilities\Engineering\UBO\Proj\A-0009CA\_ut\_r.dwg 1:0015.psh.dgn  
 90 (TGS)\Sector\Utilities\Engineering\UBO\Proj\A-0009CA\_ut\_r.dwg 1:0015.psh.dgn





