

BILL OF MATERIAL

BAR	NO.	SIZE	TYPE	LENGTH	WEIGHT	BAR	NO.	SIZE	TYPE	LENGTH	WEIGHT	BAR	NO.	SIZE	TYPE	LENGTH	WEIGHT	BAR	NO.	SIZE	TYPE	LENGTH	WEIGHT	BAR	NO.	SIZE	TYPE	LENGTH	WEIGHT
A1	270	#5	1	7'-1"	1995	A200	108	#5	STR	25'-11"	2919	A300	108	#7	STR	25'-11"	5721	A400	108	#7	STR	25'-11"	5721	B1	140	#5	STR	9'-11"	1448
A2	270	#5	1	5'-9"	1619	A201	2	#5	STR	25'-4"	53	A301	2	#7	STR	25'-4"	104	A401	2	#7	STR	25'-4"	104	B2	278	#4	STR	7'-4"	1362
A100	97	#6	STR	25'-11"	3776	A202	2	#5	STR	24'-6"	51	A302	2	#7	STR	24'-6"	100	A402	2	#7	STR	24'-6"	100	B3	208	#4	STR	9'-11"	1378
A101	2	#6	STR	25'-4"	76	A203	2	#5	STR	23'-8"	49	A303	2	#7	STR	23'-8"	97	A403	2	#7	STR	23'-8"	97						
A102	2	#6	STR	24'-5"	73	A204	2	#5	STR	22'-10"	48	A304	2	#7	STR	22'-10"	93	A404	2	#7	STR	22'-10"	93	C1	276	#4	STR	36'-4"	6699
A103	2	#6	STR	23'-6"	71	A205	2	#5	STR	22'-0"	46	A305	2	#7	STR	22'-0"	90	A405	2	#7	STR	22'-0"	90						
A104	2	#6	STR	22'-7"	68	A206	2	#5	STR	21'-2"	44	A306	2	#7	STR	21'-2"	87	A406	2	#7	STR	21'-2"	87	D1	24	#6	STR	2'-9"	99
A105	2	#6	STR	21'-8"	65	A207	2	#5	STR	20'-4"	42	A307	2	#7	STR	20'-4"	83	A407	2	#7	STR	20'-4"	83	D2	24	#6	STR	1'-9"	63
A106	2	#6	STR	20'-9"	62	A208	2	#5	STR	19'-6"	41	A308	2	#7	STR	19'-6"	80	A408	2	#7	STR	19'-6"	80						
A107	2	#6	STR	19'-10"	60	A209	2	#5	STR	18'-8"	39	A309	2	#7	STR	18'-8"	76	A409	2	#7	STR	18'-8"	76	G1	8	#5	STR	34'-10"	291
A108	2	#6	STR	18'-10"	57	A210	2	#5	STR	17'-10"	37	A310	2	#7	STR	17'-10"	73	A410	2	#7	STR	17'-10"	73						
A109	2	#6	STR	17'-11"	54	A211	2	#5	STR	17'-0"	35	A311	2	#7	STR	17'-0"	69	A411	2	#7	STR	17'-0"	69	S10	12	#8	STR	34'-10"	1116
A110	2	#6	STR	17'-0"	51	A212	2	#5	STR	16'-2"	34	A312	2	#7	STR	16'-2"	66	A412	2	#7	STR	16'-2"	66						
A111	2	#6	STR	16'-1"	48	A213	2	#5	STR	15'-4"	32	A313	2	#7	STR	15'-4"	63	A413	2	#7	STR	15'-4"	63						
A112	2	#6	STR	15'-2"	46	A214	2	#5	STR	14'-6"	30	A314	2	#7	STR	14'-6"	59	A414	2	#7	STR	14'-6"	59						
A113	2	#6	STR	14'-3"	43	A215	2	#5	STR	13'-8"	29	A315	2	#7	STR	13'-8"	56	A415	2	#7	STR	13'-8"	56						
A114	2	#6	STR	13'-4"	40	A216	2	#5	STR	12'-10"	27	A316	2	#7	STR	12'-10"	52	A416	2	#7	STR	12'-10"	52						
A115	2	#6	STR	12'-5"	37	A217	2	#5	STR	12'-0"	25	A317	2	#7	STR	12'-0"	49	A417	2	#7	STR	12'-0"	49						
A116	2	#6	STR	11'-6"	35	A218	2	#5	STR	11'-2"	23	A318	2	#7	STR	11'-2"	46	A418	2	#7	STR	11'-2"	46						
A117	2	#6	STR	11'-6"	35	A219	2	#5	STR	10'-4"	22	A319	2	#7	STR	10'-4"	42	A419	2	#7	STR	10'-4"	42						
A118	2	#6	STR	10'-7"	32	A220	2	#5	STR	9'-6"	20	A320	2	#7	STR	9'-6"	39	A420	2	#7	STR	9'-6"	39						
A119	2	#6	STR	9'-7"	29	A221	2	#5	STR	8'-8"	18	A321	2	#7	STR	8'-8"	35	A421	2	#7	STR	8'-8"	35						
A120	2	#6	STR	8'-8"	26	A222	2	#5	STR	7'-10"	16	A322	2	#7	STR	7'-10"	32	A422	2	#7	STR	7'-10"	32						
A121	2	#6	STR	7'-9"	23	A223	2	#5	STR	7'-0"	15	A323	2	#7	STR	7'-0"	29	A423	2	#7	STR	7'-0"	29						
A122	2	#6	STR	6'-10"	21	A224	2	#5	STR	6'-2"	13	A324	2	#7	STR	6'-2"	25	A424	2	#7	STR	6'-2"	25						
A123	2	#6	STR	5'-11"	18	A225	2	#5	STR	5'-11"	18	A325	2	#7	STR	5'-4"	22	A425	2	#7	STR	5'-4"	22						
A124	2	#6	STR	5'-0"	15	A226	2	#5	STR	4'-6"	9	A326	2	#7	STR	4'-6"	18	A426	2	#7	STR	4'-6"	18						
						A227	2	#5	STR	3'-8"	8	A327	2	#7	STR	3'-8"	15	A427	2	#7	STR	3'-8"	15						
REINFORCING STEEL																						LBS.		39,286					

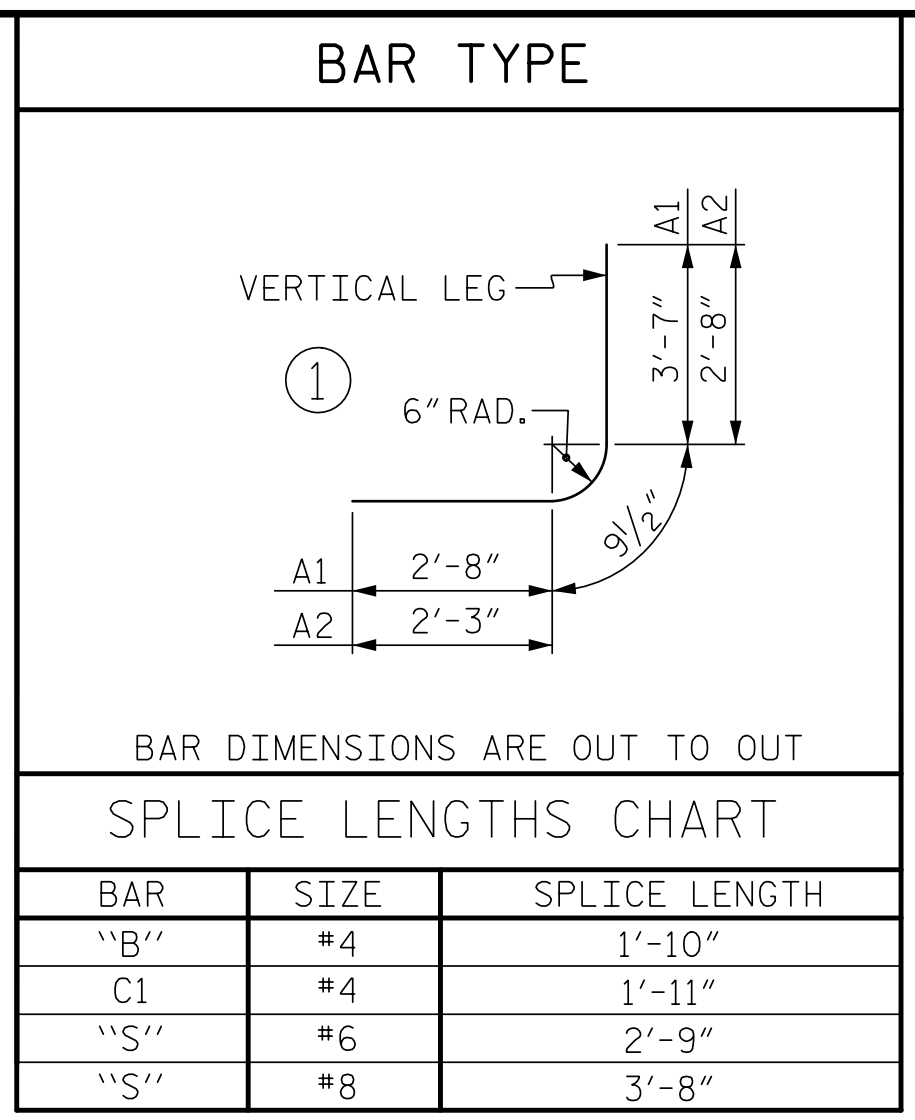

NOTES

NATIVE MATERIAL BETWEEN SILLS IN THE CULVERT SHALL PROVIDE A CONTINUOUS FLOW CHANNEL. NATIVE MATERIAL CONSISTS OF MATERIAL THAT IS EXCAVATED FROM THE STREAM BED AT THE PROJECT SITE DURING CONSTRUCTION. NATIVE MATERIAL IS SUBJECT TO APPROVAL BY THE ENGINEER AND MAY BE SUBJECT TO PERMIT CONDITIONS.

THE ENTIRE COST OF WORK REQUIRED TO PLACE EXCAVATED MATERIAL OR SUPPLEMENTAL MATERIAL AS SHOWN ON THE PLANS SHALL BE INCLUDED IN THE CONTRACT LUMP SUM PRICE BID FOR CULVERT EXCAVATION.

THE ENTIRE COST OF WORK REQUIRED TO CONSTRUCT THE SILLS SHALL BE INCLUDED IN THE VARIOUS PAY ITEMS.

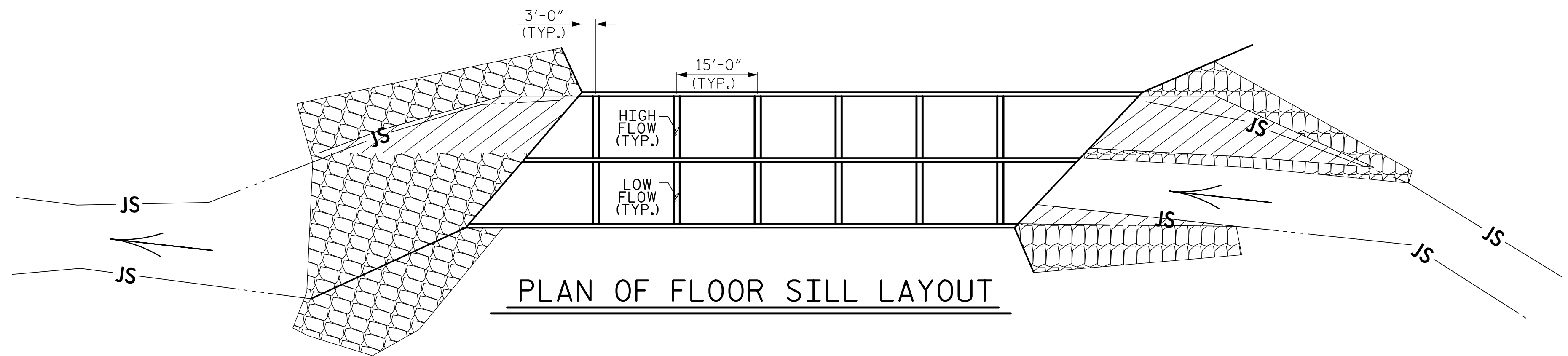
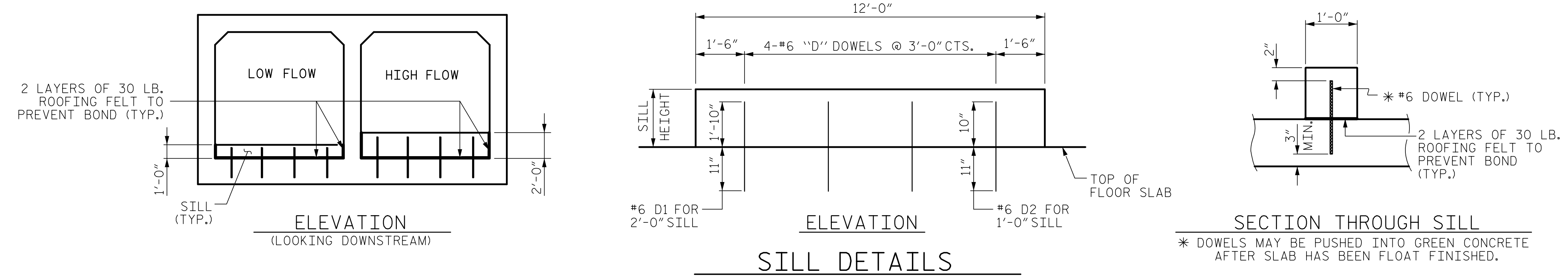

PROJECT NO. A-0009CA
GRAHAM COUNTY
 STATION: 195+16.00 -L-
 SHEET 5 OF 7

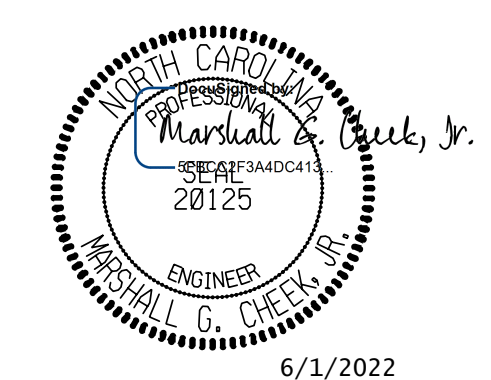

STATE OF NORTH CAROLINA
 DEPARTMENT OF TRANSPORTATION
 RALEIGH

DOUBLE 12 FT. X 8 FT.
 CONCRETE BOX CULVERT
 48° SKEW

DRAWN BY : ZCS DATE : 2/21
 CHECKED BY : MGC DATE : 6/21
 DESIGN ENGINEER OF RECORD: ZCS DATE : 11/21

DOCUMENT NOT CONSIDERED FINAL
 UNLESS ALL SIGNATURES COMPLETED

TGS ENGINEERS
 706 HILLSBOROUGH STREET
 SUITE 200
 RALEIGH, NC 27603
 PH (919) 773-8887
 CORP. LICENSE NO.: C-0275

REVISIONS						SHEET NO.
NO.	BY:	DATE:	NO.	BY:	DATE:	
1			3			C6-5
2			4			TOTAL SHEETS 7