

NOTES

NATIVE MATERIAL CONSISTS OF MATERIAL THAT IS EXCAVATED FROM THE STREAM BED OR FLOODPLAIN AT THE PROJECT SITE DURING CULVERT CONSTRUCTION. RIP-RAP MAY BE USED TO SUPPLEMENT THE NATIVE MATERIAL IN THE CULVERT BARREL. IF RIP-RAP IS USED TO LINE THE BARREL, NATIVE MATERIAL SHOULD BE PLACED ON TOP TO FILL VOIDS AND PROVIDE A FLAT SURFACE FOR ANIMAL PASSAGE. NATIVE MATERIAL IS SUBJECT TO APPROVAL BY THE ENGINEER AND MAY BE SUBJECT TO PERMIT CONDITIONS.

THE ENTIRE COST OF WORK REQUIRED TO PLACE EXCAVATED MATERIAL OR SUPPLEMENTAL MATERIAL AS SHOWN ON THE PLANS SHALL BE INCLUDED IN THE CONTRACT LUMP SUM PRICE BID FOR CULVERT EXCAVATION.

THE ENTIRE COST OF WORK REQUIRED TO CONSTRUCT THE SILLS SHALL BE INCLUDED IN THE VARIOUS PAY ITEMS.

BAR TYPE		BAR SCHEDULE				
BAR	NO.	SIZE	TYPE	LENGTH	WEIGHT	
A1	544	#4	5	4'-6"	1635	
A100	115	#5	STR	8'-1"	970	
A101	2	#5	STR	7'-2"	15	
A102	2	#5	STR	6'-2"	13	
A103	2	#5	STR	5'-2"	11	
A104	2	#5	STR	4'-2"	9	
A105	2	#5	STR	3'-2"	7	
A200	191	#4	STR	8'-1"	1031	
A201	2	#4	STR	7'-7"	10	
A202	2	#4	STR	7'-0"	9	
A203	2	#4	STR	6'-4"	8	
A204	2	#4	STR	5'-9"	8	
A205	2	#4	STR	5'-2"	7	
A206	2	#4	STR	4'-7"	6	
A207	2	#4	STR	4'-0"	5	
A208	2	#4	STR	3'-5"	5	
A209	2	#4	STR	2'-9"	4	
DIMENSIONS ARE OUT TO OUT						
SPLICE LENGTHS CHART						
BAR	SIZE	SPLICE LENGTH				
B1	#4	1'-10"				
B2	#4	1'-11"				
C1	#4	35'-8"				
D1	#6	1'-3"				
G1	#4	10'-5"				
S2	#8	10'-5"		334		
REINFORCING STEEL					9,442 LBS	

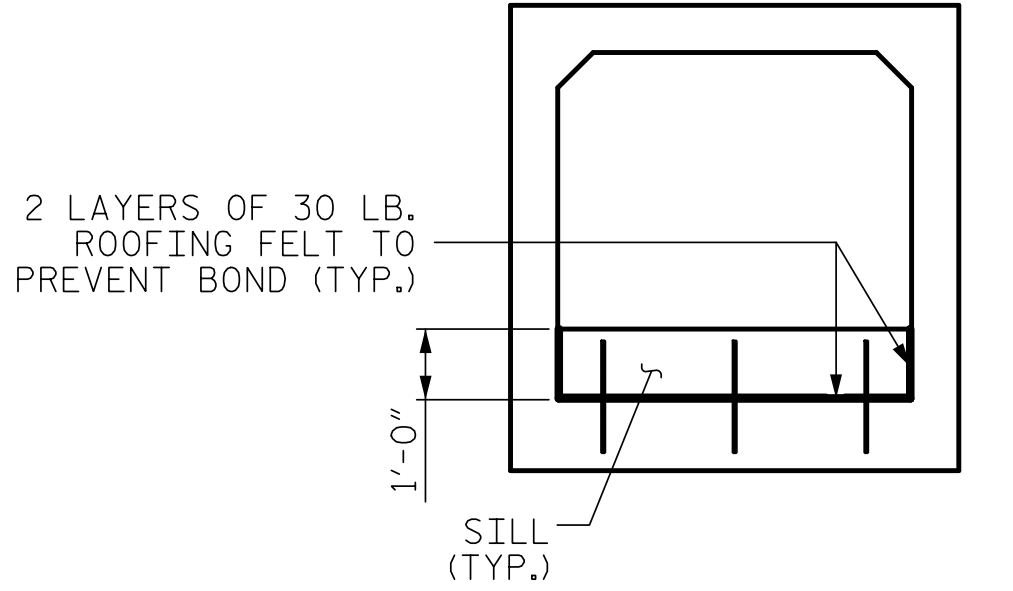
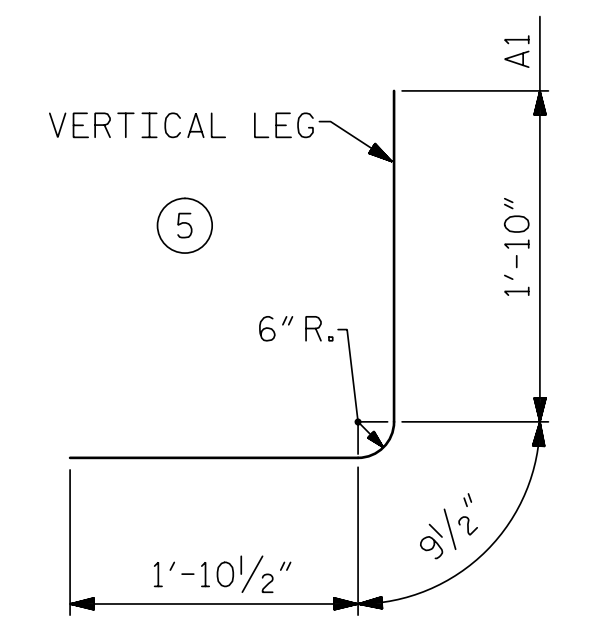

INLET ELEVATION

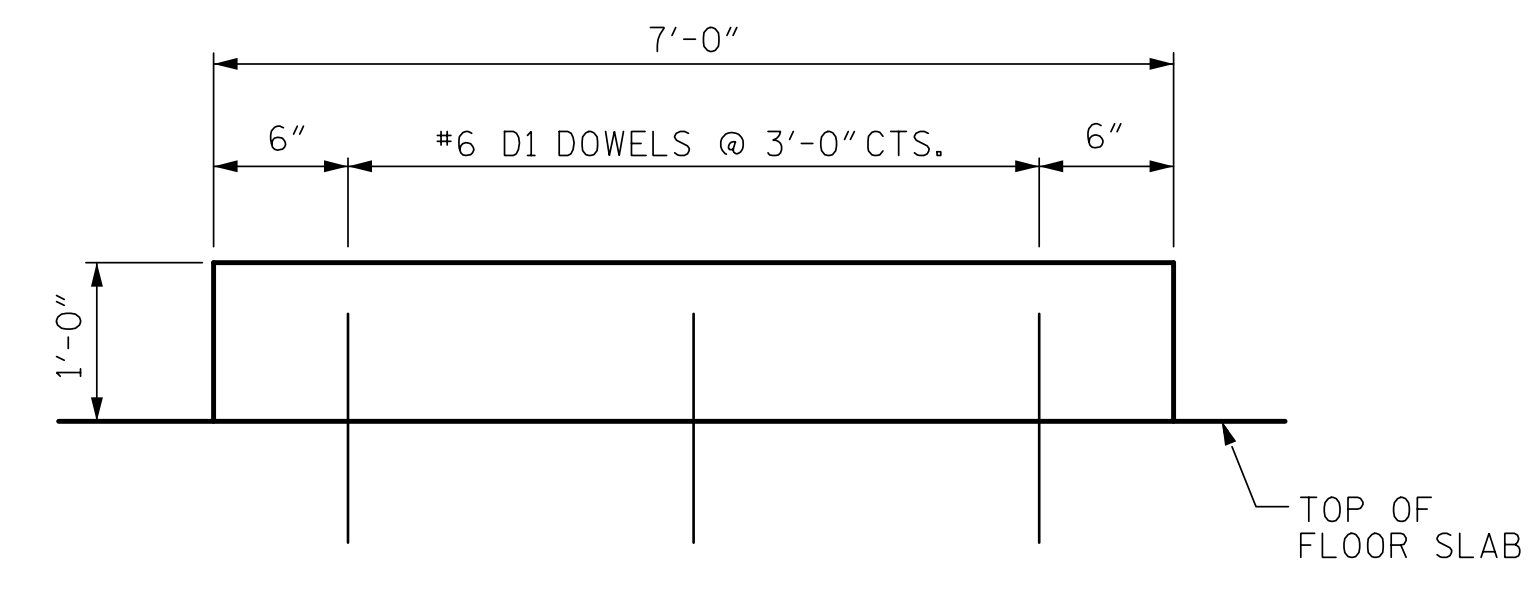

ELEVATION

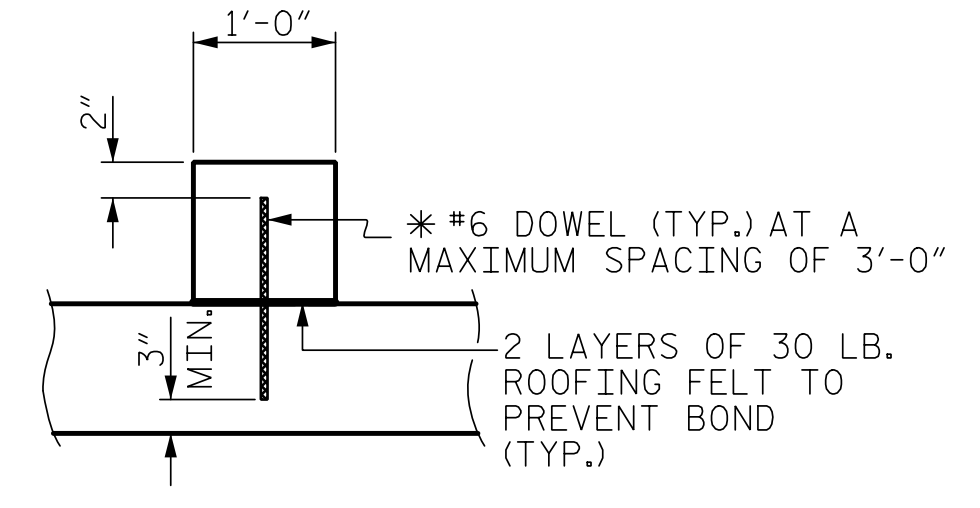

SECTION THROUGH SILL

* DOWELS MAY BE PUSHED INTO GREEN CONCRETE AFTER SLAB HAS BEEN FLOAT FINISHED.

SILL DETAILS

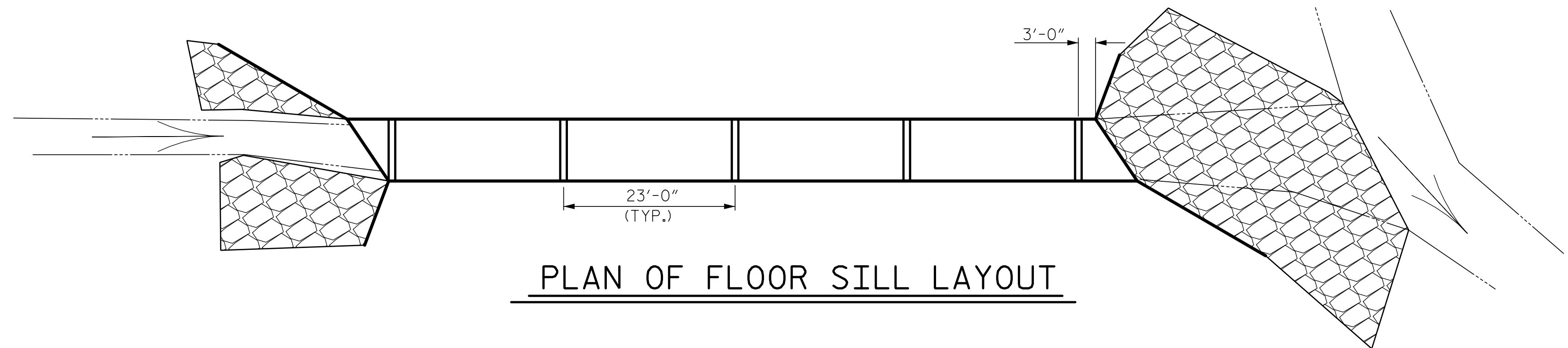

PLAN OF FLOOR SILL LAYOUT

PROJECT NO. A-0009CA
GRAHAM COUNTY
 STATION: 108+27.00 -L-

SHEET 5 OF 6



STATE OF NORTH CAROLINA
 DEPARTMENT OF TRANSPORTATION
 RALEIGH
 SINGLE 7 FT. X 8 FT.
 CONCRETE BOX CULVERT
 130° SKEW

DRAWN BY :	ZCS	DATE :	2/21
CHECKED BY :	MGC	DATE :	4/21
DESIGN ENGINEER OF RECORD:	ZCS	DATE :	4/21

DOCUMENT NOT CONSIDERED FINAL
 UNLESS ALL SIGNATURES COMPLETED

TGS ENGINEERS
 706 HILLSBOROUGH STREET
 SUITE 200
 RALEIGH, NC 27603
 PH (919) 773-8887
 CORP. LICENSE NO.: C-0275

REVISIONS						SHEET NO.
NO.	BY:	DATE:	NO.	BY:	DATE:	
1			3			C3-5
2			4			TOTAL SHEETS 6