

DIMENSIONS ARE OUT TO OUT

SPLICE LENGTHS CHART

BAR	SIZE	SPLICE LENGTH
A200	#6	3'-7"
A400	#6	2'-9"
A500	#6	2'-9"
"B"	#4	1'-11"
"C"	#4	1'-10"
"S"	#8	3'-8"

BAR SCHEDULE

BAR	NO.	SIZE	TYPE	LENGTH	WEIGHT	BAR	NO.	SIZE	TYPE	LENGTH	WEIGHT	BAR	NO.	SIZE	TYPE	LENGTH	WEIGHT	BAR	NO.	SIZE	TYPE	LENGTH	WEIGHT								
A1	92	#5		7'-1"	680	A200	25	#6	STR	30'-10"	1158	A300	25	#6	STR	38'-7"	1449	A400	25	#6	STR	30'-0"	1127	B1	92	#4	STR	11'-0"	676		
A2	216	#4	5	6'-9"	974	A201	1	#6	STR	31'-11"	48	A301	1	#6	STR	41'-0"	62	A401	1	#6	STR	31'-11"	48	B2	92	#4	STR	8'-4"	512		
A100	25	#6	STR	38'-7"	1449	A202	2	#6	STR	29'-2"	88	A302	2	#6	STR	37'-10"	114	A402	2	#6	STR	29'-2"	88	B3	124	#4	STR	11'-0"	911		
A101	1	#6	STR	41'-0"	62	A203	4	#6	STR	27'-11"	168	A303	4	#6	STR	36'-9"	221	A403	4	#6	STR	27'-11"	168	C1	32	#4	STR	18'-5"	394		
A102	2	#6	STR	37'-10"	114	A204	8	#6	STR	24'-3"	291	A304	8	#6	STR	32'-5"	390	A404	8	#6	STR	24'-3"	291	C2	34	#4	STR	23'-0"	522		
A103	4	#6	STR	36'-9"	221	A205	16	#6	STR	16'-2"	389	A305	16	#6	STR	25'-2"	605	A405	16	#6	STR	16'-2"	389	C3	30	#4	STR	27'-3"	546		
A104	8	#6	STR	32'-5"	390	A250	25	#6	STR	11'-4"	426	A306	32	#6	STR	9'-9"	469	A450	25	#6	STR	11'-4"	426	C4	24	#4	STR	8'-10"	142		
A105	16	#6	STR	25'-2"	605	A251	31	#6	STR	12'-1"	563	A451	31	#6	STR	12'-1"	563	A452	32	#6	STR	8'-7"	413	C5	50	#4	STR	13'-7"	454		
A106	32	#6	STR	9'-9"	469	A252	32	#6	STR	8'-7"	413	A453	32	#6	STR	8'-7"	413	A500	4	#6	STR	30'-2"	181	C6	52	#4	STR	18'-3"	634		
																		A501	4	#6	STR	31'-4"	188	C7	54	#4	STR	22'-10"	824		
																		A502	4	#6	STR	32'-6"	195	D1	64	#6	STR	2'-6"	240		
																		A503	4	#6	STR	33'-8"	202	D2	26	#6	STR	2'-4"	91		
																		A504	4	#6	STR	34'-10"	209	G1	4	#5	STR	38'-8"	161		
																		A550	2	#6	STR	11'-1"	33	S2	3	#8	STR	30'-11"	248		
																		A551	2	#6	STR	11'-8"	35	S3	3	#8	STR	11'-4"	91		
																		A552	2	#6	STR	12'-3"	37	S4	3	#8	STR	38'-8"	310		
																		A553	2	#6	STR	12'-10"	39								
																		A554	2	#6	STR	13'-5"	40								
																		A555	2	#6	STR	14'-0"	42								
																		A556	2	#6	STR	14'-7"	44								
																		A557	2	#6	STR	15'-2"	46								
																		A558	2	#6	STR	15'-9"	47								
																		A559	2	#6	STR	16'-4"	49								

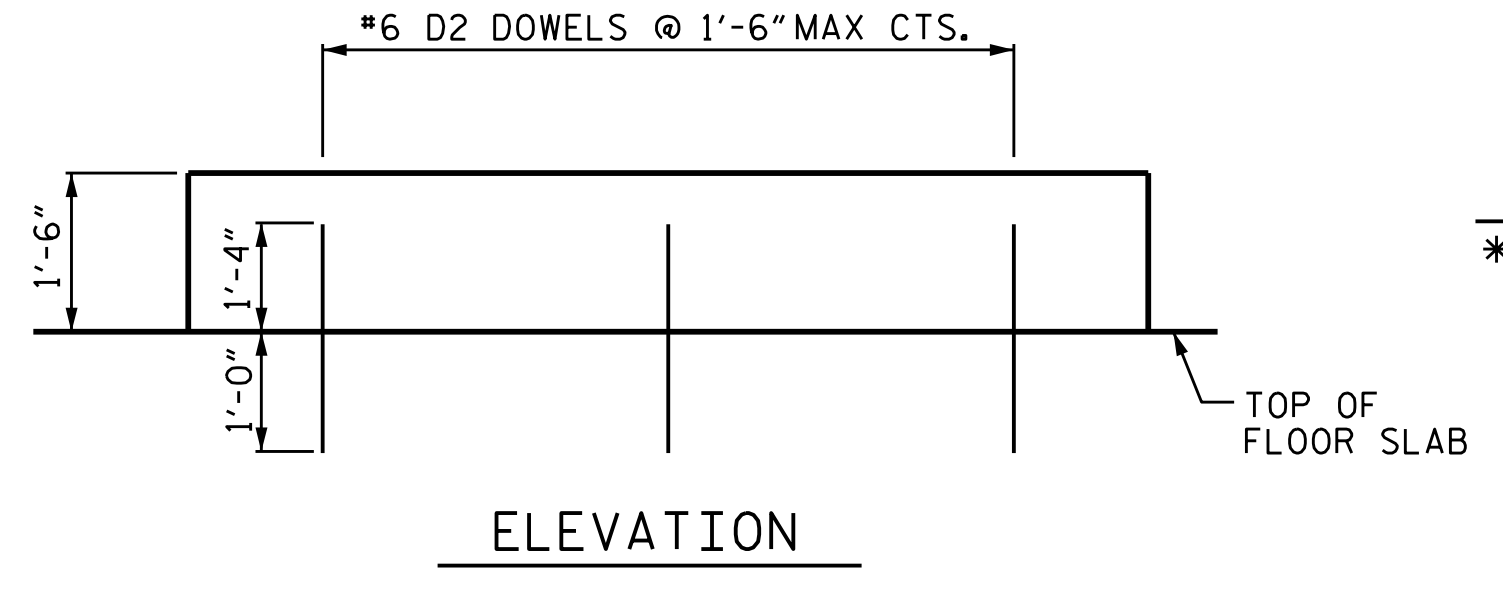
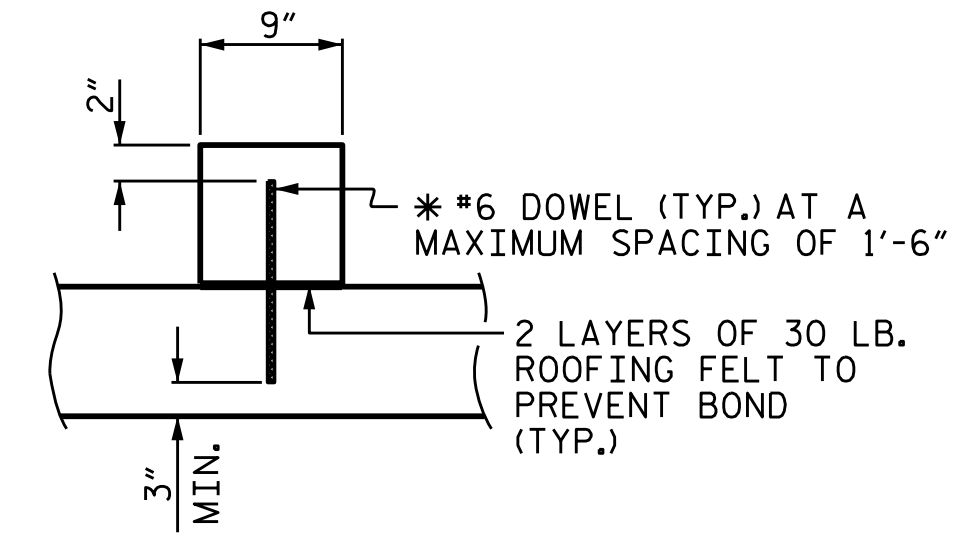

* DOWELS MAY BE PUSHED INTO GREEN CONCRETE AFTER SLAB HAS BEEN FLOAT FINISHED.

LOW FLOW SILL DETAILS

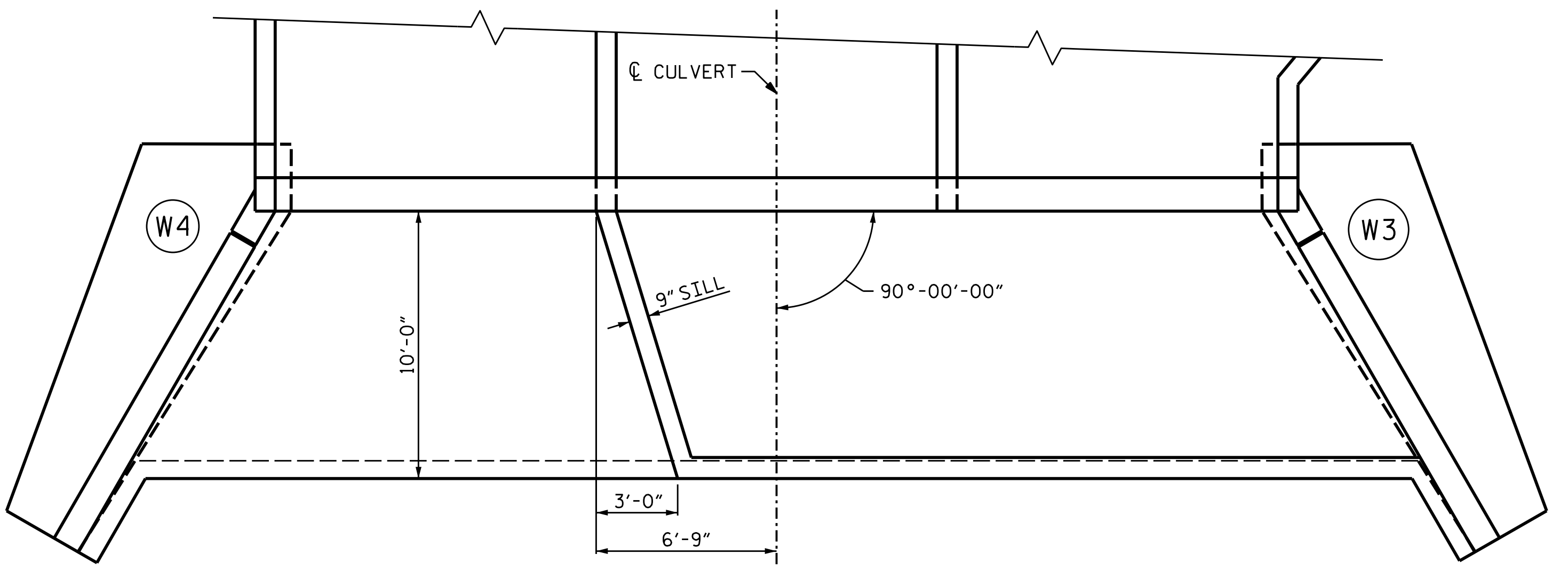

PLAN OF LOW FLOW SILL LAYOUT

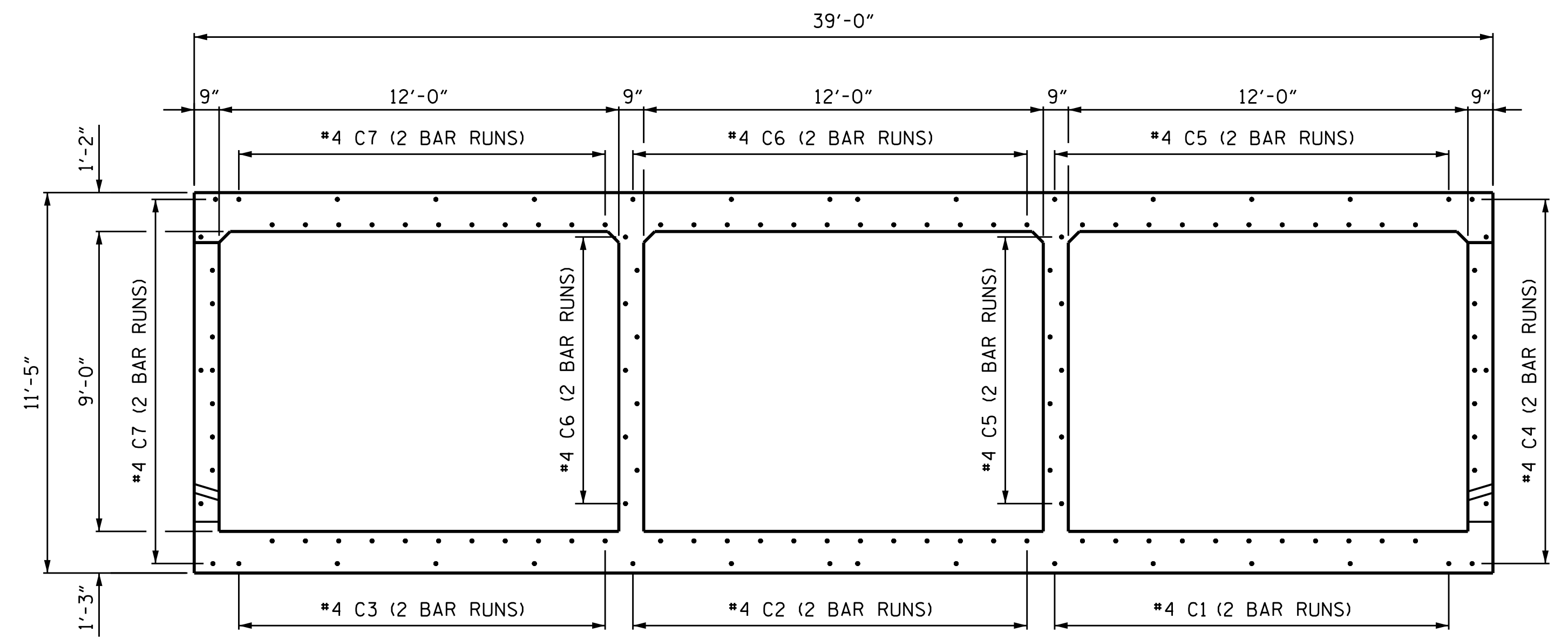

"C" BAR LAYOUT - RIGHT EXTENSION

FIELD BEND "C" AS NECESSARY

PROJECT NO. A-0009CA
GRAHAM COUNTY
 STATION: 46+41.00 -L-

SHEET 12 OF 14



STATE OF NORTH CAROLINA
 DEPARTMENT OF TRANSPORTATION
 RALEIGH
TRIPLE 12 FT. X 9 FT. CONCRETE BOX CULVERT RIGHT EXTENSION
 45°-10'-48" SKEW

DRAWN BY : STM DATE : 04/21
 CHECKED BY : MGC DATE : 02/22
 DESIGN ENGINEER OF RECORD: STM DATE : 04/21

DOCUMENT NOT CONSIDERED FINAL UNLESS ALL SIGNATURES COMPLETED
 TGS ENGINEERS
 706 HILLSBOROUGH STREET
 SUITE 200
 RALEIGH, NC 27603
 PH (919) 773-8887
 CORP. LICENSE NO.: C-0275

REVISIONS						SHEET NO.
NO.	BY:	DATE:	NO.	BY:	DATE:	C2-12
1			3			TOTAL SHEETS
2			4			14