

BAR SCHEDULE

BAR	NO.	SIZE	TYPE	LENGTH	WEIGHT	BAR	NO.	SIZE	TYPE	LENGTH	WEIGHT	BAR	NO.	SIZE	TYPE	LENGTH	WEIGHT	BAR	NO.	SIZE	TYPE	LENGTH	WEIGHT	BAR	NO.	SIZE	TYPE	LENGTH	WEIGHT
A1	58	#5	5	7'-1"	428	A200	17	#6	STR	19'-0"	485	A300	29	#6	STR	19'-0"	828	A400	17	#6	STR	19'-0"	485	B1	58	#4	STR	11'-0"	426
A2	136	#4	5	6'-9"	613																			B2	58	#4	STR	8'-4"	323
						A201	2	#6	STR	17'-11"	54	A301	4	#6	STR	17'-11"	108	A401	2	#6	STR	17'-11"	54	B3	78	#4	STR	11'-0"	573
A100	29	#6	STR	19'-0"	828	A202	2	#6	STR	16'-6"	50	A302	4	#6	STR	16'-6"	99	A402	2	#6	STR	16'-6"	50						
						A203	2	#6	STR	15'-2"	46	A303	4	#6	STR	15'-2"	91	A403	2	#6	STR	15'-2"	46	C1	138	#4	STR	19'-2"	1767
A101	4	#6	STR	17'-11"	108	A204	2	#6	STR	13'-10"	42	A304	4	#6	STR	13'-10"	83	A404	2	#6	STR	13'-10"	42						
A102	4	#6	STR	16'-6"	99	A205	2	#6	STR	12'-6"	38	A305	4	#6	STR	12'-6"	75	A405	2	#6	STR	12'-6"	38	D1	64	#6	STR	2'-6"	240
A103	4	#6	STR	15'-2"	91	A206	2	#6	STR	11'-2"	34	A306	4	#6	STR	11'-2"	67	A406	2	#6	STR	11'-2"	34						
A104	4	#6	STR	13'-10"	83	A207	2	#6	STR	9'-10"	30	A307	4	#6	STR	9'-10"	59	A407	2	#6	STR	9'-10"	30	G1	4	#5	STR	54'-6"	227
A105	4	#6	STR	12'-6"	75	A208	2	#6	STR	8'-6"	26	A308	4	#6	STR	8'-6"	51	A408	2	#6	STR	8'-6"	26						
A106	4	#6	STR	11'-2"	67	A209	2	#6	STR	7'-2"	22	A309	4	#6	STR	7'-2"	43	A409	2	#6	STR	7'-2"	22	S2	3	#8	STR	42'-3"	338
A107	4	#6	STR	9'-10"	59	A210	2	#6	STR	5'-10"	18	A310	4	#6	STR	5'-10"	35	A410	2	#6	STR	5'-10"	18	S3	3	#8	STR	16'-0"	128
A108	4	#6	STR	8'-6"	51	A211	2	#6	STR	4'-6"	14	A311	4	#6	STR	4'-6"	27	A411	2	#6	STR	4'-6"	14	S4	6	#6	STR	42'-5"	382
A109	4	#6	STR	7'-2"	43	A212	2	#6	STR	3'-2"	10	A312	4	#6	STR	3'-2"	19	A412	2	#6	STR	3'-2"	10	S5	6	#6	STR	16'-0"	144
A110	4	#6	STR	5'-10"	35	A213	2	#6	STR	17'-8"	53							A413	2	#6	STR	17'-8"	53	S6	3	#8	STR	54'-6"	437
A111	4	#6	STR	4'-6"	27	A214	2	#6	STR	16'-4"	49							A414	2	#6	STR	16'-4"	49	S7	6	#6	STR	54'-6"	491
A112	4	#6	STR	3'-2"	19	A215	2	#6	STR	15'-0"	45							A415	2	#6	STR	15'-0"	45						
						A216	2	#6	STR	13'-8"	41							A416	2	#6	STR	13'-8"	41						
						A217	2	#6	STR	12'-4"	37							A417	2	#6	STR	12'-4"	37						
						A218	2	#6	STR	11'-0"	33							A418	2	#6	STR	11'-0"	33						
						A219	2	#6	STR	9'-7"	29							A419	2	#6	STR	9'-7"	29						
						A220	2	#6	STR	8'-3"	25							A420	2	#6	STR	8'-3"	25						
						A221	2	#6	STR	6'-11"	21							A421	2	#6	STR	6'-11"	21						
						A222	2	#6	STR	5'-7"	17							A422	2	#6	STR	5'-7"	17						
						A223	2	#6	STR	4'-3"	13							A423	2	#6	STR	4'-3"	13						
						A250	12	#6	STR	11'-5"	206							A450	12	#6	STR	11'-5"	206						
						A251	4	#6	STR	10'-1"	61							A451	4	#6	STR	10'-1"	61						
						A252	4	#6	STR	8'-9"	53							A452	4	#6	STR	8'-9"	53						
						A253	4	#6	STR	7'-5"	45							A453	4	#6	STR	7'-5"	45						
						A254	4	#6	STR	6'-1"	37							A454	4	#6	STR	6'-1"	37						
						A255	4	#6	STR	4'-9"	29							A455	4	#6	STR	4'-9"	29						
						A256	4	#6	STR	3'-5"	21							A456	4	#6	STR	3'-5"	21						

REINFORCING STEEL 13,055 LBS

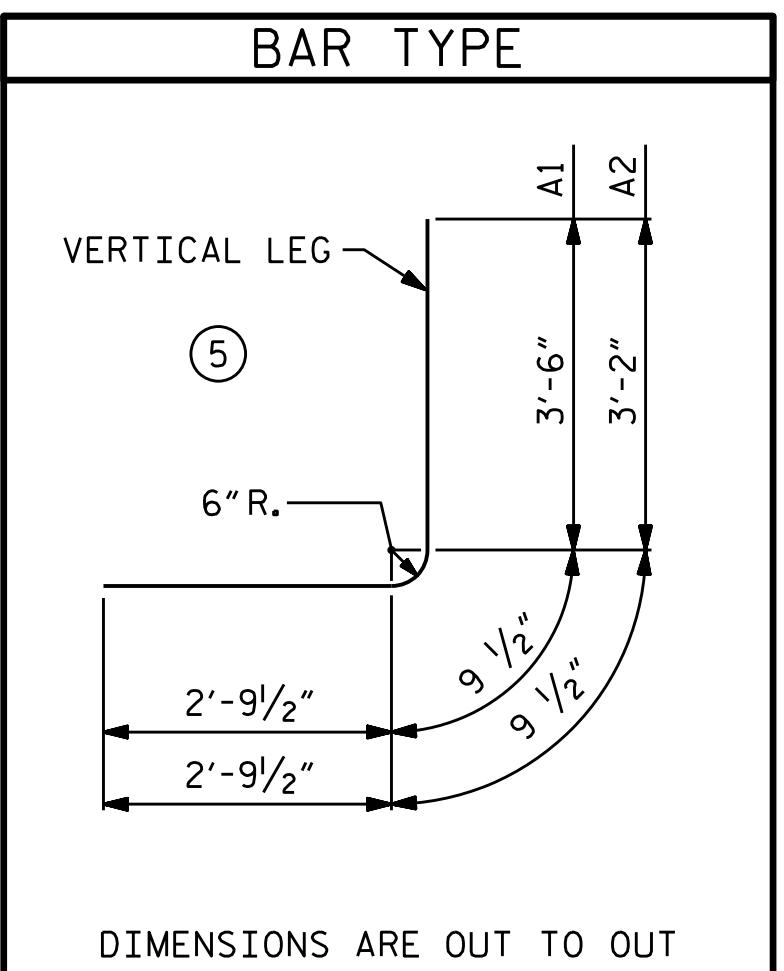

SPLICE LENGTH CHART		
BAR	SIZE	SPLICE LENGTH
A200	#6	2'-9"
A400	#6	3'-7"
"B"	#4	1'-10"
C1	#4	1'-10"
"S"	#6	3'-8"
"S"	#8	3'-8"

LEFT EXTENSION QUANTITIES	
CLASS A CONCRETE	
BARREL @ 4.50 CY/FT	87.8 C.Y.
WINGS, ETC.	26.4 C.Y.
EDGE BEAMS	4.1 C.Y.
TOTAL	118.3 C.Y.
REINFORCING STEEL	
BARREL	13,055 LBS.
WINGS, ETC.	2,440 LBS.
TOTAL	15,495 LBS.
CULVERT EXCAVATION	LUMP SUM
FOUNDATION COND. MAT'L.	59 TONS

PROJECT NO. A-0009CA
GRAHAM COUNTY
 STATION: 46+41.00 -L-

SHEET 6 OF 14

6/1/2022

DOCUMENT NOT CONSIDERED FINAL UNLESS ALL SIGNATURES COMPLETED

TGS ENGINEERS
706 HILLSBOROUGH STREET
SUITE 200
RALEIGH, NC 27603
PH (919) 773-8887
CORP. LICENSE NO.: C-0275

STATE OF NORTH CAROLINA
DEPARTMENT OF TRANSPORTATION
RALEIGH

TRIPLE 12 FT. X 9 FT.
CONCRETE BOX CULVERT
LEFT EXTENSION
45°-10'-48" SKEW

REVISIONS						SHEET NO.
NO.	BY:	DATE:	NO.	BY:	DATE:	
1			3			C2-6
2			4			TOTAL SHEETS 14

DRAWN BY : STM DATE : 04/21
 CHECKED BY : MGC DATE : 02/22
 DESIGN ENGINEER OF RECORD: STM DATE : 04/21