

SECTION B-B

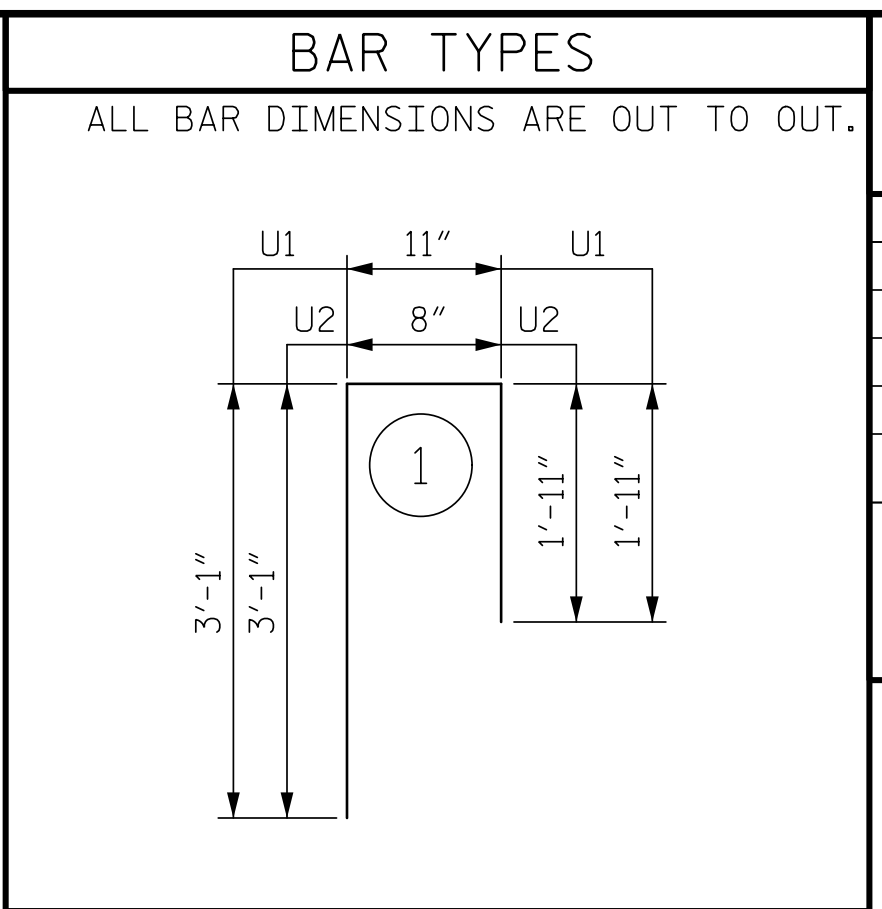

BILL OF MATERIAL FOR EXISTING INLET HEADWALL EXTENSION

BAR	NO.	SIZE	TYPE	LENGTH	WEIGHT
H1	12	#4	STR	28'-4"	227
U1	55	#4	1	5'-11"	217
REINFORCING STEEL				444 LBS	
CLASS A CONCRETE HEADWALL EXTENSION				5.7 CY	
TOTAL				5.7 CY	

BILL OF MATERIAL FOR EXISTING WING W1 EXTENSION

BAR	NO.	SIZE	TYPE	LENGTH	WEIGHT
H2	6	#4	STR	21'-5"	86
U2	21	#4	1	5'-8"	79
REINFORCING STEEL				165 LBS	
CLASS A CONCRETE WING EXTENSION				1.8 CY	
TOTAL				1.8 CY	

BILL OF MATERIAL FOR EXISTING WING W2 EXTENSION

BAR	NO.	SIZE	TYPE	LENGTH	WEIGHT
H3	6	#4	STR	16'-8"	67
U2	16	#4	1	5'-8"	61
REINFORCING STEEL				128 LBS	
CLASS A CONCRETE WING EXTENSION				1.3 CY	
TOTAL				1.3 CY	

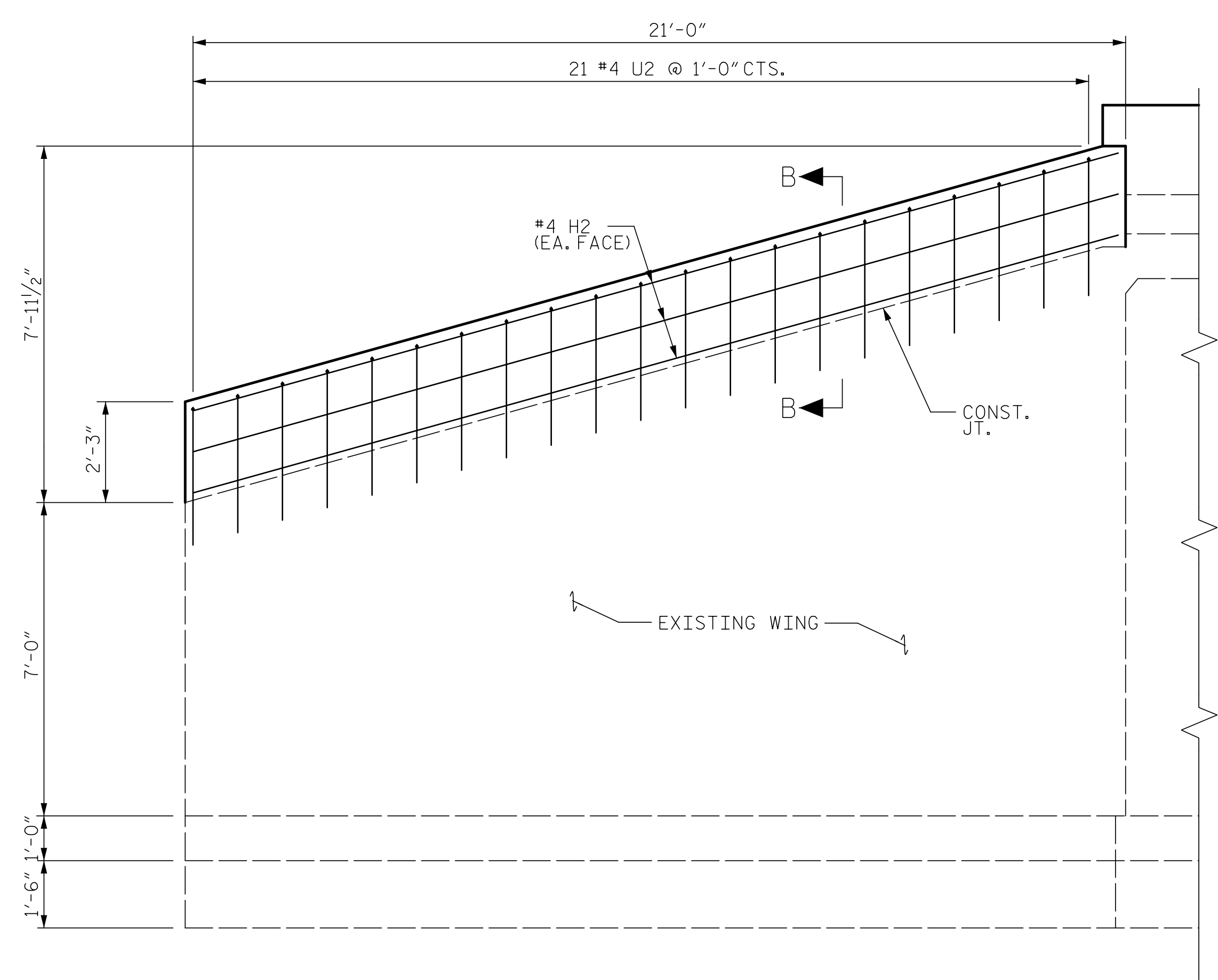

ELEVATION W1

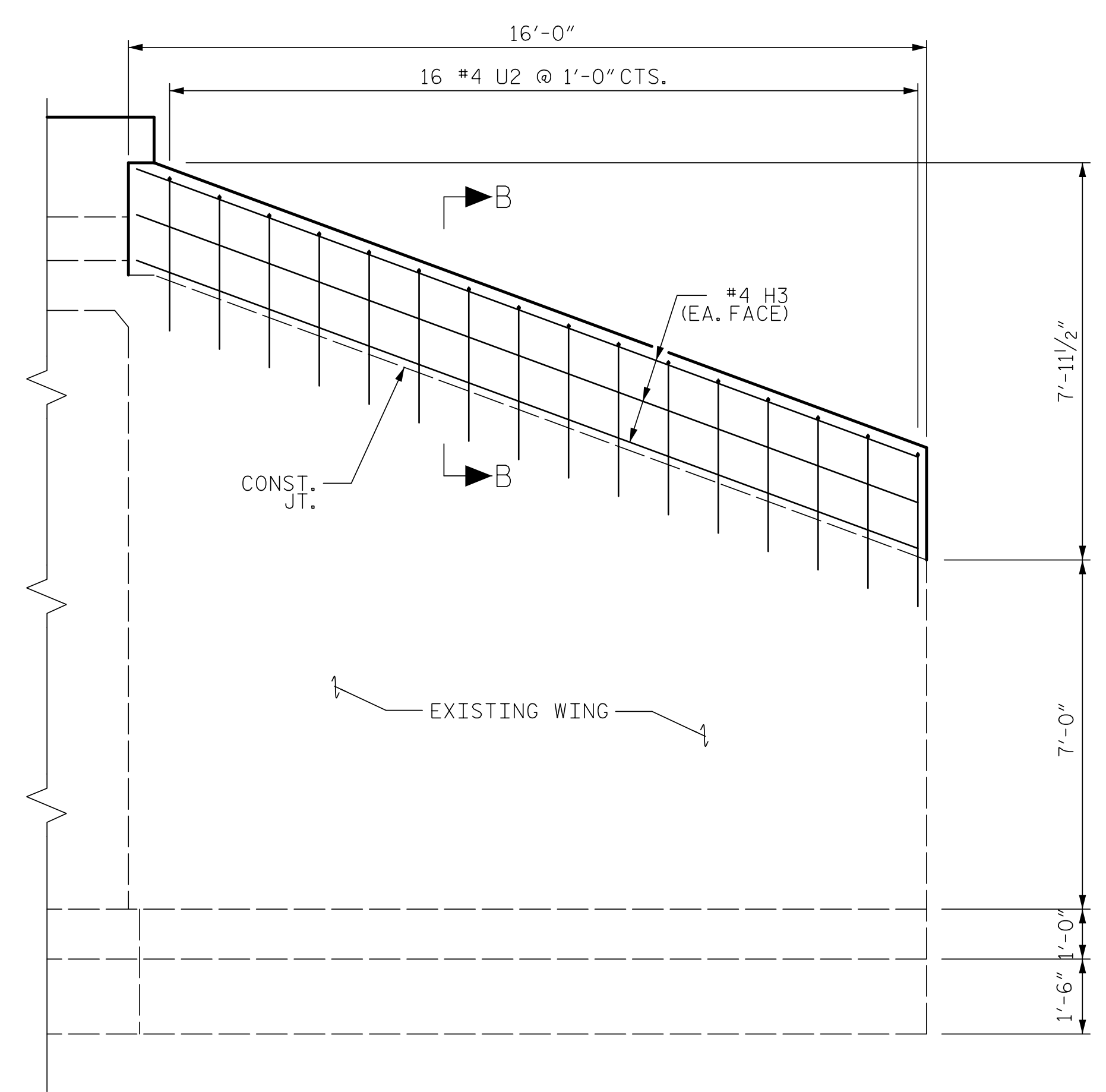

ELEVATION W2

PROJECT NO. A-0009CA
 GRAHAM COUNTY
 STATION: 17+34.70 -L-

SHEET 3 OF 5

6/1/2022

DOCUMENT NOT CONSIDERED FINAL UNLESS ALL SIGNATURES COMPLETED

TGS ENGINEERS
 804-C N. LAFAYETTE ST
 SHELBY, NC 28150
 PH (704) 476-0003
 CORP. LICENSE NO.: C-0275

STATE OF NORTH CAROLINA
 DEPARTMENT OF TRANSPORTATION
 RALEIGH

INLET END
 WING EXTENSIONS
 WINGS 1 & 2

REVISIONS						SHEET NO.
NO.	BY:	DATE:	NO.	BY:	DATE:	C1-3
1			3			TOTAL SHEETS
2			4			5

DRAWN BY : ZCS DATE : 1/21
 CHECKED BY : MGC DATE : 4/22
 DESIGN ENGINEER OF RECORD : ZCS DATE : 4/22