

PROJECT REFERENCE NO.	SHEET NO.
A-0009CA	EC-14A/CONST.14
RW SHEET NO.	
ROADWAY DESIGN ENGINEER	HYDRAULICS ENGINEER

PIPE CONSTRUCTION SEQUENCE STA. 134+82 -L-

1. INSTALL IMPERVIOUS DIKES #1 & #2, MAINTAINING FLOW THROUGH EXISTING 30" CMP.
2. DEWATER WORK SITE AS NEEDED INTO SPECIAL STILLING BASIN(S).
3. INSTALL 66" WELDED STEEL PIPE USING TRENCHLESS INSTALLATION.
4. REMOVE IMPERVIOUS DIKES #1 & #2.

5. INSTALL IMPERVIOUS DIKES #3 & #4, SHIFTING FLOW INTO NEW 66" PIPE.
6. PLUG AND FILL EXISTING 30" CMP.
7. REMOVE IMPERVIOUS DIKES #3 & #4.
8. COMPLETE ANY NECESSARY INLET/OUTLET CHANNEL IMPROVEMENTS AND REESTABLISH STREAM ACCORDING TO CONST. PLANS.

PHASE 1

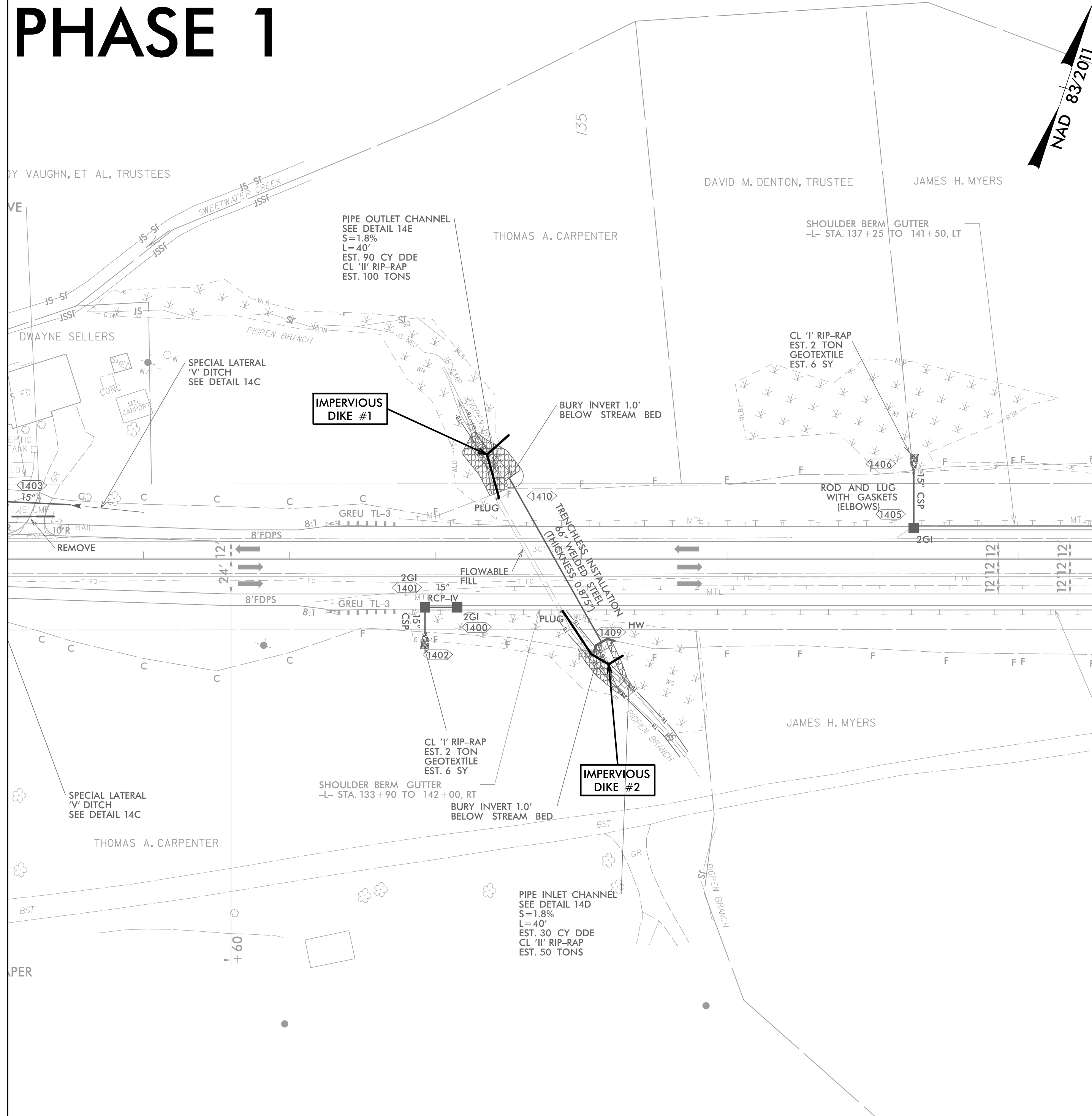

PHASE 2

