

PHASE 1, STEP 1.A

SEE ROADWAY DETAIL SHT 2B-2 FOR DETOUR LAYOUT.
SEE EROSION CONTROL PLANS FOR CULVERT CONSTRUCTION SEQUENCE

PHASE 1, STEP 1.B

| | |
|---------------------|-----------|
| PROJ. REFERENCE NO. | SHEET NO. |
| A-0009CA | TMP-7 |

TGS ENGINEERS
201 W. MARION ST. STE 200
SHELBY, NC 28150
PH (704) 476-0003
CORP. LICENSE NO.: C-0275

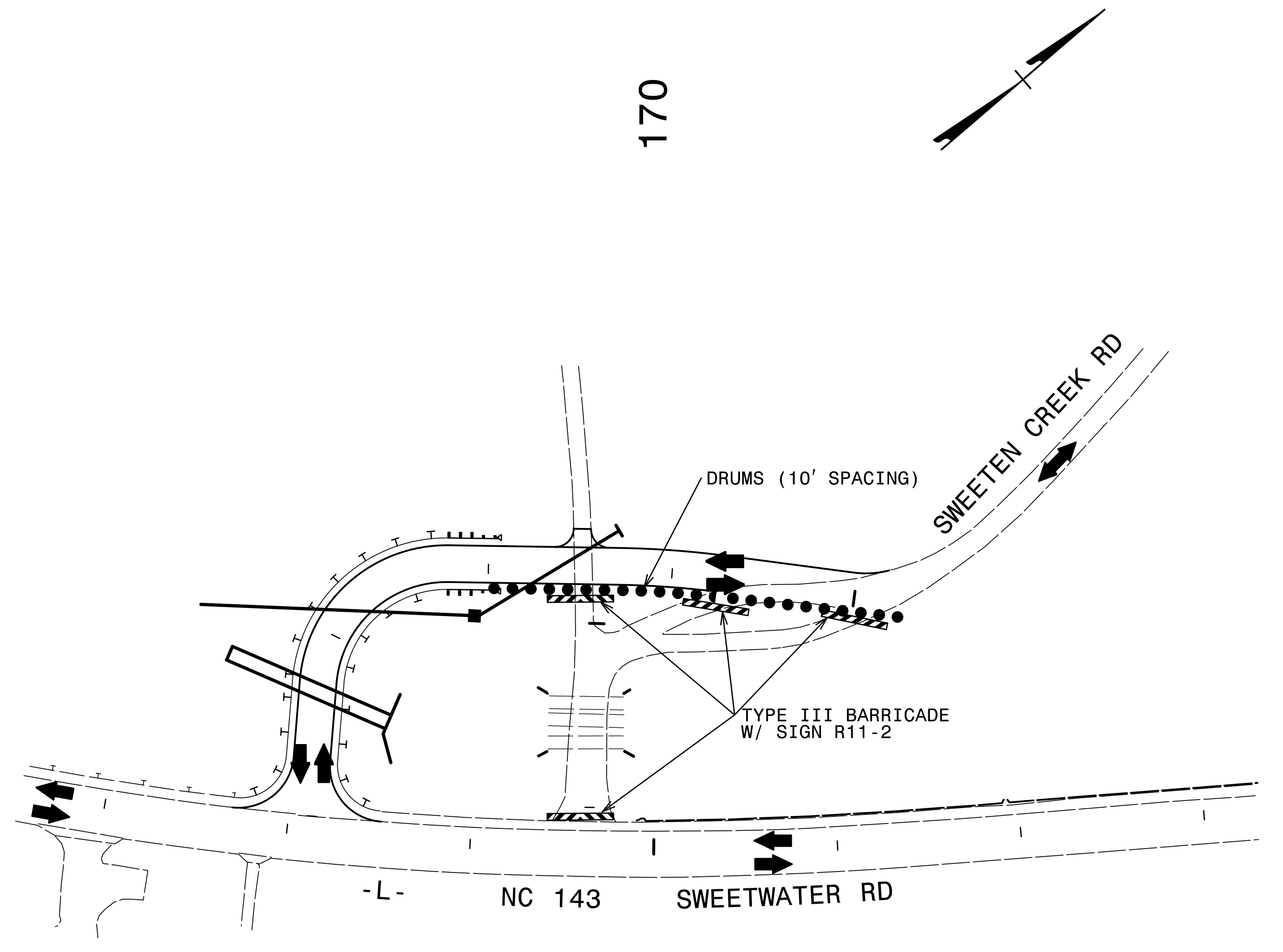
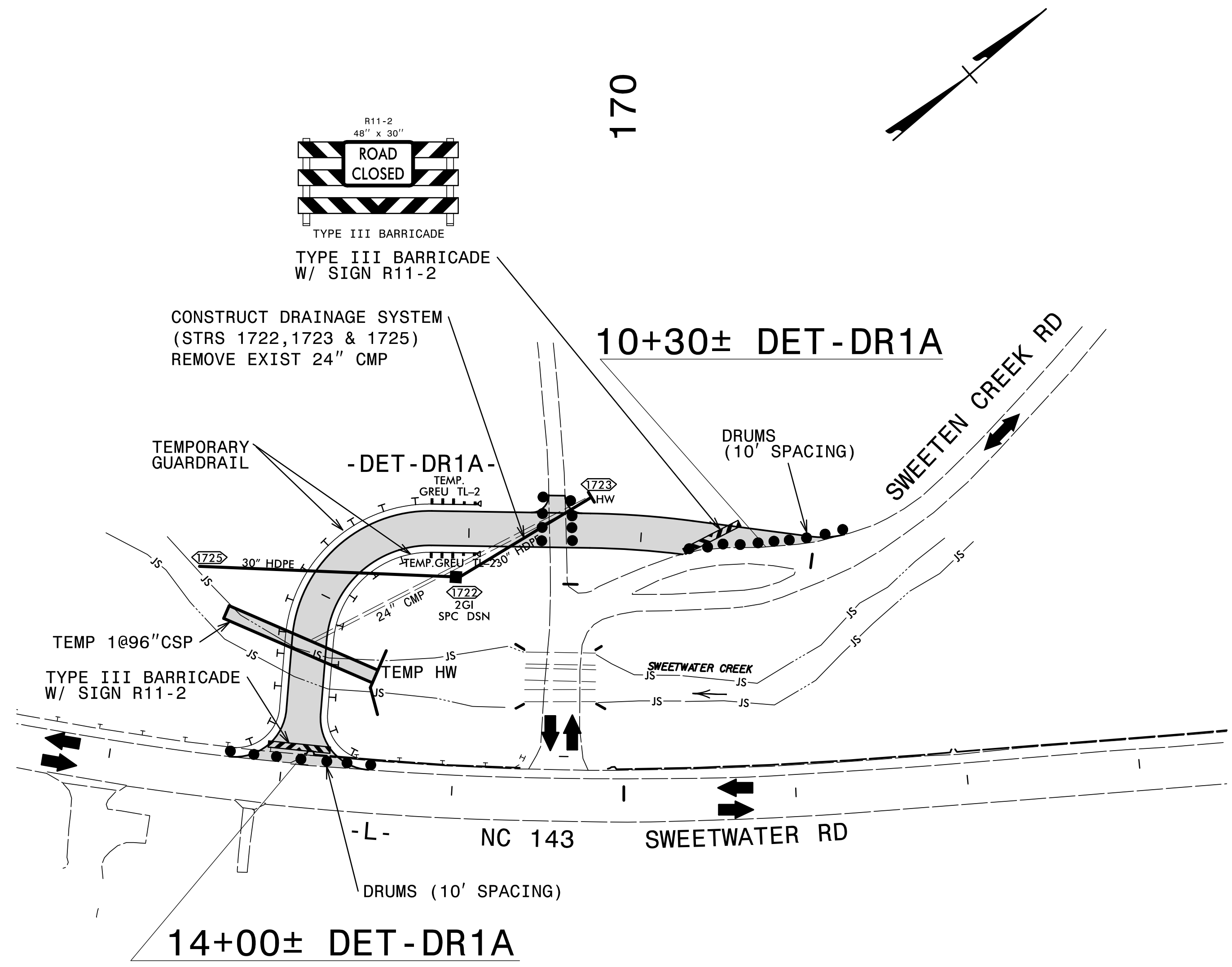

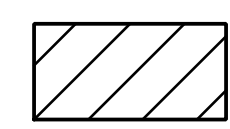
-  PROPOSED CONSTRUCTION
-  WEDGING EXISTING PAVEMENT

APPROVED: *Jimmy Terry*

DATE: 5/31/2022

SEAL

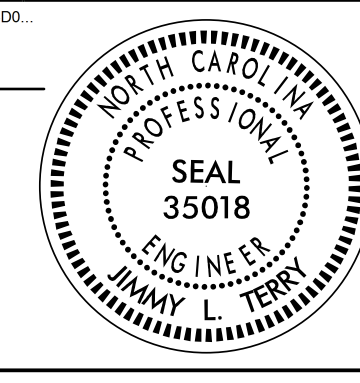

DOCUMENT NOT CONSIDERED FINAL
UNLESS ALL SIGNATURES COMPLETED

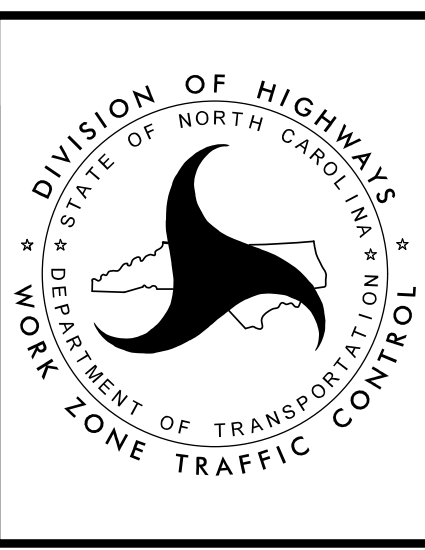

PHASE I
NC 143

ON-SITE DETOUR DET-DR1A

5/16/2022
 S:\NC\09CA_0009\Traffic\TrafficControl\TCP\A-0009CA\A-0009CA_TC_TMP_07(PHL-S).dgn
 User: jsmelin