

6/2/19

I6-AUG-2021 10:02  
V:\NC\Survey\02112-21A-0009CA ROW Staking\Survey\RW and Control Sheets\A-0009CA\A0009CA\_1s-RW02C-10.dgn  
JKS-1503PY-37  
Jegordon

REVISIONS

# SURVEY CONTROL SHEET

## W/ EXISTING CENTERLINE ALIGNMENTS PRIOR TO CONSTRUCTION

I, Mark A. Parris, PLS, certify that the Project Control was verified under my supervision from an actual GPS survey made under my supervision and the following information was used to perform the survey:

Class of survey: AA  
Type of GPS field procedure: Static, OPUS, RTN  
Dates of survey: 2/2020-3/2020  
Datum/Epoch: 2010.0000  
Published/Fixed-control use: N/A  
Localized around: A0009C-10  
Northing: 612531.117  
Easting: 584817.003  
Combined grid factor: 0.999772236  
Geoid model: 18 CONUS  
Units: English

I also certify that the Baseline Control for this project was completed under my direct and responsible charge from an actual survey made under my supervision; that all horizontal closures had a minimum ratio of precision of 1:20,000 (Class AA) and Vertical accuracy to Class A. Field work was performed from 3/2020 to 5/2020, and all coordinates are based on NAD 83/2011 and all elevations are based on NAVD 88; that this survey was performed to meet the requirements of 21NCAC 56.1600 as applicable.

This 21st day of December, 2020.

DocuSigned by:  
  
F1570C85C7248A  
Professional Land Surveyor L-4529

PROJECT REFERENCE NO.

A-0009CA

SHEET NO.

RW02C-10

Location and Surveys



PROJECT SURVEYOR

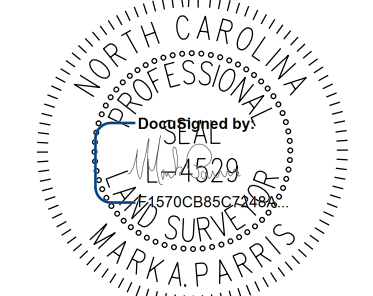

DOCUMENT NOT CONSIDERED FINAL UNLESS ALL SIGNATURES COMPLETED

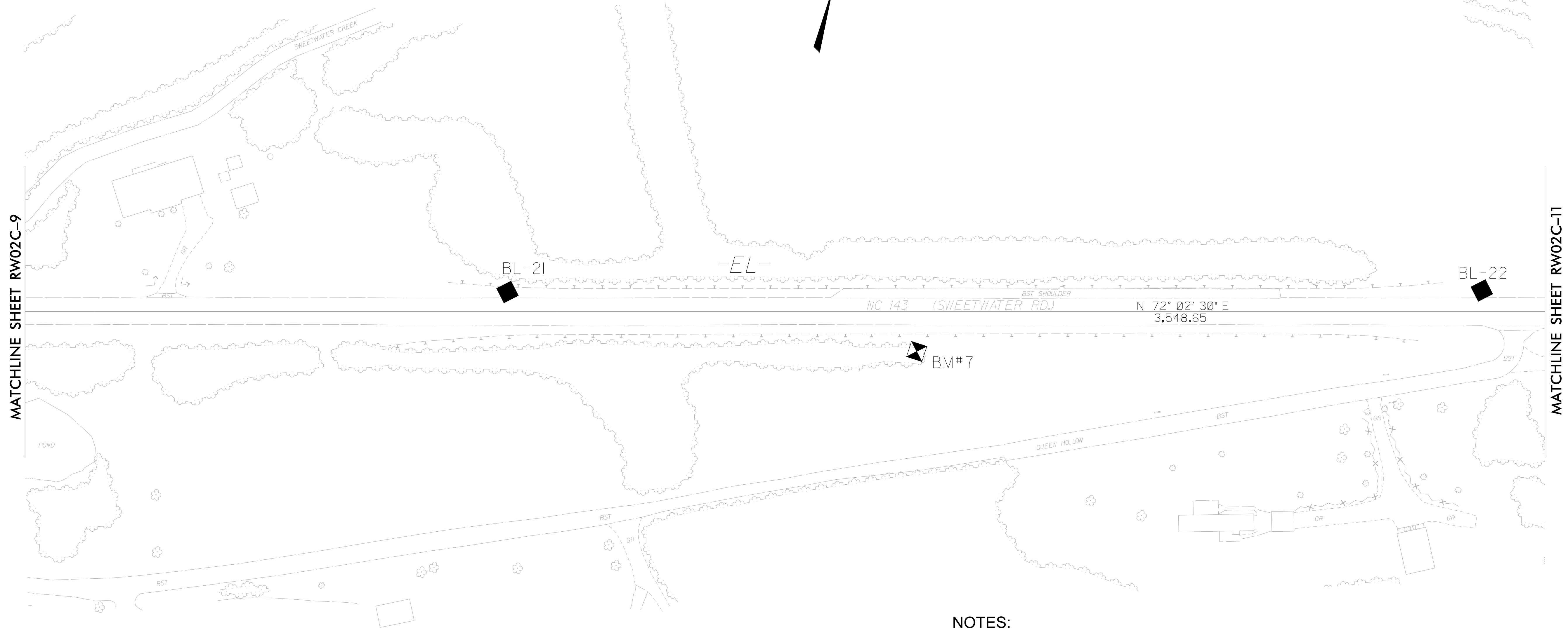

MATCHLINE SHEET RW02C-9

MATCHLINE SHEET RW02C-11

**SEE SHEETS RW02C-56 THRU RW02C-65  
FOR FURTHER  
ALIGNMENT DETAILS**

### NOTES:

1. PROJECT CONTROL WAS ESTABLISHED USING GNSS, THE GLOBAL NAVIGATION SATELLITE SYSTEM.
2. THE SURVEY CONTROL DATA FOR THIS PROJECT HAS BEEN COMPILED FROM VARIOUS SOURCES. IF FURTHER INFORMATION REGARDING PROJECT CONTROL IS NEEDED, PLEASE CONTACT THE LOCATION AND SURVEYS UNIT.