

8/17/99

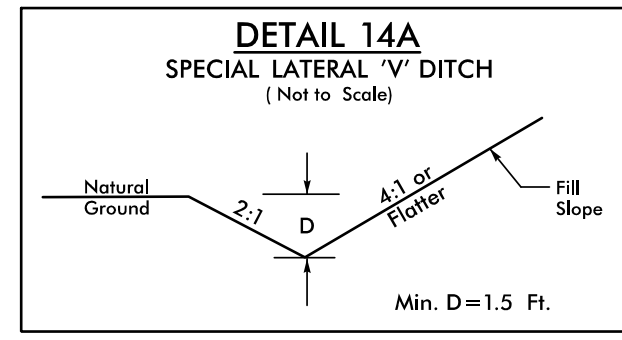

FROM STA.127+00 TO STA.127+25-LT.
FROM STA.127+80 TO STA.128+00-LT.

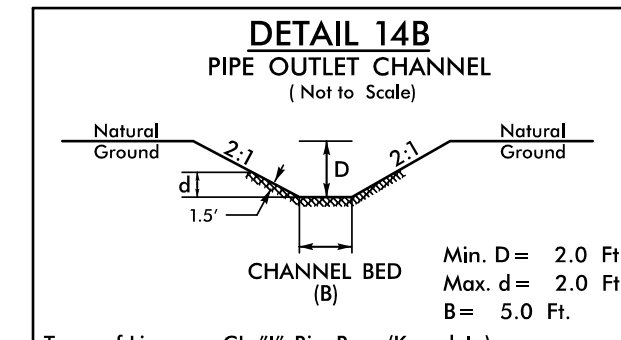

Min. D = 2.0 Ft.
Max. d = 2.0 Ft.
B = 5.0 Ft.
STA. 129+13-LT.

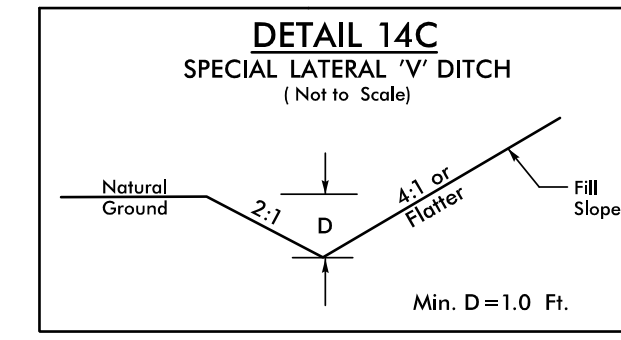

FROM STA.129+50 TO STA.130+70-LT.
FROM STA.131+50 TO STA.132+00-LT.
FROM STA.130+00 TO STA.131+00-LT.

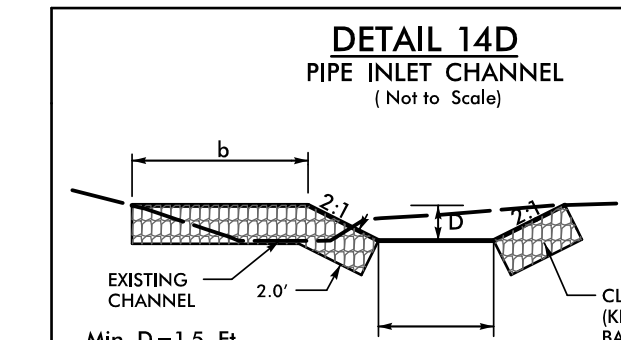

Min. D = 1.5 Ft.
B = 6.0 Ft.
b = Var.
STA.135+20-RT.

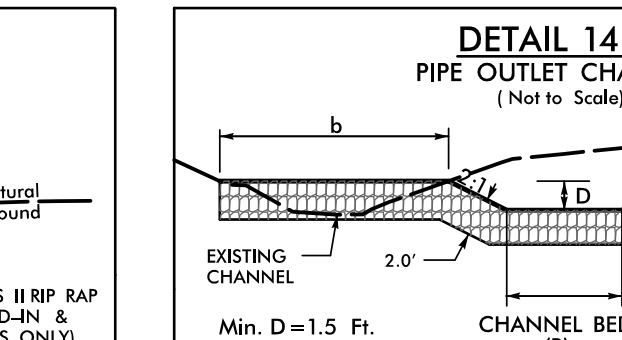

Min. D = 1.5 Ft.
B = 6.0 Ft.
b = Var.
STA.134+40-LT.

NOTE: ALL DRIVEWAYS ARE TO BE ASPHALT UNLESS OTHERWISE NOTED. END LOCATION OF DRIVEWAY SHOWN ON PLANS REPRESENTS TIE-IN PER CROSS-SECTIONS, THE CONTRACTOR SHALL EXTEND THE DRIVES AND PAVE UP TO THE RIGHT OF WAY LINE. FROM ROW POINT ON MATCH DRIVEWAY IN KIND, UNLESS OTHERWISE NOTED.



PROJECT REFERENCE NO. A-0009CA		SHEET NO. 14	
ROADWAY DESIGN ENGINEER		HYDRAULICS ENGINEER	
DOCUMENT NOT CONSIDERED FINAL UNLESS ALL SIGNATURES COMPLETED			
 TGS ENGINEERS 201 W. MARION ST SHELBY, NC 28150 PH (704) 476-0003 CORP. LICENSE NO.: C-0275			

REVISIONS

MATCH LINE STA -L- 124+00.00
MATCH TO SHEET NO. 13

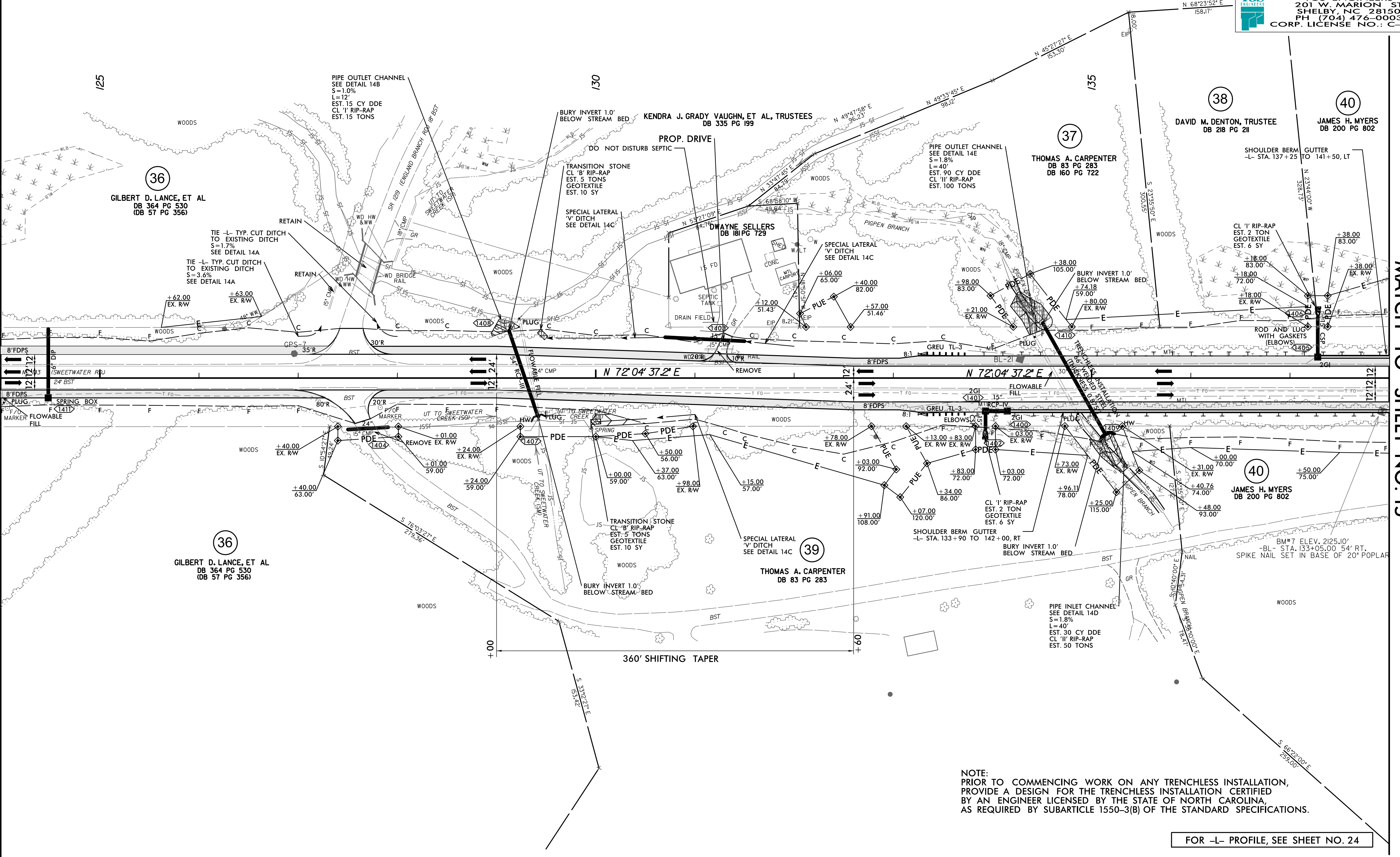

MATCH LINE STA -L- 138+00.00
MATCH TO SHEET NO. 15

NOTE: PRIOR TO COMMENCING WORK ON ANY TRENCHLESS INSTALLATION, PROVIDE A DESIGN FOR THE TRENCHLESS INSTALLATION CERTIFIED BY AN ENGINEER LICENSED BY THE STATE OF NORTH CAROLINA, AS REQUIRED BY SUBARTICLE 1550-3(B) OF THE STANDARD SPECIFICATIONS.

FOR -L- PROFILE, SEE SHEET NO. 24

5/20/2022
K:\2009\A-0009\Roadway\Proj\A-0009CA_Plan
Sheets\A-0009CA_Rdy_psh_14.dgn
1/1/2009