

8/17/99

**-L- CURVE DATA**  
 PI Sta 78+21.5/  
 $\Delta = 38^{\circ}02'00.5"$  (RT)  
 $D = 4^{\circ}46'28.7"$   
 $L = 796.57'$   
 $T = 413.59'$   
 $R = 1,200.00'$   
 $SE = 0.08$   
 $DS = 60$  MPH

**-L- CURVE DATA**  
 PI Sta 98+90.1/  
 $\Delta = 65^{\circ}35'01.6"$  (LT)  
 $D = 5^{\circ}58'05.9"$   
 $L = 1,098.87'$   
 $T = 618.49'$   
 $R = 960.00'$   
 $SE = 0.08$   
 $DS = 55$  MPH

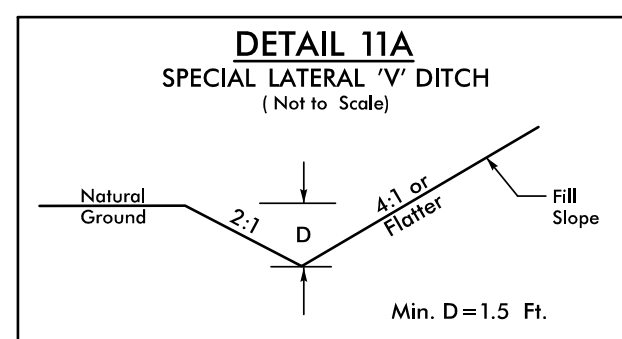

FROM STA.87+00 TO STA.87+50-L- LT.  
 FROM STA.88+62 TO STA.89+50-L- LT.

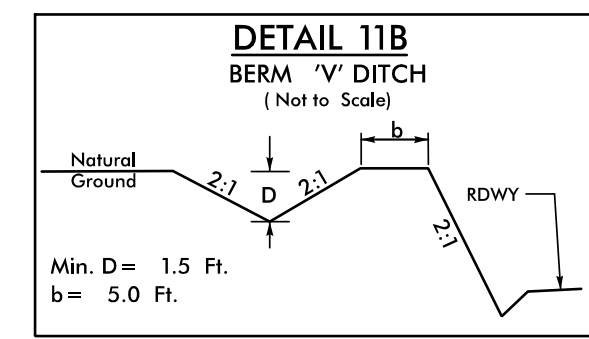

FROM STA.91+95 TO STA.92+50-L- LT.  
 FROM STA.93+85 TO STA.96+00-L- LT.

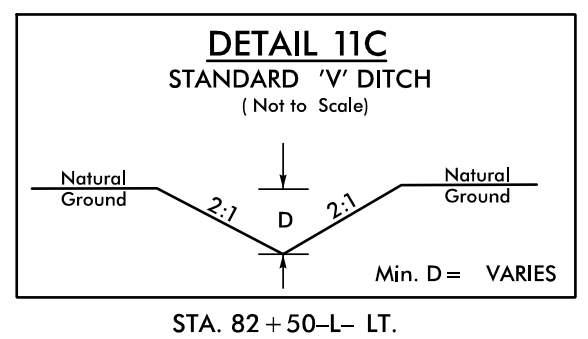

STA. 82 + 50-L- LT.

**NOTE:**  
 ALL DRIVEWAYS ARE TO BE ASPHALT UNLESS OTHERWISE NOTED.  
 END LOCATION OF DRIVEWAY SHOWN ON PLANS REPRESENTS TIE-IN  
 PER CROSS-SECTIONS, THE CONTRACTOR SHALL EXTEND THE DRIVES AND  
 PAVE UP TO THE RIGHT OF WAY LINE. FROM ROW POINT ON MATCH  
 DRIVEWAY IN KIND, UNLESS OTHERWISE NOTED.

NAD 83/2011

PROJECT REFERENCE NO. A-0009CA		SHEET NO. 11	
ROADWAY DESIGN ENGINEER		HYDRAULICS ENGINEER	
<b>DOCUMENT NOT CONSIDERED FINAL UNLESS ALL SIGNATURES COMPLETED</b>			
 TGS ENGINEERS 201 W. MARION ST SHELBY, NC 28150 PH (704) 476-0003 CORP. LICENSE NO.: C-0275			

REVISIONS

MATCH LINE STA -L- 82 + 00.00  
 MATCH TO SHEET NO. 10

MATCH LINE STA -L- 96 + 00.00  
 MATCH TO SHEET NO. 12

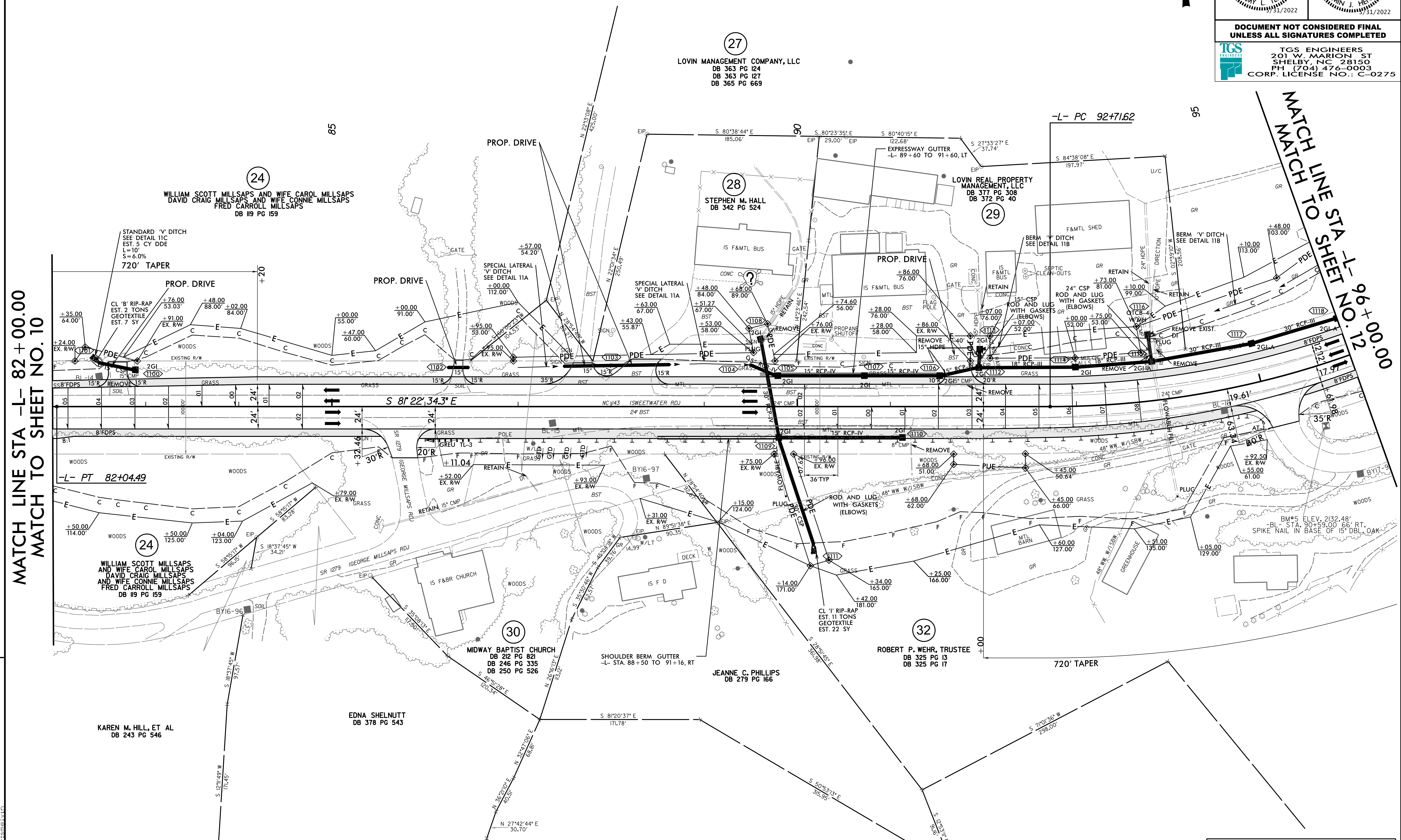

5/20/2022  
 C:\Users\m10001\OneDrive\Roadway\Proj\A-0009CA\Plan\_Sheets\A-0009CA\_Rdy\_psh\_11.dgn  
 11/14/2022  
 C:\Users\m10001\OneDrive\Roadway\Proj\A-0009CA\Plan\_Sheets\A-0009CA\_Rdy\_psh\_11.dgn

FOR -L- PROFILE, SEE SHEET NO. 23