

PROJECT REFERENCE NO. A-0009CA	SHEET NO. 5
ROADWAY DESIGN ENGINEER	HYDRAULICS ENGINEER
DOCUMENT NOT CONSIDERED FINAL UNLESS ALL SIGNATURES COMPLETED	
TGS ENGINEERS 201 W. MARION ST SHELBY, NC 28150 PH (704) 476-0003 CORP. LICENSE NO.: C-0275	

-YIA- CURVE DATA	-YIB- CURVE DATA	-YI- CURVE DATA
PI Sta 12+48.39 $\Delta = 27^\circ 40' 40.3" (LT)$ $D = 10' 31' 56.3"$ $L = 262.79'$ $T = 134.01'$ $R = 544.00'$	PI Sta 10+93.09 $\Delta = 7^\circ 33' 51.9" (RT)$ $D = 7' 09' 43.1"$ $L = 105.62'$ $T = 52.89'$ $R = 800.00'$	PI Sta 13+65.73 $\Delta = 40' 16' 26.4" (LT)$ $D = 57' 17' 44.8"$ $L = 70.29'$ $T = 36.67'$ $R = 100.00'$
③ -YIA- PC 11+4.38	① -YIB- PC 13+29.06 ② -YIB- PT 13+99.35	PI Sta 24+35.36 $\Delta = 38^\circ 00' 53.8" (RT)$ $D = 3' 10' 59.2"$ $L = 1,194.27'$ $T = 620.05'$ $R = 1,800.00'$ SE = 0.03 DS = 45 MPH

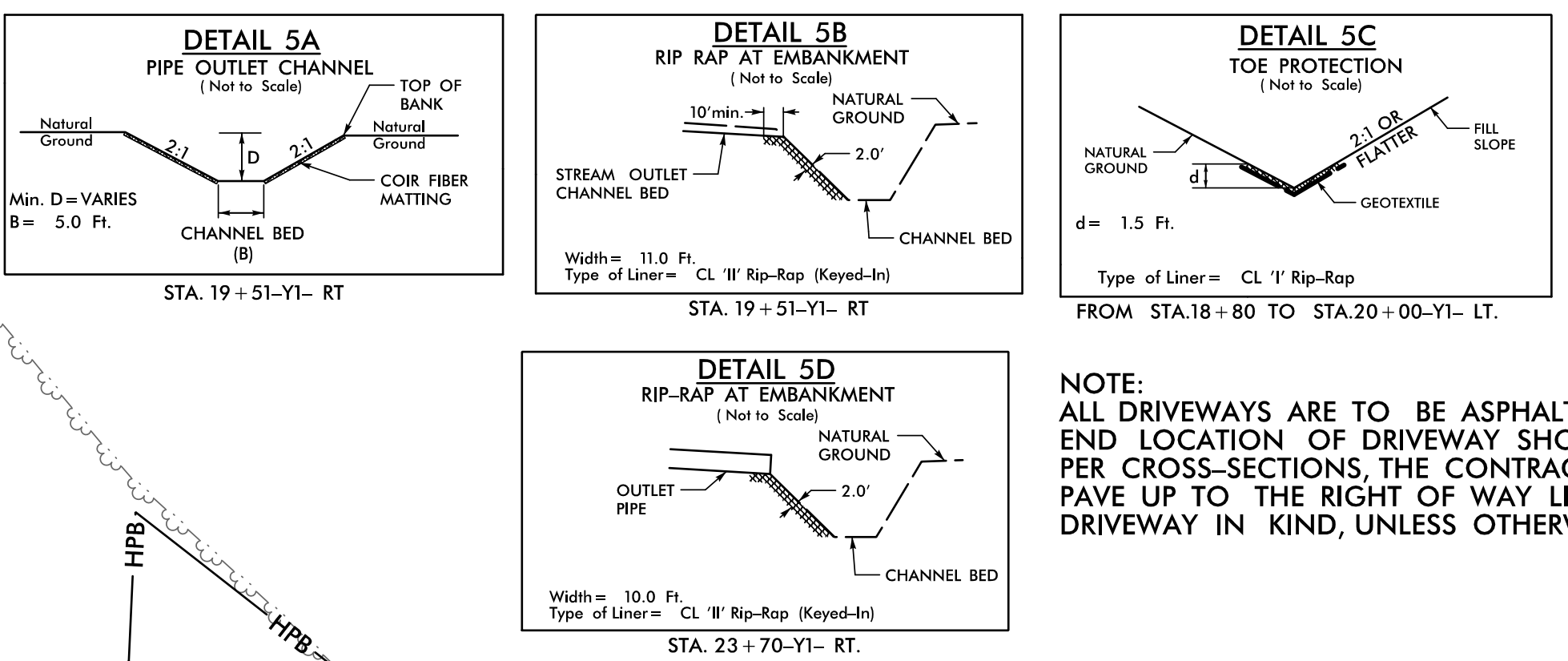

NOTE:
ALL DRIVEWAYS ARE TO BE ASPHALT UNLESS OTHERWISE NOTED.
END LOCATION OF DRIVEWAY SHOWN ON PLANS REPRESENTS TIE-IN PER CROSS-SECTIONS, THE CONTRACTOR SHALL EXTEND THE DRIVES AND PAVE UP TO THE RIGHT OF WAY LINE FROM ROW POINT ON MATCH DRIVEWAY IN KIND, UNLESS OTHERWISE NOTED.

8	EDDIE R. BROOMS, JR. DB 335 PG 807
8A	CLARA BELLE SHULER HEIRS DB 52 PG 435 DB 53 PG 42

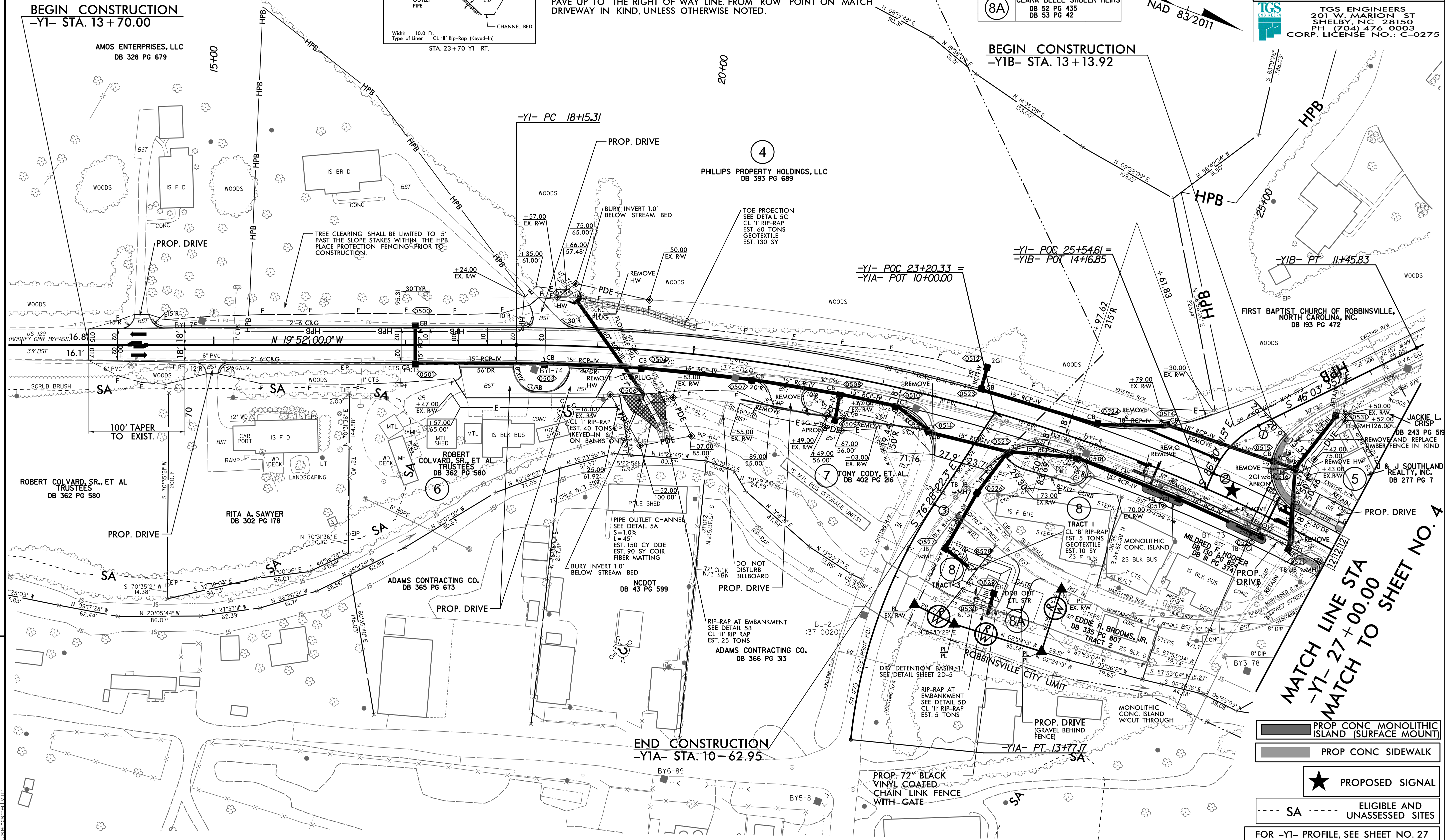

**MATCH LINE STA -YI- 27+00.00
MATCH TO SHEET NO. 4**

- PROP CONC MONOLITHIC ISLAND (SURFACE MOUNT)
- PROP CONC SIDEWALK
- PROPOSED SIGNAL
- SA ELIGIBLE AND UNASSESSED SITES

FOR -YI- PROFILE, SEE SHEET NO. 27

REVISIONS

5/20/2022
 X:\Roadway\0009\Roadway\Proj\A-0009CA_Plan_Sheets\A-0009CA_Rdy_psh_05.dgn
 8/17/99