

PHASING DIAGRAM

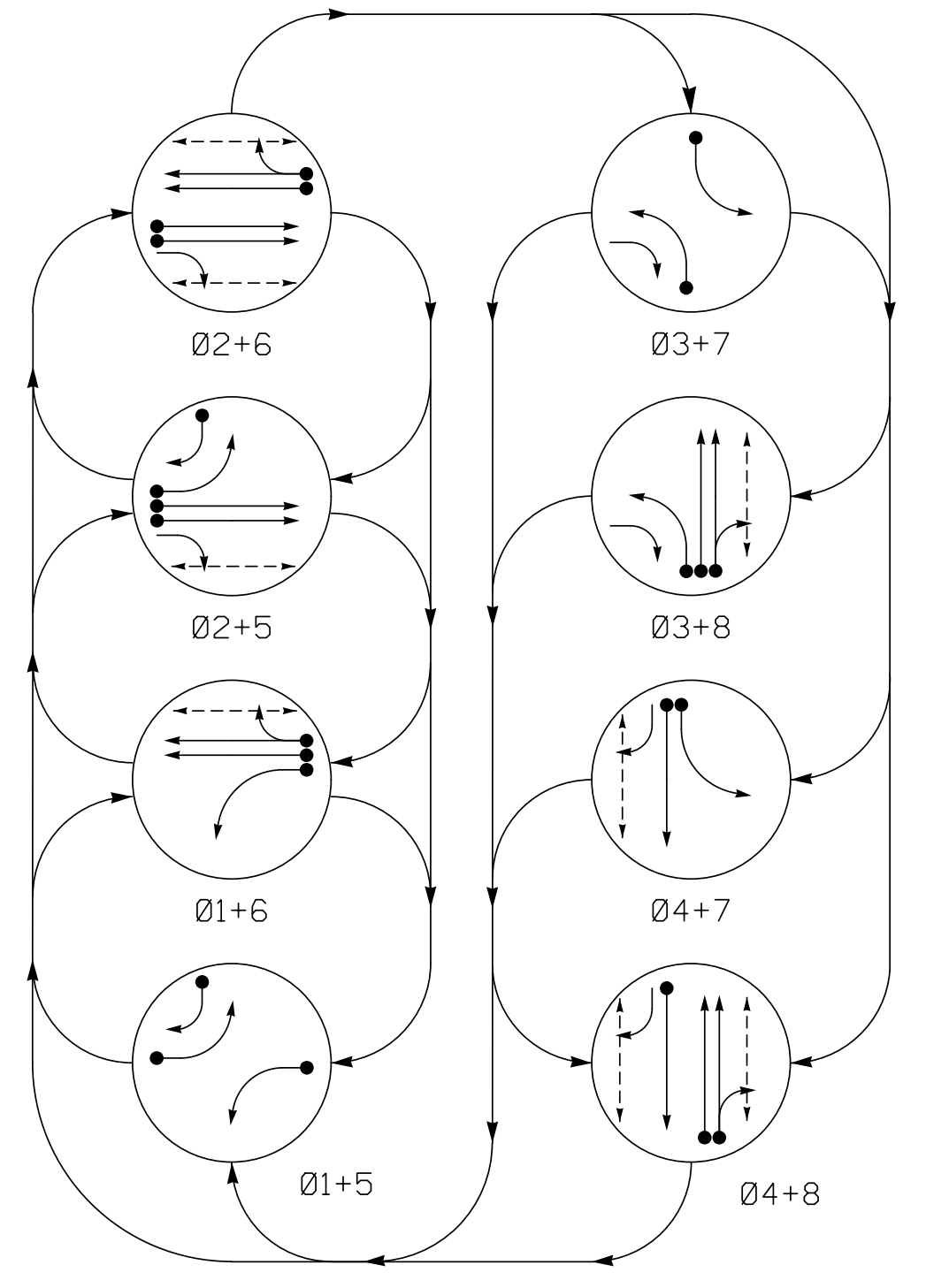

PHASING DIAGRAM DETECTION LEGEND

- ◄● DETECTED MOVEMENT
- ◄ UNDETECTED MOVEMENT (OVERLAP)
- ◄- UN SIGNALIZED MOVEMENT
- ◄- PEDESTRIAN MOVEMENT

TABLE OF OPERATION

SIGNAL FACE	PHASE							
	Ø 1 + 5	Ø 1 + 6	Ø 2 + 5	Ø 2 + 6	Ø 3 + 7	Ø 3 + 8	Ø 4 + 7	Ø 4 + 8
11	←	←	←	←	←	←	←	←
21	R	R	G	G	R	R	R	Y
22	R	R	G	G	R	R	R	Y
31	←	←	←	←	←	←	←	←
41	R	R	R	R	R	R	G	G
42	R	R	R	R	R	R	G	G
51	←	←	←	←	←	←	←	←
61,62	R	G	R	G	R	R	R	Y
71	←	←	←	←	←	←	←	←
81,82	R	R	R	R	R	R	G	R
P21,P22	DW	DW	W	W	DW	DW	DW	DRK
P41,P42	DW	DW	DW	DW	DW	DW	W	DRK
P61,P62	DW	W	DW	W	DW	DW	DW	DRK
P81,P82	DW	DW	DW	DW	DW	W	DW	DRK

SIGNAL FACE I.D.

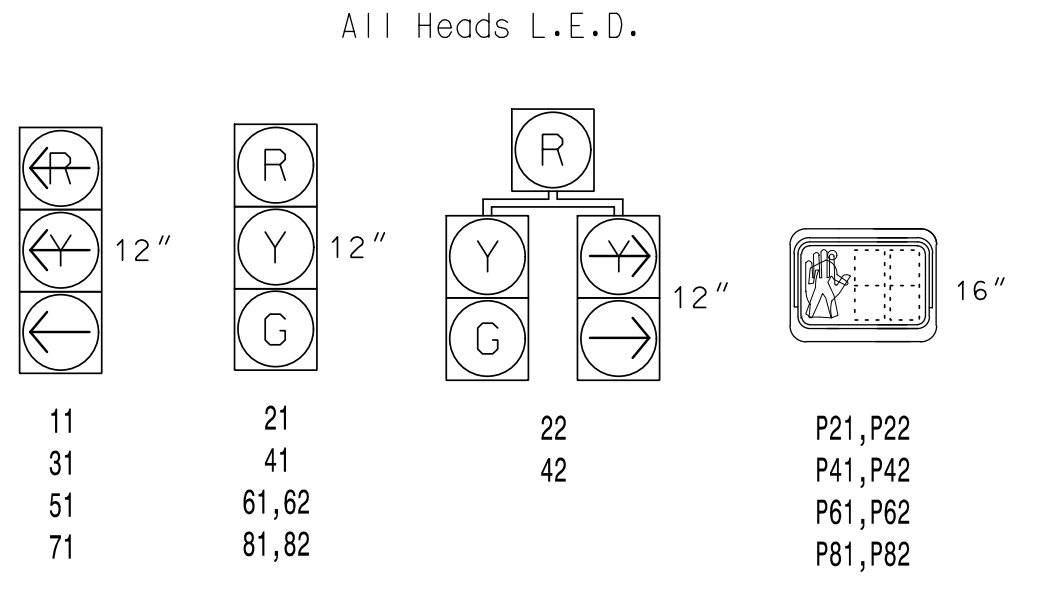

DETECTOR INSTALLATION CHART

LOOP	SIZE (FT)	DISTANCE FROM STOPBAR (FT)	TURNS	NEW LOOP	PROGRAMMING							
					PHASE	CALLING	EXTEND TIME	DELAY TIME	USE ADDED INITIAL	TYPE	SYSTEM LOOP	NEW CARD
1A	6X40	0	2-4-2	-	1	Yes	-	3	-	N	-	X
2A	6X6	70	EXIST	-	2	Yes	-	-	-	N	-	X
2B	6X6	70	EXIST	-	2	Yes	-	-	-	N	-	X
3A	6X60	0	2-4-2	-	3	Yes	-	3	-	N	-	X
4A	6X40	0	2-4-2	-	4	Yes	-	-	-	N	-	X
5A	6X40	0	2-4-2	-	5	Yes	-	3	-	N	-	X
5B	6X40	0	2-4-2	-	5	Yes	-	15	-	N	-	X
6A	6X6	70	EXIST	-	6	Yes	-	-	-	N	-	X
6B	6X6	70	EXIST	-	6	Yes	-	-	-	N	-	X
7A	6X40	0	2-4-2	-	7	Yes	-	3	-	N	-	X
8A	6X60	0	2-4-2	-	8	Yes	-	-	-	N	-	X
8B	6X60	0	2-4-2	-	8	Yes	-	10	-	N	-	X
S1	6X6	230	EXIST	-	-	No	-	-	-	N	X	X
S2	6X6	230	EXIST	-	-	No	-	-	-	N	X	X

8 Phase Fully Actuated Gastonia Signal System

NOTES

- Refer to "Roadway Standard Drawings NCDOT" dated January 2018 and "Standard Specifications for Roads and Structures" dated January 2018.
- Do not program signal for late night flashing operation unless otherwise directed by the Engineer.
- Phase 1 and/or phase 5 may be lagged.
- Phase 3 and/or phase 7 may be lagged.
- Set all detector units to presence mode.
- In the event of loop replacement, refer to the current ITS and Signal Design Manual and submit a Plan of Record to the Signal Design Section.
- Locate new cabinet so as not to obstruct sight distance of vehicles turning right on red.
- Omit "WALK" and flashing "DON'T WALK" with no pedestrian calls.
- Program pedestrian heads to countdown the flashing "Don't Walk" time only.
- Pavement markings are existing.
- Maximum times shown in timing chart are for free-run operation only. Coordinated signal system timing values shall supersede these values.
- Install new cabinet on the existing cabinet foundation.
- All new cabinets and base extenders shall be black in color. See Project Special Provisions for details.
- City of system data:
Controller Asset #0079.

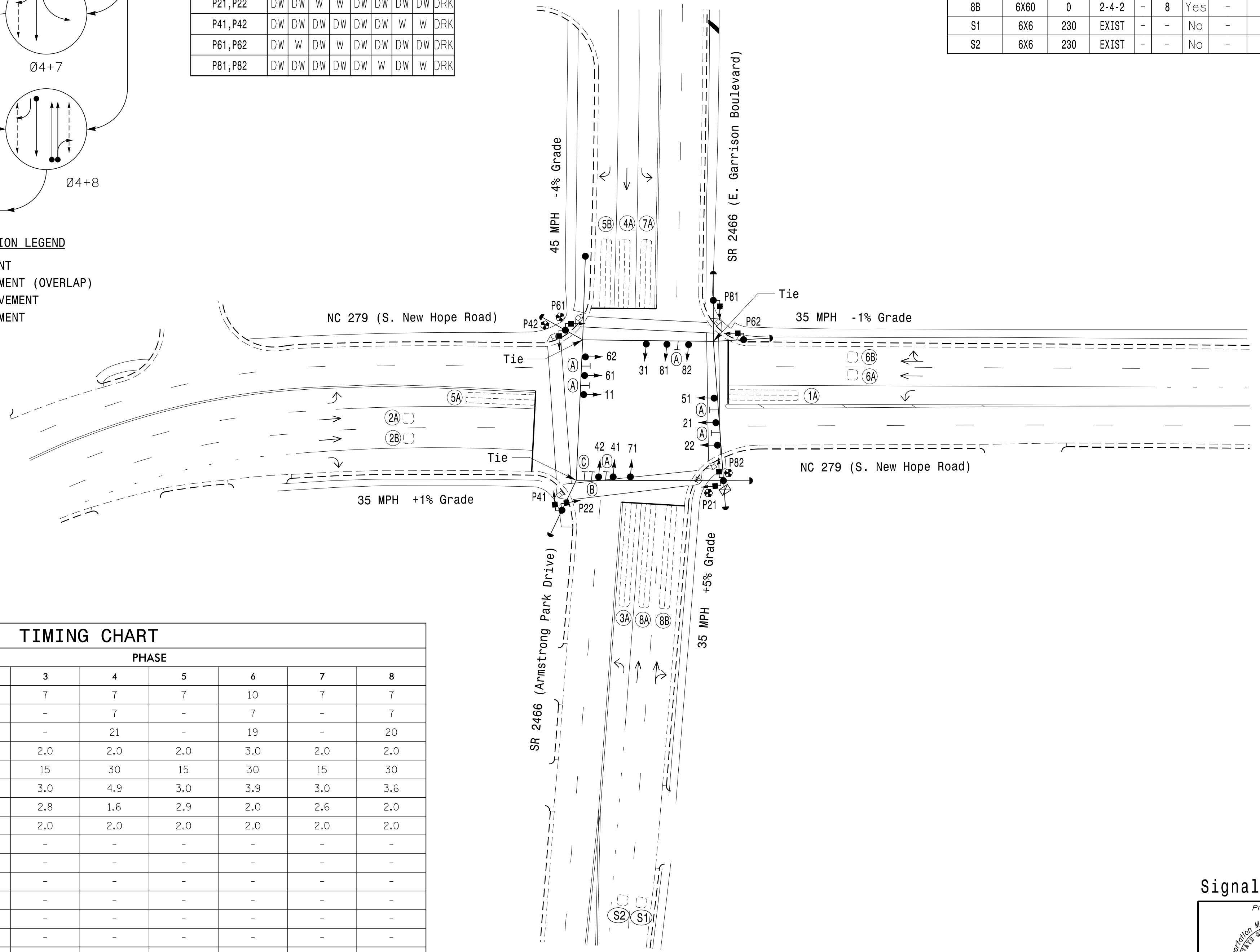

TIMING CHART

FEATURE	PHASE							
	1	2	3	4	5	6	7	8
Min Green *	7	10	7	7	7	10	7	7
Walk *	-	7	-	7	-	7	-	7
Ped Clear	-	20	-	21	-	19	-	20
Veh. Extension *	2.0	3.0	2.0	2.0	2.0	3.0	2.0	2.0
Max I *	15	30	15	30	15	30	15	30
Yellow	3.0	3.8	3.0	4.9	3.0	3.9	3.0	3.6
Red Clear	2.9	2.1	2.8	1.6	2.9	2.0	2.6	2.0
Red Revert	2.0	2.0	2.0	2.0	2.0	2.0	2.0	2.0
Actuations B4 Add *	-	-	-	-	-	-	-	-
Seconds / Actuation *	-	-	-	-	-	-	-	-
Max Initial *	-	-	-	-	-	-	-	-
Time Before Reduction *	-	-	-	-	-	-	-	-
Time To Reduce *	-	-	-	-	-	-	-	-
Minimum Gap	-	-	-	-	-	-	-	-
Locking Detector	-	X	-	-	-	X	-	-
Recall Position	-	MIN RECALL	-	-	-	MIN RECALL	-	-
Dual Entry	-	-	-	-	-	-	-	-
Simultaneous Gap	X	X	X	X	X	X	X	X

* These values may be field adjusted. Do not adjust Min Green and Extension times for phases 2 and 6 lower than what is shown. Min Green for all other phases should not be lower than 4 seconds.

LEGEND

- | | | | |
|--|--|--|--|
| | Proposed Traffic Signal Head | | Existing Traffic Signal Head |
| | Proposed Modified Signal Head | | Existing Modified Signal Head |
| | Proposed Pedestrian Signal Head | | Existing Pedestrian Signal Head |
| | Proposed Type I Pushbutton Post | | Existing Type I Pushbutton Post |
| | Proposed Type II Signal Pedestal | | Existing Type II Signal Pedestal |
| | Proposed Signal Pole with Guy | | Existing Signal Pole with Guy |
| | Proposed Signal Pole with Sidewalk Guy | | Existing Signal Pole with Sidewalk Guy |
| | Proposed Inductive Loop Detector | | Existing Inductive Loop Detector |
| | Proposed Junction Box | | Existing Junction Box |
| | Proposed 2-in Underground Conduit | | Existing 2-in Underground Conduit |
| | Proposed Right of Way | | Existing Right of Way |
| | Proposed Directional Arrow | | Existing Directional Arrow |
| | Proposed Curb Ramp | | Existing Curb Ramp |
| | Proposed Street Name Sign | | Existing Street Name Sign |
| | Proposed "NO TURN ON RED" Sign (R10-11) | | Existing "NO TURN ON RED" Sign (R10-11) |
| | Proposed Right Arrow "ONLY" Sign (R3-5R) | | Existing Right Arrow "ONLY" Sign (R3-5R) |

Signal Upgrade

Prepared For:
Kimley-Horn

PLANS PREPARED IN THE OFFICE OF:
Kimley-Horn
421 Fayetteville Street, Suite 600
Raleigh, NC 27601
(919) 677-2000

NC 279 (S. New Hope Road)
at
SR 2466 (E. Garrison Boulevard/ Armstrong Park Drive)

Division 12 Gaston County Gastonia

PLAN DATE: May 2021 REVIEWED BY: SL Phillips
PREPARED BY: CF Davis REVIEWED BY: KP Baumann

SCALE: 1" = 40'

DOCUMENT NOT CONSIDERED FINAL UNLESS ALL SIGNATURES COMPLETED

Discussed by: 3/11/2022
DATE

SIG. INVENTORY NO. 12-0079

3/9/2022 11:16:08 AM Dan.Hellie.Cur1 ***Kinley-Horn.com/E-RAL/RRAL-TIP/DK-TIS/K01036569 Gastonia Signal System/Sig. 43.0 - S1/signal Design/120079-2021.dgn