

DEFAULT PHASING DIAGRAM

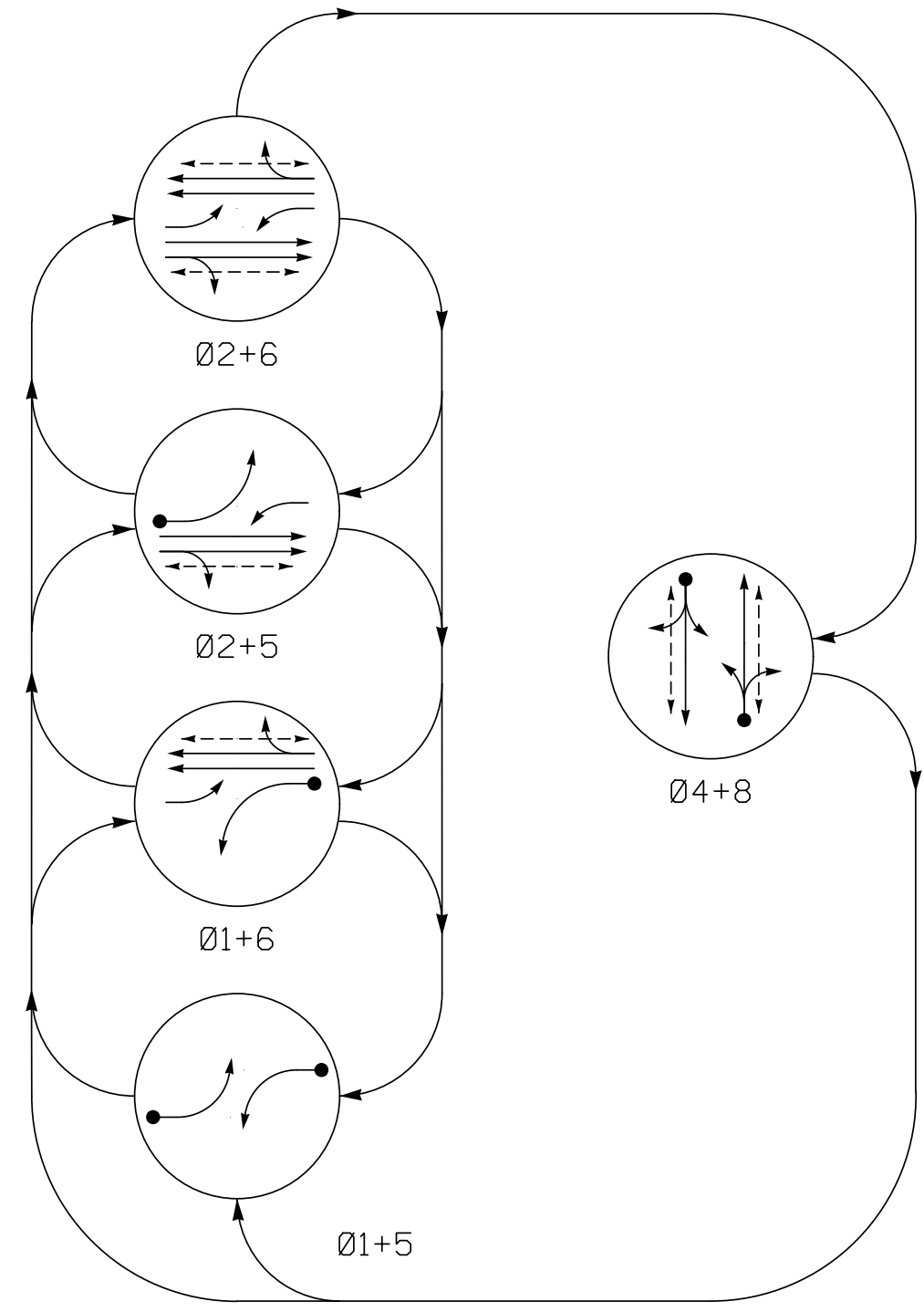

DEFAULT PHASING TABLE OF OPERATION

SIGNAL FACE	PHASE					
	Ø 1+5	Ø 1+6	Ø 2+5	Ø 2+6	Ø 4+8	Ø 1+5
11	←	←	←	←	←	←
21, 22	R	R	G	G	R	Y
41, 42	R	R	R	R	G	R
51	←	←	←	←	←	←
61, 62	R	G	R	G	R	Y
81, 82	R	R	R	R	G	R
P21, P22	DW	DW	W	W	DW	DRK
P41, P42	DW	DW	DW	DW	W	DRK
P61, P62	DW	W	DW	W	DW	DRK
P81, P82	DW	DW	DW	DW	W	DRK

ALTERNATE PHASING DIAGRAM

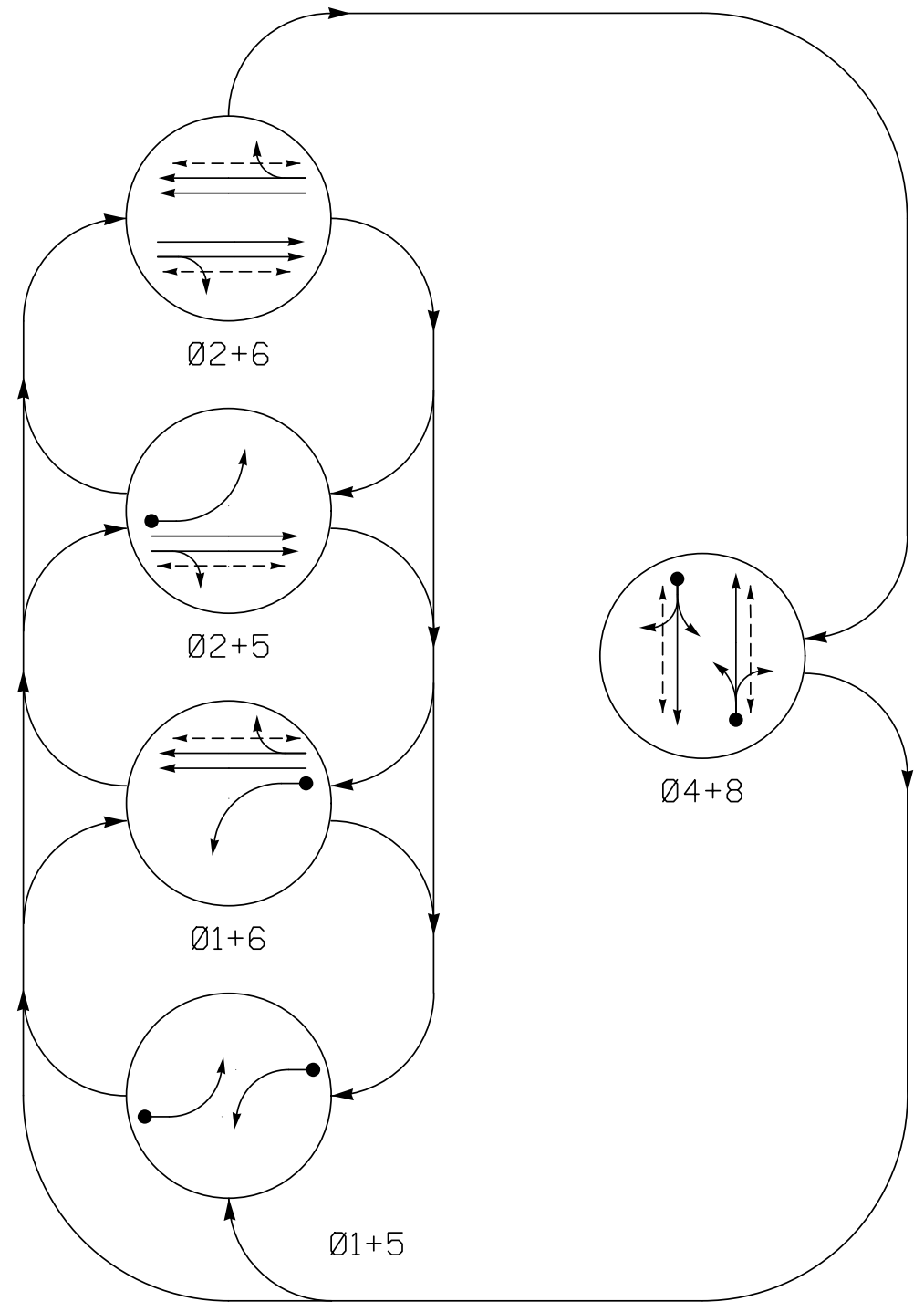

ALTERNATE PHASING TABLE OF OPERATION

SIGNAL FACE	PHASE					
	Ø 1+5	Ø 1+6	Ø 2+5	Ø 2+6	Ø 4+8	Ø 1+5
11	←	←	←	←	←	←
21, 22	R	R	G	G	R	Y
41, 42	R	R	R	R	G	R
51	←	←	←	←	←	←
61, 62	R	G	R	G	R	Y
81, 82	R	R	R	R	G	R
P21, P22	DW	DW	W	W	DW	DRK
P41, P42	DW	DW	DW	DW	W	DRK
P61, P62	DW	W	DW	W	DW	DRK
P81, P82	DW	DW	DW	DW	W	DRK

DETECTOR INSTALLATION CHART

LOOP	SIZE (FT)	DISTANCE FROM STOPBAR (FT)	TURNS	NEW LOOP	PROGRAMMING							
					PHASE	CALLING	EXTEND TIME	DELAY TIME	USE ADDED INITIAL	TYPE	SYSTEM LOOP	NEW CARD
1A	6X40	0	2-4-2	-	1	Yes	-	15*	-	N	-	X
4A	EXIST	+5	EXIST	-	4	Yes	-	10	-	N	-	X
5A	6X40	0	2-4-2	-	5	Yes	-	15*	-	N	-	X
8A	EXIST	+5	EXIST	-	8	Yes	-	10	-	N	-	X

* Reduce delay to 3 seconds during Alternate Phasing Operation.

5 Phase Semi-Actuated w/ Alternate Phasing Operation Gastonia Signal System

NOTES

- Refer to "Roadway Standard Drawings NCDOT" dated January 2018 and "Standard Specifications for Roads and Structures" dated January 2018.
- Do not program signal for late night flashing operation unless otherwise directed by the Engineer.
- Phase 1 and/or phase 5 may be lagged.
- Set all detector units to presence mode.
- In the event of loop replacement, refer to the current ITS and Signal Design Manual and submit a Plan of Record to the Signal Design Section.
- Locate new cabinet so as not to obstruct sight distance of vehicles turning right on red.
- Omit "WALK" and flashing "DON'T WALK" with no pedestrian calls on pedestrian phases 4 and 8.
- Program pedestrian heads to countdown the flashing "Don't Walk" time only.
- The City Engineer or their representative will determine the hours of use for each phasing plan.
- Maximum times shown in timing chart are for free-run operation only. Coordinated signal timing values shall supersede these values.
- Install new cabinet on the existing cabinet foundation.
- All new cabinets and base extenders shall be black in color. See Project Special Provisions for details.
- City system data:
Controller Asset #0046

PHASING DIAGRAM DETECTION LEGEND

- ← ● → DETECTED MOVEMENT
- ← ○ → UNDETECTED MOVEMENT (OVERLAP)
- ← ○ → UNSIGNALIZED MOVEMENT
- ← ○ → PEDESTRIAN MOVEMENT

SIGNAL FACE I.D.

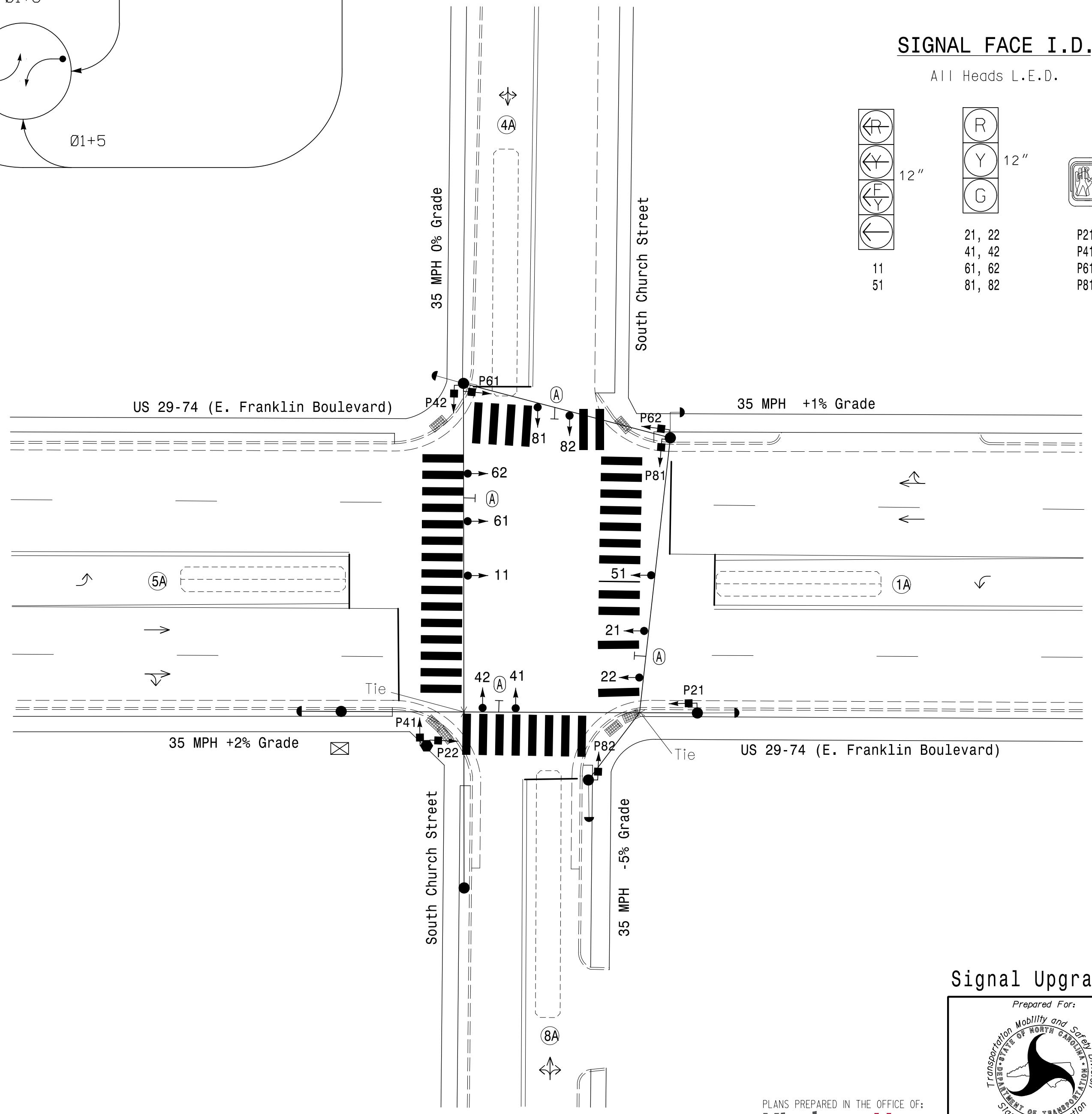
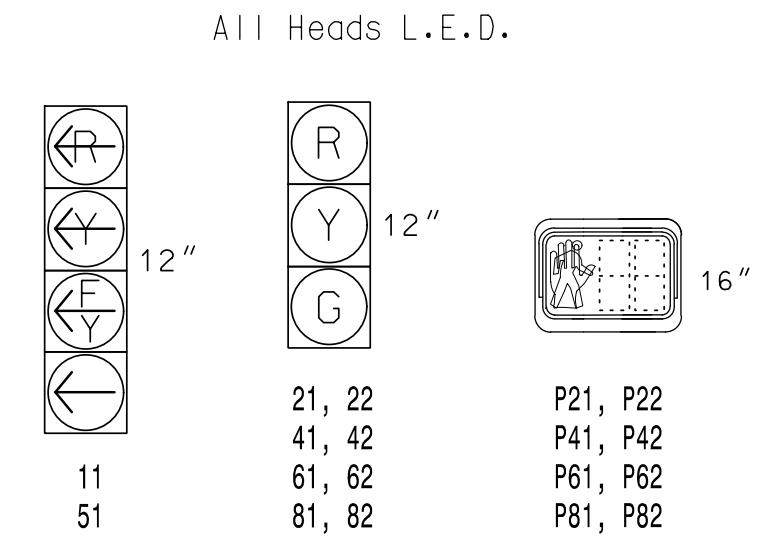

LEGEND

- | PROPOSED | EXISTING |
|----------|----------|
| | |
| | |
| | |
| | |
| | |
| | |
| | |
| | |
| | |
| | |
| | |
| | |
| | |

TIMING CHART

FEATURE	PHASE							
	1	2	4	5	6	8		
Min Green *	7	10	7	7	10	7		
Walk *	-	7	7	-	7	7		
Ped Clear	-	7	18	-	10	16		
Veh. Extension *	2.0	-	1.0	2.0	-	1.0		
Max 1 *	25	60	30	25	60	30		
Yellow	3.0	3.8	4.2	3.0	3.8	4.2		
Red Clear	2.1	1.4	1.6	2.1	1.4	1.6		
Red Revert	2.0	2.0	2.0	2.0	2.0	2.0		
Actuations B4 Add *	-	-	-	-	-	-		
Seconds / Actuation *	-	-	-	-	-	-		
Max Initial *	-	-	-	-	-	-		
Time Before Reduction *	-	-	-	-	-	-		
Time To Reduce *	-	-	-	-	-	-		
Minimum Gap	-	-	-	-	-	-		
Locking Detector	-	-	-	-	-	-		
Recall Position	-	PED/MAX	-	-	PED/MAX	-		
Dual Entry	-	-	X	-	-	X		
Simultaneous Gap	X	X	X	X	X	X		

* These values may be field adjusted. Do not adjust Min Green and Extension times for phases 2 and 6 lower than what is shown. Min Green for all other phases should not be lower than 4 seconds.

Signal Upgrade

PLANS PREPARED IN THE OFFICE OF:
Kimley-Horn
NC License #F-0102
421 Fayetteville Street, Suite 600
Raleigh, NC 27601
(919) 677-2000

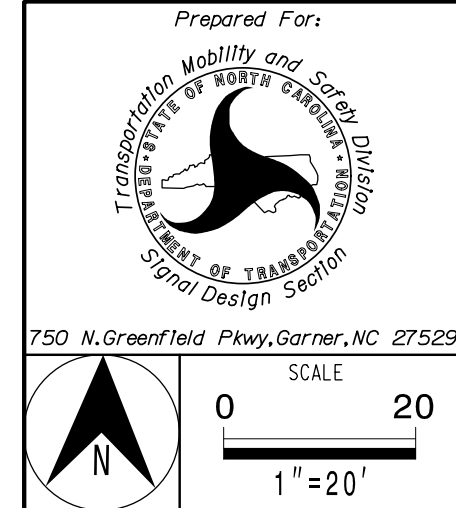

Prepared For:		US 29-74 (E. Franklin Boulevard) at S. Church Street	
Division 12		Gaston County Gastonia	
PLAN DATE:	May 2021	REVIEWED BY:	SL Phillips
PREPARED BY:	CF Davis	REVIEWED BY:	KP Baumann
REVISIONS		INIT.	DATE

DOCUMENT NOT CONSIDERED FINAL UNLESS ALL SIGNATURES COMPLETED

3/11/2022
DATE
12-0046
SIG. INVENTORY NO.

3/9/2022 11:12:10 AM D:\m181\ie-Curr1 ***kimley-horn.com\SELRAL\IP\OK-ITS\01036569_Gastonia_Signal_System\9_Signal\Signal\200-06-2021.dgn