

R:\Structures\Station\Finals\401_05_LB5810_SMU_BM_026_120022.dgn 1/16/2022 4:51:49 PM igr\scm

SUPERSTRUCTURE REINFORCING STEEL LENGTHS ARE BASED ON THE FOLLOWING MINIMUM SPLICE LENGTHS

BAR SIZE	SUPERSTRUCTURE EXCEPT APPROACH SLABS, PARAPET, AND BARRIER RAIL		APPROACH SLABS		PARAPET AND BARRIER RAIL
	EPOXY COATED	UNCOATED	EPOXY COATED	UNCOATED	
#4	1'-11"	1'-7"	1'-11"	1'-7"	2'-6"
#5	2'-5"	2'-0"	2'-5"	2'-0"	3'-1"
#6	2'-10"	2'-5"	3'-7"	2'-5"	3'-8"
#7	4'-2"	2'-9"			
#8	4'-9"	3'-2"			

SUPERSTRUCTURE BILL OF MATERIAL

	CLASS AA CONCRETE (CU. YDS.)	REINFORCING STEEL (LBS.)	* EPOXY COATED REINFORCING STEEL (LBS.)
POUR 1	113.8		
POUR 2	140.3		
POUR 3	146.4		
POUR 4	115.2		
POUR 5	106.6		
POUR 6	111.3		
POUR 7	20.2		
TOTALS**	753.8	78,492	75,480

** QUANTITIES FOR BARRIER RAIL ARE NOT INCLUDED

GROOVING BRIDGE FLOORS

APPROACH SLABS	1,619.3 SQ.FT.
BRIDGE DECK	17,528.1 SQ.FT.
TOTAL	19,147.4 SQ.FT.

BAR TYPES

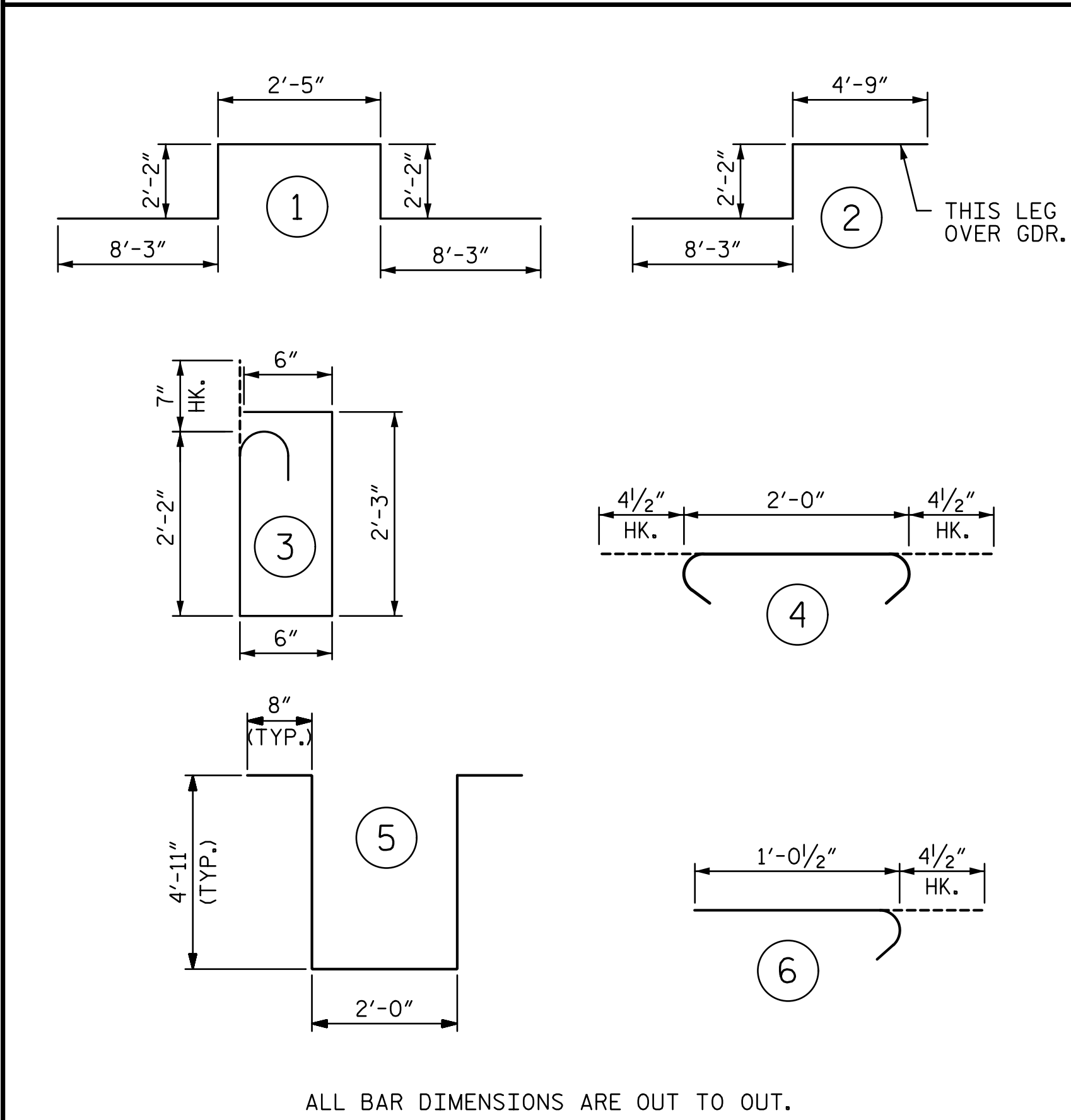

ALL BAR DIMENSIONS ARE OUT TO OUT.

MARK	NO.	SIZE	TYPE	LENGTH	WEIGHT
*A1	1127	#5	STR	39'-11"	46,920
A2	1127	#5	STR	39'-11"	46,920
*B1	56	#5	STR	34'-4"	2,005
*B2	28	#5	STR	39'-10"	1,163
*B3	56	#5	STR	34'-10"	2,035
*B4	56	#5	STR	32'-10"	1,918
*B5	28	#5	STR	22'-10"	667
*B6	28	#5	STR	45'-2"	1,319
*B7	84	#5	STR	60'-0"	5,257
*B8	54	#6	STR	40'-0"	3,244
*B9	50	#6	STR	30'-0"	2,253
*B10	27	#6	STR	36'-0"	1,460
*B11	25	#6	STR	26'-0"	976
*B12	28	#5	STR	52'-0"	1,519
*B13	27	#6	STR	32'-0"	1,298
*B14	25	#6	STR	22'-0"	826
B15	260	#5	STR	58'-4"	15,819
B16	208	#5	STR	60'-0"	13,017
*G1	4	#5	STR	39'-11"	167
*J1	144	#4	⑥	1'-5"	136
*K1	16	#8	①	23'-3"	993
*K2	16	#8	②	15'-2"	648
K3	40	#4	STR	18'-1"	483
K4	24	#4	STR	7'-3"	116
K5	72	#4	STR	9'-3"	445
K6	24	#4	STR	8'-11"	143
*S1	108	#5	③	6'-0"	676
S2	384	#4	④	2'-9"	705
U1	96	#4	⑤	13'-2"	844

* DENOTES EPOXY PROTECTIVE COATING

NOTE:

FOR AREA OF REINFORCED CONCRETE DECK SLAB, SEE "POURING DIAGRAM AND LAYOUT FOR COMPUTING AREA REINFORCED CONCRETE DECK SLAB" SHEET.

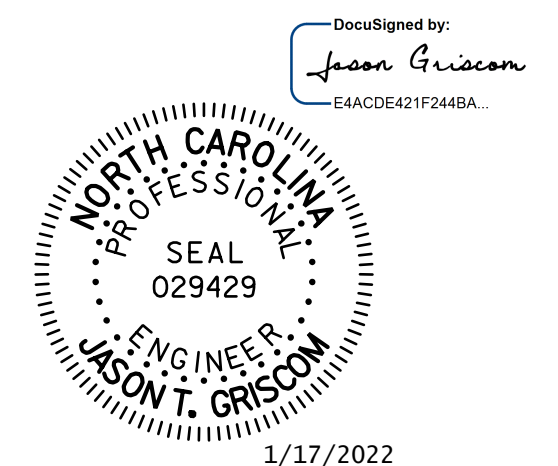

STV 100 YEARS
STV ENGINEERS, INC.
900 West Trade St., Suite 715
Charlotte, NC 28202
NC License Number F-0991

DOCUMENT NOT CONSIDERED FINAL UNLESS ALL SIGNATURES COMPLETED

PROJECT NO. B-5810
CABARRUS COUNTY
STATION: 23+17.00 -L-

STATE OF NORTH CAROLINA DEPARTMENT OF TRANSPORTATION RALEIGH				
SUPERSTRUCTURE BILL OF MATERIAL				
REVISIONS				SHEET NO.
NO.	BY:	DATE:	NO.	DATE:
1			3	
2			4	
				S-26
				TOTAL SHEETS 36

ASSEMBLED BY : LGH DATE : 6-19
CHECKED BY : MLO DATE : 12-19
DESIGN ENGINEER OF RECORD : J. GRISON DATE : 1-22