

POUR SEQUENCE

⊕ → INDICATES POUR NUMBER AND DIRECTION OF POUR

▲ PREVIOUSLY CAST CONCRETE SHALL HAVE A ATTAINED MINIMUM COMPRESSIVE STRENGTH OF 3,000 PSI BEFORE ADDITIONAL CONCRETE IS CAST.

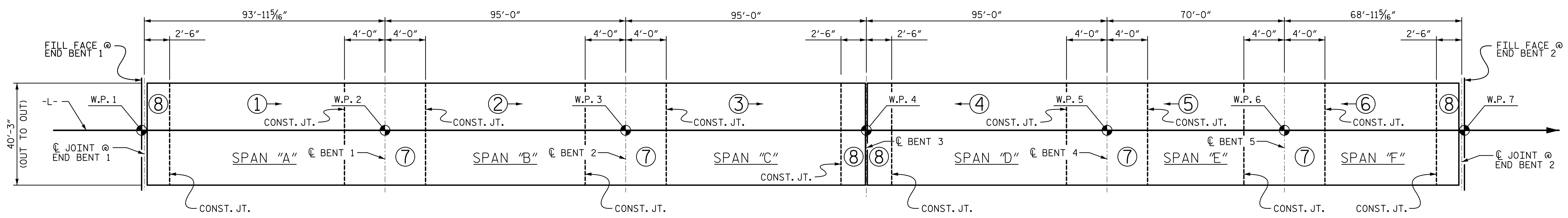

OPTIONAL POUR SEQUENCE

⊕ → INDICATES POUR NUMBER AND DIRECTION OF POUR

POURING DIAGRAM AND LAYOUT FOR COMPUTING AREA OF REINFORCED CONCRETE DECK SLAB (SQ. FT. = 20,834.0)

PROJECT NO. B-5810
CABARRUS COUNTY
 STATION: 23+17.00 -L-

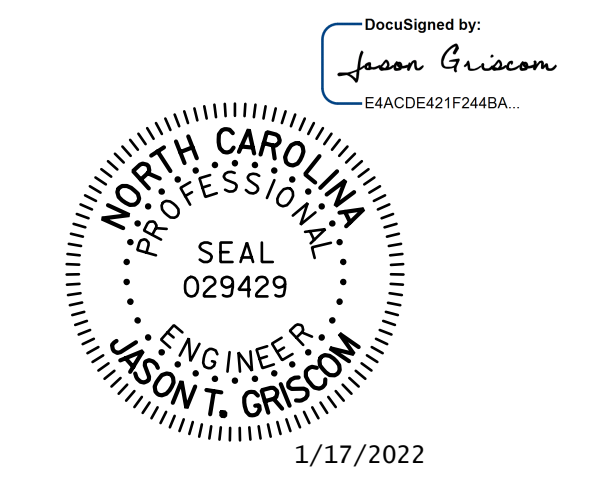

STV 100 YEARS STV ENGINEERS, INC.
 900 West Trade St., Suite 715
 Charlotte, NC 28202
 NC License Number F-0991

DOCUMENT NOT CONSIDERED FINAL UNLESS ALL SIGNATURES COMPLETED

STATE OF NORTH CAROLINA
 DEPARTMENT OF TRANSPORTATION
 RALEIGH
POURING DIAGRAM AND LAYOUT FOR COMPUTING AREA OF REINFORCED CONCRETE DECK SLAB

REVISIONS						SHEET NO.
NO.	BY:	DATE:	NO.	BY:	DATE:	S-25
1			3			TOTAL SHEETS 36
2			4			

R:\Structures\Station\Finals\40L_049_B5810_SMU_DPS_025_I20022.dgn 1/16/2022 4:51:44 PM igr\scorn

ASSEMBLED BY : LGH DATE : 6-19
 CHECKED BY : MLO DATE : 12-19
 DESIGN ENGINEER OF RECORD : J. GRISCOM DATE : 1-22