

VERTICAL CURVE DATA -L-

(+)0.7809% (-)0.8375%
 PI = 23+00.00
 EL = 508.30
 VC = 550.00'

VERTICAL CURVE DATA -L-

(-)0.8375% (+)0.9680%
 PI = 27+00.00
 EL = 504.95
 VC = 250.00'

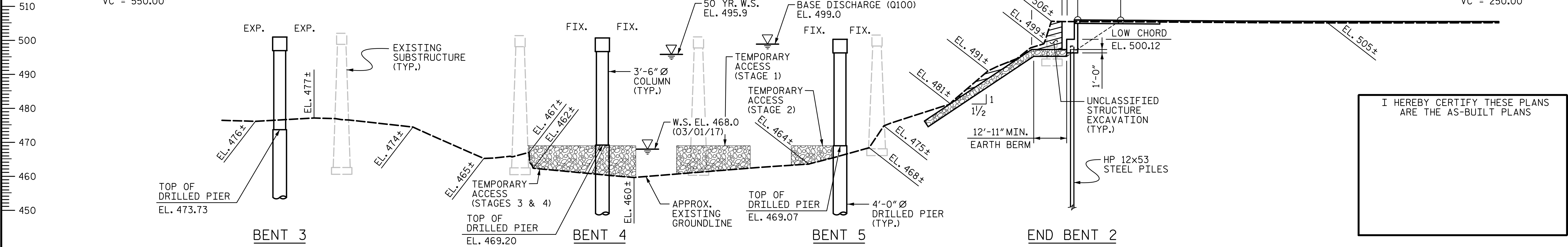

I HEREBY CERTIFY THESE PLANS ARE THE AS-BUILT PLANS

HYDRAULIC DATA

DESIGN DISCHARGE: 42,244 CFS
 FREQUENCY OF DESIGN FLOOD: 50 YRS.
 DESIGN HIGH WATER ELEVATION: 495.9
 DRAINAGE AREA: 536 SQ. MI.
 BASE DISCHARGE (Q100): 51,858 CFS
 BASE HIGH WATER ELEVATION: 499.0

OVERTOPPING FLOOD DATA

OVERTOPPING DISCHARGE: 78,133 CFS
 FREQUENCY OF OVERTOPPING FLOOD: 500± YRS.
 OVERTOPPING FLOOD ELEVATION: 505.5
 OVERTOPPING OCCURS @ STA. 26+90.97 -L- ON PROPOSED ROADWAY

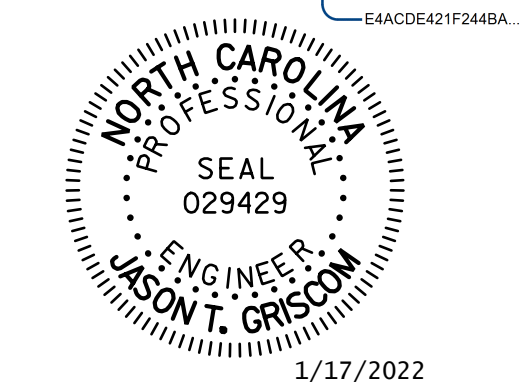
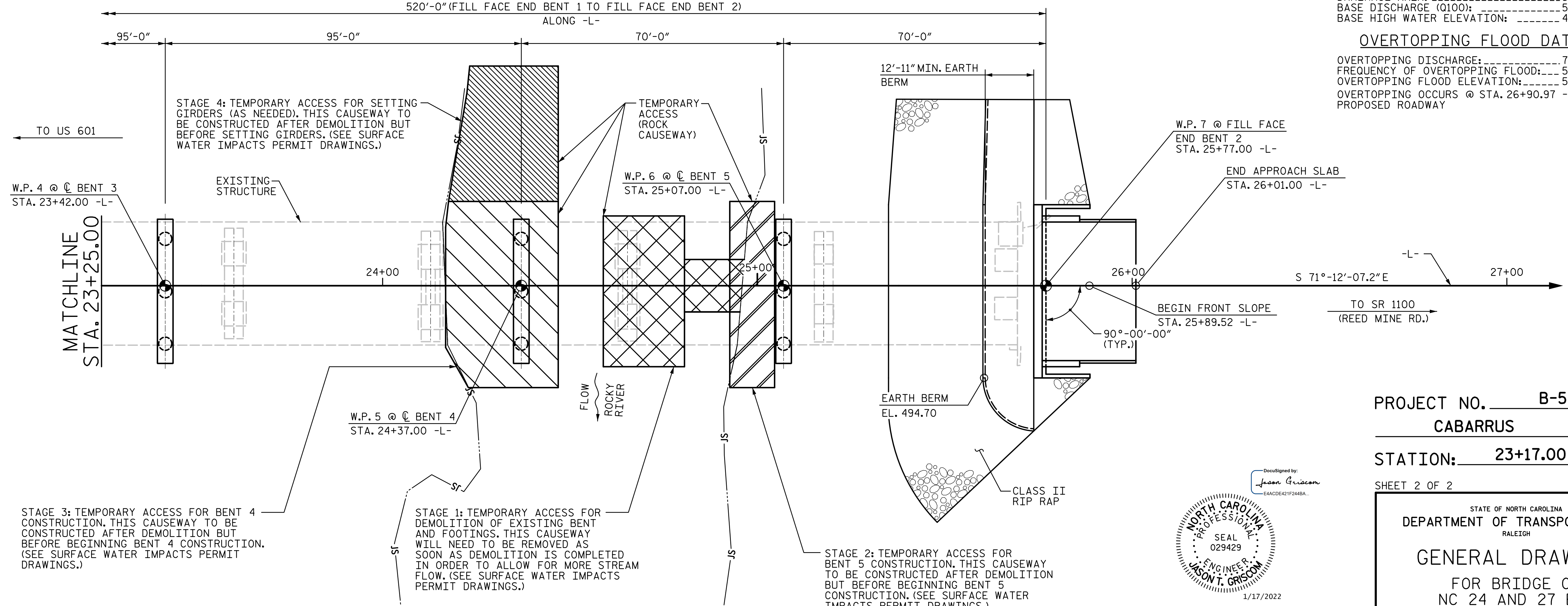

STV 100 YEARS
 STV ENGINEERS, INC.
 900 West Trade St., Suite 715
 Charlotte, NC 28202
 NC License Number F-0991

DOCUMENT NOT CONSIDERED FINAL UNLESS ALL SIGNATURES COMPLETED

PROJECT NO. **B-5810**
 CABARRUS COUNTY
 STATION: **23+17.00 -L-**

SHEET 2 OF 2
 STATE OF NORTH CAROLINA
 DEPARTMENT OF TRANSPORTATION
 RALEIGH
GENERAL DRAWING
 FOR BRIDGE ON
 NC 24 AND 27 EBL
 OVER ROCKY RIVER BETWEEN
 US 601 AND SR 1100

REVISIONS				SHEET NO.
NO.	BY:	DATE:	NO.	DATE:
1			3	
2			4	

S-2
 TOTAL SHEETS 36

R:\Structures\Station\Final\401_003_B5810_SMU_GD2_002_120022.dgn 4:49:24 PM 1/16/2022 Igr\scm