

6/2/19

PROJECT REFERENCE NO.	SHEET NO.
B-5810	RW05
Location and Surveys	

I, Dennis W. Staples, a Professional Land Surveyor in the state of North Carolina hereby certify to the best of my knowledge and belief that the following work item(s) (R/W Staking) performed under my responsible charge meet NCDOT Survey Standards as directed in the NCDOT Location & Surveys guidelines and procedures.

I further certify that the right of way and permanent easement points shown herein and outlined in the tables shown hereon (localized coordinates, station/offset) have been checked and are accurate representations of the right of way and permanent easement points depicted on the corresponding highway plans. I also certify that the right of way and permanent easement points shown herein have been field monumented under my supervision from existing survey control provided by others; that the depicted property data shown herein were surveyed by others; and these monuments denote the right of way and easement boundaries at the time of staking which may be subject to change due to right of way revisions (See deeds for final determination).

Witness my original signature, registration number and seal this 31st day of July, 2019.

Designed by:
Dennis W. Staples, PE, PLS
 Professional Land Surveyor L-3255
 PLS #

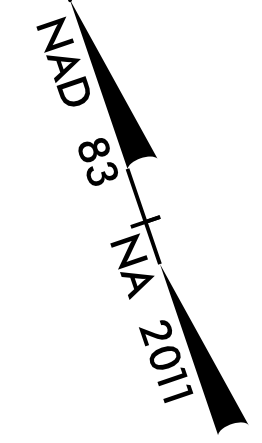
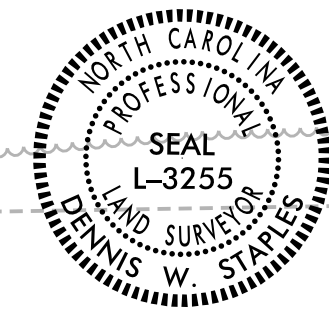

REVISIONS

MATCHLINE -L- STA 15+40 (SHEET RW04)

MATCHLINE -L- STA 20+60 (SHEET RW06)

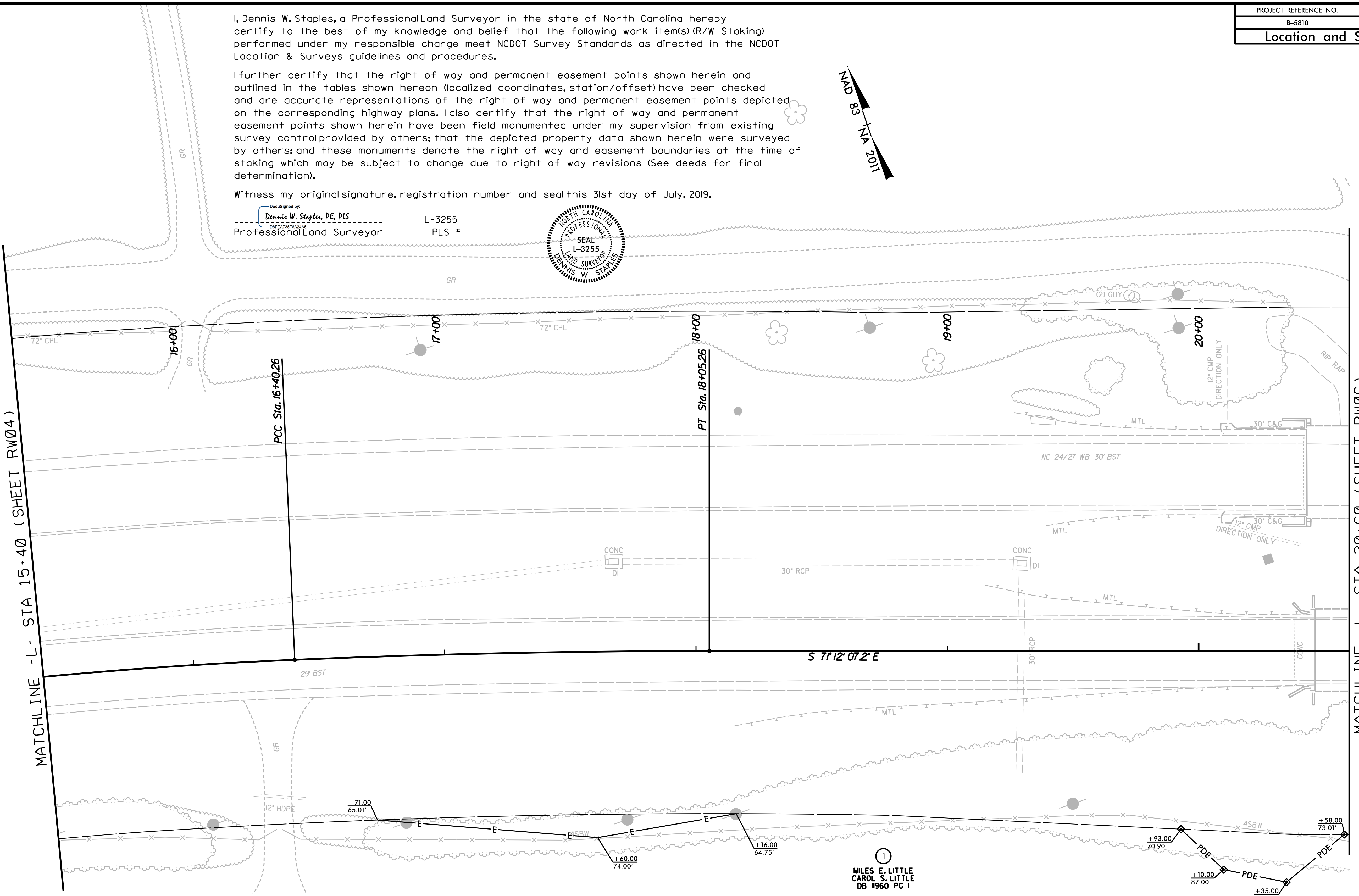

①
 MILES E. LITTLE
 CAROL S. LITTLE
 DB #960 PG 1

NOTES:

- IF FURTHER INFORMATION REGARDING PROJECT CONTROL IS NEEDED, PLEASE CONTACT THE LOCATION AND SURVEYS UNIT.
- PROJECT CONTROL WAS ESTABLISHED USING GNSS, THE GLOBAL NAVIGATION SATELLITE SYSTEM.

31 JUL 2019 10:10
 Z:\Projects\B-5810\19-XXX_RWS\steking\wtf\B-5810_1s_rw05.dgn
 19-XXX_RWS\steking\wtf\B-5810_1s_rw05.dgn
 19-XXX_RWS\steking\wtf\B-5810_1s_rw05.dgn