

09/08/99

TIP PROJECT: Y-5500JC

CONTRACT: C204708

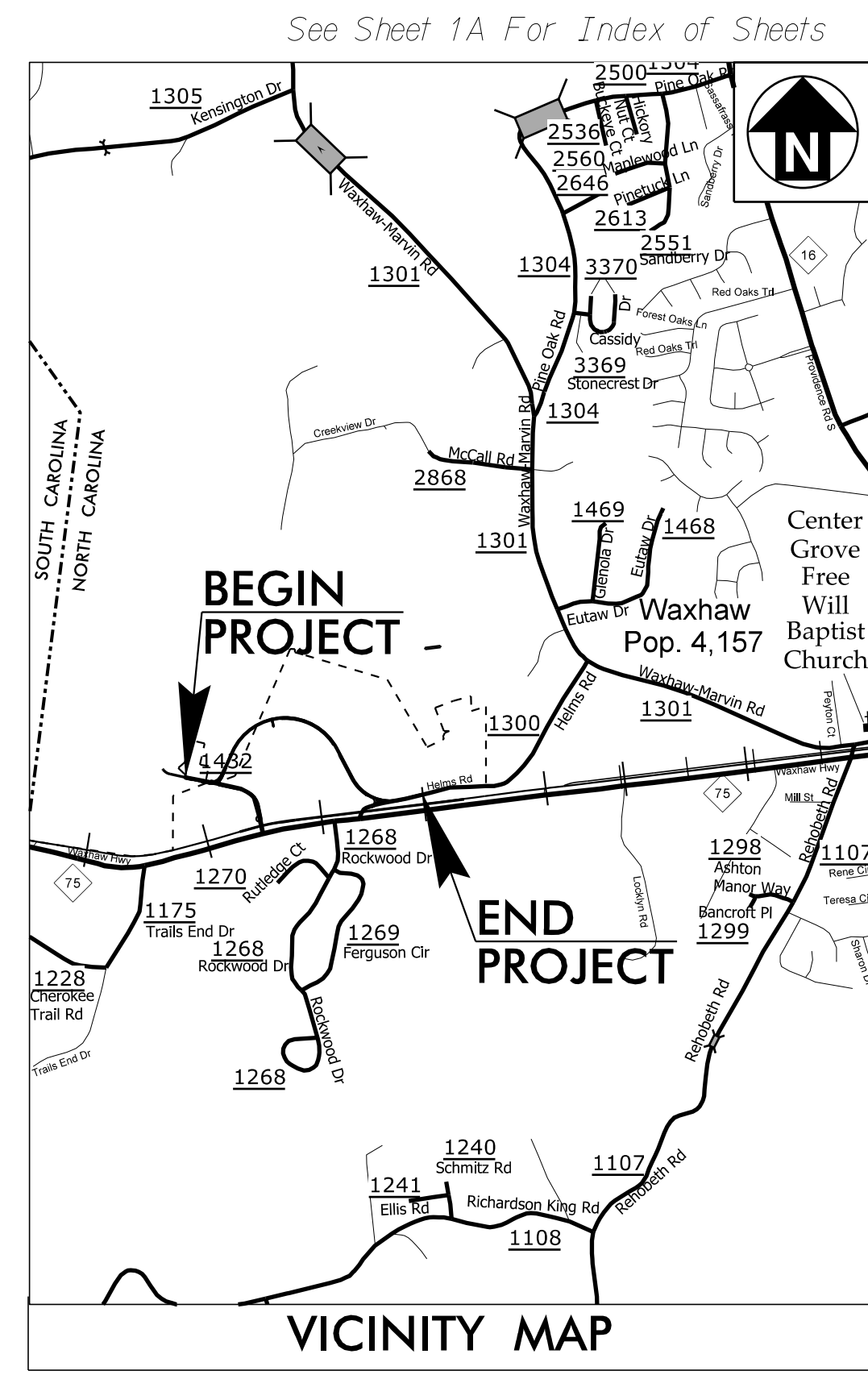

STATE OF NORTH CAROLINA
RAIL DIVISION

UNION COUNTY

STATE	STATE PROJECT REFERENCE NO.	SHEET NO.	TOTAL SHEETS
N.C.	Y-5500JC	1	
STATE PROJ. NO.	F.A. PROJ. NO.	DESCRIPTION	
45533.1.18	1432008	PE	
45533.2.5	1432008	RW	
45533.3.18	1432008	CONST	

LOCATION: SR 1432 (TORY PATH ROAD)(CROSSING NUMBER 638 898H, MP 319.97)
CROSSING CLOSURE AT CSX TRANSPORTATION, AND EXTENSION
TO SR 1300 (HELMS ROAD) IN WAXHAW

TYPE OF WORK: GRADING, PAVING, DRAINAGE, AND RAIL CROSSING CLOSURE

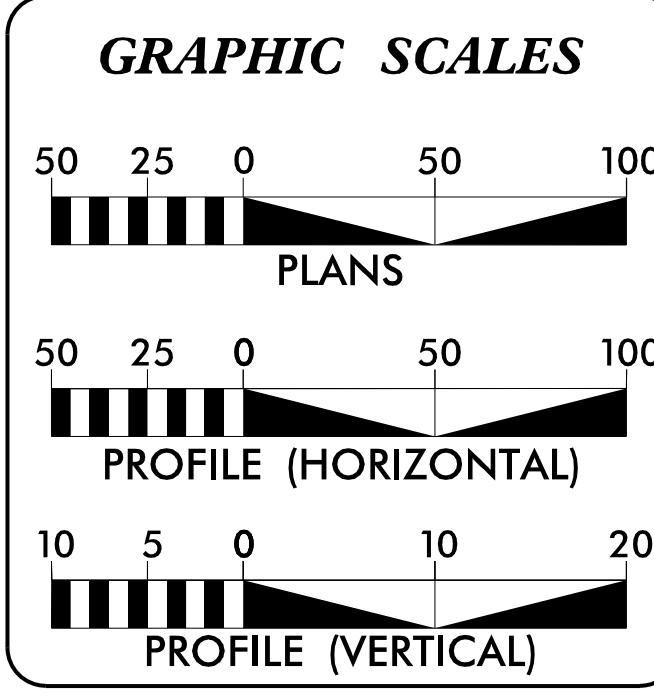
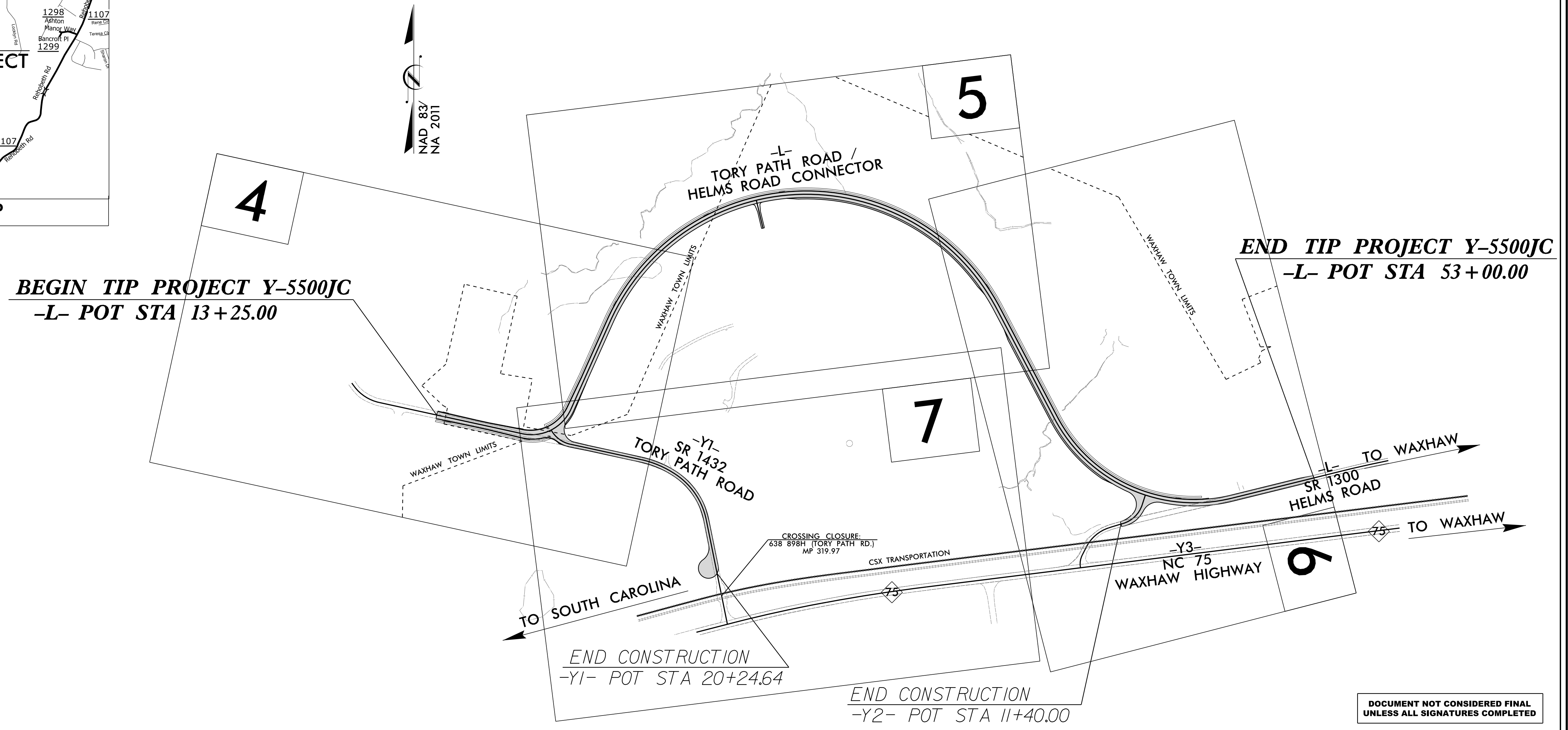

DESIGN DATA

ADT 2022 =	320
ADT 2045 =	1200
K =	10 %
D =	55 %
T =	9 % *
V =	40 MPH

* (TTST 1% + DUAL 8%)

FUNC CLASS = LOCAL
REGIONAL TIER

PROJECT LENGTH

LENGTH ROADWAY TIP PROJECT Y-5500JC =	0.753 MILES
TOTAL LENGTH OF TIP PROJECT Y-5500JC =	0.753 MILES

PLANS PREPARED FOR THE NCDOT BY:

M M
MOTT
MACDONALD
LICENSE NO. F-0669

2018 STANDARD SPECIFICATIONS

RIGHT OF WAY DATE:
APRIL 26, 2021

LETTING DATE:
JULY 19, 2022

W. HERBERT TURNER, JR, PE
PROJECT ENGINEER
PEF ENGINEER

JEFFREY COOKE, PE
PROJECT DESIGN ENGINEER
PEF ENGINEER

BRIAN GACKSTETTER, EI
NCDOT DIVISION
PROJECT ENGINEER

HYDRAULICS ENGINEER

W. HERBERT TURNER, JR.
P.E.

JEFFREY COOKE
P.E.

SEAL
21862
HERBERT TURNER, JR.
JEFFREY COOKE

NC DEPARTMENT OF
TRANSPORTATION
RAIL DIVISION

1556 MAIL SERVICE CENTER
RALEIGH, NC 27699-1556
(919) 707 4110
(919) 707-4154 (FAX)

DOCUMENT NOT CONSIDERED FINAL UNLESS ALL SIGNATURES COMPLETED

3:50:17 PM
R:\Roadway\Proj\F-14288_rdy_tsh.dgn
C0482919