

GEOTECHNICAL ENGINEER
 ENGINEER
 NORTH CAROLINA PROFESSIONAL SEAL 048207
 ENGINEER
 STEPHEN C. CROCKETT
 DocuSigned by: Stephen C. Crockett 04/12/2022
 DATE: 04/12/2022
 SIGNATURE: DATE:

**DOCUMENT NOT CONSIDERED FINAL
UNLESS ALL SIGNATURES COMPLETED**

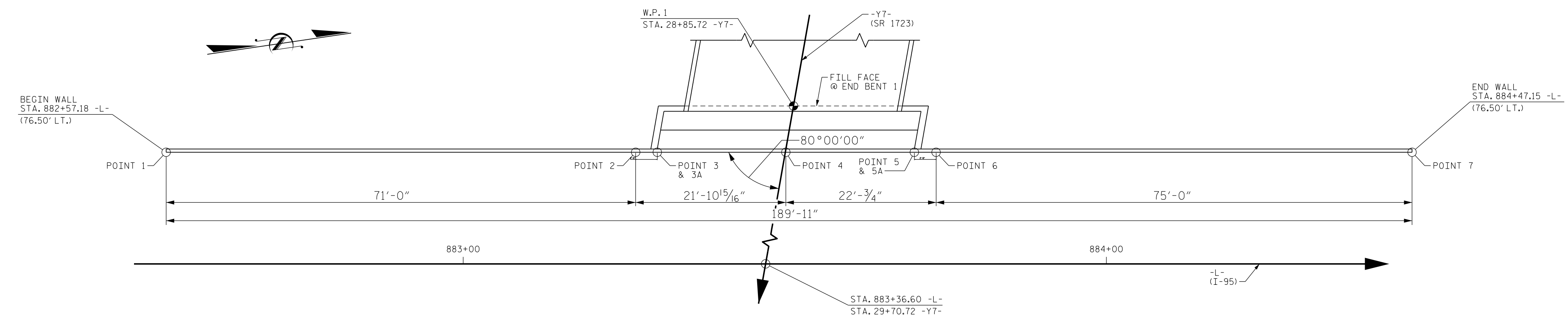

ESTIMATED MSE WALL QUANTITIES (SQUARE FEET)	
MSE RETAINING WALL NO. W8A	2,900 SF

RETAINING WALL NO. W8A PLAN - END BENT 1 MSE WALL

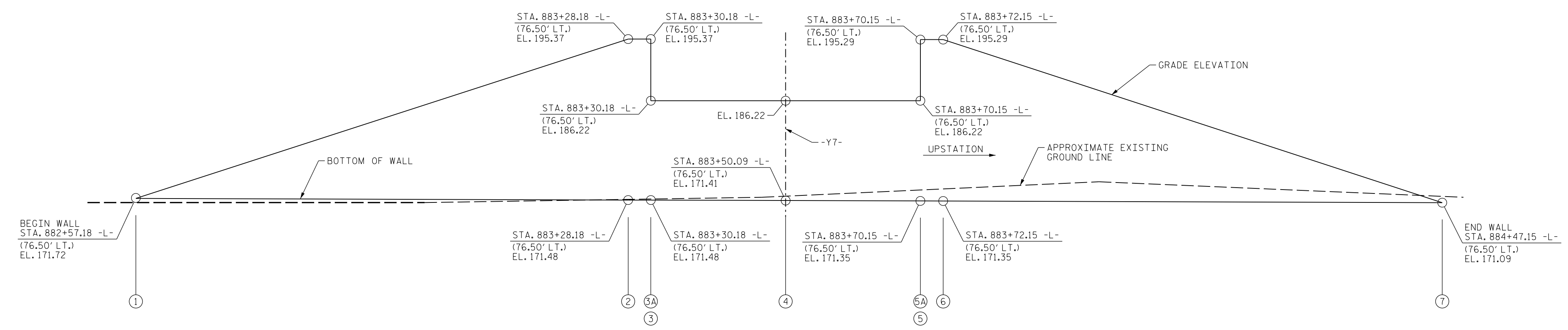

RETAINING WALL NO. W8A ENVELOPE - END BENT 1 MSE WALL

DIMENSIONS OF WALL TAKEN ALONG FRONT FACE OF MSE WALL
FACING DOWNSTATION ON -Y7-

PROJECT NO.: I-5987B
 ROBESON COUNTY
 STATION: 29+70.72 -Y7-
 SHEET 9 OF 19 WALL ID W8A

PREPARED BY: S. CROCKETT	DATE: 3/29/22
REVIEWED BY: J. HAMM	DATE: 3/29/22

FALCON ENGINEERING, INC.
 1210 TRINITY ROAD, SUITE 110
 CARY, NC 27513
 PHONE: 919.871.0800
 www.falconengineers.com

NORTH CAROLINA
 DEPARTMENT OF TRANSPORTATION
 DIVISION OF HIGHWAYS
**GEOTECHNICAL
ENGINEERING UNIT**

REVISIONS						SHEET NO. W-9
NO.	BY	DATE	NO.	BY	DATE	
1			3			W-9
2			4			