

GEOTECHNICAL ENGINEER

ENGINEER

NORTH CAROLINA
PROFESSIONAL
SEAL
048207
ENGINEER
STEPHEN C. CROCKETT

DocuSigned by:
Stephen C. Crockett 04/12/2022

DATE SIGNATURE DATE

DOCUMENT NOT CONSIDERED FINAL
UNLESS ALL SIGNATURES COMPLETED

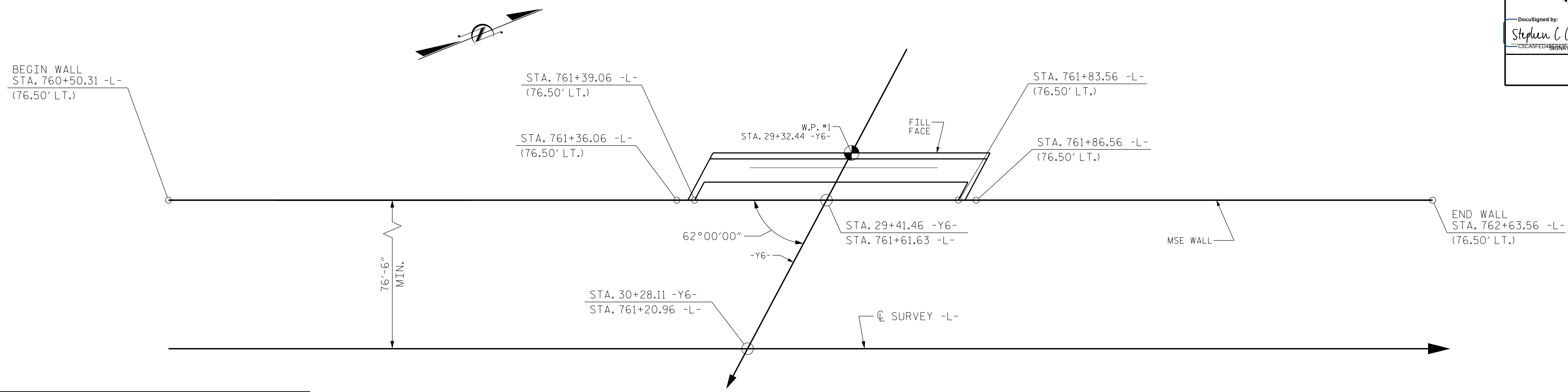

ESTIMATED MSE WALL QUANTITIES (SQUARE FEET)	
MSE RETAINING WALL NO. W7A	3,500 SF

RETAINING WALL NO. W7A PLAN - END BENT 1 MSE WALL

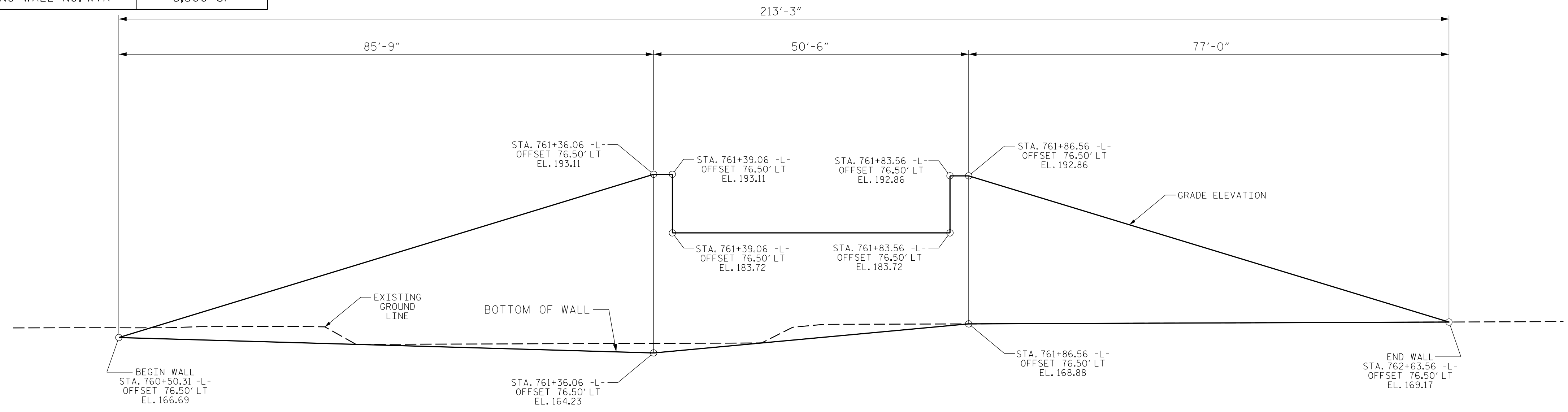

RETAINING WALL NO. W7A ENVELOPE - END BENT 1 MSE WALL

DIMENSIONS OF WALL TAKEN ALONG FRONT FACE OF MSE WALL
FACING DOWNSTATION ON -Y6-

PROJECT NO.: I-5987B
ROBESON COUNTY
STATION: 30+28.11 -Y6-
SHEET 7 OF 19 WALL ID W7A

PREPARED BY: S. CROCKETT	DATE: 3/29/22
REVIEWED BY: J. HAMM	DATE: 3/29/22

FALCON ENGINEERING

FALCON ENGINEERING, INC.
1210 TRINITY ROAD, SUITE 110
CARY, NC 27513
PHONE: 919.871.0800
www.falconengineers.com

NORTH CAROLINA
DEPARTMENT OF TRANSPORTATION
DIVISION OF HIGHWAYS

GEOTECHNICAL
ENGINEERING UNIT

REVISIONS						SHEET NO. W-7
NO.	BY	DATE	NO.	BY	DATE	
1			3			
2			4			